

PDC Energy Inc. DJ Basin



HEN 02N
 Hen Pad
 North American Datum 1983 , US State Plane 1983, Colorado Northern Zone
 Ground Elevation: 4779.0
 +N/-S +E/-W Northing Easting Latitude Longitude
 0.0 0.0 1363818.78 3258628.40 40.328370 -104.572350
 P272 - RKB 28.5' Well @ 4807.5ft (P272 - RKB 28.5')

Hen Pad
 HEN 02N
 HEN 02N Final Surveys
 9:50, August 17 2023



Azimuths to True North
 Magnetic North: 7.68°

Magnetic Field
 Strength: 51711.5nT
 Dip Angle: 66.58°
 Date: 08/08/2023
 Model: HRGM

ANNOTATIONS

MD	TVD	Annotation
7662.0	6900.8	LPL - 360' FNL & 2433' FEL
15174.0	6815.8	BHL - 357' FNL & 206' FEL

FINAL SURVEY
Projected Bottom Hole Location
15174' MD / 6815.8' TVD
92.83° INC / 90.3° AZM
357' FNL / 206' FEL

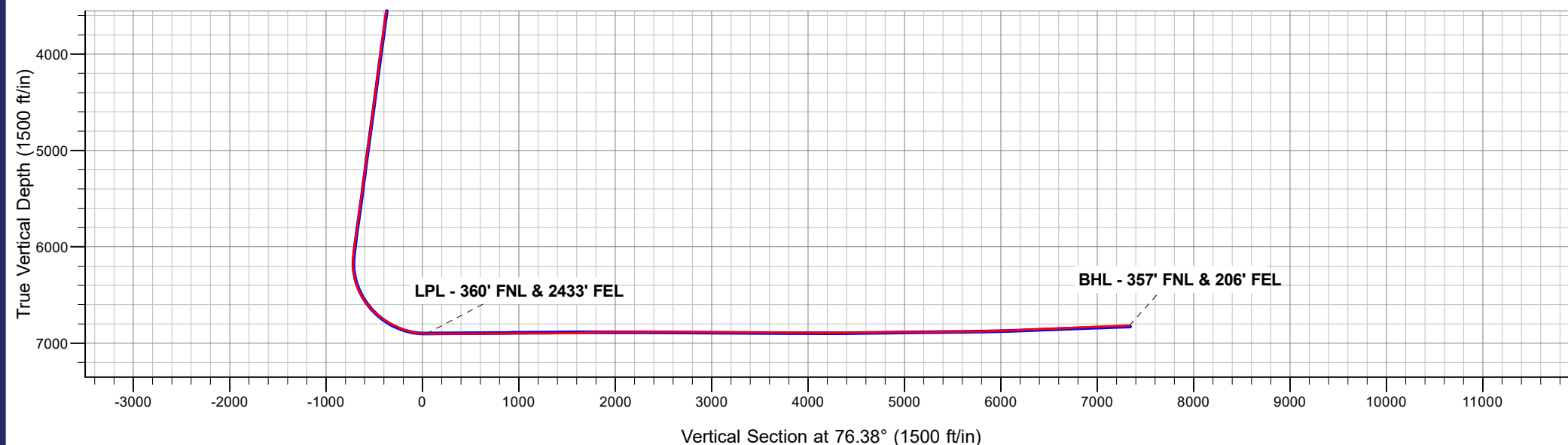
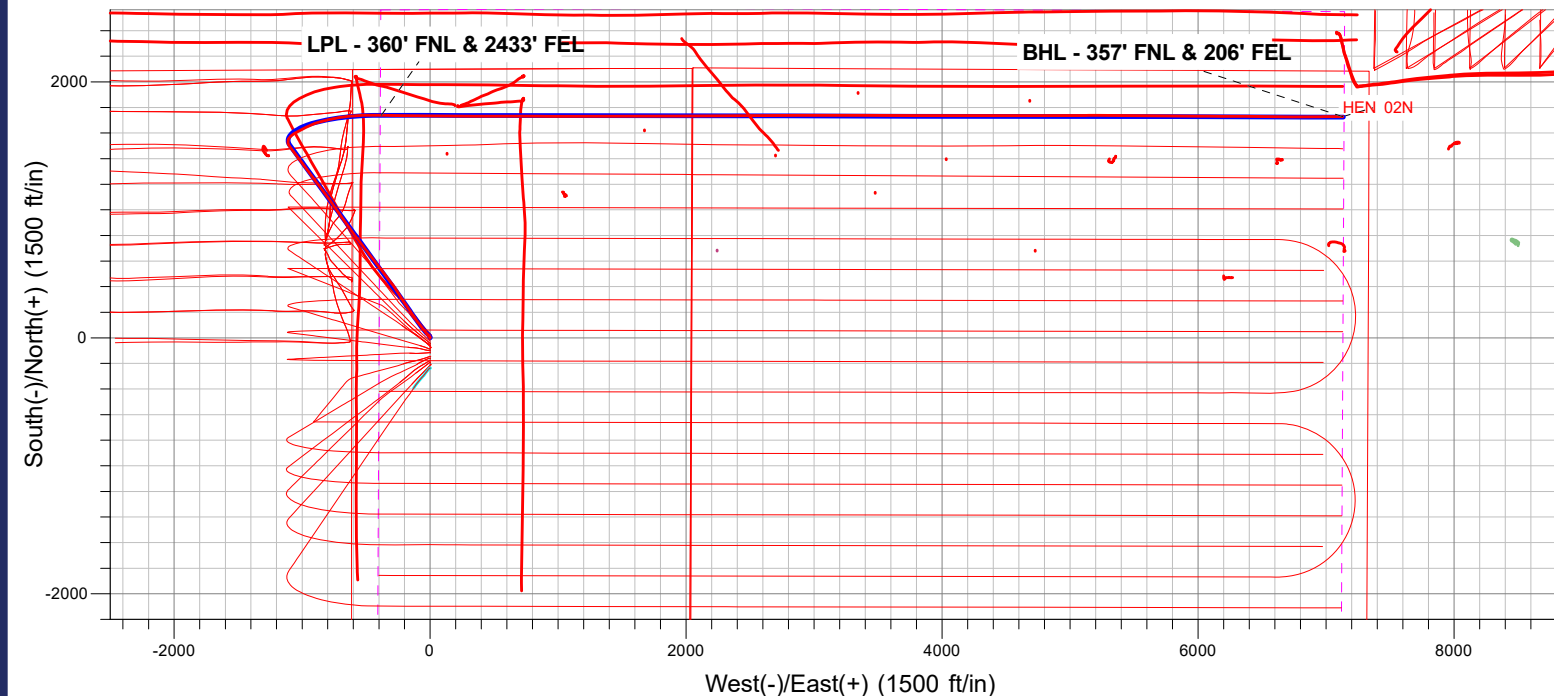

PDC Energy Inc. DJ Basin

SEC.8-T4N-R64W

Hen Pad

HEN 02N

HEN 02N

Design: HEN 02N Final Surveys

Standard Survey Report

17 August, 2023

Ensign

Survey Report

Company: PDC Energy Inc. DJ Basin	Local Co-ordinate Reference: Well HEN 02N
Project: SEC.8-T4N-R64W	TVD Reference: Well @ 4807.5ft (P272 - RKB 28.5')
Site: Hen Pad	MD Reference: Well @ 4807.5ft (P272 - RKB 28.5')
Well: HEN 02N	North Reference: True
Wellbore: HEN 02N	Survey Calculation Method: Minimum Curvature
Design: HEN 02N Final Surveys	Database: US_EDM

Project SEC.8-T4N-R64W, Weld County, Colorado	
Map System: US State Plane 1983	System Datum: Mean Sea Level
Geo Datum: North American Datum 1983	
Map Zone: Colorado Northern Zone	Using geodetic scale factor

Site Hen Pad	
Site Position:	Northing: 1,363,685.50 usft
From: Lat/Long	Easting: 3,258,631.47 usft
Position Uncertainty: 0.0 ft	Slot Radius: 13-3/16 "
	Latitude: 40.328004
	Longitude: -104.572344
	Grid Convergence: 0.60 °

Well HEN 02N	
Well Position +N/-S 0.0 ft	Northing: 1,363,818.78 usft
+E/-W 0.0 ft	Easting: 3,258,628.40 usft
Position Uncertainty 0.0 ft	Wellhead Elevation: ft
	Latitude: 40.328370
	Longitude: -104.572350
	Ground Level: 4,779.0 ft

Wellbore HEN 02N					
Magnetics	Model Name	Sample Date	Declination (°)	Dip Angle (°)	Field Strength (nT)
	HRGM	08/08/2023	7.68	66.58	51,711.46863185

Design HEN 02N Final Surveys				
Audit Notes:				
Version: 1.0	Phase: ACTUAL			
	Tie On Depth: 0.0			
Vertical Section:	Depth From (TVD) (ft)	+N/-S (ft)	+E/-W (ft)	Direction (°)
	0.0	0.0	0.0	76.38

Survey Program		Date 08/17/2023
From (ft)	To (ft)	Survey (Wellbore)
159.5	15,174.0	Survey #1 (HEN 02N)
		Tool Name
		MWD
		Description
		MWD - Standard

Survey										
Measured Depth (ft)	Inclination (°)	Azimuth (°)	Vertical Depth (ft)	+N/-S (ft)	+E/-W (ft)	Vertical Section (ft)	Dogleg Rate (°/100usft)	Build Rate (°/100usft)	Turn Rate (°/100usft)	
0.0	0.00	0.00	0.0	0.0	0.0	0.0	0.00	0.00	0.00	
159.5	1.32	45.66	159.5	1.3	1.3	1.6	0.83	0.83	0.00	
249.5	0.44	25.44	249.5	2.3	2.2	2.7	1.02	-0.98	-22.47	
340.5	1.49	317.94	340.5	3.5	1.6	2.3	1.52	1.15	-74.18	
456.5	3.43	326.03	456.4	7.5	-1.4	0.4	1.69	1.67	6.97	
545.5	3.61	329.37	545.2	12.1	-4.3	-1.3	0.31	0.20	3.75	
629.5	5.72	322.69	628.9	17.7	-8.2	-3.8	2.59	2.51	-7.95	
715.5	8.35	316.19	714.2	25.7	-15.1	-8.6	3.19	3.06	-7.56	
801.5	10.02	311.44	799.1	35.1	-25.0	-16.1	2.13	1.94	-5.52	
888.5	11.61	318.47	884.6	46.7	-36.5	-24.5	2.37	1.83	8.08	

Ensign

Survey Report

Company:	PDC Energy Inc. DJ Basin	Local Co-ordinate Reference:	Well HEN 02N
Project:	SEC.8-T4N-R64W	TVD Reference:	Well @ 4807.5ft (P272 - RKB 28.5')
Site:	Hen Pad	MD Reference:	Well @ 4807.5ft (P272 - RKB 28.5')
Well:	HEN 02N	North Reference:	True
Wellbore:	HEN 02N	Survey Calculation Method:	Minimum Curvature
Design:	HEN 02N Final Surveys	Database:	US_EDM

Survey										
Measured Depth (ft)	Inclination (°)	Azimuth (°)	Vertical Depth (ft)	+N/-S (ft)	+E/-W (ft)	Vertical Section (ft)	Dogleg Rate (°/100usft)	Build Rate (°/100usft)	Turn Rate (°/100usft)	
977.5	12.66	321.28	971.6	61.0	-48.6	-32.8	1.35	1.18	3.16	
1,066.5	15.12	321.46	1,058.0	77.7	-61.9	-41.9	2.76	2.76	0.20	
1,151.5	16.71	321.81	1,139.7	96.0	-76.4	-51.6	1.87	1.87	0.41	
1,237.5	18.38	324.10	1,221.7	116.7	-92.0	-61.9	2.10	1.94	2.66	
1,322.5	18.64	324.80	1,302.3	138.6	-107.6	-72.0	0.40	0.31	0.82	
1,407.5	19.70	324.98	1,382.6	161.4	-123.7	-82.2	1.25	1.25	0.21	
1,495.5	20.49	326.21	1,465.3	186.4	-140.8	-92.9	1.02	0.90	1.40	
1,582.5	20.58	325.50	1,546.7	211.7	-157.9	-103.6	0.30	0.10	-0.82	
1,671.5	20.05	325.68	1,630.2	237.1	-175.4	-114.6	0.60	-0.60	0.20	
1,698.5	19.61	325.33	1,655.6	244.7	-180.6	-117.9	1.69	-1.63	-1.30	
1,796.0	19.82	326.00	1,747.4	271.9	-199.1	-129.5	0.32	0.22	0.69	
1,828.0	19.71	325.07	1,777.5	280.8	-205.2	-133.3	1.04	-0.34	-2.91	
1,926.0	19.91	328.17	1,869.7	308.5	-223.5	-144.6	1.09	0.20	3.16	
2,023.0	19.58	327.29	1,961.0	336.2	-241.0	-155.0	0.46	-0.34	-0.91	
2,120.0	18.98	327.21	2,052.6	363.1	-258.3	-165.5	0.62	-0.62	-0.08	
2,217.0	19.35	328.17	2,144.2	390.1	-275.3	-175.7	0.50	0.38	0.99	
2,315.0	19.21	322.49	2,236.7	416.6	-293.7	-187.3	1.92	-0.14	-5.80	
2,409.0	19.24	322.48	2,325.5	441.2	-312.6	-199.9	0.03	0.03	-0.01	
2,506.0	19.88	321.67	2,416.9	466.8	-332.5	-213.2	0.72	0.66	-0.84	
2,603.0	19.67	322.86	2,508.1	492.8	-352.6	-226.6	0.47	-0.22	1.23	
2,700.0	19.52	322.85	2,599.5	518.7	-372.2	-239.6	0.15	-0.15	-0.01	
2,797.0	20.24	322.43	2,690.7	544.9	-392.3	-252.9	0.76	0.74	-0.43	
2,894.0	19.52	322.65	2,782.0	571.1	-412.3	-266.2	0.75	-0.74	0.23	
2,991.0	19.87	322.59	2,873.3	597.1	-432.2	-279.4	0.36	0.36	-0.06	
3,088.0	18.29	321.44	2,965.0	622.1	-451.7	-292.5	1.67	-1.63	-1.19	
3,185.0	19.61	322.02	3,056.7	646.8	-471.2	-305.6	1.37	1.36	0.60	
3,283.0	19.30	322.83	3,149.1	672.7	-491.1	-318.9	0.42	-0.32	0.83	
3,379.0	19.30	322.07	3,239.7	697.8	-510.4	-331.7	0.26	0.00	-0.79	
3,477.0	19.44	322.82	3,332.2	723.6	-530.2	-344.9	0.29	0.14	0.77	
3,575.0	18.59	320.90	3,424.8	748.7	-549.9	-358.2	1.08	-0.87	-1.96	
3,672.0	19.65	322.48	3,516.5	773.6	-569.6	-371.4	1.22	1.09	1.63	
3,768.0	19.35	323.72	3,606.9	799.3	-588.9	-384.1	0.53	-0.31	1.29	
3,865.0	19.22	324.17	3,698.5	825.2	-607.7	-396.3	0.20	-0.13	0.46	
3,962.0	19.21	325.42	3,790.1	851.2	-626.1	-408.1	0.42	-0.01	1.29	
4,058.0	19.46	324.72	3,880.7	877.3	-644.3	-419.6	0.36	0.26	-0.73	
4,155.0	19.26	324.14	3,972.2	903.5	-663.0	-431.6	0.29	-0.21	-0.60	
4,252.0	19.65	324.72	4,063.7	929.7	-681.8	-443.7	0.45	0.40	0.60	
4,350.0	19.54	326.35	4,156.0	956.8	-700.4	-455.4	0.57	-0.11	1.66	
4,447.0	19.83	324.17	4,247.3	983.7	-719.0	-467.2	0.81	0.30	-2.25	
4,545.0	19.37	325.16	4,339.6	1,010.5	-738.1	-479.3	0.58	-0.47	1.01	
4,642.0	19.75	324.61	4,431.0	1,037.1	-756.7	-491.2	0.44	0.39	-0.57	
4,739.0	19.82	323.77	4,522.3	1,063.7	-775.9	-503.6	0.30	0.07	-0.87	
4,838.0	19.53	323.85	4,615.5	1,090.6	-795.6	-516.4	0.29	-0.29	0.08	
4,936.0	19.83	323.63	4,707.8	1,117.2	-815.1	-529.1	0.32	0.31	-0.22	

Ensign

Survey Report

Company:	PDC Energy Inc. DJ Basin	Local Co-ordinate Reference:	Well HEN 02N
Project:	SEC.8-T4N-R64W	TVD Reference:	Well @ 4807.5ft (P272 - RKB 28.5')
Site:	Hen Pad	MD Reference:	Well @ 4807.5ft (P272 - RKB 28.5')
Well:	HEN 02N	North Reference:	True
Wellbore:	HEN 02N	Survey Calculation Method:	Minimum Curvature
Design:	HEN 02N Final Surveys	Database:	US_EDM

Survey										
Measured Depth (ft)	Inclination (°)	Azimuth (°)	Vertical Depth (ft)	+N/-S (ft)	+E/-W (ft)	Vertical Section (ft)	Dogleg Rate (°/100usft)	Build Rate (°/100usft)	Turn Rate (°/100usft)	
5,033.0	19.15	323.26	4,799.3	1,143.2	-834.4	-541.7	0.71	-0.70	-0.38	
5,131.0	19.20	323.25	4,891.8	1,169.0	-853.7	-554.4	0.05	0.05	-0.01	
5,228.0	18.55	323.71	4,983.6	1,194.2	-872.4	-566.6	0.69	-0.67	0.47	
5,327.0	18.84	323.82	5,077.4	1,219.8	-891.1	-578.8	0.30	0.29	0.11	
5,425.0	18.54	323.86	5,170.2	1,245.2	-909.6	-590.8	0.31	-0.31	0.04	
5,522.0	18.40	322.63	5,262.2	1,269.8	-928.0	-602.9	0.43	-0.14	-1.27	
5,618.0	19.40	323.07	5,353.0	1,294.6	-946.8	-615.3	1.05	1.04	0.46	
5,716.0	19.53	322.81	5,445.4	1,320.6	-966.5	-628.3	0.16	0.13	-0.27	
5,813.0	19.74	323.65	5,536.8	1,346.7	-986.0	-641.1	0.36	0.22	0.87	
5,911.0	19.17	323.06	5,629.2	1,372.9	-1,005.5	-653.9	0.62	-0.58	-0.60	
6,008.0	19.38	323.06	5,720.8	1,398.5	-1,024.7	-666.6	0.22	0.22	0.00	
6,105.0	19.36	323.08	5,812.3	1,424.2	-1,044.0	-679.3	0.02	-0.02	0.02	
6,201.0	19.47	322.55	5,902.8	1,449.7	-1,063.3	-692.1	0.22	0.11	-0.55	
6,298.0	19.73	323.34	5,994.2	1,475.6	-1,082.9	-705.0	0.38	0.27	0.81	
6,395.0	17.67	325.86	6,086.1	1,500.9	-1,101.0	-716.6	2.28	-2.12	2.60	
6,493.0	15.94	354.15	6,180.0	1,526.7	-1,110.7	-720.0	8.44	-1.77	28.87	
6,591.0	15.66	22.59	6,274.5	1,552.3	-1,107.0	-710.3	7.83	-0.29	29.02	
6,688.0	18.49	44.42	6,367.3	1,575.4	-1,091.2	-689.5	7.17	2.92	22.51	
6,787.0	23.99	62.07	6,459.6	1,596.1	-1,062.4	-656.6	8.46	5.56	17.83	
6,884.0	33.85	63.17	6,544.4	1,617.6	-1,020.7	-611.1	10.18	10.16	1.13	
6,981.0	42.62	61.45	6,620.5	1,645.5	-967.7	-553.0	9.11	9.04	-1.77	
7,078.0	49.61	70.45	6,687.8	1,673.6	-903.9	-484.3	9.82	7.21	9.28	
7,175.0	55.13	76.93	6,747.1	1,695.0	-830.2	-407.7	7.77	5.69	6.68	
7,272.0	60.88	78.84	6,798.4	1,712.3	-749.8	-325.5	6.16	5.93	1.97	
7,370.0	65.84	81.13	6,842.4	1,727.4	-663.6	-238.1	5.47	5.06	2.34	
7,468.0	73.79	86.34	6,876.2	1,737.4	-572.2	-147.0	9.52	8.11	5.32	
7,565.0	83.43	90.39	6,895.3	1,740.0	-477.3	-54.1	10.75	9.94	4.18	
7,655.0	89.59	91.20	6,900.8	1,738.8	-387.5	32.9	6.90	6.85	0.90	
EP - HEN 02N - 360° FNL & 2440° FEL										
7,662.0	90.07	91.26	6,900.8	1,738.6	-380.5	39.6	6.90	6.85	0.89	
LPL - 360° FNL & 2433° FEL										
7,760.0	89.85	91.08	6,900.9	1,736.6	-282.5	134.3	0.29	-0.22	-0.18	
7,857.0	89.88	90.26	6,901.1	1,735.5	-185.6	228.3	0.85	0.03	-0.85	
7,993.0	90.02	90.76	6,901.2	1,734.3	-49.6	360.2	0.38	0.10	0.37	
8,092.0	89.96	90.50	6,901.2	1,733.2	49.4	456.2	0.27	-0.06	-0.26	
8,190.0	90.71	90.64	6,900.7	1,732.2	147.4	551.2	0.78	0.77	0.14	
8,286.0	90.75	89.63	6,899.4	1,732.0	243.4	644.4	1.05	0.04	-1.05	
8,385.0	90.01	90.03	6,898.8	1,732.3	342.4	740.7	0.85	-0.75	0.40	
8,482.0	89.68	90.02	6,899.0	1,732.2	439.4	835.0	0.34	-0.34	-0.01	
8,579.0	90.35	90.05	6,899.0	1,732.2	536.4	929.2	0.69	0.69	0.03	
8,677.0	90.48	89.81	6,898.3	1,732.3	634.4	1,024.5	0.28	0.13	-0.24	
8,775.0	89.93	90.16	6,898.0	1,732.3	732.4	1,119.7	0.67	-0.56	0.36	
8,872.0	90.09	90.40	6,897.9	1,731.8	829.4	1,213.9	0.30	0.16	0.25	

Ensign

Survey Report

Company:	PDC Energy Inc. DJ Basin	Local Co-ordinate Reference:	Well HEN 02N
Project:	SEC.8-T4N-R64W	TVD Reference:	Well @ 4807.5ft (P272 - RKB 28.5')
Site:	Hen Pad	MD Reference:	Well @ 4807.5ft (P272 - RKB 28.5')
Well:	HEN 02N	North Reference:	True
Wellbore:	HEN 02N	Survey Calculation Method:	Minimum Curvature
Design:	HEN 02N Final Surveys	Database:	US_EDM

Survey									
Measured Depth (ft)	Inclination (°)	Azimuth (°)	Vertical Depth (ft)	+N/-S (ft)	+E/-W (ft)	Vertical Section (ft)	Dogleg Rate (°/100usft)	Build Rate (°/100usft)	Turn Rate (°/100usft)
8,969.0	90.71	90.19	6,897.3	1,731.3	926.4	1,308.1	0.67	0.64	-0.22
9,068.0	90.59	90.33	6,896.1	1,730.9	1,025.4	1,404.2	0.19	-0.12	0.14
9,166.0	90.35	90.05	6,895.3	1,730.6	1,123.4	1,499.3	0.38	-0.24	-0.29
9,265.0	91.87	89.80	6,893.4	1,730.7	1,222.4	1,595.6	1.56	1.54	-0.25
9,363.0	91.52	89.94	6,890.5	1,730.9	1,320.3	1,690.8	0.38	-0.36	0.14
9,461.0	91.76	89.96	6,887.7	1,731.0	1,418.3	1,786.0	0.25	0.24	0.02
9,560.0	91.85	89.34	6,884.6	1,731.6	1,517.2	1,882.3	0.63	0.09	-0.63
9,565.2	91.82	89.34	6,884.4	1,731.7	1,522.4	1,887.4	0.67	-0.66	0.05
HEN 02N - WP#1									
9,655.0	91.22	89.39	6,882.1	1,732.7	1,612.2	1,974.9	0.67	-0.66	0.05
9,754.0	90.13	91.25	6,880.9	1,732.1	1,711.2	2,070.9	2.18	-1.10	1.88
9,851.0	89.68	89.46	6,881.1	1,731.5	1,808.2	2,165.1	1.90	-0.46	-1.85
9,947.0	89.98	89.17	6,881.3	1,732.7	1,904.2	2,258.6	0.43	0.31	-0.30
10,044.0	89.58	89.86	6,881.7	1,733.5	2,001.2	2,353.1	0.82	-0.41	0.71
10,142.0	89.85	89.73	6,882.2	1,733.8	2,099.2	2,448.4	0.31	0.28	-0.13
10,239.0	89.07	90.09	6,883.1	1,734.0	2,196.2	2,542.7	0.89	-0.80	0.37
10,336.0	89.67	89.59	6,884.2	1,734.3	2,293.1	2,637.1	0.81	0.62	-0.52
10,434.0	89.92	89.40	6,884.5	1,735.1	2,391.1	2,732.5	0.32	0.26	-0.19
10,531.0	89.38	89.88	6,885.1	1,735.7	2,488.1	2,826.9	0.74	-0.56	0.49
10,628.0	89.77	89.49	6,885.8	1,736.3	2,585.1	2,921.3	0.57	0.40	-0.40
10,726.0	90.08	89.53	6,886.0	1,737.1	2,683.1	3,016.7	0.32	0.32	0.04
10,824.0	89.63	90.16	6,886.2	1,737.4	2,781.1	3,112.0	0.79	-0.46	0.64
10,922.0	90.06	88.98	6,886.5	1,738.1	2,879.1	3,207.5	1.28	0.44	-1.20
11,116.0	89.15	90.55	6,887.8	1,738.9	3,073.1	3,396.2	0.94	-0.47	0.81
11,212.0	89.99	89.61	6,888.5	1,738.8	3,169.1	3,489.4	1.31	0.88	-0.98
11,308.0	89.85	90.23	6,888.7	1,738.9	3,265.1	3,582.8	0.66	-0.15	0.65
11,405.0	89.82	90.19	6,889.0	1,738.5	3,362.1	3,677.0	0.05	-0.03	-0.04
11,601.0	89.87	90.19	6,889.5	1,737.9	3,558.1	3,867.3	0.03	0.03	0.00
11,698.0	89.14	90.53	6,890.3	1,737.3	3,655.1	3,961.4	0.83	-0.75	0.35
11,796.0	89.30	90.12	6,891.7	1,736.7	3,753.1	4,056.5	0.45	0.16	-0.42
11,892.0	89.66	90.06	6,892.5	1,736.6	3,849.1	4,149.8	0.38	0.38	-0.06
11,989.0	90.37	90.63	6,892.5	1,736.0	3,946.1	4,243.9	0.94	0.73	0.59
12,003.1	90.42	90.51	6,892.4	1,735.8	3,960.2	4,257.6	0.95	0.36	-0.88
HEN 02N - WP#2									
12,086.0	90.72	89.78	6,891.6	1,735.6	4,043.1	4,338.1	0.95	0.36	-0.88
12,184.0	90.95	89.94	6,890.2	1,735.9	4,141.1	4,433.4	0.29	0.23	0.16
12,280.0	90.07	90.19	6,889.3	1,735.8	4,237.1	4,526.6	0.95	-0.92	0.26
12,375.0	90.86	89.98	6,888.5	1,735.6	4,332.0	4,618.9	0.86	0.83	-0.22
12,472.0	90.16	90.22	6,887.7	1,735.5	4,429.0	4,713.2	0.76	-0.72	0.25
12,569.0	90.97	89.16	6,886.7	1,736.0	4,526.0	4,807.6	1.38	0.84	-1.09
12,765.0	90.40	90.27	6,884.4	1,737.0	4,722.0	4,998.3	0.64	-0.29	0.57
12,862.0	90.13	90.18	6,883.9	1,736.6	4,819.0	5,092.4	0.29	-0.28	-0.09
12,959.0	90.54	90.33	6,883.3	1,736.1	4,916.0	5,186.6	0.45	0.42	0.15
13,057.0	90.70	90.61	6,882.3	1,735.3	5,014.0	5,281.6	0.33	0.16	0.29

Ensign

Survey Report

Company:	PDC Energy Inc. DJ Basin	Local Co-ordinate Reference:	Well HEN 02N
Project:	SEC.8-T4N-R64W	TVD Reference:	Well @ 4807.5ft (P272 - RKB 28.5')
Site:	Hen Pad	MD Reference:	Well @ 4807.5ft (P272 - RKB 28.5')
Well:	HEN 02N	North Reference:	True
Wellbore:	HEN 02N	Survey Calculation Method:	Minimum Curvature
Design:	HEN 02N Final Surveys	Database:	US_EDM

Survey										
Measured Depth (ft)	Inclination (°)	Azimuth (°)	Vertical Depth (ft)	+N/-S (ft)	+E/-W (ft)	Vertical Section (ft)	Dogleg Rate (°/100usft)	Build Rate (°/100usft)	Turn Rate (°/100usft)	
13,155.0	90.56	87.87	6,881.2	1,736.6	5,112.0	5,377.2	2.80	-0.14	-2.80	
13,254.0	90.31	90.33	6,880.5	1,738.2	5,211.0	5,473.7	2.50	-0.25	2.48	
13,352.0	90.39	90.12	6,879.9	1,737.8	5,309.0	5,568.9	0.23	0.08	-0.21	
13,450.0	90.93	90.95	6,878.7	1,736.9	5,406.9	5,663.9	1.01	0.55	0.85	
13,546.0	90.26	90.80	6,877.7	1,735.4	5,502.9	5,756.8	0.72	-0.70	-0.16	
13,642.0	91.89	90.52	6,875.9	1,734.3	5,598.9	5,849.9	1.72	1.70	-0.29	
13,695.5	91.95	90.37	6,874.1	1,733.9	5,652.3	5,901.7	0.30	0.11	-0.28	
HEN 02N - WP#3										
13,741.0	92.00	90.24	6,872.6	1,733.7	5,697.8	5,945.9	0.30	0.11	-0.28	
13,837.0	92.14	90.25	6,869.1	1,733.3	5,793.8	6,039.0	0.15	0.15	0.01	
13,935.0	92.00	90.31	6,865.6	1,732.8	5,891.7	6,134.1	0.16	-0.14	0.06	
14,030.0	92.23	90.39	6,862.1	1,732.2	5,986.6	6,226.2	0.26	0.24	0.08	
14,127.0	91.97	90.42	6,858.5	1,731.5	6,083.6	6,320.2	0.27	-0.27	0.03	
14,223.0	92.29	90.44	6,854.9	1,730.8	6,179.5	6,413.3	0.33	0.33	0.02	
14,417.0	92.30	90.49	6,847.2	1,729.2	6,373.3	6,601.3	0.03	0.01	0.03	
14,515.0	92.71	90.31	6,842.9	1,728.5	6,471.2	6,696.3	0.46	0.42	-0.18	
14,612.0	92.74	90.54	6,838.3	1,727.8	6,568.1	6,790.3	0.24	0.03	0.24	
14,708.0	92.41	90.40	6,834.0	1,727.0	6,664.0	6,883.3	0.37	-0.34	-0.15	
14,806.0	92.09	90.79	6,830.1	1,726.0	6,762.0	6,978.2	0.51	-0.33	0.40	
14,903.0	92.18	90.21	6,826.5	1,725.2	6,858.9	7,072.2	0.60	0.09	-0.60	
15,000.0	91.87	87.77	6,823.1	1,726.9	6,955.8	7,166.8	2.53	-0.32	-2.52	
15,097.0	92.38	90.78	6,819.5	1,728.1	7,052.7	7,261.3	3.15	0.53	3.10	
15,141.0	92.83	90.30	6,817.5	1,727.7	7,096.7	7,303.9	1.49	1.02	-1.09	
15,174.0	92.83	90.30	6,815.8	1,727.5	7,129.6	7,335.9	0.00	0.00	0.00	
BHL - 357' FNL & 206' FEL - BHL - HEN 02N - 360' FNL & 200' FEL										

Design Annotations					
Measured Depth (ft)	Vertical Depth (ft)	Local Coordinates		Comment	
		+N/-S (ft)	+E/-W (ft)		
7,662.0	6,900.8	1,738.6	-380.5	LPL - 360' FNL & 2433' FEL	
15,174.0	6,815.8	1,727.5	7,129.6	BHL - 357' FNL & 206' FEL	

Checked By: _____	Approved By: _____	Date: _____
-------------------	--------------------	-------------