

Operator: BONANZA CREEK ENERGY OPERATING COMPANY LLC

Location Name: Antelope B-33 Pad

Loc ID: 432287

Inspection: 713900095



Exhibit A

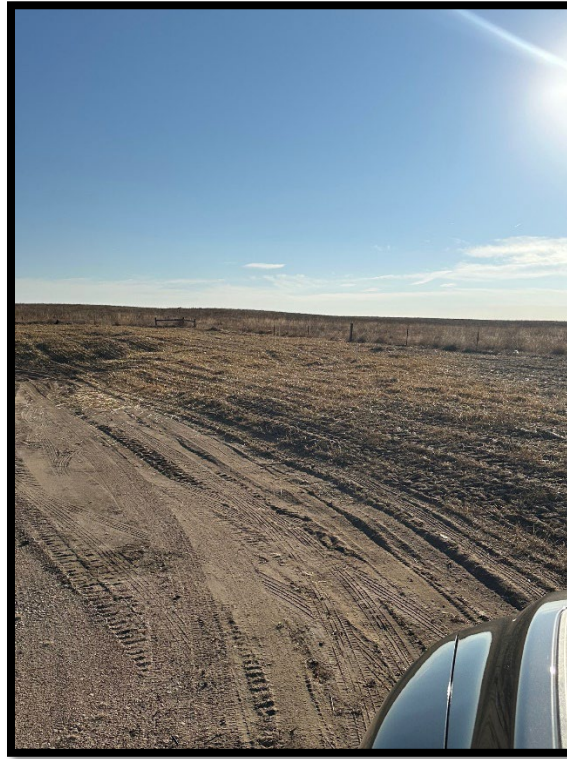

Exhibit B



Exhibit C

CA: Weed debris in the form of tumbleweeds were observed along the perimeter fence of the location. Tumbleweeds are a troublesome annual non-native weed that easily breaks off at the stem. Operator failed to control and manage weeds to prevent weed waste and prevent the spread of seeds onto adjacent lands. Comply with Rule 606 to remove weed debris.

CA Resolution: Operator has addressed and cleared weed debris and mowed location to comply with Rule 606.

CA: Boards and stakes left across the location area. Refer to photo 8 as an example. Comply with Rule 606.

CA Resolution: Operator has addressed and removed identified trash/unused equipment on location to comply with Rule 606.

CA: Multiple areas of stained soil within gravel berm around risers. Comply with Rule 912.a.

CA Resolution: Operator has addressed and cleaned/properly disposed of stained soil to comply with Rule 912.a.

CA: Interim reclamation activities have been performed to reduce disturbance areas only needed for production operations. Vegetation throughout the interim areas was mowed and has not met Rule 1003 standards. In addition, large areas of bare soil were observed along the South, West and east edges of the location and are not stabilized, impacted by wheel tracking as well. Perform reclamation in accordance with Rule 1003. Establish vegetation with total perennial, non-invasive uniform plant cover of at least eighty (80) percent of reference area levels. Use a seed mixture requested by the surface owner, or a mixture prescribed by the local county NRCS. Ensure erosion controls are implemented to stabilize the seeded soil and continue to monitor and manage this site until the location meets Rule 1003 standards, including stormwater and weed management.

CA Resolution: Operator has reported that identified areas have been crimped to help prevent regrowth of undesirable vegetation and bare areas have been reseeded. It has also been noted that the perimeter berms have been maintained and stabilized.