



MOFFAT ENGINEERING SERVICES

Gunbarrel Business Park
6395 Gunpark Drive — Penthouse
Boulder, Colorado 80301

303-530-0608

RECEIVED

JUL 29 1981

COLO. OIL & GAS CONS. COMM.

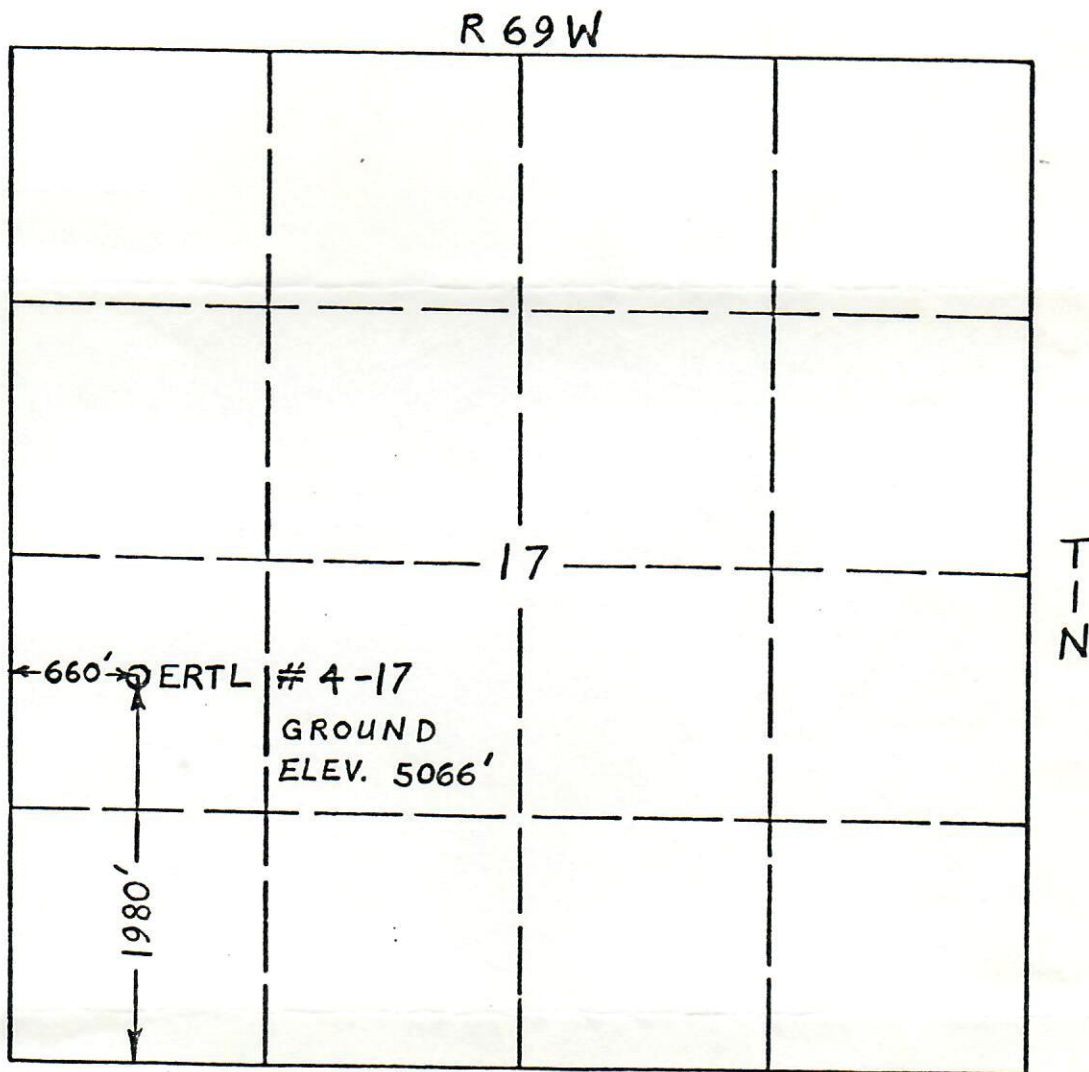

Moffat Engineering has in accordance with a request from Martin Exploration Management Corp., determined the location of their ERTL #4-17 to be 1980' FSL, 660' FWL, Section 17 (NW $\frac{1}{4}$ of SW $\frac{1}{4}$), Township 1 North, Range 69 West, Boulder County, Colorado.



00037665

Reese McKay