

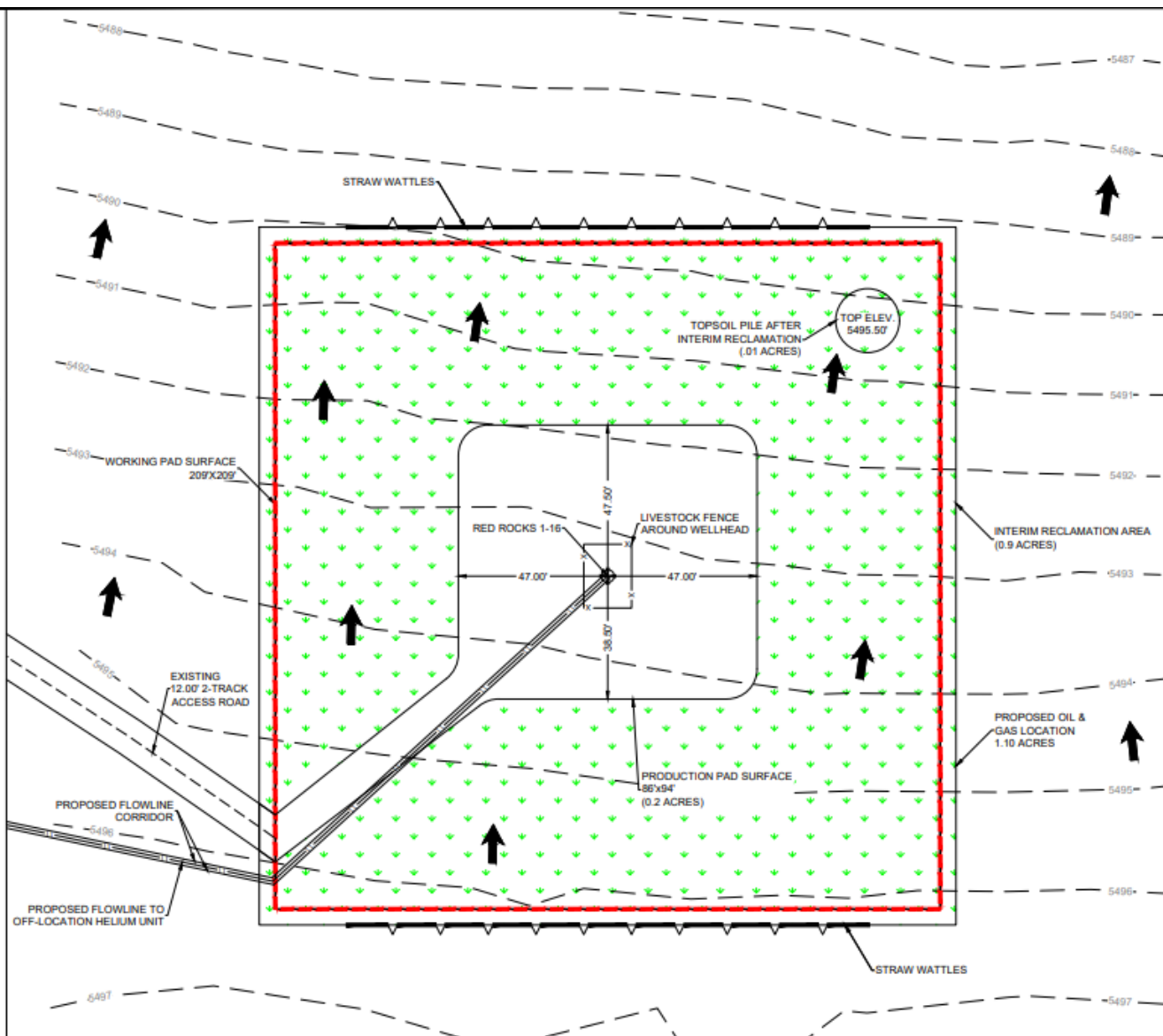

- EXISTING 1" CONTOUR
- EXISTING 5" CONTOUR
- PROPOSED FLOWLINE
- WORKING PAD SURFACE
- STRAW WATTLES
- WELLHEAD
- INTERIM RECLAMATION AREA
- DRAINAGE

WELLHEAD ELEVATIONS
 ELEVATION: 5,493.37'
 3 ELEVATION: 5,493.37'

ACREAGES:
 LOCATION (AC): 1.10
 PAD SURFACE (AC): 0.25
 INTERIM RECLAMATION (AC): 0.90
 ACCESS ROAD (AC): 1.35
 CORRIDOR (AC): 0.10



FACILITY LAYOUT

RED ROCKS 1-16 LAS ANIMAS COUNTY
 NE 1/4 NE 1/4 SEC. 1 T30S R55W 6TH P.M.

DESERT EAGLE OPERATING

PRELIMINARY, THIS DOCUMENT SHALL NOT BE RECORDED FOR ANY PURPOSE AND SHALL NOT BE USED OR VIEWED OR RELIED UPON AS A FINAL ENGINEERING OR SURVEY DOCUMENT.

DATE:	10/07/2022
DRAWN BY:	TJM
REVIEWED BY:	CCC
SCALE:	1" = 30'
SHEET:	4 OF 4
REVISION:	
XXX	XXXXXX
XXX	XXXXXX
XXX	XXXXXX