



FORM F-106



RECEIVED

JUL 20 1984

COLO. OIL & GAS CONS. COMM.

N

R. 50 W

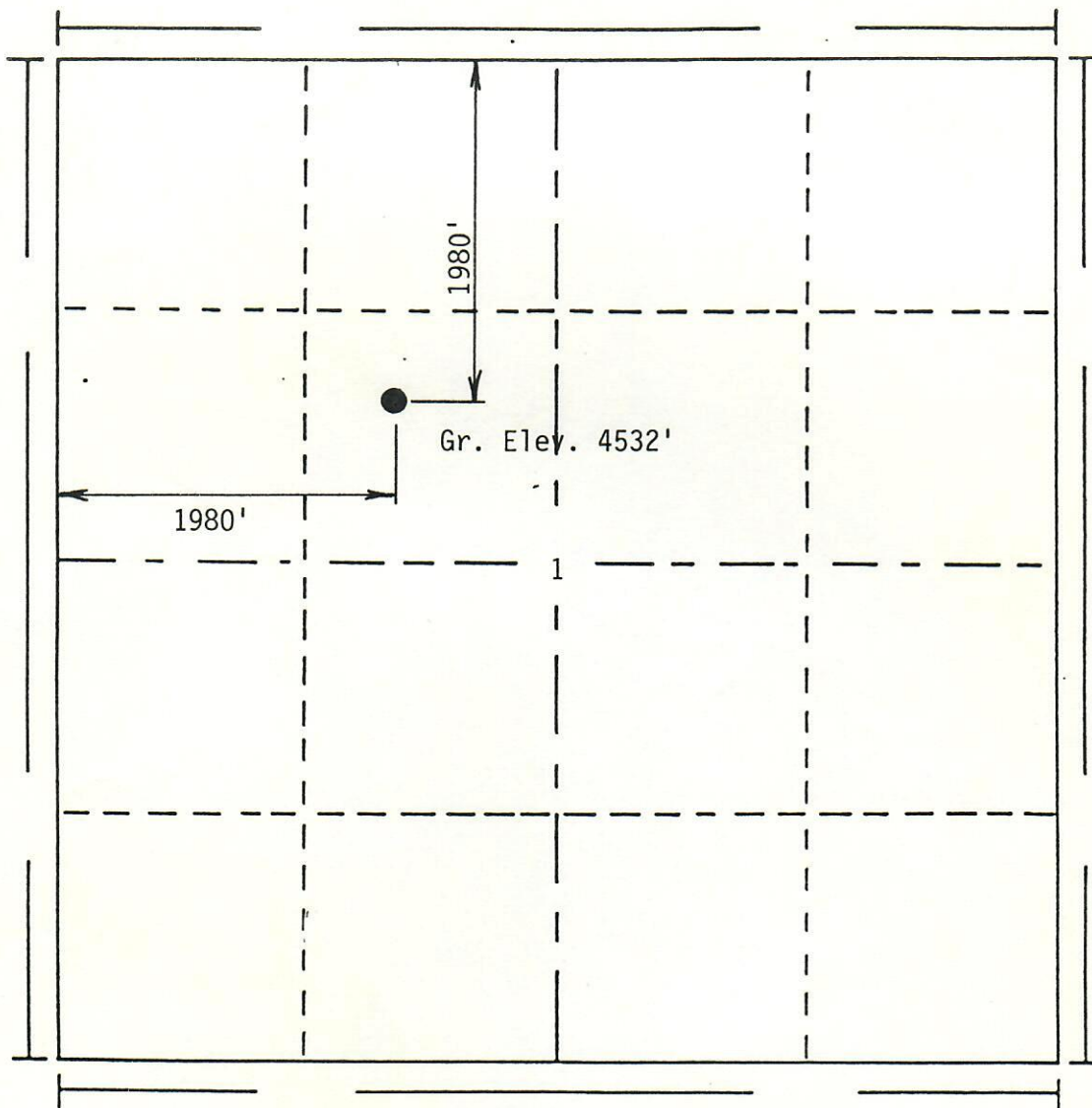

Scale... 1" = 1000'

Powers Elevation of Denver, Colorado
has in accordance with a request from Mr. Poulain
for Phillips Petroleum
determined the location of #1 Wilkerson "D"
to be 1980' FN & 1980' FW
Range 50 W of the 6th Principal
Cheyenne County, Colorado

Section 1 Township 14 S
Meridian

I hereby certify that this plat is an
accurate representation of a correct
survey showing the location of #1 Wilkerson "D"

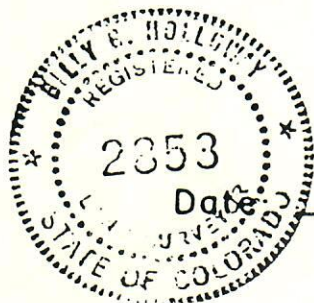

July 14, 1984

Billy E. Hollenby
Licensed Land Surveyor No. 2853
State of Colorado