

SWNE of Section 28  
Township 5 South, Range 97 West, 6th P.M.

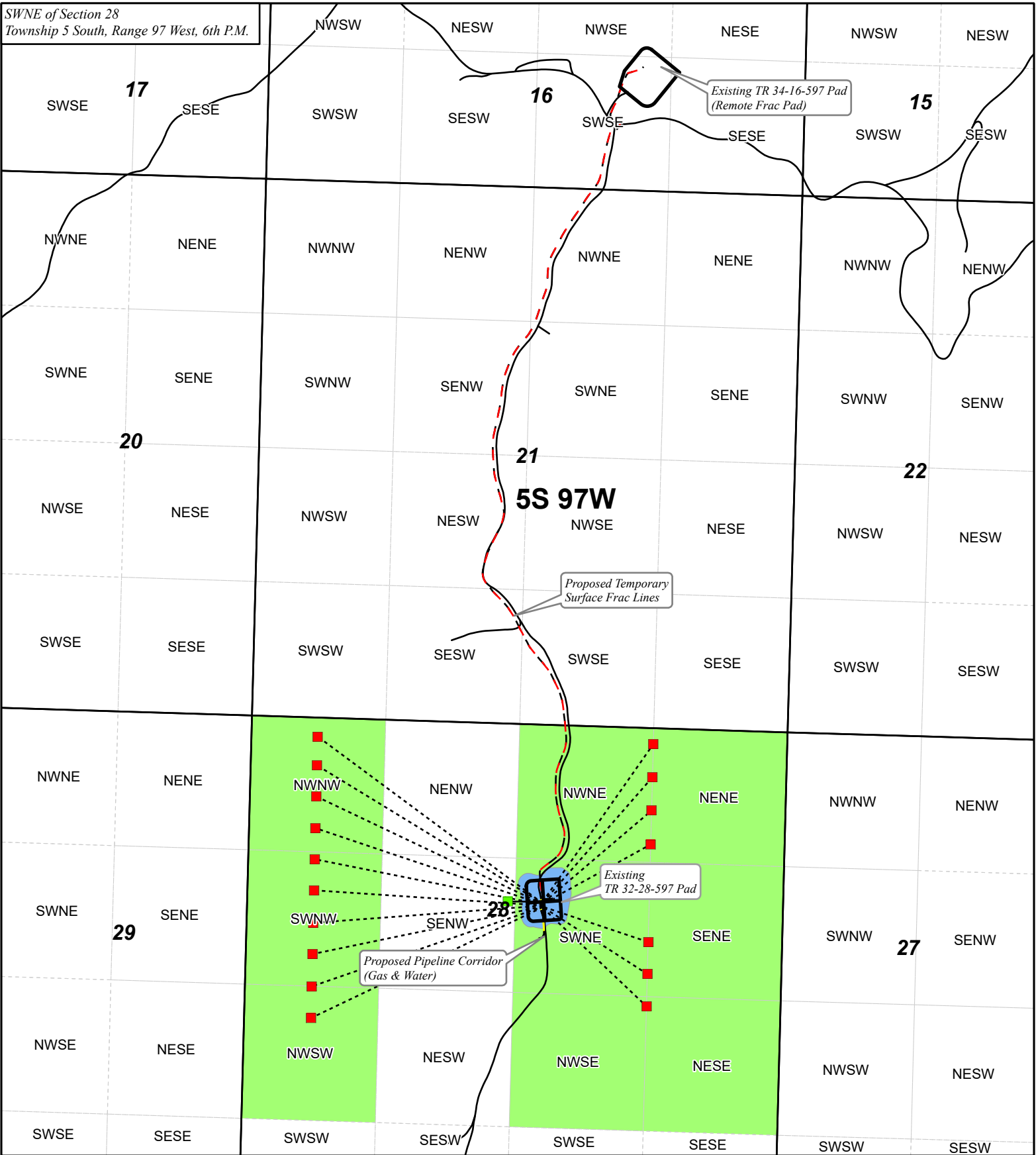

- Legend**
- Existing Gas Well BHL
  - Future Gas Well BHL
  - Proposed Working Pad Surface
  - Proposed Pipeline Corridor
  - Proposed Frac Lines (5-4.5")
  - Existing Access Road
  - Mineral Development (360ac)
  - Surface Lands (5.778ac)
  - Township
  - Section
  - Qtr/Qtr

**TEP Rocky Mountain LLC**  
**TR 32-28-597 OGD**  
**Oil and Gas Development Plan**  
**Application Lands**

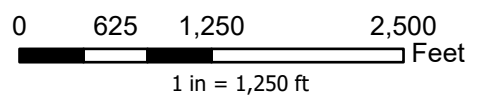
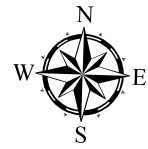

**April 13, 2023**