

FACILITY PAD - WINDOM 5N67W24 1-46
DESIGN SUMMARY

PAD QUANTITIES AND DESIGN PARAMETERS

CUT SLOPES = 3:1
FILL SLOPES = 3:1
SHRINKAGE FACTOR = 1.10
SWELL FACTOR = 1.00
GRADED FACILITY PAD AREA = 5.78 ACRES
TOTAL FACILITY PAD AREA = 6.60 ACRES

FACILITY PAD QUANTITIES

TOTAL CUT FOR FACILITY PAD = 18,911 C.Y.
TOTAL FILL FOR FACILITY PAD = 18,911 C.Y.
TOPSOIL @ 10" DEPTH = 8,837 C.Y.
IMPORT MATERIAL = 0 C.Y.

ROAD BASE MATERIAL VOLUME
TO BE ADDED TO FACILITY PAD = 4,664 C.Y.
(ASSUMING 6" DEPTH)

MLVT PAD - WINDOM 5N67W24 1-46
DESIGN SUMMARY

PAD QUANTITIES AND DESIGN PARAMETERS

FINISHED GRADE ELEVATION = 5014.7'
CUT SLOPES = 3:1
FILL SLOPES = 3:1
SHRINKAGE FACTOR = 1.10
SWELL FACTOR = 1.00
GRADED MLVT PAD AREA = 0.80 ACRES
TOTAL MLVT PAD AREA = 0.96 ACRES

MLVT PAD QUANTITIES

TOTAL CUT FOR MLVT PAD = 1,255 C.Y.
TOTAL FILL FOR MLVT PAD = 1,255 C.Y.
TOPSOIL @ 10" DEPTH = 1,279 C.Y.
IMPORT MATERIAL = 0 C.Y.

WELL NAME	FINISHED GRADE (FT)	EXISTING GRADE (FT)	C/F
WINDOM 01N	5000.5	4996.3	F4.2
WINDOM 02C	5000.5	4997.2	F3.3
WINDOM 03N	5000.5	4998.0	F2.5
WINDOM 04NA	5000.5	4998.7	F1.8
WINDOM 05N	5000.5	4999.3	F1.2
WINDOM 06N	5000.5	5000.0	F0.5
WINDOM 07C	5000.5	5000.7	C0.2
WINDOM 08N	5000.5	5001.3	C0.8
WINDOM 09N	5000.5	5001.7	C1.2
WINDOM 10NA	5000.5	5002.1	C1.6
WINDOM 11N	5000.5	5002.5	C2.0
WINDOM 12N	5000.5	5002.9	C2.4
WINDOM 13NA	5000.5	5003.3	C2.8
WINDOM 14N	5000.5	5003.8	C3.3
WINDOM 15N	5000.5	5004.1	C3.6
WINDOM 16C	5000.5	5004.3	C3.8
WINDOM 17N	5000.5	5004.8	C4.3
WINDOM 18N	5000.5	5005.1	C4.6
WINDOM 19NA	5000.5	5005.5	C5.0
WINDOM 20N	5000.5	5005.8	C5.3
WINDOM 21N	5000.5	5006.1	C5.6
WINDOM 22N	5000.5	5006.3	C5.8
WINDOM 23N	5000.5	5006.5	C6.0
WINDOM 24N	5000.5	5006.8	C6.3
WINDOM 25NA	5000.8	4996.2	F4.6
WINDOM 26N	5000.8	4996.9	F3.9
WINDOM 27N	5000.8	4997.7	F3.1
WINDOM 28C	5000.8	4998.3	F2.5
WINDOM 29N	5000.8	4998.9	F1.9
WINDOM 30N	5000.8	4999.6	F1.2
WINDOM 31NA	5000.8	5000.2	F0.6
WINDOM 32N	5000.8	5000.9	C0.1
WINDOM 33N	5000.8	5001.6	C0.8
WINDOM 34C	5000.8	5002.2	C1.4
WINDOM 35N	5000.8	5002.8	C2.0
WINDOM 36N	5000.8	5003.4	C2.6
WINDOM 37NA	5000.8	5003.9	C3.1
WINDOM 38N	5000.8	5004.4	C3.6
WINDOM 39N	5000.8	5004.8	C4.0
WINDOM 40C	5000.8	5005.3	C4.5
WINDOM 41N	5000.8	5005.7	C4.9
WINDOM 42N	5000.8	5006.2	C5.4
WINDOM 43NA	5000.8	5006.4	C5.6
WINDOM 44N	5000.8	5006.8	C6.0
WINDOM 45C	5000.8	5007.1	C6.3
WINDOM 46N	5000.8	5007.5	C6.7

NOTE:

- AFTER COMPLETION OF WELL PAD GRADING, PLATING MATERIAL WILL BE PLACED AT A DEPTH OF 6 INCHES AND COMPACTED USING MOBILE EQUIPMENT.
- EXISTING UTILITIES DISPLAYED ON THE GRADING PLAN ARE FOR REFERENCE PURPOSES ONLY. PRIOR TO CONSTRUCTION OR EARTHWORK, CONTRACTOR WILL BE RESPONSIBLE TO CALL FOR LOCATES: (800) 922-1987
- DIVERSION DITCH AND BERM TO BE CONSTRUCTED AROUND THE ENTIRE LOCATION. BERM SECTIONS TO BE COMPACTED IN ACCORDANCE WITH STANDARD CONSTRUCTION PRACTICES.
- CENTER OF WELL PAD REFERENCED BELOW CORRESPONDS TO THE SURFACE LOCATION OF THE WINDOM 12N WELL.

WINDOM 5N67W24 1-46 CONSTRUCTION LAYOUT DRAWING - PLAN VIEW

WELL PAD QUANTITIES AND DESIGN PARAMETERS

EXISTING GRADE AT CENTER OF WELL PAD = 5002.9'
FINAL GRADE AT CENTER OF WELL PAD = 5000.5'
CUT SLOPES = 3:1; EXCEPT AS NOTED
FILL SLOPES = 3:1; EXCEPT AS NOTED
SHRINKAGE FACTOR = 1.10
SWELL FACTOR = 1.00
OIL AND GAS LOCATION TOTAL DISTURBANCE AREA = 21.12 ACRES
WORKING PAD SURFACE AREA = 14.08 ACRES
ACCESS ROAD DISTURBANCE AREA = 0.05 ACRES
PIPELINE/UTILITY CORRIDOR AREA = 0.00 ACRES

WINDOM 5N67W24 1-46

CONSTRUCTION LAYOUT DRAWING - PLAN VIEW
LOCATED IN NW1/4 SE1/4
SECTION 24, T5N, R67W, 6TH P.M.
WELD COUNTY, COLORADO

WELL PAD QUANTITIES

TOTAL CUT FOR WELL PAD = 29,739 C.Y.
TOTAL FILL FOR WELL PAD = 29,739 C.Y.
TOPSOIL @ 10" DEPTH = 10,504 C.Y.
IMPORT MATERIAL = 0 C.Y.

PLATING MATERIAL VOLUME
TO BE ADDED TO WELL PAD = 5,560 C.Y.
(ASSUMING 6" DEPTH)

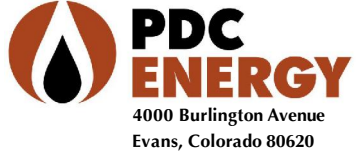

LOVELAND OFFICE
6706 North Franklin Avenue
Loveland, Colorado 80538
Phone 970-776-4331

SHERIDAN OFFICE
1095 Saberton Avenue
Sheridan, Wyoming 82801
Phone 307-674-0609

LEGEND

- EXISTING WELL LOCATION
- PROPOSED WELL LOCATION
- EXISTING CONTOURS (2' INTERVAL)
- PROPOSED CONTOURS (2' INTERVAL)
- EPL
- EXISTING PIPELINE
- PROPOSED FLOWLINE CORRIDOR
- EXISTING FENCE
- DIVERSION DITCH
- BERM / OFF-SITE FLOW DEFLECTION
- CULVERT PROTECTION / RIPRAP



HORIZONTAL 0 60' 120' 1" = 120'
2' CONTOURS

SCALE: 1"=120'	DATE: 11/5/21	SHEET NO:
REVISED:	CDJ 4/3/23	1 OF 1

K:\SYNERGY RESOURCES\2018\18_55_WINDOM_CHOPPER_DSJ_207_8_208_T5N_R67W_SEC_24\DWG\WINDOM_WATTEP_OFF_WELLS.dwg, 4/2/2023 11:07:27 AM, gjaeger

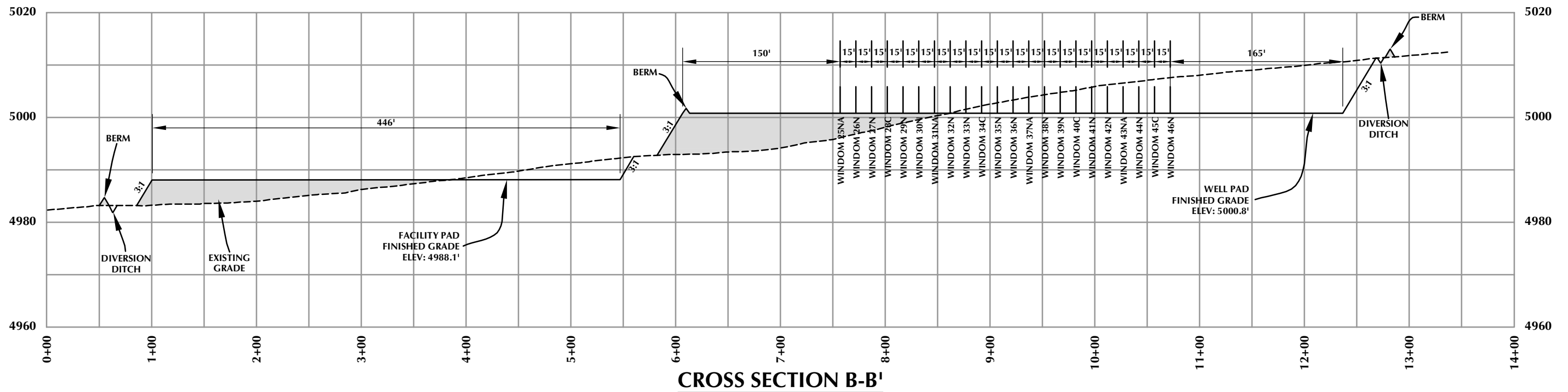
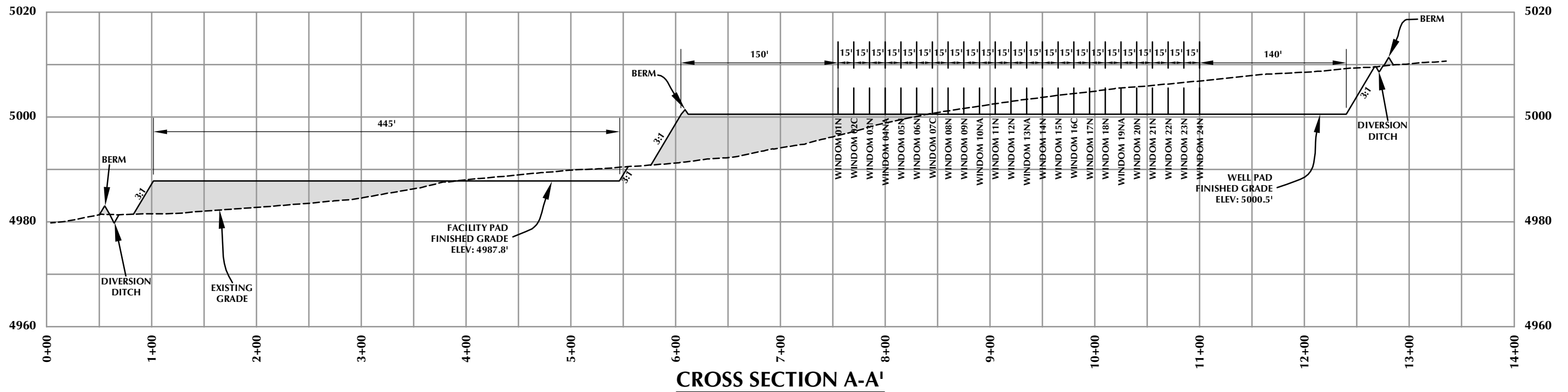

WINDOM 5N67W24 1-46

CONSTRUCTION LAYOUT DRAWING - CROSS SECTIONS
LOCATED IN NW1/4 SE1/4
SECTION 24, T5N, R67W, 6TH P.M.
WELD COUNTY, COLORADO

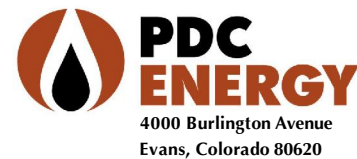

LOVELAND OFFICE
6706 North Franklin Avenue
Loveland, Colorado 80538
Phone 970-776-4331

SHERIDAN OFFICE
1095 Saberton Avenue
Sheridan, Wyoming 82801
Phone 307-674-0609

HORIZONTAL 0 50' 100' 1" = 100'
VERTICAL 0 10' 20' 1" = 20'

SCALE: 1"=100'	DATE: 11/5/21	SHEET NO:
REVISED:	CDJ 4/3/23	1 1 OF 2

K:\SYNERGY RESOURCES\2018\2018_55_WINDOM_CHOPPER_DSJ_207 & 208_T5N_R67W_SEC_24\DWG\WINDOM_WATTEK_OFF_WELLS.dwg, 4/4/2023 4:24:36 PM, cjbgr

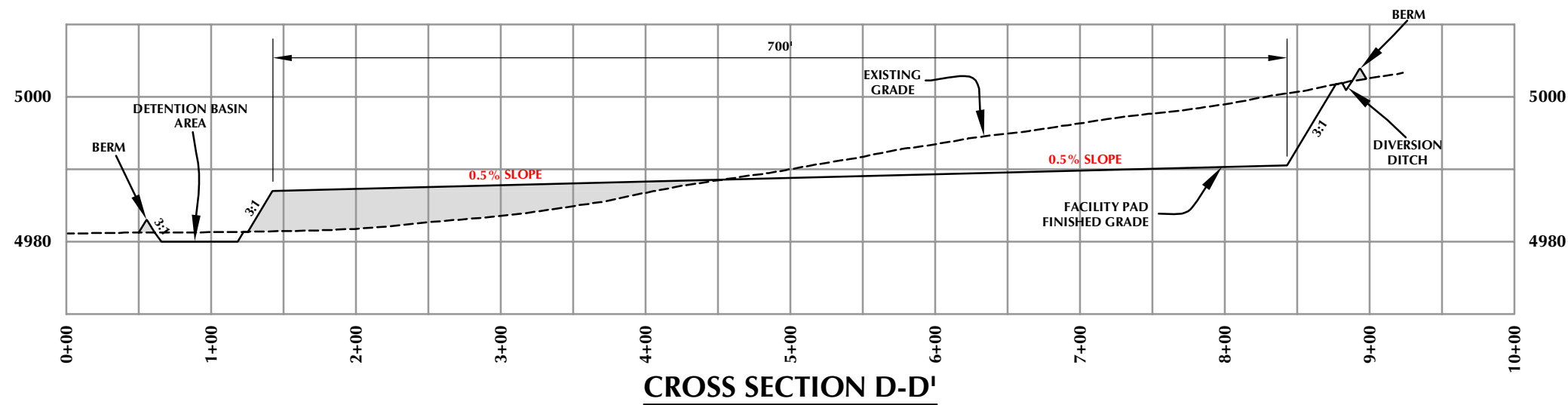
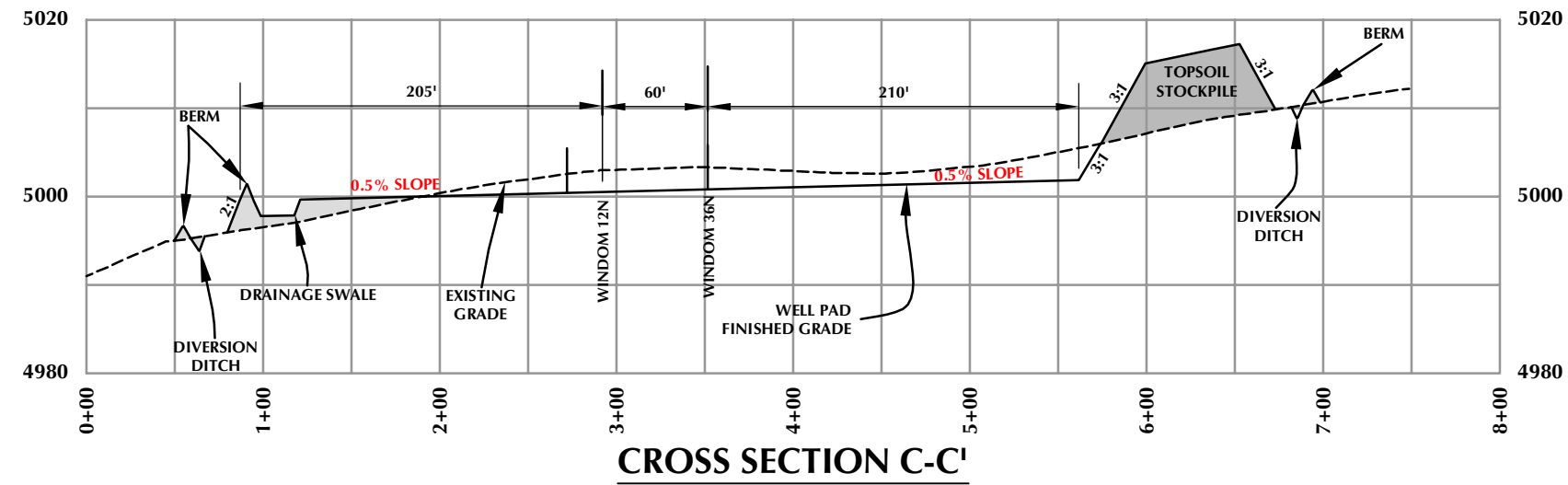

WINDOM 5N67W24 1-46

CONSTRUCTION LAYOUT DRAWING - CROSS SECTIONS
LOCATED IN NW1/4 SE1/4
SECTION 24, T5N, R67W, 6TH P.M.
WELD COUNTY, COLORADO

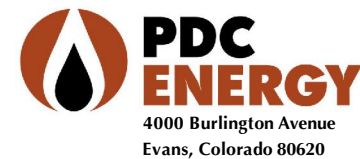

LOVELAND OFFICE
6706 North Franklin Avenue
Loveland, Colorado 80538
Phone 970-776-4331

SHERIDAN OFFICE
1095 Saberton Avenue
Sheridan, Wyoming 82801
Phone 307-674-0609

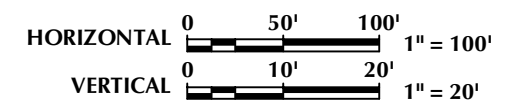

SCALE: 1"=100'	DATE: 11/5/21	SHEET NO:
REVISED: CDJ 4/3/23		2 2 OF 2

PRELIMINARY RIG LAYOUT DRAWING
WINDOM 5N67W24 1-46
NW1/4 SE1/4 SECTION 24, TOWNSHIP 5 NORTH, RANGE 67 WEST, 6TH P.M., WELD COUNTY, COLORADO

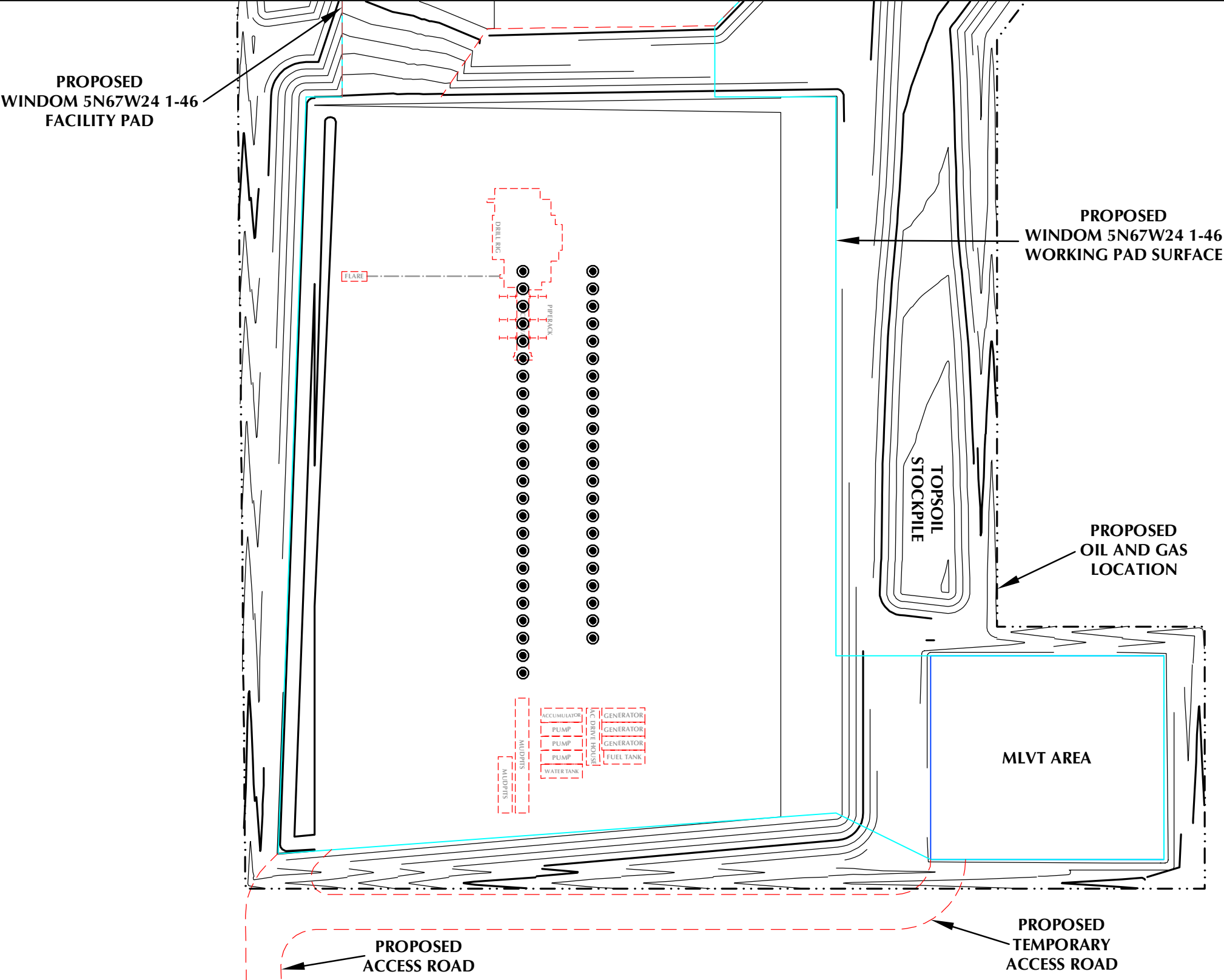

- LEGEND**
- PROPOSED WELL
 - EXISTING WELL
 - PROPOSED OIL AND GAS LOCATION
 - PROPOSED WORKING PAD SURFACE
 - PROPOSED 2' CONTOUR

609

CONSULTING, LLC

LOVELAND OFFICE
6706 North Franklin Avenue
Loveland, Colorado 80538
Phone 970-776-4331

SHERIDAN OFFICE
1095 Saberton Avenue
Sheridan, Wyoming 82801
Phone 307-674-0609

PDC ENERGY

4000 Burlington Avenue
Evans, Colorado 80620

DATE SURVEYED:	10/29/21
DATE:	11/5/21
DRAFTER:	CDJ
REVISED:	4/3/23





NOTES:

K:\SYNERGY RESOURCES\2018\2018_55_WINDOM_CHOPPER_DSJ_2017_8_208_T5N_R67W_SEC_24\DWG\DSJ_2017_208.dwg, 4/22/2023 11:24:30 AM, gberger

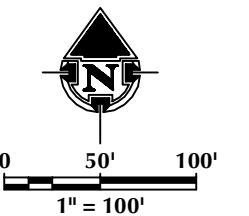
WINDOM 5N67W24 1-46
NW1/4 SE1/4 SECTION 24, TOWNSHIP 5 NORTH, RANGE 67 WEST, 6TH P.M., WELD COUNTY, COLORADO

**PROPOSED
TEMPORARY
ACCESS ROAD**



- LEGEND**
- | | |
|---|-------------------------------|
|  | PROPOSED WELL |
|  | EXISTING WELL |
|  | PROPOSED OIL AND GAS LOCATION |
|  | PROPOSED WORKING PAD SURFACE |
|  | PROPOSED 2' CONTOUR |



LOVELAND OFFICE
6706 North Franklin Avenue
Loveland, Colorado 80538
Phone 970-776-4331

SHERIDAN OFFICE
1095 Saberton Avenue
Sheridan, Wyoming 82801
Phone 307-674-0609

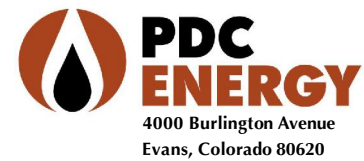

DATE SURVEYED: 10/29/21
DATE: 11/5/21
DRAFTER: CDJ
REVISED: 4/3/23

NOTES:

PRELIMINARY FLOWBACK EQUIPMENT LAYOUT DRAWING

WINDOM 5N67W24 1-46

NW1/4 SE1/4 SECTION 24, TOWNSHIP 5 NORTH, RANGE 67 WEST, 6TH P.M., WELD COUNTY, COLORADO

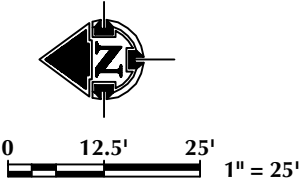
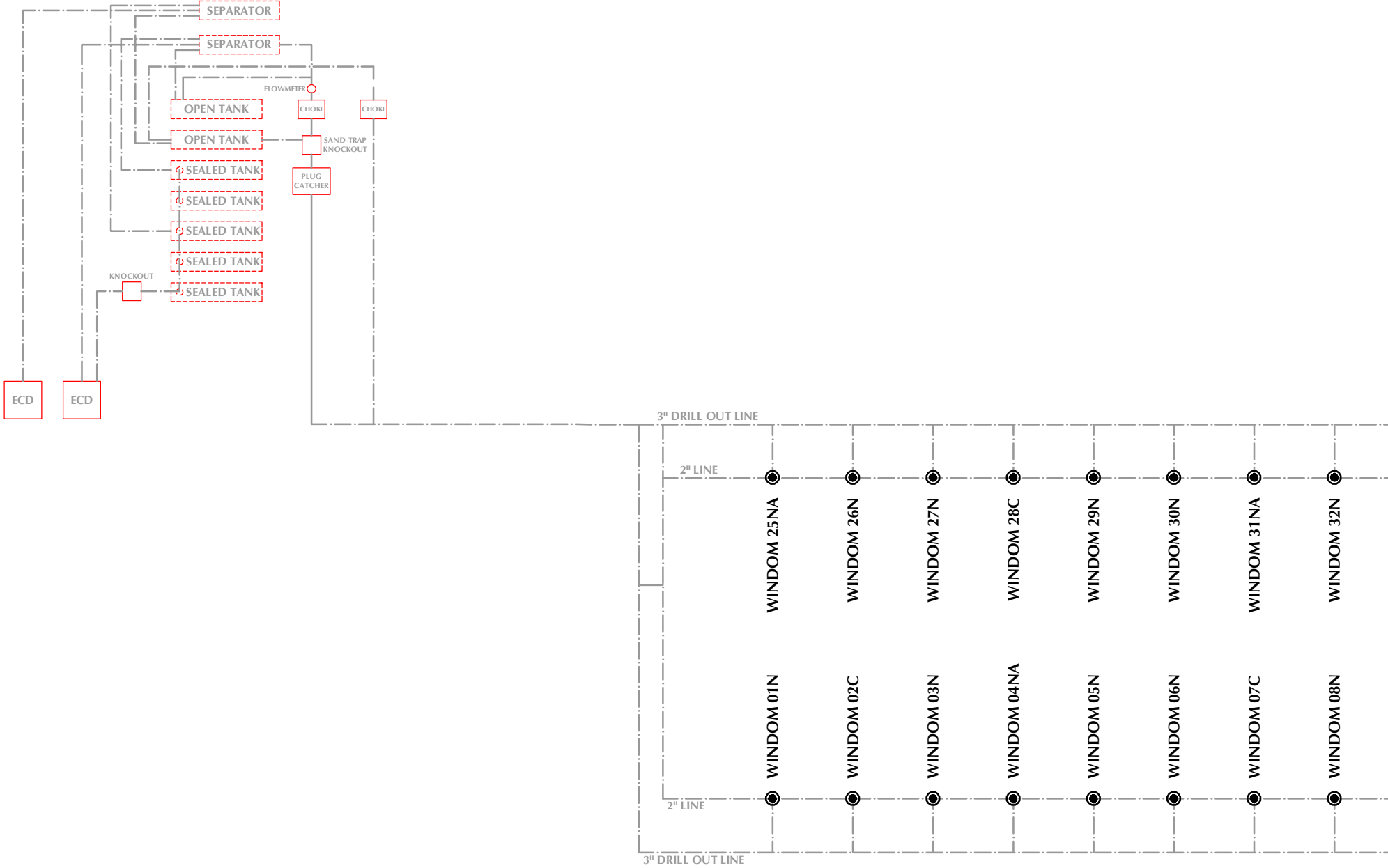

LEGEND

● PROPOSED WELL

--- PROPOSED PIPELINE



609
CONSULTING, LLC

LOVELAND OFFICE
6706 North Franklin Avenue
Loveland, Colorado 80538
Phone 970-776-4331

SHERIDAN OFFICE
1095 Saberton Avenue
Sheridan, Wyoming 82801
Phone 307-674-0609



PDC
ENERGY

4000 Burlington Avenue
Evans, Colorado 80620

DATE SURVEYED: 10/29/21

DATE: 11/5/21

DRAFTER: CDJ

REVISED: 4/3/23

NOTES:

OIL AND GAS FACILITY LAYOUT DRAWING
WINDOM 5N67W24 1-46

NW1/4 SE1/4 SECTION 24, TOWNSHIP 5 NORTH, RANGE 67 WEST, 6TH P.M., WELD COUNTY, COLORADO

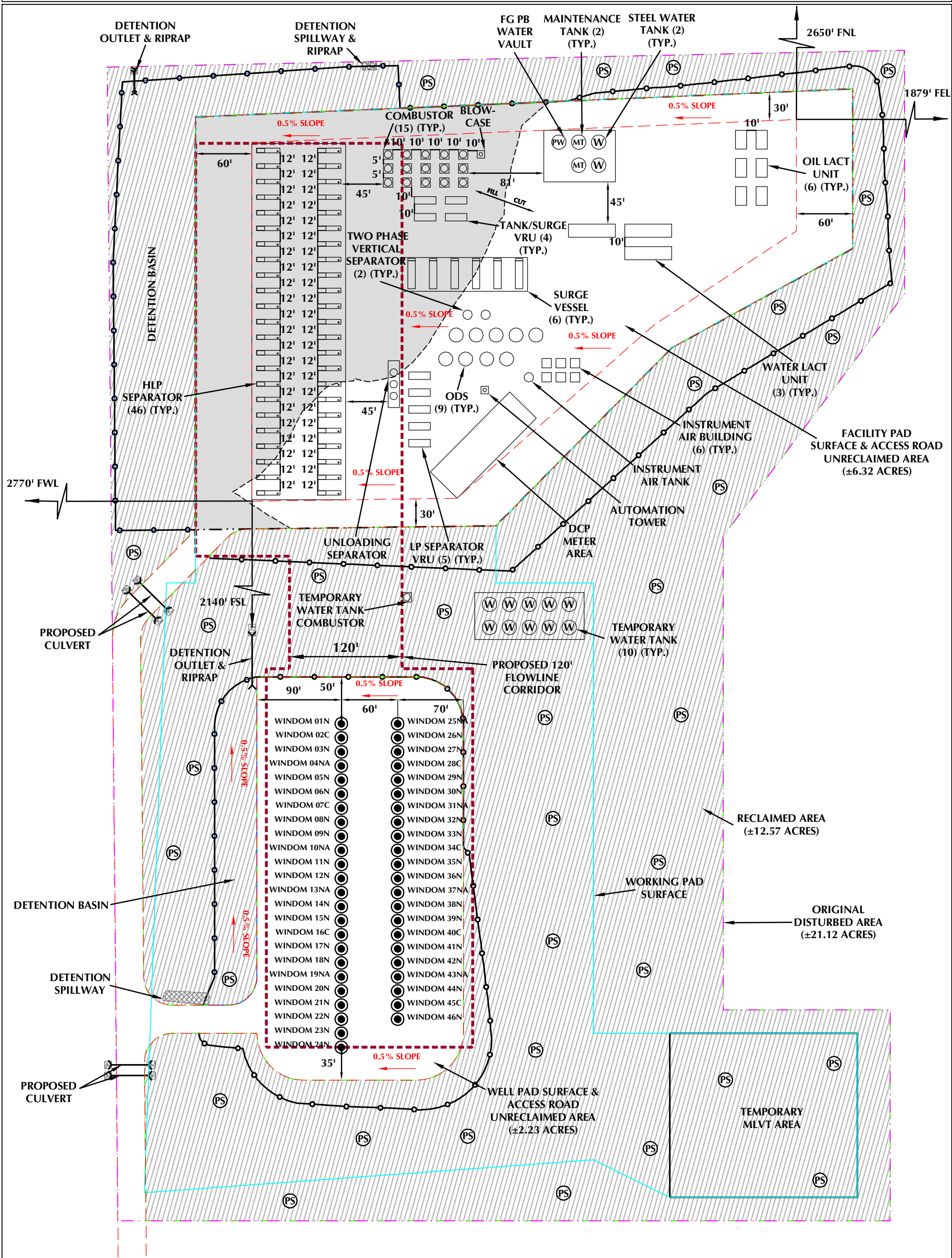

- LEGEND**
- BERM/OFF-SITE FLOW DEFLECTION
 - PROPOSED OIL AND GAS LOCATION
 - RECLAMATION HATCH
 - CULVERT PROTECTION / RIPRAP
 - FLOWLINE CORRIDOR
 - EXISTING ROAD
 - PROPOSED WORKING PAD SURFACE
 - DETENTION BASIN AREA
 - PROPOSED ACCESS ROAD
 - PROPOSED PERMANENT SEEDING
 - PROPOSED WELL LOCATION
 - EXISTING WELL LOCATION

NOTES:
1. EQUIPMENT PLACEMENT IS APPROXIMATE AND SUBJECT TO MINOR MODIFICATION DUE TO SPECIFIC CIRCUMSTANCES.

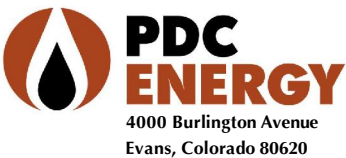

LOVELAND OFFICE
6706 North Franklin Avenue
Loveland, Colorado 80538
Phone 970-776-4331
SHERIDAN OFFICE
1095 Saberton Avenue
Sheridan, Wyoming 82801
Phone 307-674-0609

SCALE: 1" = 100' DATE: 11/5/21 SHEET NO: 1
REVISED: CDJ 4/3/23 1 OF 1

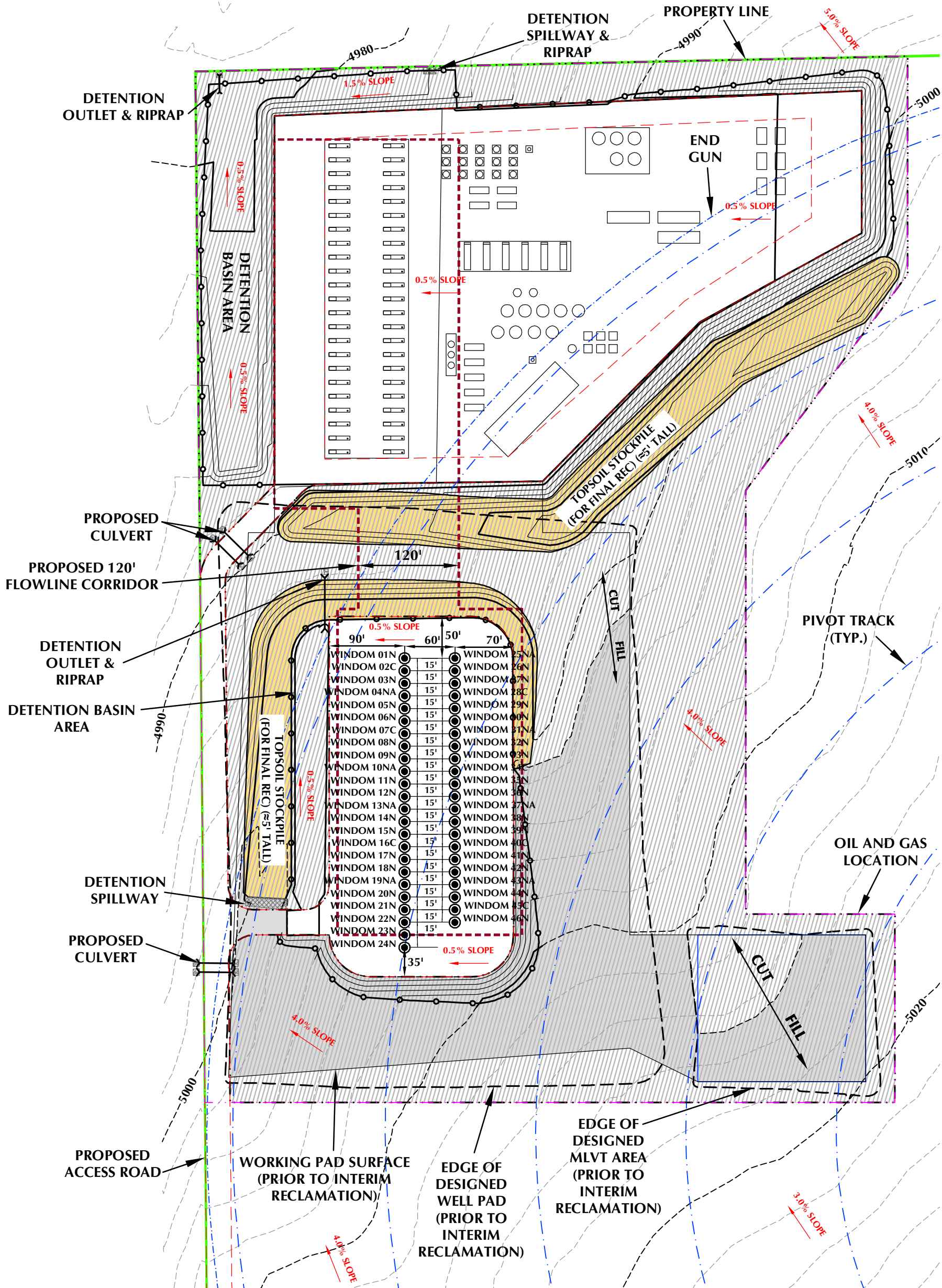

WINDOM 5N67W24 1-46 - INTERIM RECLAMATION SUMMARY

QUANTITIES AND DESIGN PARAMETERS
SHRINKAGE FACTOR = 1.00
SWELL FACTOR = 1.00
TOTAL DISTURBANCE AREA = 21.12 ACRES
TOTAL WELL PAD AREA AFTER
INTERIM RECLAMATION = 2.23 ACRES
TOTAL FACILITY PAD AREA AFTER
INTERIM RECLAMATION = 6.32 ACRES
AREA RECLAIMED DURING
INTERIM RECLAMATION = 12.57 ACRES

WELL PAD QUANTITIES
TOTAL CUT = 19,337 C.Y.
TOTAL FILL = 19,337 C.Y.
TOPSOIL @ 10" DEPTH
FROM WELL PAD = 10,504 C.Y.
TOPSOIL @ 10" DEPTH FROM
FACILITY/MLVT PAD = 10,116 C.Y.
TOTAL TOPSOIL = 20,620 C.Y.
TOPSOIL USED FOR INTERIM REC = 9,072 C.Y.
TOPSOIL STORED FOR FINAL REC = 11,548 C.Y.
TOTAL EXPORT = 0 C.Y.

- LEGEND**
- EXISTING WELL LOCATION
 - PROPOSED WELL LOCATION
 - EXISTING CONTOURS (2' INTERVAL)
 - PROPOSED CONTOURS (2' INTERVAL)
 - EPL
 - EXISTING PIPELINE
 - RECLAMATION AREA
 - BERM

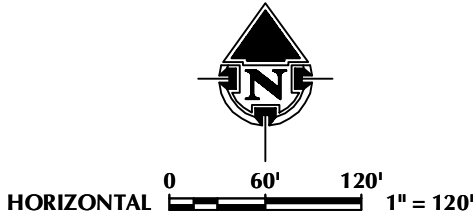

SCALE: 1"=120' DATE: 8/25/22 SHEET NO: 1 OF 1
REVISED: CDJ 4/3/23

INTERIM RECLAMATION SUMMARY
LOCATED IN NW1/4 SE1/4
SECTION 24, T5N, R67W, 6TH P.M.
WELD COUNTY, COLORADO

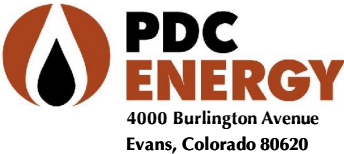

LOVELAND OFFICE
6706 North Franklin Avenue
Loveland, Colorado 80538
Phone 970-776-4331
SHERIDAN OFFICE
1095 Saberton Avenue
Sheridan, Wyoming 82801
Phone 307-674-0609