

Soil Map—Weld County, Colorado, Southern Part (Windom)

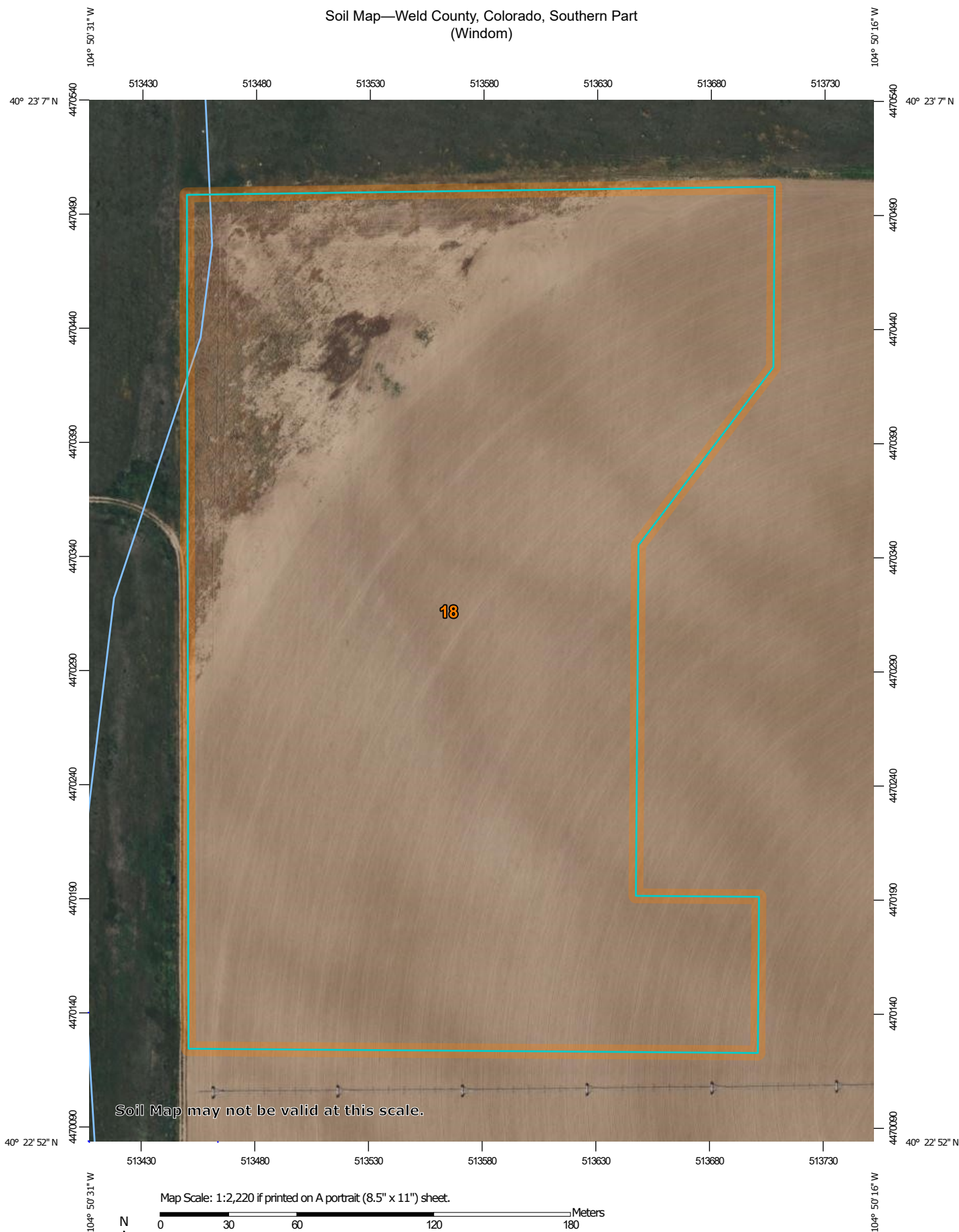

Soil Map—Weld County, Colorado, Southern Part (Windom)

MAP LEGEND

Area of Interest (AOI)

 Area of Interest (AOI)

Soils

 Soil Map Unit Polygons

 Soil Map Unit Lines

 Soil Map Unit Points

Special Point Features



Blowout



Borrow Pit



Clay Spot



Closed Depression



Gravel Pit



Gravelly Spot



Landfill



Lava Flow



Marsh or swamp



Mine or Quarry



Miscellaneous Water



Perennial Water



Rock Outcrop



Saline Spot



Sandy Spot



Severely Eroded Spot



Sinkhole



Slide or Slip



Sodic Spot



Spoil Area



Stony Spot



Very Stony Spot



Wet Spot



Other



Special Line Features

Water Features



Streams and Canals

Transportation



Rails



Interstate Highways



US Routes



Major Roads



Local Roads

Background



Aerial Photography

MAP INFORMATION

The soil surveys that comprise your AOI were mapped at 1:24,000.

Warning: Soil Map may not be valid at this scale.

Enlargement of maps beyond the scale of mapping can cause misunderstanding of the detail of mapping and accuracy of soil line placement. The maps do not show the small areas of contrasting soils that could have been shown at a more detailed scale.

Please rely on the bar scale on each map sheet for map measurements.

Source of Map: Natural Resources Conservation Service

Web Soil Survey URL:

Coordinate System: Web Mercator (EPSG:3857)

Maps from the Web Soil Survey are based on the Web Mercator projection, which preserves direction and shape but distorts distance and area. A projection that preserves area, such as the Albers equal-area conic projection, should be used if more accurate calculations of distance or area are required.

This product is generated from the USDA-NRCS certified data as of the version date(s) listed below.

Soil Survey Area: Weld County, Colorado, Southern Part

Survey Area Data: Version 21, Sep 1, 2022

Soil map units are labeled (as space allows) for map scales 1:50,000 or larger.

Date(s) aerial images were photographed: Jun 8, 2021—Jun 12, 2021

The orthophoto or other base map on which the soil lines were compiled and digitized probably differs from the background imagery displayed on these maps. As a result, some minor shifting of map unit boundaries may be evident.

Weld County, Colorado, Southern Part

18—Colby-Adena loams, 3 to 9 percent slopes

Map Unit Setting

National map unit symbol: 361t

Elevation: 4,750 to 4,900 feet

Mean annual precipitation: 12 to 16 inches

Mean annual air temperature: 48 to 55 degrees F

Frost-free period: 120 to 160 days

Farmland classification: Not prime farmland

Map Unit Composition

Colby and similar soils: 55 percent

Adena and similar soils: 30 percent

Minor components: 15 percent

Estimates are based on observations, descriptions, and transects of the mapunit.

Description of Colby

Setting

Landform: Plains, hills, ridges

Down-slope shape: Linear

Across-slope shape: Linear

Parent material: Calcareous eolian deposits

Typical profile

H1 - 0 to 7 inches: loam

H2 - 7 to 60 inches: silt loam

Properties and qualities

Slope: 5 to 9 percent

Depth to restrictive feature: More than 80 inches

Drainage class: Well drained

Runoff class: Medium

Capacity of the most limiting layer to transmit water

(Ksat): Moderately high to high (0.57 to 2.00 in/hr)

Depth to water table: More than 80 inches

Frequency of flooding: None

Frequency of ponding: None

Calcium carbonate, maximum content: 15 percent

Available water supply, 0 to 60 inches: High (about 10.6 inches)

Interpretive groups

Land capability classification (irrigated): None specified

Land capability classification (nonirrigated): 4e

Hydrologic Soil Group: B

Ecological site: R067BY008CO - Loamy Slopes

Hydric soil rating: No

Description of Adena

Setting

Landform: Ridges, plains, hills

Down-slope shape: Linear

Across-slope shape: Linear

Parent material: Calcareous eolian deposits

Typical profile

H1 - 0 to 6 inches: loam

H2 - 6 to 9 inches: clay loam

H3 - 9 to 60 inches: silt loam

Properties and qualities

Slope: 3 to 7 percent

Depth to restrictive feature: More than 80 inches

Drainage class: Well drained

Runoff class: Medium

Capacity of the most limiting layer to transmit water

(Ksat): Moderately high (0.20 to 0.60 in/hr)

Depth to water table: More than 80 inches

Frequency of flooding: None

Frequency of ponding: None

Calcium carbonate, maximum content: 15 percent

Available water supply, 0 to 60 inches: High (about 10.1 inches)

Interpretive groups

Land capability classification (irrigated): 3e

Land capability classification (nonirrigated): 4e

Hydrologic Soil Group: C

Ecological site: R067BY002CO - Loamy Plains

Hydric soil rating: No

Minor Components

Kim

Percent of map unit: 5 percent

Hydric soil rating: No

Keith

Percent of map unit: 4 percent

Hydric soil rating: No

Weld

Percent of map unit: 3 percent

Hydric soil rating: No

Wiley

Percent of map unit: 3 percent

Hydric soil rating: No

Data Source Information

Soil Survey Area: Weld County, Colorado, Southern Part

Survey Area Data: Version 21, Sep 1, 2022