

UNGRADED ELEVATION: 4128.2'

FINAL ELEVATION: 4127.3'

PROPOSED AREA OF DISTURBANCE: 3.5± ACRES

AREA OF WORKING PAD SURFACE: 2.1± ACRES

PROPOSED ACCESS DISTURBANCE: 0.6± ACRES

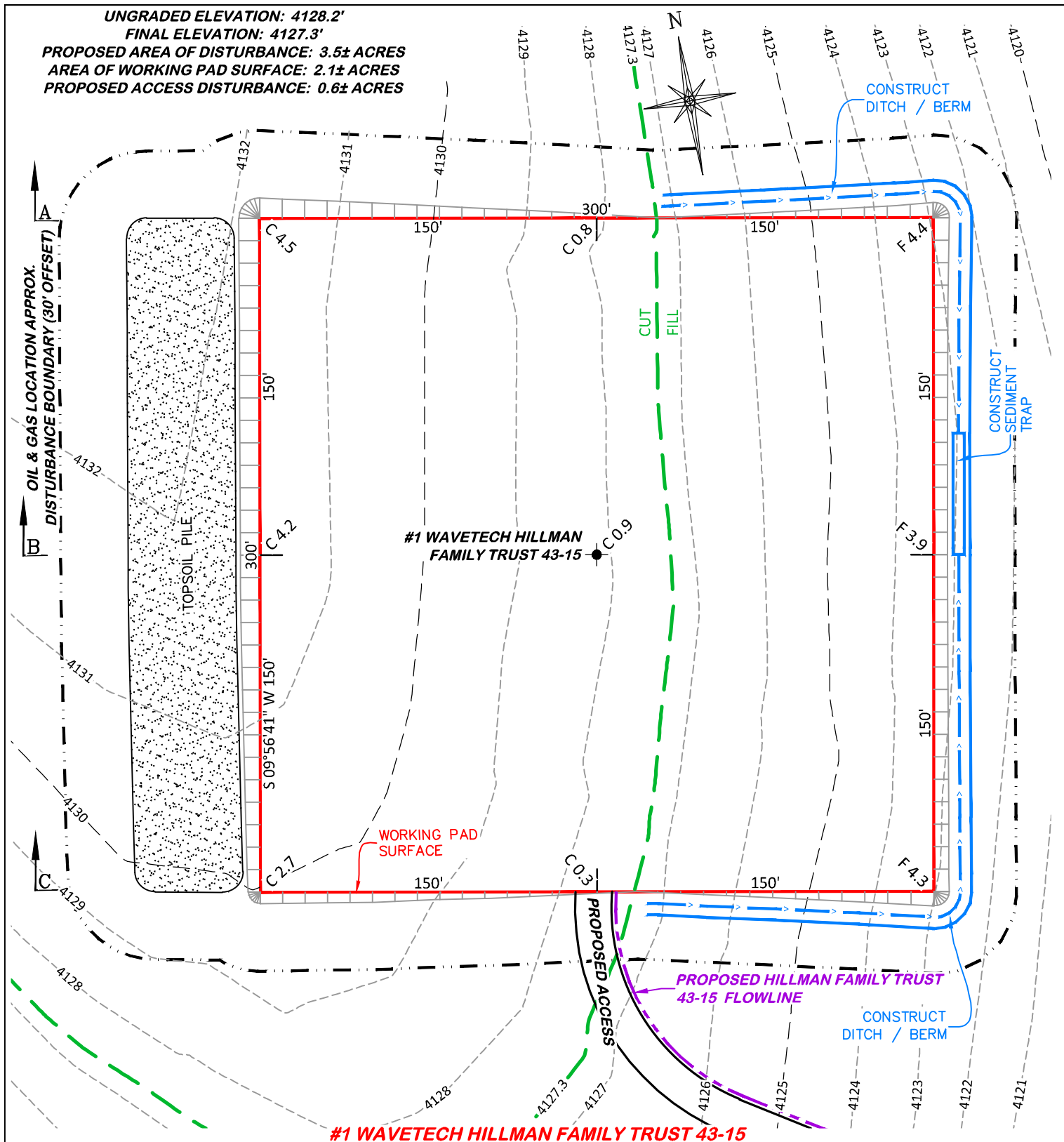

#1 WAVETECH HILLMAN FAMILY TRUST 43-15

NOTE: THE EARTH QUANTITIES ON THIS DRAWING ARE ESTIMATED AND THE USE OF SAID QUANTITIES IS AT THE RESPONSIBILITY OF THE USER.

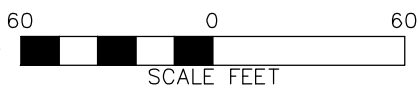

SCALE FEET



RIFFIN & ASSOCIATES, INC.

(307) 362-5028

1414 ELK ST., ROCK SPRINGS, WY 82901

DRAWN: 8/18/22 - JMB

SCALE: 1" = 60'

REVISED: 11/28/22-DWB

DRG JOB No. 22263

MISC. REVISIONS

304b(7)Bi CONST

CONSTRUCTION LAYOUT DRAWING 1 OF 5

PLAN

WAVETECH HELIUM, INC.

#1 WAVETECH HILLMAN FAMILY TRUST 43-15  
NESE, SECTION 15, T. 12 S., R. 43 W., 6th P.M.,  
CHEYENNE COUNTY, COLORADO

ESTIMATED EARTHWORK

ITEM	CUT	FILL	TOPSOIL	EXCESS
PAD	4,543 CY	2,743 CY	1,791 CY	9 CY
PIT	NONE			NONE
TOTALS	4,543 CY	2,743 CY	1,791 CY	9 CY

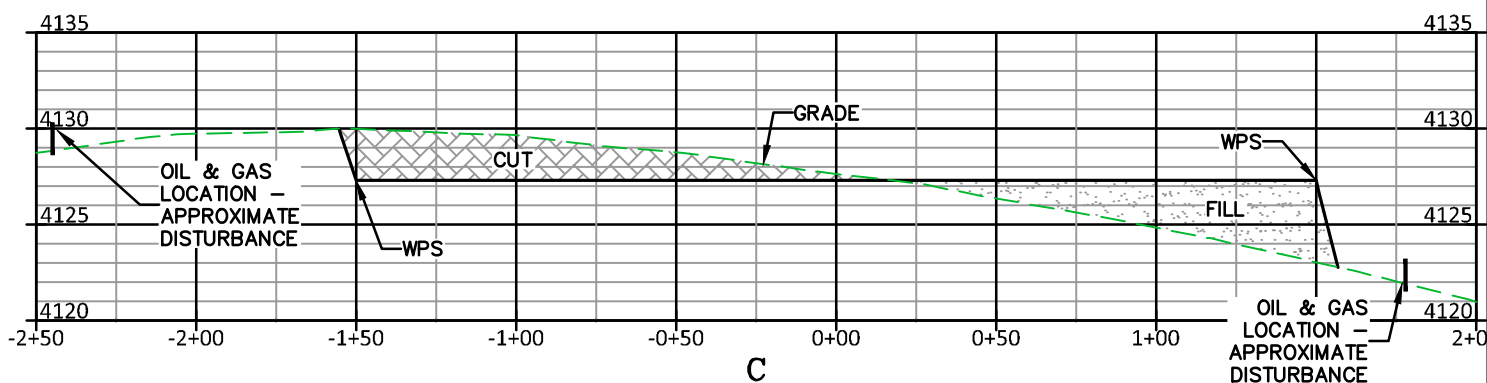
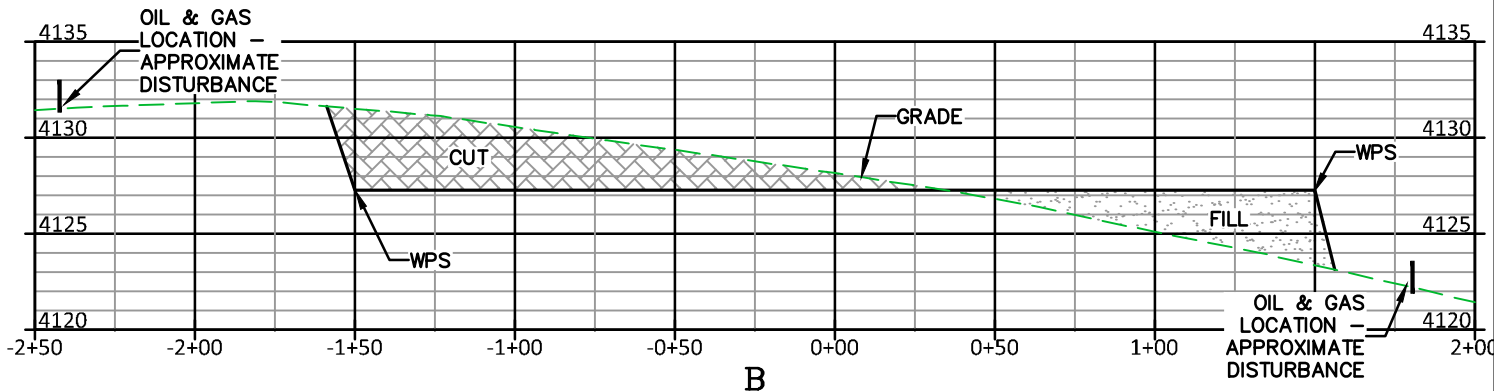
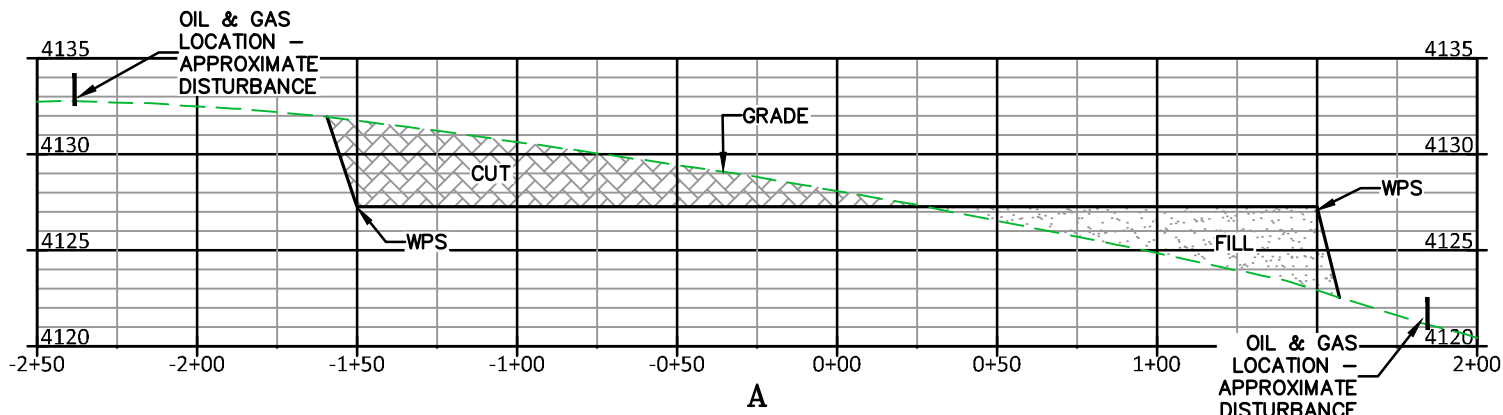

**CUT SLOPES - 2:1**

**FILL SLOPES - 1.5:1**

**#1 WAVETECH HILLMAN FAMILY TRUST 43-15**



**RIFFIN & ASSOCIATES, INC.**

(307) 362-5028

1414 ELK ST., ROCK SPRINGS, WY 82901

DRAWN: 8/18/22 - JMB

SCALE: H - 1" = 60' V - 1" = 10'

REVISED: 11/28/22-DWB

DRG JOB No. 22263

WELL NAME CHANGE

304b(7)Bi XSEC

CONSTRUCTION LAYOUT DRAWING 2 OF 5

**CONSTRUCTION LAYOUT DRAWING  
CROSS-SECTIONS**

**WAVETECH HELIUM, INC.**

**#1 WAVETECH HILLMAN FAMILY TRUST 43-15  
NESE, SECTION 15, T. 12 S., R. 43 W., 6th P.M.,  
CHEYENNE COUNTY, COLORADO**

**FINAL ELEVATION: 4127.3'**

**PROPOSED ACCESS DISTURBANCE: 0.6± ACRES**



**(307) 362-5028**

**SCALE: 1" = 60'**

**DRG JOB No. 22263**

**304b(7)Bi DSGN CONT**

**#1 WAVETECH HILLMAN FAMILY TRUST 43-15  
NESE, SECTION 15, T. 12 S., R. 43 W., 6th P.M.,  
CHEYENNE COUNTY, COLORADO**

UNGRADED ELEVATION: 4128.2'

FINAL ELEVATION: 4127.3'

PROPOSED AREA OF DISTURBANCE: 3.5± ACRES

AREA OF WORKING PAD SURFACE: 2.1± ACRES

PROPOSED ACCESS DISTURBANCE: 0.6± ACRES

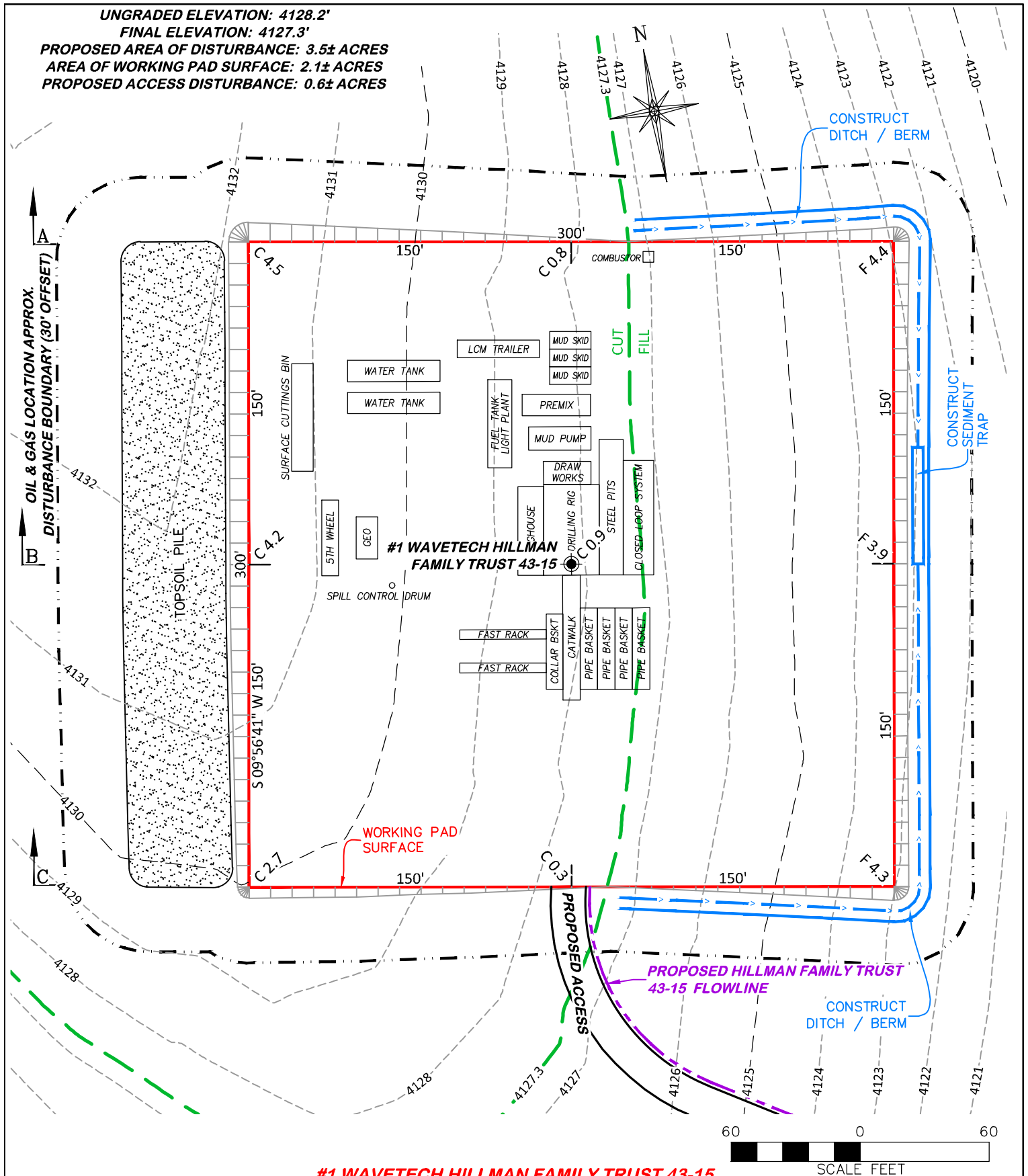

**#1 WAVETECH HILLMAN FAMILY TRUST 43-15**

SCALE FEET



**DRG RIFFIN & ASSOCIATES, INC.**

(307) 362-5028

1414 ELK ST., ROCK SPRINGS, WY 82901

DRAWN: 8/18/22 - JMB

SCALE: 1" = 60'

REVISED: 11/28/22-DWB

DRG JOB No. 22263

MISC. REVISIONS

304b(7)Bii RIG

**APPROXIMATE DISTURBANCE AREA 3.5± ACRES**  
**PROPOSED RECLAMATION AREA: 2.4± ACRES**  
**INTERIM RECLAMATION DISTURBANCE: 1.1± ACRES**

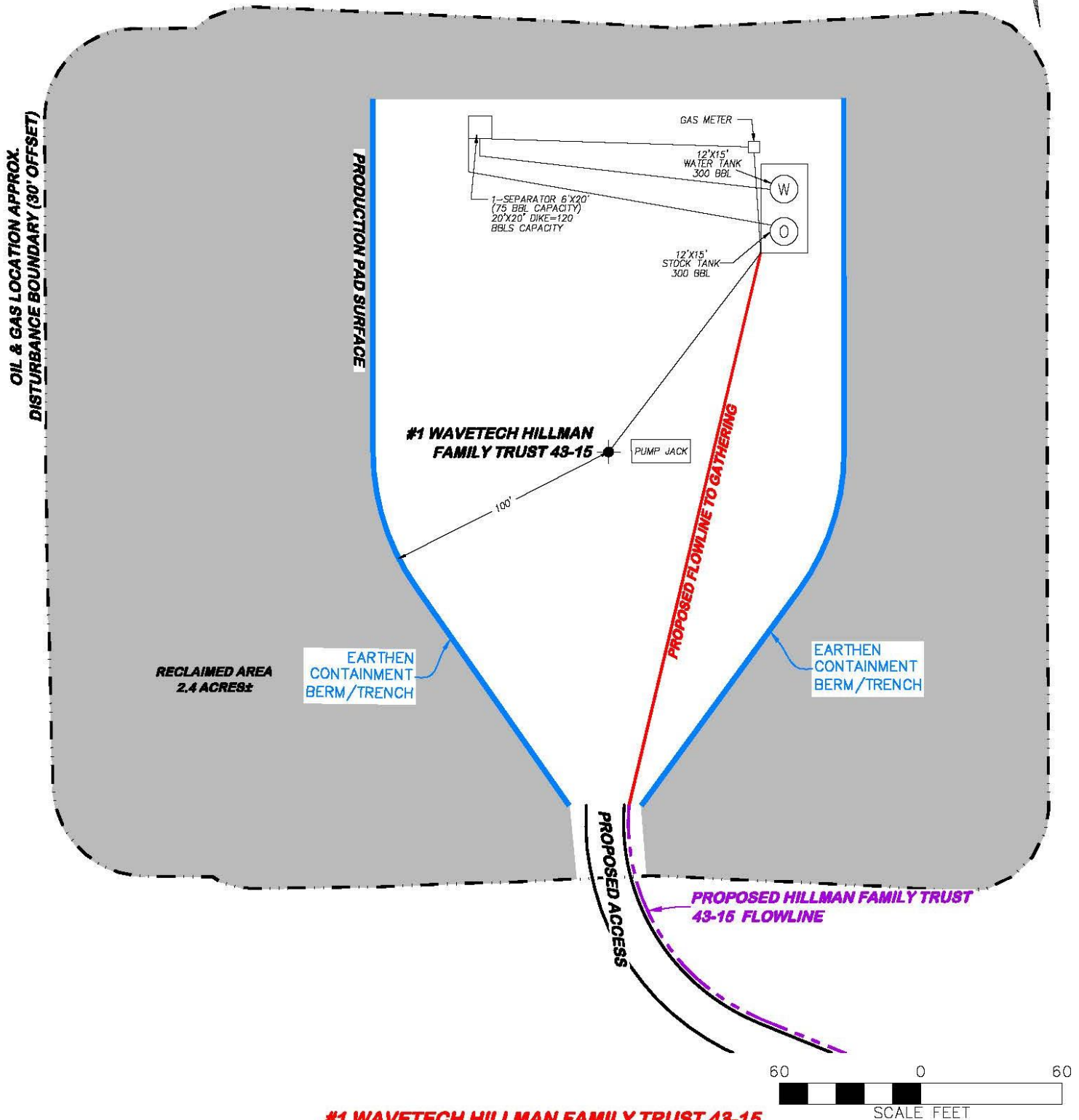
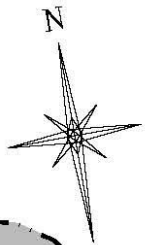

**#1 WAVETECH HILLMAN FAMILY TRUST 43-15**

SCALE FEET



**DRG RIFFIN & ASSOCIATES, INC.**  
1414 ELK ST., ROCK SPRINGS, WY 82901

(307) 362-5028

**DRAWN: 8/18/22 - JMB**

**SCALE: 1" = 60'**

**REVISED: 11/28/22-DWB**

**DRG JOB No. 22263**

**WELL NAME CHANGE**

**304b(7)Bv FACILITY**

**CONSTRUCTION LAYOUT DRAWING 5 OF 5**

**FACILITY LAYOUT DRAWING**  
**WAVETECH HELIUM, INC.**  
**#1 WAVETECH HILLMAN FAMILY TRUST 43-15**  
**NESE, SECTION 15, T. 12 S., R. 43 W., 6th P.M.,**  
**CHEYENNE COUNTY, COLORADO**