



BOOMHOG 8-59 3 OGD P INTERIM RECLAMATION PLAN

Contents

| | | |
|--------------|------------------------------------------------------------------|---|
| Article I. | Introduction..... | 2 |
| | Location Information..... | 2 |
| Article II. | Site Specific Details..... | 2 |
| | Vegetation | 2 |
| | Soils..... | 2 |
| | Security | 3 |
| Article III. | Mitigation Measures and Best Management Practices | 3 |
| | 1003.a. General | 3 |
| | 1003.b. Areas no Longer in Use..... | 3 |
| | 1003.c. Compaction Alleviation..... | 4 |
| | 1003.d. Drilling pit closure..... | 4 |
| | 1003.e. Restoration and revegetation | 4 |
| | 1003.f. Weed control..... | 4 |
| | Interim Reclamation Completion Notice..... | 4 |
| Article IV. | Site-Specific Interim Reclamation Best Management Practices..... | 5 |
| | Reporting..... | 5 |
| Article V. | Exhibits/References/Appendices..... | 6 |



Bison IV Operating, LLC

518 17th Street, Suite 1800
Denver, CO 80202
Phone: 720-644-6997
Fax: 303-974-1767

Article I. Introduction

Location Information

This document provides site-specific information for the Boomhog 8-59 3 Pad within the Boomhog 8-59 3 OGD. The information in this document relates specifically to the time during the construction, drilling, completion, and production of the twelve (12) proposed horizontal wells on this location.

The proposed location is rangeland approximately 4.9 miles north of the intersection of WCR 115 and Highway 14. The Pad will be in the NWSW of Section 3, Township 8 North, Range 59 West, zoned Agricultural within Weld County's Ag-Rural planning area. A 1041WOGA was filed in June 2023 as 1041WOGA22-0045.

The proposed Pad will be 15.0 acres, reduced to 10.6 after interim reclamation. The working pad surface will be 9.6 acres. The Pad is on Parcel 053903000013 owned by Wade E Castor and Deland Castor. The location is currently used for grazing.

The proposed production facility equipment for the Boomhog 8-59 3 Pad will be located within the WPS adjacent to the wells and will consist of gas lift meters, heater treaters, scrubbers, oil tanks, produced water tanks, recycle pumps, oil and water Lease Automatic Custody Transfers (LACTs), gas lift compressors, sales gas meters/buildings, electrical skids, vapor recovery towers (VRT), vapor recovery units (VRU), blower/oxygen destructors, and emission control devices (ECD).

| Phase | Duration (days) | Estimated Start Date |
|---------------------|----------------------|------------------------------------------|
| Construction | +/- 20 days | 2 nd Quarter (May) 2024 |
| Drilling | +/- 120 days | 2 nd Quarter (June) 2024 |
| Completion | +/- 45 days | 3 rd Quarter (August) 2024 |
| Flowback | +/- 10 days | 4 th Quarter (October) 2024 |
| Production | Ongoing +/- 30 years | 4 th Quarter (October) 2024 |
| Interim Reclamation | +/- 30 days | 4 th Quarter (November) 2024* |

**or the first favorable weather/growing season.*

Article II. Site Specific Details

Vegetation

Location is in Rangeland.

Dominant Vegetation: Prairie Sandreed

Soils

Pad and Access Soil type(s)**: 4 - Ascalon fine sandy loam, 0 to 6 percent slopes

****NRCS Web Soil Survey is not accurate at scale to capture access road soil types.**

Total area of soil disturbance in acres including accesses, pipeline and utility corridors: approximately 15.2 acres.



There are no flowline, pipeline, or utility corridors planned as part of the OGD. **(15.0 acres pad disturbance + 0.2 acres access road)**

Security

A meeting with the surface owner will occur after completion activities but before interim reclamation to determine a fencing plan if needed. The location will be adequately secured per 603.h to restrict access by unauthorized persons in accordance with the surface owner's requests.

- Bison will identify the type (wildlife friendly, livestock, barbed wire) and area to be fenced, if needed, to ensure that the interim reclaimed area does not get overgrazed.

Article III. Mitigation Measures and Best Management Practices

1003.a. General

When wells are completed for production, all disturbed areas no longer needed will be restored and revegetated as soon as practicable.

All well sites and surface production facilities will be maintained in accordance with Rule 603.

All non-native materials, such as debris and waste, including but not limited to concrete, sack bentonite and other drilling mud additives, sand plastic, pipe and cable, as well as equipment associated with the drilling, re-entry, or completion operations, will be removed. All Exploration & Production (E&P) waste will be handled according to the 900 Series rules, and consistent with Bison's Waste Management Plan. Per Rule 1003.a, upon interim reclamation, Bison will remove and regrade any and all pits, cellars, rat holes, and other bore holes not required for future lease operations. All non-native materials such as road base, granular rock, concrete or similar pad surfacing materials placed in areas to be reclaimed will be removed. If deemed usable, road base and rock material may be salvaged for future use. Bison will keep the Surface Use Area as well as any roads or other areas used by Bison safe and in good order, including control of weeds litter and debris per Rule 606.

All E&P waste will be handled according to the 900 Series rules.

All guy line anchors will be brightly marked pursuant to Rule 603.j

1003.b. Areas no Longer in Use

All disturbed areas affected by drilling or subsequent operations, except areas reasonably needed for stabilization and maintenance for production operations and subsequent drilling operations to be commenced within twelve (12) months, will be reclaimed as nearly as practicable to their original condition or their final land use as designated by the surface owner no later than 6 months (weather permitting) after production is established and will be maintained to control dust and minimize erosion. If subsidence occurs in such areas, additional topsoil will be added to the depression and the land will be re-leveled as close to its original contour as practicable.



All holes unnecessary for further lease operations will be backfilled as soon as possible after the drilling rig is released to conform with surrounding terrain.

1003.c. Compaction Alleviation.

All areas compacted by drilling and subsequent oil and gas operations which are no longer needed following completion of such operations will be cross-ripped. Ripping will be undertaken to a depth of eighteen (18) inches unless bed rock is encountered at a shallower depth.

1003.d. Drilling pit closure

Location is closed loop. No pits on location, so no pit closure will be needed.

1003.e. Restoration and revegetation

All segregated soil horizons removed from non-crop lands will be replaced to their original relative positions and contour as near as practicable to achieve erosion control and long-term stability and will be tilled adequately in order to establish a proper seedbed. The disturbed area then will be reseeded in the first favorable season following rig demobilization. Reseeding with species consistent with the adjacent plant community is encouraged. In the absence of an agreement between Bison and the affected surface owner as to what seed mix should be used, Bison will consult with a representative of the local soil conservation district to determine the proper seed mix to use in revegetating the disturbed area. In an area where an operator has drilled or plans to drill multiple wells, in the absence of an agreement between Bison and the affected surface owner, Bison may rely upon previous advice given by the local soil conservation district in determining the proper seed mixes to be used in revegetating each type of terrain upon which operations are to be conducted.

Cut and fill areas to be reclaimed will be regraded to match pre-existing contours to the nearest extent possible to provide long term erosion control and site stability.

1003.f. Weed control

During drilling, production, and reclamation operations, all disturbed areas will be kept as free of all undesirable plant species designated to be noxious weeds as practicable with careful assessment of suitability and timing of integrated weed management tools conducted in compliance with the Colorado Noxious Weed Act and Weld County Weed Division options. Bison or contractor will conduct daily visual inspections for weeds.

Interim Reclamation Completion Notice

Bison will submit a Form 4 Sundry Notice describing the reclamation procedures, associated mitigation measures, changes to final land use, and total cover of live perennial vegetation to evaluate the success of interim reclamation with photo documentation as stipulated by Rule 1003.e.(3).



Article IV. Site-Specific Interim Reclamation Best Management Practices

Gathering Lines

Identify the pipeline and utility corridors that will be reclaimed.

- N/A. There are no proposed pipeline or utility corridors.

Access Road

Identify if portions of the access road system can be reclaimed.

- N/A. No portion of the access road will be reclaimed during interim reclamation.

Management of Waste Material:

- 1003.d. Drilling pit closure: Location is closed loop. No pits on location, so no pit closure will be needed.
- All E&P waste will be handled according to the 900 Series rules.

Establish Desired Self-Perpetuating Plant Community (1003.e.)

- All segregated soil horizons removed from non-crop lands will be replaced to their original relative positions and contour as near as practicable to achieve erosion control and long-term stability and will be tilled adequately in order to establish a proper seedbed. The disturbed area then will be reseeded in the first favorable season following rig demobilization. Reseeding with species consistent with the adjacent plant community will be coordinated with the surface owner.
- Bison will be responsible for segregating the topsoil, backfilling, re-compacting any backfill, reseeding, and re-contouring the surface of any disturbed area so as not to interfere with the surface owner's operations and will reclaim such area to be returned to preexisting conditions as best as possible with control of all weeds.
- Any interim reclamation will be reseeded in consultation with the surface owner and in accordance with Weld County's recommended mixes.

Management of Invasive Plants (1003.f.)

- No known weed infestations onsite.

Reporting

- When reclamation work is complete, Bison will provide the following forms to the ECMC documenting the work performed.
 - Form 4 Notice: Upon completion of work, Bison will submit a Form 4 Sundry Notice detailing the work performed along with a minimum of four (4) photographs in each cardinal direction or one



- (1) aerial photograph image taken with an unmanned aerial vehicle during the growing season to document successful vegetative growth.
- Form 45: Within six (6) months of completion of reclamation work, Bison will submit a site As-built verifying the work completion and accuracy of acreage returned to original site conditions.

Inspections

- Interim reclamation of all disturbed areas no longer in use will be considered complete when all ground surface disturbing activities at the site have been completed, and all disturbed areas have been either built on, compacted, covered, paved, or otherwise stabilized in such a way as to minimize erosion to the extent practicable, or a uniform vegetative cover has been established that reflects pre-disturbance or reference area forbs, shrubs, and grasses. The site will be inspected periodically in accordance with ECMC and CDPHE requirements. Pictures will be taken to document vegetative growth. The site will not be deemed as complete until vegetative cover exceeds 80%.

Article V. Exhibits/References/Appendices

Interim Reclamation sheet from Grading Plan

P:\BOLC__B220001\PROD\Grading\09 INTERIM RECLAMATION LAYOUT.dwg

BOOMHOG 8-59 3 PAD
GRADING PLAN

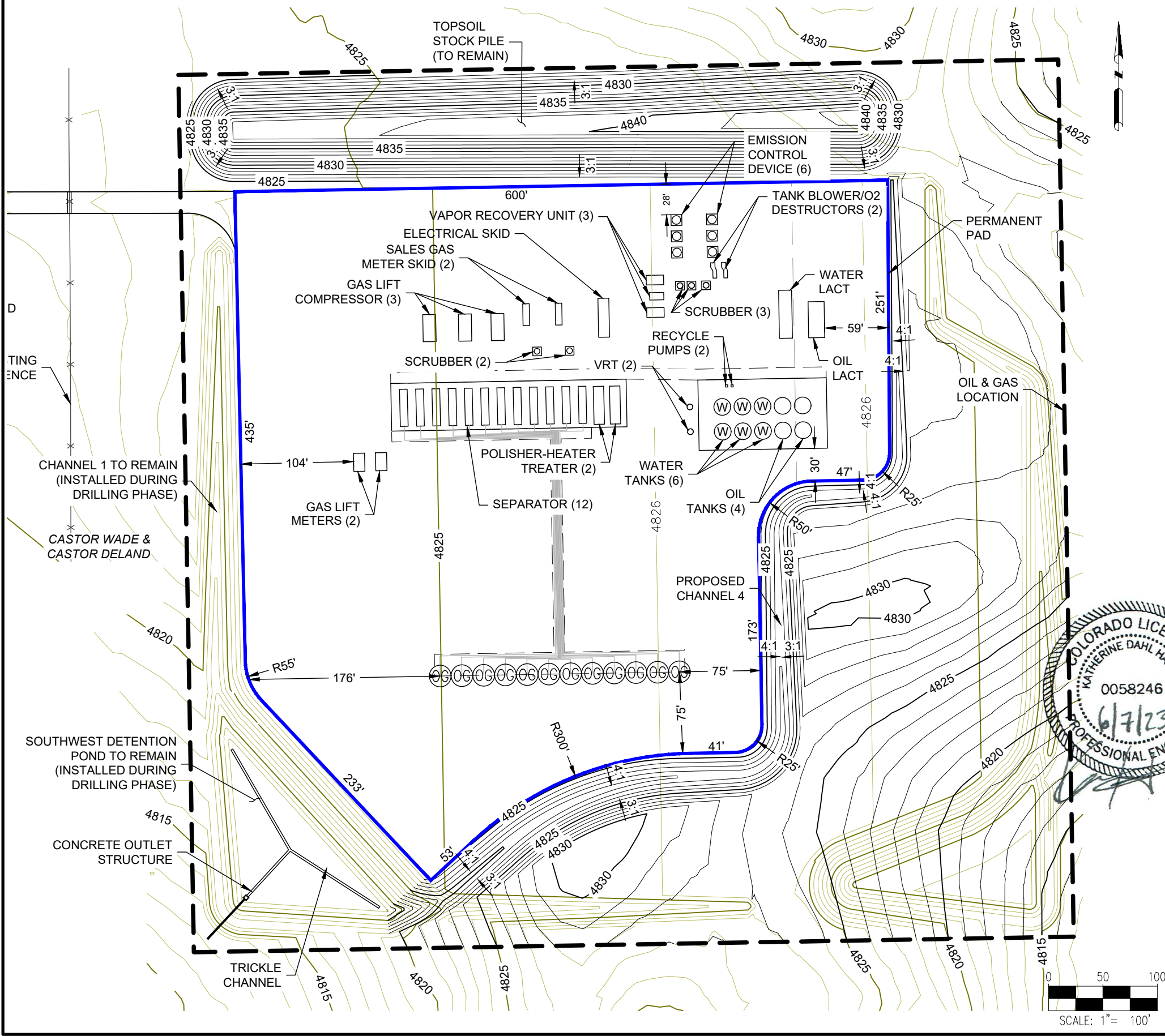

| SITE QUANTITIES | |
|----------------------------|------------|
| TOTAL CUT FOR SITE | 8,753 CY |
| TOTAL FILL FOR SITE | 8,199 CY |
| NET EXCESS MATERIAL | 554 CY |
| RECLAIMED AREA | 4.4 ACRES |
| PERMANENT DISTURBANCE AREA | 10.6 ACRES |
| OIL & GAS LOCATION AREA | 15.0 ACRES |

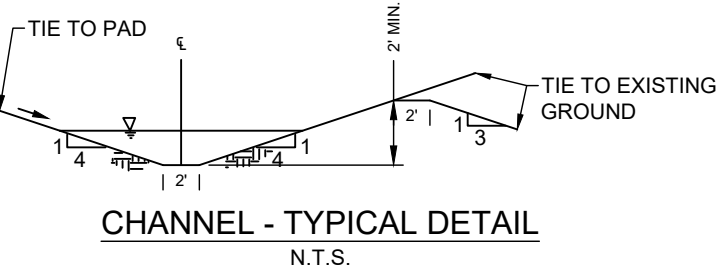

NOTES:
1. ASCENT GEOMATICS SOLUTIONS WAS NOT PROVIDED A TITLE REPORT FOR THIS SITE. ALL RECORDED DOCUMENTS REFERENCED ON THESE PLANS WERE DOWNLOADED FROM RESEARCH VIA THE WELD COUNTY CLERK AND RECORDER. ASCENT GEOMATICS SOLUTIONS MAKES NO GUARANTY OR WARRANTY, EITHER EXPRESSED OR IMPLIED, TO THE COMPLETENESS OF ENCUMBRANCES TO THE SUBJECT PROPERTY.

DISCLAIMER:
THIS PLOT DOES NOT REPRESENT A MONUMENTED LAND SURVEY AND SHOULD NOT BE RELIED UPON TO DETERMINE BOUNDARY LINES, PROPERTY OWNERSHIP OR OTHER PROPERTY INTERESTS. PARCEL LINES, IF DEPICTED HAVE NOT BEEN FIELD VERIFIED AND MAY BE BASED UPON PUBLICLY AVAILABLE DATA THAT ALSO HAS NOT BEEN INDEPENDENTLY VERIFIED.

| | |
|--------------------------------------------------------------------------------------------------------------------------------------------------|-------------------------|
| ASCENT GEOMATICS SOLUTIONS 8620 WOLFF COURT WESTMINSTER, CO 80031 (303) 928-7128 | |
| PREPARED FOR: BISON OPERATING LLC 518 17TH STREET, SUITE 1800 DENVER, CO 80202 720.644.6997 | |
| SHEET NAME: INTERIM RECLAMATION LAYOUT SURFACE LOCATION NW 1/4 SW 1/4 SECTION 3 TOWNSHIP 8 N, RANGE 59 W 6TH P.M. WELD COUNTY, CO | |
| REV. | DESCRIPTION |
| 0 | ISSUED FOR CONSTRUCTION |
| 1 | ISSUED FOR CONSTRUCTION |
| DRAWING DATE: 12/08/22 | |
| DRAFTED BY: SG | |
| SHEET NO. 09 OF 20 | |