

UNGRADED ELEVATION: 4164.5'

FINAL ELEVATION: 4164.0'

PROPOSED AREA OF DISTURBANCE: 3.5± ACRES

AREA OF WORKING PAD SURFACE: 2.1± ACRES

PROPOSED ACCESS DISTURBANCE: 2.3± ACRES

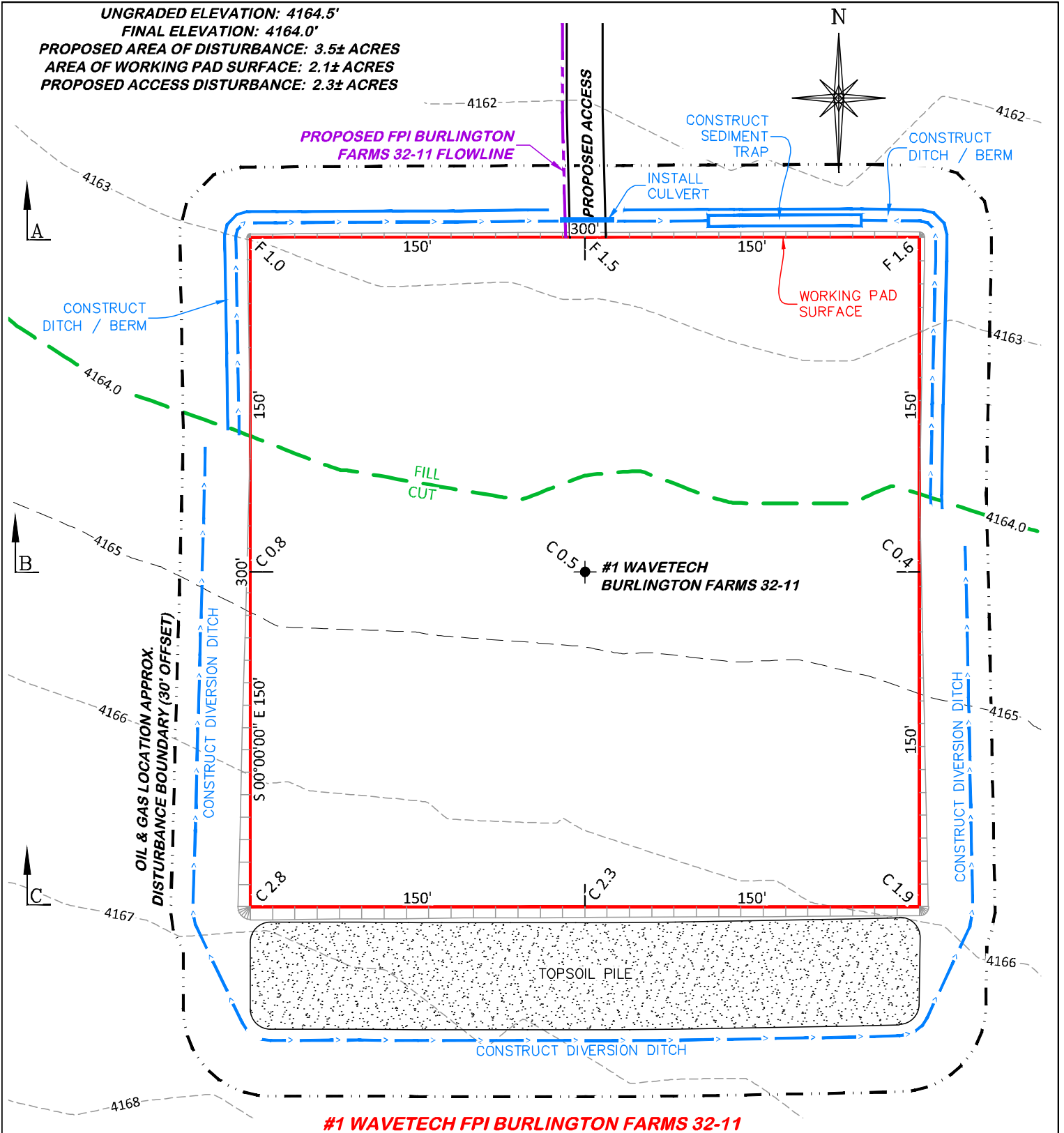

#1 WAVETECH FPI BURLINGTON FARMS 32-11

NOTE: THE EARTH QUANTITIES ON THIS DRAWING ARE ESTIMATED AND THE USE OF SAID QUANTITIES IS AT THE RESPONSIBILITY OF THE USER.

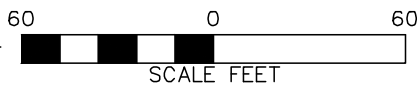

RIFFIN & ASSOCIATES, INC.

(307) 362-5028

1414 ELK ST., ROCK SPRINGS, WY 82901

CONSTRUCTION LAYOUT DRAWING 1 OF 5

PLAN

WAVETECH HELIUM, INC.

**#1 WAVETECH FPI BURLINGTON FARMS 32-11
SWNE, SECTION 11, T. 12 S., R. 43 W., 6th P.M.,
CHEYENNE COUNTY, COLORADO**

ESTIMATED EARTHWORK

	ITEM	CUT	FILL	TOPSOIL	EXCESS
DRAWN: 8/24/2022 - JMB/DWB	PAD	2,692 CY	898 CY	1,728 CY	66 CY
REVISED: 11/7/22 - JMB	PIT	NONE			NONE
COGCC REVISIONS	TOTALS	2,692 CY	898 CY	1,728 CY	66 CY

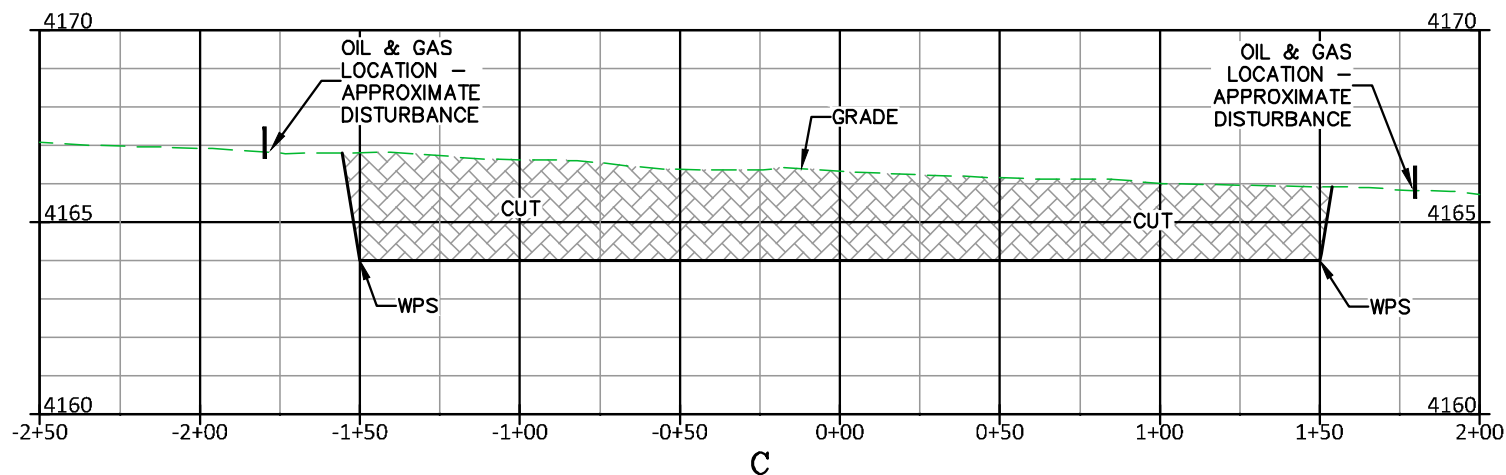
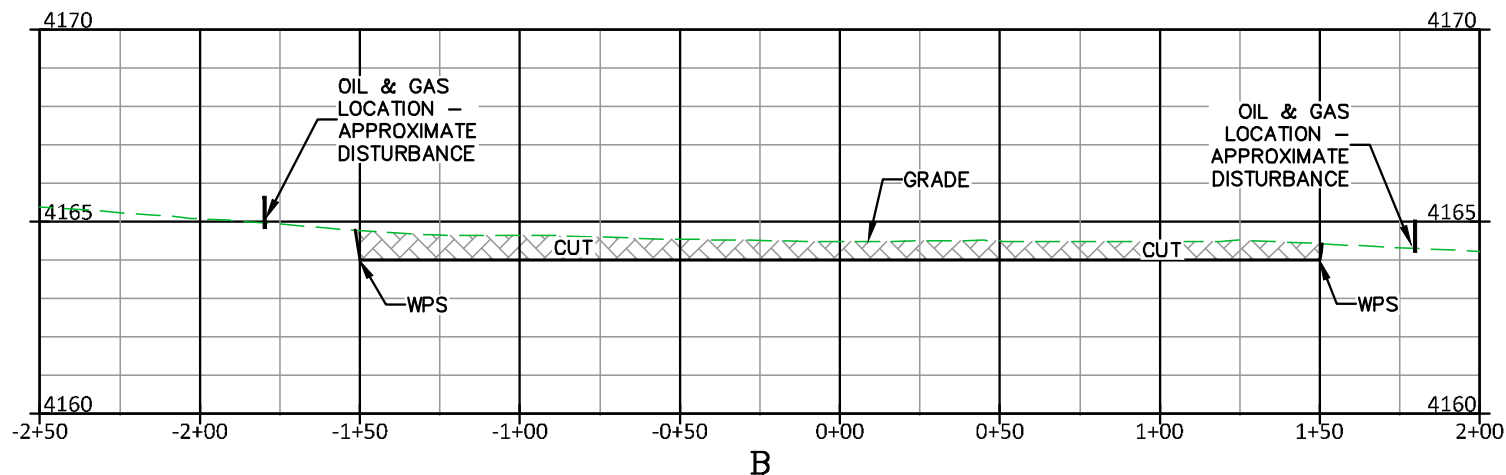
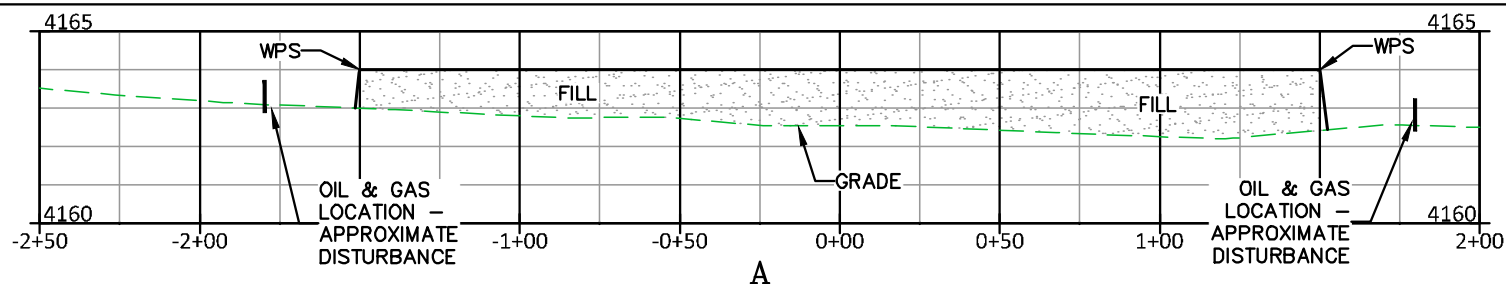

CUT SLOPES - 2:1

FILL SLOPES - 1.5:1

#1 WAVETECH FPI BURLINGTON FARMS 32-11



RIFFIN & ASSOCIATES, INC.

(307) 362-5028

1414 ELK ST., ROCK SPRINGS, WY 82901

DRAWN: 8/24/2022 - JMB/DWB

SCALE: H - 1" = 60' V - 1" = 5'

REVISED: 11/7/22 - JMB

DRG JOB No. 22272

COGCC REVISIONS

304b(7)Bi XSEC

CONSTRUCTION LAYOUT DRAWING 2 OF 5

**CONSTRUCTION LAYOUT DRAWING
CROSS-SECTIONS**

WAVETECH HELIUM, INC.

**#1 WAVETECH FPI BURLINGTON FARMS 32-11
SWNE, SECTION 11, T. 12 S., R. 43 W., 6th P.M.,
CHEYENNE COUNTY, COLORADO**

FINAL ELEVATION: 4164.0'

**PROPOSED FPI BURLINGTON
FARMS 32-11 FLOWLINE**

CONSTRUCT
SEDIMENT
TRAP

CONSTRUCT
DITCH / BERM

INSTALL CULVERT

WORKING PAD
SURFACE

CONSTRUCT
DITCH / BERM

**OIL & GAS LOCATION APPROX.
DISTURBANCE BOUNDARY (30' OFFSET)**

CONSTRUCT DIVERSION DITCH

4165
S 00°00'00" E 150'

C2.8

150

C0.5  **#1 WAVETECH**
BURLINGTON FARMS 32-11

C1.9

CONSTRUCT DIVERSION DITCH

CONSTRUCT DIVERSION DITCH

60 0 60

SCALE FEET

#1 WAVETECH FPI BURLINGTON FARMS 32-11



DRAWN: 8/24/2022 - JMB/DWB

SCALE: 1" = 60'

REVISED: 11/7/22 - JMB

DRG JOB No. 22272

COGCC REVISIONS

304b(7)Bi DSGN CONT

CONSTRUCTION LAYOUT DRAWING 3 OF 5

**CONSTRUCTION LAYOUT DRAWING
PLANNED CUT-FILL CONTOURS
WAVETECH HELIUM, INC.**

**#1 WAVETECH FPI BURLINGTON FARMS 32-11
SWNE, SECTION 11, T. 12 S., R. 43 W., 6th P.M.,
CHEYENNE COUNTY, COLORADO**

FINAL ELEVATION: 4164.0'

**PROPOSED FPI BURLINGTON
FARMS 32-11 FLOWLINE**

CONSTRUCT
SEDIMENT
TRAP

CONSTRUCT
DITCH / BERM

CONSTRUCT
DITCH / BERM

WORKING SURFACE

FILL
CUT

#1 WAVETECH
BURLINGTON

SPILL CONTROL DRUM

THE WHEEL

**OIL & GAS LOCATION APPROX.
DISTURBANCE BOUNDARY (30' OFFSET)**

CONSTRUCT DIVERSION DITCH

S 00°00'00" E 150'

C2.8

150'

☐ COMBUSTOR

MUD SKID	LC
----------	----

LCM TRAILER

WATER TANK

WATER TANK

VS

EMS

COG

TOPSOIL PILE

CONSTRUCT DIVERSION DITCH

60 0 60

SCALE FEET

#1 WAVETECH FPI BURLINGTON FARMS 32-11



RIFFIN & ASSOCIATES, INC.

(307) 362-5028

DRAWN: 8/24/2022 - JMB/DWB

SCALE: 1" = 60'

REVISED: 11/7/22 - JMB

DRG JOB No. 22272

COGCC REVISIONS

304b(7)Bii RIG

CONSTRUCTION LAYOUT DRAWING 4 OF 5

PRELIMINARY RIG LAYOUT DRAWING
WAVETECH HELIUM, INC.

**#1 WAVETECH FPI BURLINGTON FARMS 32-11
SWNE, SECTION 11, T. 12 S., R. 43 W., 6th P.M.,
CHEYENNE COUNTY, COLORADO**

APPROXIMATE DISTURBANCE AREA 3.5± ACRES
 PROPOSED RECLAMATION AREA: 2.3± ACRES
 INTERIM RECLAMATION DISTURBANCE: 1.2± ACRES

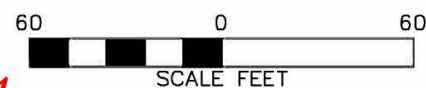
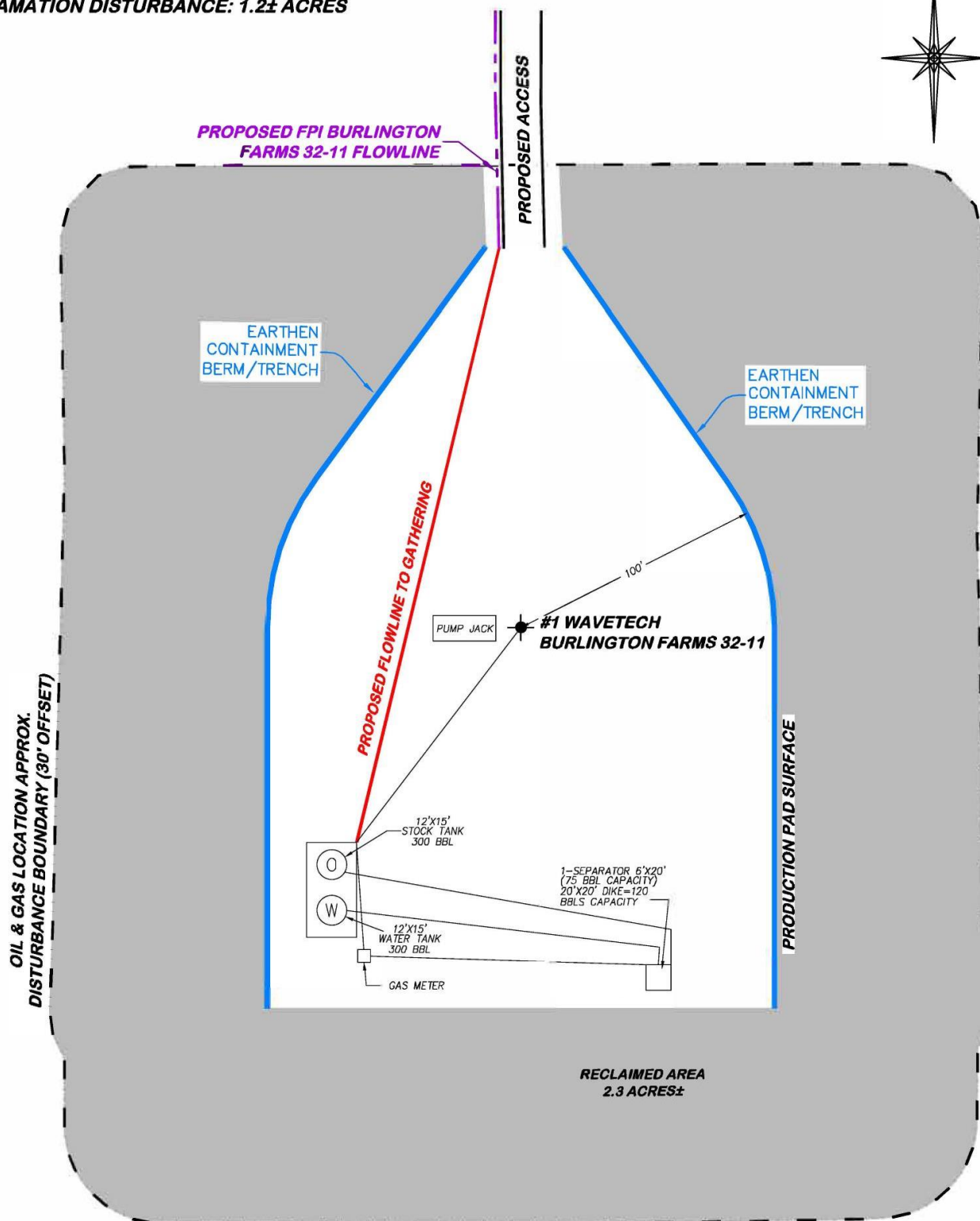
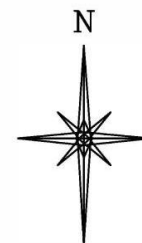

#1 WAVETECH FPI BURLINGTON FARMS 32-11

CONSTRUCTION LAYOUT DRAWING 5 OF 5



DRG RIFFIN & ASSOCIATES, INC.
 1414 ELK ST., ROCK SPRINGS, WY 82901

(307) 362-5028

DRAWN: 8/24/2022 - JMB/DWB

SCALE: 1" = 60'

REVISED: 11/7/22 - JMB

DRG JOB No. 22272

COGCC REVISIONS

304b(7)Bv FACILITY

FACILITY LAYOUT DRAWING
WAVETECH HELIUM, INC.

#1 WAVETECH FPI BURLINGTON FARMS 32-11
SWNE, SECTION 11, T. 12 S., R. 43 W., 6th P.M.,
CHEYENNE COUNTY, COLORADO