



**VIA EFORMS**

Director Julie Murphy  
Colorado Oil & Gas Conservation Commission  
1120 Lincoln Street, Suite 801  
Denver, CO 80203

May 19, 2023

RE: Rule 304.d. Lesser Impact Exemption Request  
Wavetech Helium Inc.  
1 Wavetech FPI Burlington Farms 43-2 Wellpad  
T12S R43W Sec. 2: NE/4SE/4  
Cheyenne County, Colorado

Dear Director Murphy:

Wavetech Helium Inc. (Wavetech) respectfully requests that the Director grant a Lesser Impact Exemption pursuant to Colorado Oil and Gas Conservation Commission (COGCC) Rule 304.d. for the above referenced wellpad.

COGCC Rule 304.d. stipulates that the Director may exempt an Operator from submitting any of the information required by Rule 304.b, or any plan required by Rule 304.c under certain circumstances:

*The impacted resource or resource concern are not present in the area; or  
Impacts to the resource will be so minimal as to pose no concern.*

The Lesser Impact Area exemptions are listed on Appendix A with all applicable information as requested by COGCC.

Wavetech requests the Director approve the proposed Lesser Impact Exemption requests.

Please send a copy of all correspondence to Upstream Petroleum Management, Inc. at 7000 S. Yosemite St., Suite 290B, Englewood, CO 80112. Please contact me at 303-942-0506 or at [agross@upstreampm.com](mailto:agross@upstreampm.com) if you have any questions.

Sincerely,

Andrea Gross  
Permit Agent for Wavetech Helium, Inc.

**Your Assets / Our Expertise**

- Regulatory
- Storm-water Management Plans
- Project Coordination
- Permitting
- Government Relations
- EA/EIS Assistance

**Exemption requested from: Rule 304.c.(2) & 423.a. Noise Mitigation Plan**

**Resource concern: Noise impacts to People and Wildlife**

**Exemption Circumstance: Impact to Resource is minimal.**

**Description:** This location is in a very remote area. A review of available map data and plats indicates there are no building units within 5,280' from the proposed working pad surface. Based on this distance from the wellpad, it is unlikely that on-site noise will adversely affect the nearest building units.

The location is within the Lesser Prairie Chicken (LPC) Estimated Occupied Range. In Eastern Colorado, in the locale of the proposed project, the LPC is typically associated with native grasslands, sandsage, and with lands managed under the Conservation Reserve Program (CRP). Habitats and landcover types other than these, including agricultural crops, are not considered suitable LPC habitats. The U.S Fish and Wildlife Service (USFWS) has suggested LPC may avoid otherwise suitable habitats that are within 1,800 meters (5,905 feet) within an existing wind turbine (USFWS 2021<sup>1</sup>). Included in the *Range-Wide Oil and Gas Candidate Conservation Agreement with Assurances for the Lesser Prairie-Chicken (Tympanuchus pallidicinctus) in Colorado, Kansas, New Mexico, Oklahoma and Texas*" (USFWS and WAFWA 2014) is a noise minimization measure that precludes noise levels greater than 75 decibals (dB) for facility construction and operation activities within 1.25 miles of a known lek.

A biological reconnaissance survey was completed at the proposed site on August 29, 2022. At the time of this survey, the habitat at the proposed location was agriculture. A review of publicly available aerial imagery indicates the parcel in which the project is proposed has been used for agricultural practices routinely since 1993. Five (5) operational wind turbines exist within 1,800 of the proposed working pad surface. The closest windmill is 4,388' (1337m) from the working pad surface. The next closest windmill is 4,940' (1506m) from the working pad surface. The proposed working pad surface is 3.3 miles from a known lek.

Based on the lack of suitable LPC habitat at the proposed location, the existence of five (5) wind turbines within 1,800 meters, and a distance greater than 1.5 miles from a known lek, implementation of the proposed project is not expected to have any impacts on LPC. Implementation of the proposed project would not alter or remove suitable LPC habitat. LPC are expected to avoid the areas associated with the proposed project based on the absence of suitable vegetative cover and because of the presence of (5) five existing wind turbines. As such, implementation of the proposed project is not expected to directly or indirectly impact LPC. Lastly, noise levels associated with the proposed construction and operation of the project are not expected to impact LPC based on their absence in habitats associated with the project location and based on the extreme distance from a known lek.

The noisiest phase of the project will be during the construction and re-entry phase which will last approximately 15 days. The proposed location will utilize a work-over rig. Work-over rigs will comply with the COGCC Commercial/Agriculture permissible noise levels. Per a conversation with Karen Voltura, the Commercial/Agriculture permissible noise levels are acceptable in this area. Due to the short and temporary duration of these phases, impacts to wildlife will be minimal.

There will be minimal long-term noise impacts during the production phase due to truck traffic. There will not be any compressors on location. All gas will utilize an existing gas gathering system. Any oil or

---

<sup>1</sup> LPC Conservation LLC (2021). Renewable (Wind and Solar) Energy, Power Line, and Communication Tower Habitat Conservation Plan for the Lesser Prairie-chicken. Colorado, Kansas, New Mexico, Oklahoma, and Texas. Available online at: [https://www.fws.gov/sites/default/files/documents/508%20Compliant%20LEPC%20Renewables%20HCP\\_07.20.2021\\_rev.pdf](https://www.fws.gov/sites/default/files/documents/508%20Compliant%20LEPC%20Renewables%20HCP_07.20.2021_rev.pdf). Accessed on September 12, 2022

produced water will be stored on location in tanks and hauled by truck off location 1-2 times per week. To conclude, the resource concern (LPC) is not present in the area and the distance to a known lek is great enough that potential impacts will be minimal.

**Exemption requested from: Rule 304.c.(3) & 424.a. Light Mitigation Plan**

**Resource concern: Light impacts to People and Wildlife**

**Exemption Circumstance: Impact to Resource is minimal.**

Description: A review of available map data and plats indicates there are no building units within 5,280' from the proposed working pad surface. Based on this distance from the wellpad, it is unlikely that on-site lighting will adversely affect the nearest building units. The distance from the Working Pad Surface to the nearest public road is greater than one mile. Lighting will not impact traffic. The public road is not heavily used. No permanent lighting will be installed. Light during night hours may only occur during the drilling phase which will last no more than 7 days. If Lighting will be limited to rig-mounted lighting that will be cast downward during well drilling. Lighting will be removed after well drilling. The location will not be lit during completion or production. However, the nearby wind turbines do have lights per FAA regulations. The additional lights will not cumulatively impact the wildlife.

The location is within the Lesser Prairie Chicken (LPC) Estimated Occupied Range. In Eastern Colorado, in the locale of the proposed project, the LPC is typically associated with native grasslands, sandsage, and with lands managed under the Conservation Reserve Program (CRP). Habitats and landcover types other than these, including agricultural crops, are not considered suitable LPC habitats. The U.S Fish and Wildlife Service (USFWS) has suggested LPC may avoid otherwise suitable habitats that are within 1,800 meters (5,905 feet) within an existing wind turbine (USFWS 2021).

A biological reconnaissance survey was completed at the proposed site on August 29, 2022. At the time of this survey, the habitat at the proposed location was agriculture (sorghum). A review of publicly available aerial imagery indicates the parcel in which the project is proposed has been used for agricultural practices routinely since 1993. Five (5) operational wind turbines exist within 1,800m of the proposed working pad surface. The proposed working pad surface is 3.3 miles from a known lek.

Based on the lack of suitable habitats at the proposed location and the expected lack of occurrence of LPC in the area associated with the proposed location, any new temporary light sources associated with the proposed project will result in minimal impacts on LPC. The *resource concern* (LPC) *is not present in the area.*

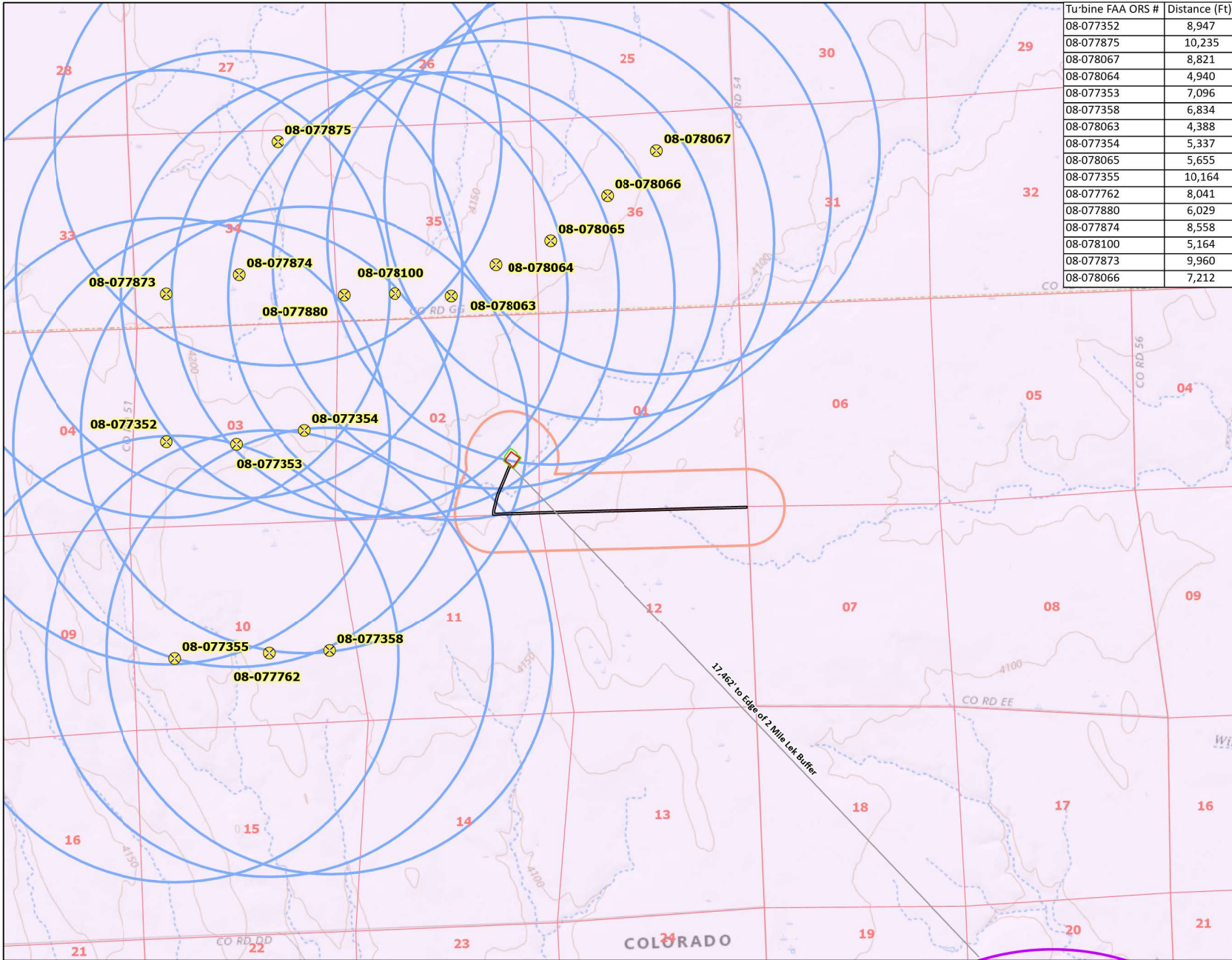

Turbine FAA ORS #	Distance (Ft)
08-077352	8,947
08-077875	10,235
08-078067	8,821
08-078064	4,940
08-077353	7,096
08-077358	6,834
08-078063	4,388
08-077354	5,337
08-078065	5,655
08-077355	10,164
08-077762	8,041
08-077880	6,029
08-077874	8,558
08-078100	5,164
08-077873	9,960
08-078066	7,212

### Legend

- Proposed Access Road
- Proposed Oil and Gas Location
- Proposed Working Pad Surface
- Lesse- Prairie Chicken Lek Buffer
- LPC Estimated Occupied Range
- LPC Connectivity Area
- 1,800m Turbine Buffer
- 300m Project Buffer
- Wind Turbine Location

No other CPW High Priority Habitats were evident in this area.  
 Source: [https://cogcc.state.co.us/documents/data/downloads/gis/CPW\\_HPH\\_for\\_309e\\_1202c\\_1202d\\_20211231.zip](https://cogcc.state.co.us/documents/data/downloads/gis/CPW_HPH_for_309e_1202c_1202d_20211231.zip)

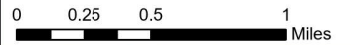

**WAVETECH ENERGY, INC.**  
**1 WAVETECH FPI BURLINGTON FARMS 43-2**  
**SEC. 2 T12S R43W (NE/4 SE/4)**  
**CHEYENNE COUNTY, COLORADO**  
**SURFACE: FEE**  
**TURBINE DISTANCES**

Coordinate System: NAD 83 StatePlane  
 Colorado South FIPS 0503 Feet

Prepared By: REDHAWK GIS

Date Saved: 2/12/2023 11:39 AM

APPROXIMATE DISTURBANCE AREA 3.4± ACRES  
 PROPOSED RECLAMATION AREA: 2.3± ACRES  
 INTERIM RECLAMATION DISTURBANCE: 1.1± ACRES

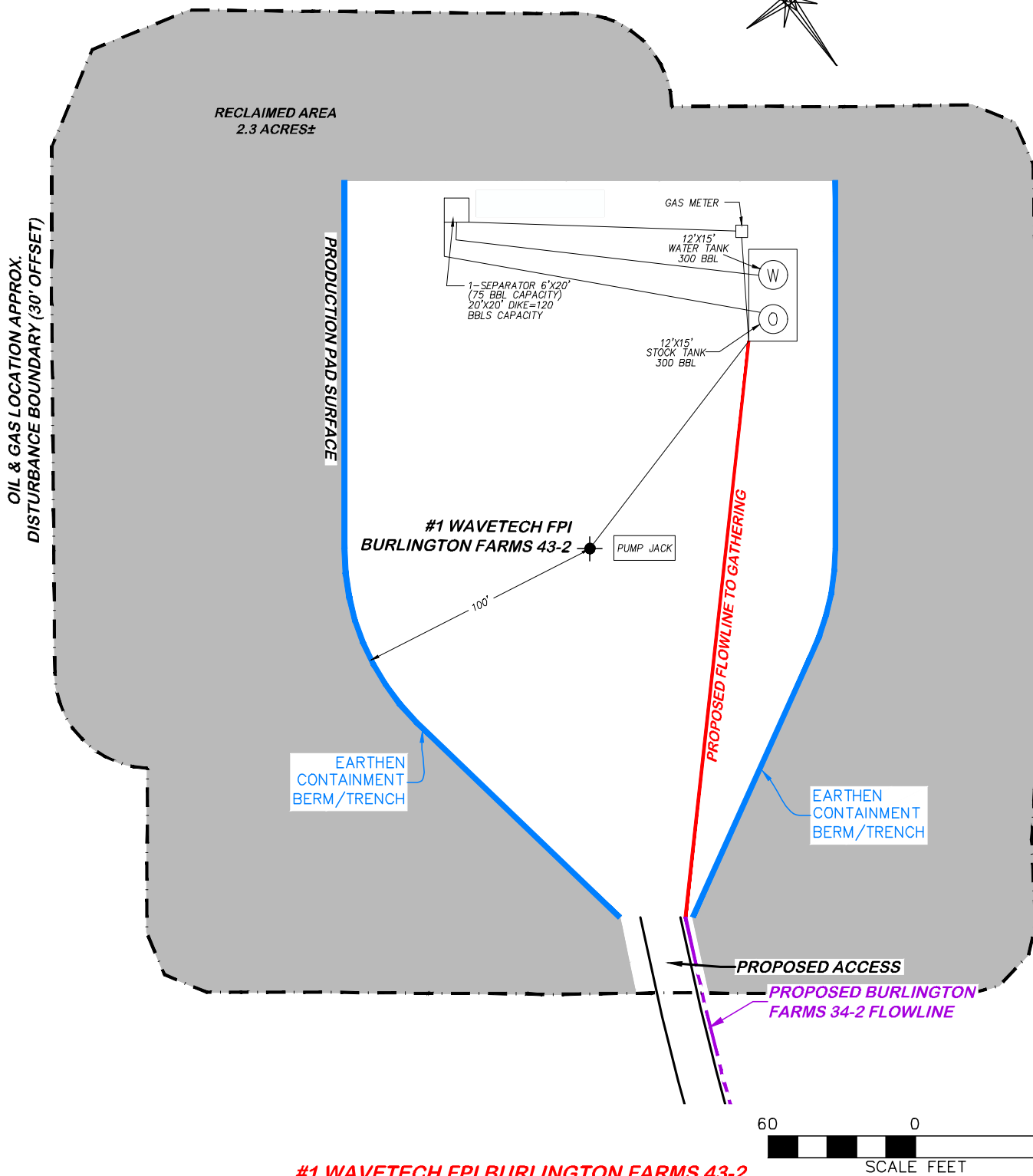
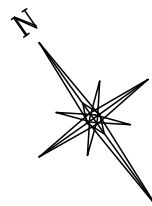

**#1 WAVETECH FPI BURLINGTON FARMS 43-2**

**CONSTRUCTION LAYOUT DRAWING 5 OF 5**

**DRG RIFFIN & ASSOCIATES, INC.**  
 (307) 362-5028 1414 ELK ST., ROCK SPRINGS, WY 82901

**FACILITY LAYOUT DRAWING**  
**WAVETECH HELIUM, INC.**  
**#1 WAVETECH FPI BURLINGTON FARMS 43-2**  
**NESE, SECTION 2, T. 12 S., R. 43 W., 6th P.M.,**  
**CHEYENNE COUNTY, COLORADO**

DRAWN: 8/4/22 - JMB/DEH

SCALE: 1" = 60'

REVISED: 10-21-22-DWB

DRG JOB No. 22270

PRODUCTION EQUIPMENT

304b(7)Bv FACILITY

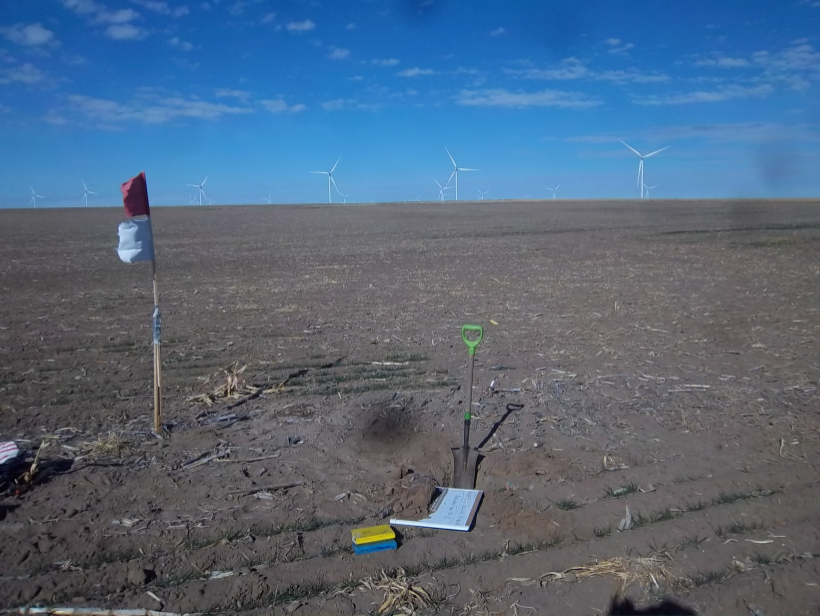

**T. 12 S.**

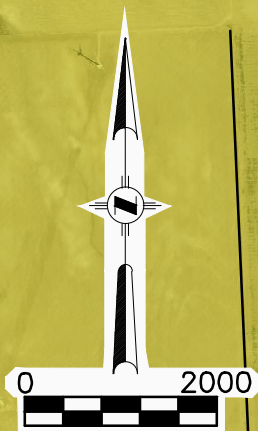

35

**KIT CARSON CO., COLORADO**

**CHEYENNE CO., COLORADO**

PROPOSED #1 WAVETECH FPI BURLINGTON FARMS 43-2 DISTURBANCE AREA

#1 WAVETECH FPI BURLINGTON FARMS 43-2 PROPOSED ACCESS ROAD

EAST BIG TIMBER #6-1

EAST BIG TIMBER ##11-1

PROPOSED #1 WAVETECH FPI BURLINGTON FARMS 43-2 WORKING PAD SURFACE

ROSA 31-10 #1

REVEILLE 21-12 #1

CO RD 54

CARWILA 2 #1

PROPOSED #1 WAVETECH FPI BURLINGTON FARMS 43-2 FLOWLINE

EIGER 42-11 #2

**R. 43 W.**

11

EIGER 43-11 #3

12

10

EIGER 14-11 #1

SANCTION 41-15 #1



PROPOSED WORKING PAD AND DISTURBANCE AREA



RULE 309.e.1 OTHER CONSULTATION HABITAT - LESSER PRAIRIE CHICKEN ESTIMATED OCCUPIED RANGE



PROPOSED FLOWLINE



PROPOSED ACCESS ROAD



ONE MILE BUFFER

**QUADRANGLES MOUNT SUNFLOWER SW**

**#1 WAVETECH FPI BURLINGTON FARMS 43-2**

**WILDLIFE HABITAT DRAWING**



**DRG RIFFIN & ASSOCIATES, INC.**

(307) 362-5028

1414 ELK ST., ROCK SPRINGS, WY 82901

DRAWN: 8/4/22 - JMB/DEH

SCALE: 1" = 2000'

REVISED: 2-23-23 - DWB

DRG JOB No. 22270

PAD ADJUSTMENT

304b(7)C WILDLIFE

**WAVETECH HELIUM, INC.  
#1 WAVETECH FPI BURLINGTON FARMS 43-2  
NESE, SECTION 2, T. 12 S., R. 43 W., 6th P.M.,  
CHEYENNE COUNTY, COLORADO**