



T. 12 S.

KIT CARSON CO., COLORADO

CHEYENNE CO., COLORADO

WETLANDS LEGEND

-  RIVERINE - INTERMITTENT - STREAMBED - TEMPORARILY FLOODED
-  PALUSTRINE - EMERGENT - PERSISTENT - TEMPORARILY FLOODED
-  PALUSTRINE - EMERGENT - PERSISTENT - TEMPORARILY FLOODED

WETLANDS NOTE
WETLANDS LOCATION AND DATA PROVIDED BY UNITED STATES FISH AND WILDLIFE SERVICE (USFWS).

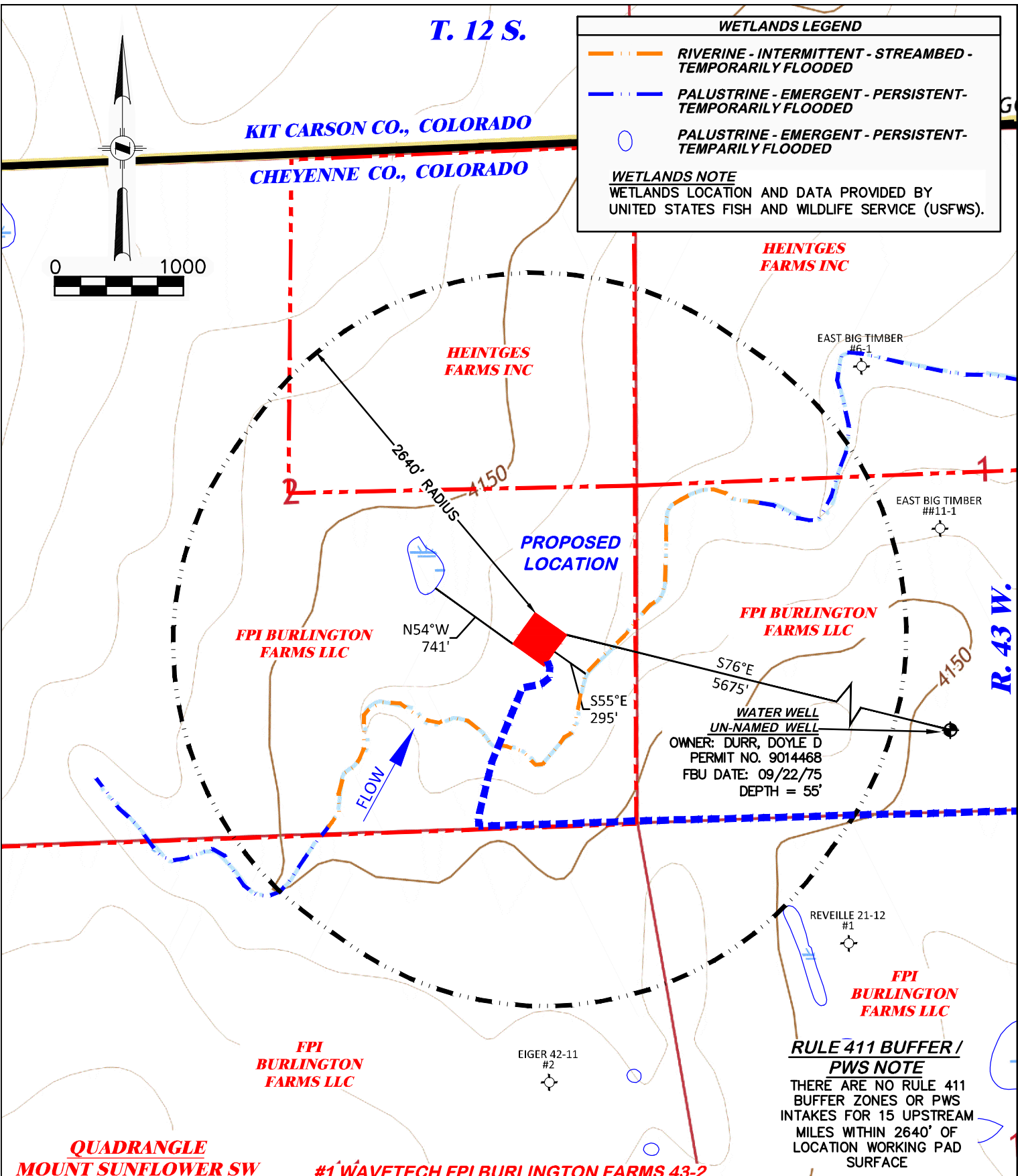

RULE 411 BUFFER / PWS NOTE
THERE ARE NO RULE 411 BUFFER ZONES OR PWS INTAKES FOR 15 UPSTREAM MILES WITHIN 2640' OF LOCATION WORKING PAD SURFACE

QUADRANGLE MOUNT SUNFLOWER SW #1 WAVETECH FPI BURLINGTON FARMS 43-2

DRG RIFFIN & ASSOCIATES, INC.
(307) 362-5028 1414 ELK ST., ROCK SPRINGS, WY 82901

DRAWN: 8/4/22 - JMB/DEH	SCALE: 1" = 1000'
REVISED: 2-23-23 - DWB	DRG JOB No. 22270
PAD ADJUSTMENT	304b(7)E HYDRO

HYDROLOGY MAP

WAVETECH HELIUM, INC.
#1 WAVETECH FPI BURLINGTON FARMS 43-2
NESE, SECTION 2, T. 12 S., R. 43 W., 6th P.M.,
CHEYENNE COUNTY, COLORADO

HISTORIC SPRING 

EXISTING ROAD 