

C Street Directional

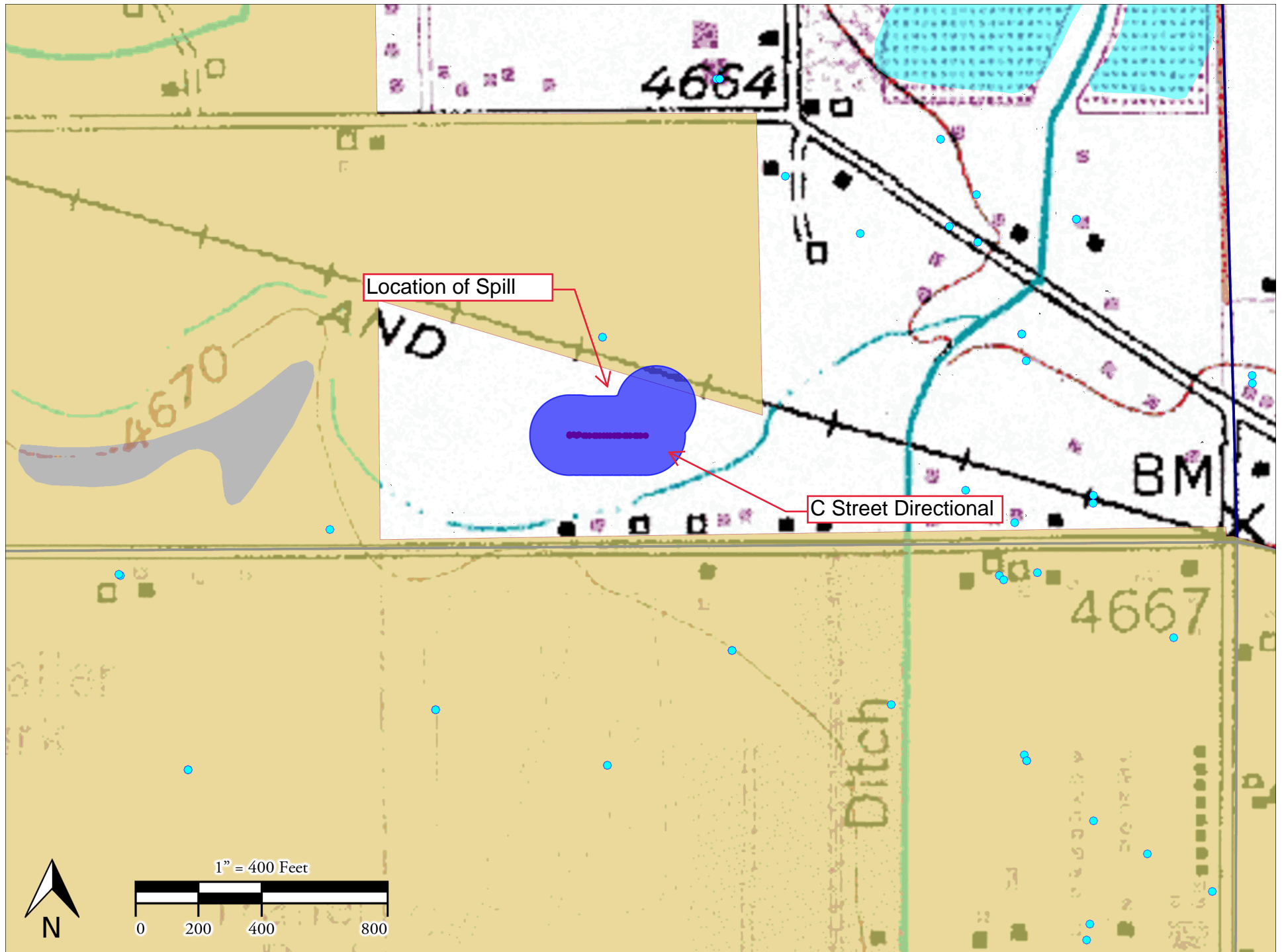

C Street Directional

Legend

CS-Bittersweet 3-1-13 Separator

Spill Area



CS-Bittersweet 3-1-13 Separator



#28060

SC-BITTERSWEET 3-1-13 (N) 12200 FT

NO SMOKING

CORROSIVE

DANGER

HIGH PRESSURE GAS

FLAMMABLE LIQUID

DigiPix Signs - (970) 674-3310 - digipixsigns.com

1267
3

EXTRACTION
Oil & Gas
370 17th Street, Suite 5200
Denver, CO 80202
(720) 557-8300

2

4

0

DANGER - HIGH PRESSURE GAS/
HAZARDOUS CHEMICALS/
FLAMMABLE LIQUID

IN CASE OF EMERGENCY CALL: (720) 370-5540

IN CASE OF FIRE OR MEDICAL EMERGENCY CALL: 911

PETROLEUM CRUDE OIL
-CAS.NO. 8002-05-9

NATURAL GAS CONDENSATE
-CAS.NO. 689-19-39-1

POSSIBLE HAZARDS - ACUTE AND CHRONIC
HEALTH HAZARDS / CORROSIVE / HYDROGEN
SULFIDE CAS. NO. 7783-06-4

AUTHORIZED PERSONNEL ONLY - NO TRESPASSING

NO SMOKING OR OPEN FLAMES

ALL PERSONNEL SHALL WEAR APPROPRIATE
PROTECTIVE CLOTHING AND SAFETY EQUIPMENT
WHEN WORKING ON OR NEAR THIS EQUIPMENT

REPORT ALL LEAKS AND SPILLS TO EXTRACTION OIL AND GAS

SAFETY DATA SHEETS CAN BE OBTAINED
BY WRITING OR CALLING EXTRACTION OIL AND GAS

SC-Bittersweet 3-1-13

29 Aug 2023, 11:38:26 AM

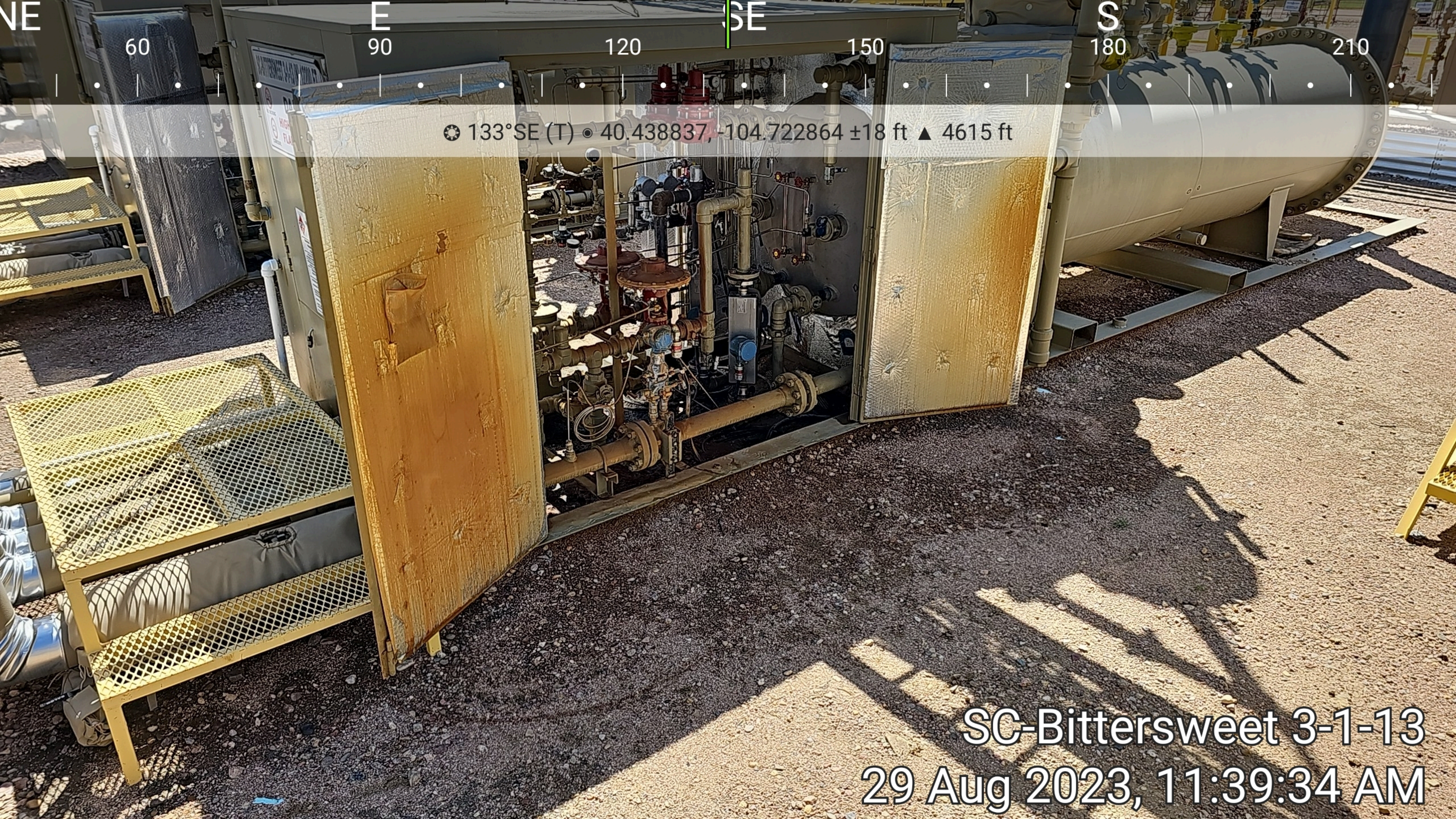

☉ 133°SE (T) • 40.438837, -104.722864 ±18 ft ▲ 4615 ft

SC-Bittersweet 3-1-13
29 Aug 2023, 11:39:34 AM

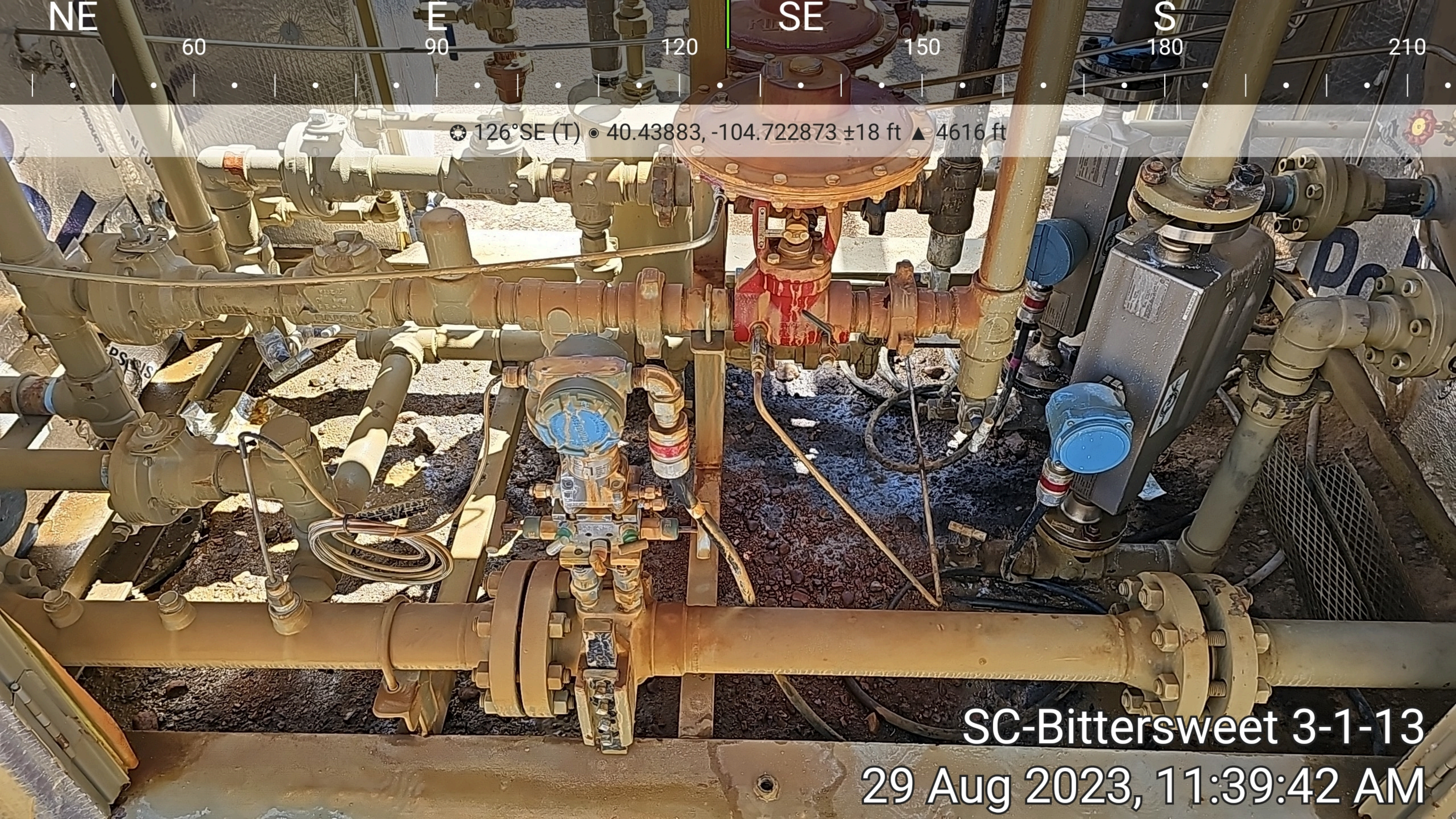

126°SE (T) • 40.43883, -104.722873 ±18 ft ▲ 4616 ft

SC-Bittersweet 3-1-13

29 Aug 2023, 11:39:42 AM



NW

N

300

330

0

30

☀ 343°NW (T) ● 40.438809, -104.722868 ±18 ft ▲ 4614 ft

SC-Bittersweet 3-1-13

29 Aug 2023, 11:39:52 AM



W
270

NW
330

N
0

NE
30

60

332°NW (T) • 40.438784, -104.722866 ±21 ft ▲ 4614 ft

SC-Bittersweet 3-1-13
29 Aug 2023, 11:40:35 AM



SW

24 VDC MAY BE PRESENT

W

NV

210

240

270

300

257°SW (T) 40.438793, -104.722847 ±16 ft 4614 ft

SC-Bittersweet 3-1-13

29 Aug 2023, 11:40:41 AM



309°NW (T) 40.438794, -104.722845 ±16 ft 4614 ft

SC-Bittersweet 3-1-13
29 Aug 2023, 11:40:51 AM



240

W

270

300

NW

330

☉ 291°W (T) ☉ 40.438808, -104.722833 ±18 ft ▲ 4614 ft

SC-Bittersweet 3-1-13

29 Aug 2023, 11:41:00 AM

☀ 56°NE (T) • 40.438572, -104.722295 ±28 ft ▲ 4616 ft



SC-KINKADE 5-1-12	CS-KINKADE 4-1-13	CS-KINKADE 2-1-13	CS-KINKADE 1-1-13
CS-KINKADE 3-1-13	SC-KINKADE C6-1-13	SC-KINKADE C8-1-13	SC-SCOTT 5-1-13
SC-SCOTT 1-1-12	SC-SCOTT 4-1-13	SC-SCOTT 2-1-12	SC-SCOTT C2-1-13
SC-SCOTT C4-1-13	SC-LONGMEADOW 2-1-13	SC-LONGMEADOW 1-1-13	SC-SHERWOOD 2-1-13
SC-SHERWOOD 1-1-13	SC-SHERWOOD 3-1-13	SC-BITTERSWEET C1-1-13	SC-BITTERSWEET 3-1-13

DANGER

**NO SMOKING
OR OPEN FLAMES**

CAUTION

**AUTHORIZED
PERSONNEL ONLY**

PPE REQUIRED

SWSE SEC36 T6N R66W
WELD COUNTY, CO
NORTH 35TH AVE & C STREET, EAST 1/2, NORTH INTO
LAT 40.43839, LONG -104.72262

AUTHORIZED PERSONNEL ONLY
ALL PERSONNEL WILL WEAR APPROPRIATE PROTECTIVE CLOTHING AND SAFETY EQUIPMENT
WHEN WORKING ON AND NEAR THIS EQUIPMENT

HEALTH FLAMMABLE CORROSIVE POISON NO SMOKING
REPORT ALL LEAKS TO THE COMPANY SAFETY AND HAZARDOUS MATERIAL COORDINATOR
MATERIAL SAFETY DATA SHEETS CAN BE OBTAINED BY WRITING OR CALLING THE COMPANY SAFETY
AND HAZARDOUS CHEMICAL COORDINATOR

DANGER
HIGH PRESSURE GAS
EXTREMELY HAZARDOUS CHEMICALS
FLAMMABLE LIQUID
PETROLEUM CRUDE OIL - NATURAL GAS CONDENSATE
CAS NO. 800-80-00-9 CAS NO. 800-19-30-1
POSSIBLE HYDROGEN SULFIDE

CAS NO. 7782-62-4
POSSIBLE CORROSIVE HAZARD
ACUTE AND CHRONIC HEALTH HAZARD

IN CASE OF EMERGENCY CALL
(720) 370-5540
IN CASE OF FIRE OR MEDICAL EMERGENCY
CALL 911

SC-Bittersweet 3-1-13
29 Aug 2023, 4:11:22 PM

HARD HATS, STEEL TOED BOOTS,
SAFETY GLASSES, EAR PROTECTION
REQUIRED BEYOND THIS POINT
FR CLOTHING RECOMMENDED