

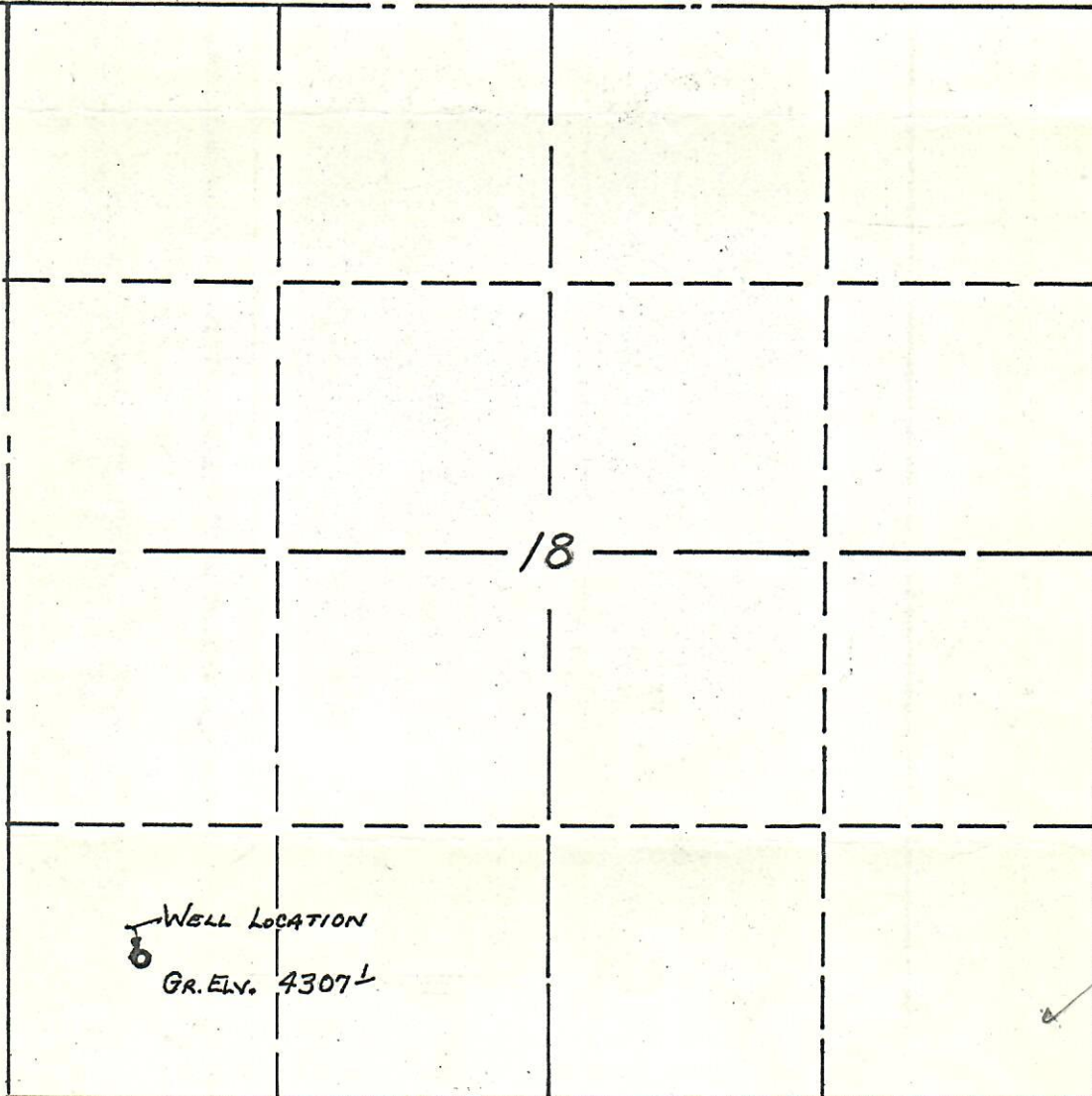
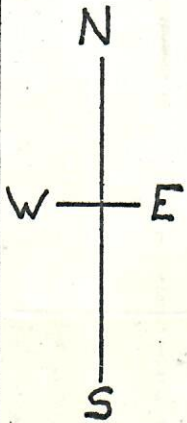

FEB 8 - 1965

FRONTIER PRODUCING OF COLORADO, LTD.

OIL & GAS
CONSERVATION COMMISSIONTo: ~~REVENUE PROPERTIES, INC.~~ c/o JACK TRIGG, BOULDER, COLORADOLEASE LOCATION: SEC. 18, T. 33, S., R. 45 W., 6TH P.M.WELL NAME: ^{Frontier} ~~MATHEWS~~ No. 1 LOCATION: CEN. SW¹/₄, SW¹/₄COUNTY: BACH STATE: COLORADO

I, HEREBY CERTIFY THAT THE WELL LOCATION
SHOWN ON THE ABOVE PLAT WAS STAKED AND
MEASURED AS SHOWN ON THIS PLAT.

DATE: JAN. 21, 1965

Shawn S. Kelly
REGISTERED ENGINEER
LAND, COLO.

65 37