

## Legend

- P&A'd Wellhead
- Soil Sample Location
- Soil Screening Location
- Shallow Soil Vapor Point (SVP) Location
- Background Soil Sample Location
- Approximate Location of Flowline (Removed)
- Excavation Extent

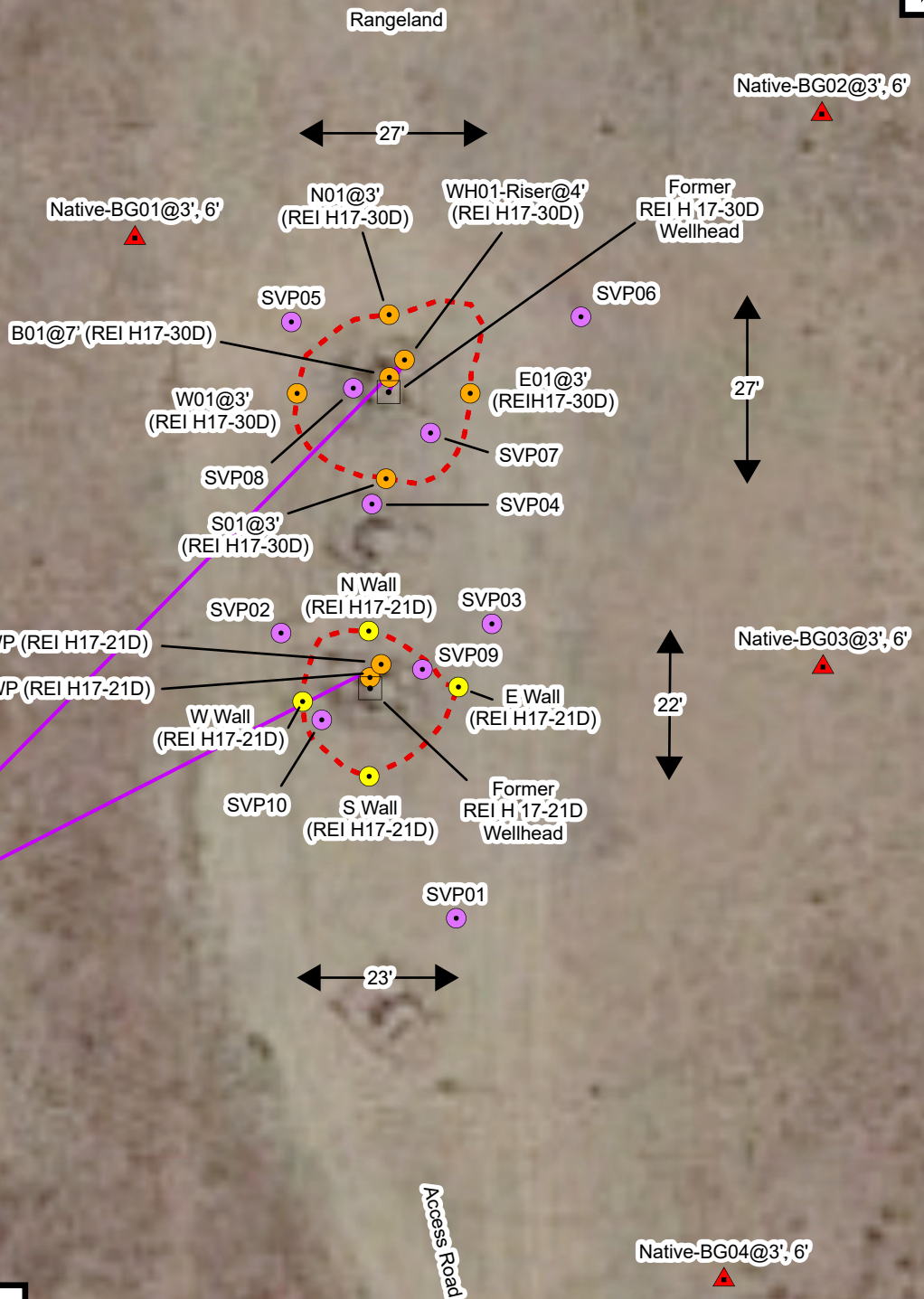

0 25 50 Feet

Sources: Environmental Systems Research Institute (ESRI)

## Wellhead Excavation Site Map

REI H 17-21D, 30D Wellheads  
Kerr-McGee Oil & Gas Onshore, LP  
NWNW SEC 17-T3N-R65W  
Weld County, CO

Project Number: 09A1417235

FIGURE

1