



00594858

RECEIVED

JUL 8 1976

COLO. OIL & GAS CONS. COMM.

R. 43W

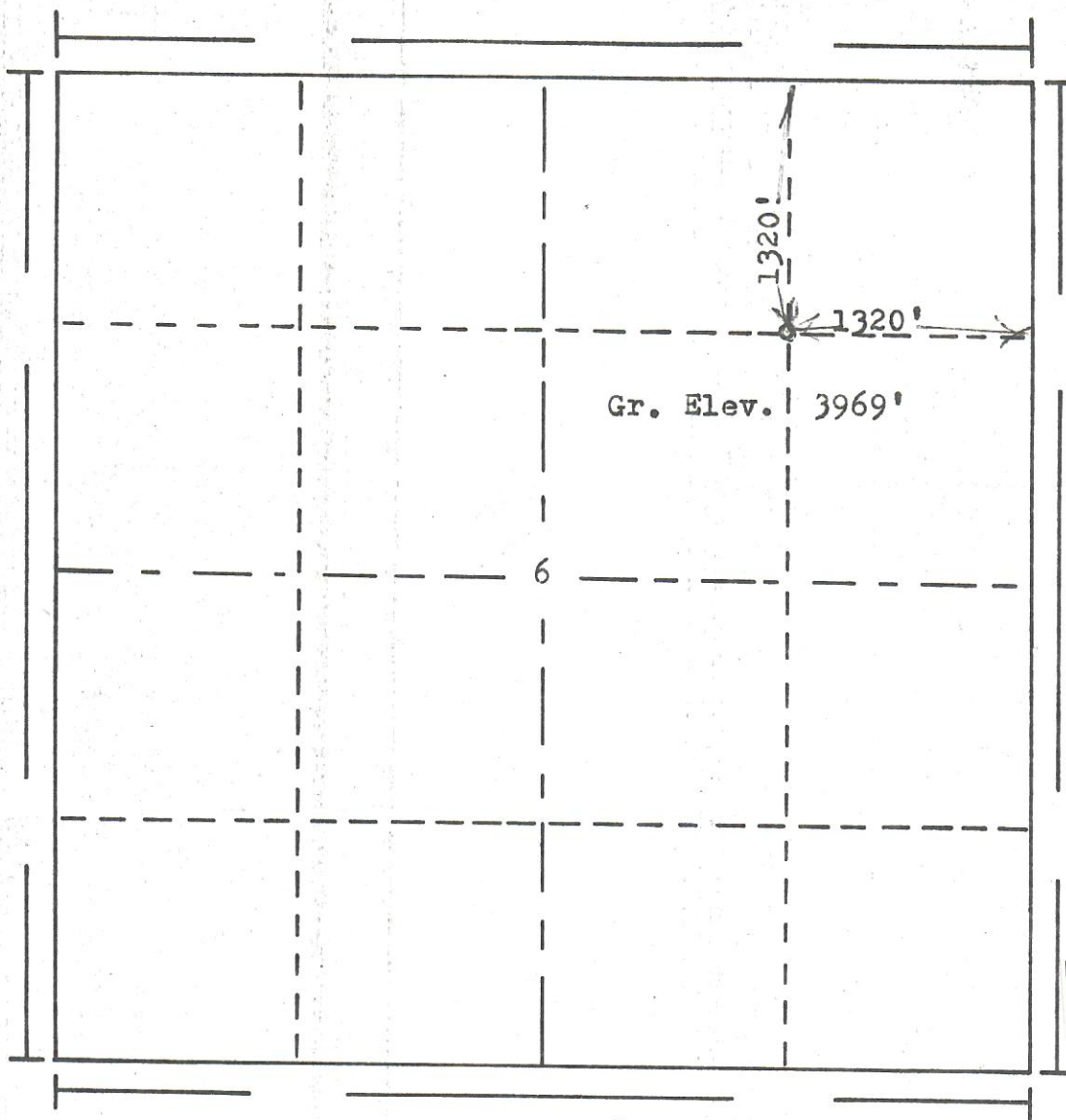
T.
33
SBEST COPY
AVAILABLE

Scale... 1" = 1000'

Powers Elevation Company, Inc. of Denver, Colorado
has in accordance with a request from Mr. McKenney
for Michigan-Wisconsin Pipeline Co.

determined the location of No. 1-6 Cogburn-Weco
to be CNE 1 of the 6th Principal Section 6 Township 33S
Range 43W Meridian
Baca County, Colorado

I hereby certify that this plat is an
accurate representation of a correct
survey showing the location of.

Date: 6-26-76

Billy J. Holloway
Licensed Land Surveyor No. 2853
State of Colorado