

POINT	NAD 83		NAD 27	
SURFACE HOLE LOCATION	N:	1256775.41	N:	256778.34
	E:	3252845.14	E:	2252996.75
	LAT:	N40.0347023	LAT:	N40.0347191
	LONG:	W104.5970016	LONG:	W104.5964837
LANDING POINT LOCATION	N:	1254382.67	N:	254385.59
	E:	3247651.31	E:	2247803.04
	LAT:	N40.0282779	LAT:	N40.0282946
	LONG:	W104.6156346	LONG:	W104.6151158
BOTTOM OF PRODUCTION ZONE	N:	1244742.50	N:	244745.52
	E:	3247730.93	E:	2247882.75
	LAT:	N40.0018130	LAT:	N40.0018295
	LONG:	W104.6156936	LONG:	W104.6151746
BOTTOM HOLE LOCATION	N:	1244652.50	N:	244655.52
	E:	3247731.67	E:	2247883.49
	LAT:	N40.0015659	LAT:	N40.0015824
	LONG:	W104.6156941	LONG:	W104.6151752



TOPOGRAPHIC
LOYALTY INNOVATION LEGACY
520 Stacy Court Ste B, Lafayette, CO 80026
303.666.0379 www.topographic.com

SURVEYOR'S STATEMENT
THE UNDERSIGNED HEREBY STATES THAT THE WELL LOCATION SHOWN HEREON WAS STAKED ON THE GROUND BASED ON EXISTING MONUMENTATION AND/OR PHYSICAL EVIDENCE FOUND IN THE FIELD AND IS CORRECT TO THE BEST OF MY KNOWLEDGE, INFORMATION AND BELIEF.

- NOTES**
- HORIZONTAL (NAD 83) AND VERTICAL (NAVD 88) DATUM IS BASED ON THE TRIMBLE VRS NETWORK. THE LINEAL UNITS OF MEASUREMENT ARE U.S. SURVEY FEET.
 - ALL DIRECTIONS, DISTANCES, AND DIMENSIONS SHOWN HEREON ARE BASED ON COORDINATES FROM THE "COLORADO COORDINATE SYSTEM OF 1983 NORTH ZONE" (TITLE 38, ARTICLE 52 C.R.S.).
 - ALL SECTION LINE DIMENSIONS SHOWN HEREON ARE BASED ON FIELD MEASUREMENTS OF EXISTING MONUMENTS AND/OR PHYSICAL EVIDENCE FOUND IN THE FIELD UNLESS OTHERWISE INDICATED.
 - PHYSICAL FEATURES SHOWN HEREON ARE FOR GRAPHICAL REPRESENTATION ONLY.
 - SEE FORM 2A FOR VISIBLE IMPROVEMENTS WITHIN 500' OF WELLHEAD.
 - DISTANCES TO NEAREST SECTION LINES ARE MEASURED PERPENDICULARLY.
 - THIS IS NOT A LAND SURVEY NOR LAND SURVEY PLAT.
- PDOP READING: 1.2 INSTRUMENT OPERATOR: B. Garcia

- LEGEND**
- COUNTY LINE
 - RANGE/TOWNSHIP LINE
 - SECTION LINE
 - QUARTER SECTION LINE
 - SIXTEENTH SECTION LINE
 - POINT OF INTERSECTION
 - MONUMENT FOUND
 - CALCULATED CORNER

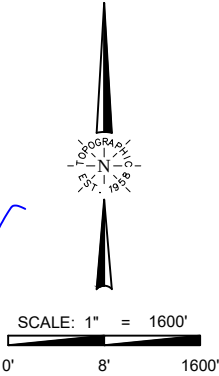
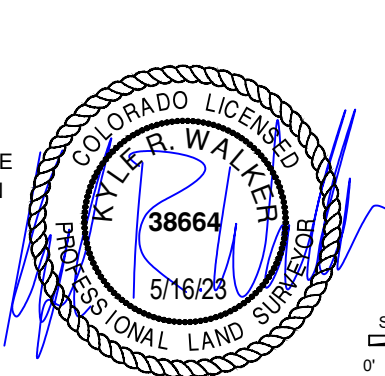

VERDAD RESOURCES CHIVE 2536 12H			
FIELD	04/19/2023	DRAFT	SW
REV 0	05/16/2023	CHECK	ZAK
SHEET : 1 OF 1		JOB: 1001724	

WELL LOCATION MAP
S.H.L. NE/4 SW/4, SECTION 19 T01N R64W 6TH PM
TPZ NE/4 NW/4, SECTION 25 T01N R65W 6TH PM
BPZ SE/4 SW/4, SECTION 36 T01N R65W 6TH PM
BHL SE/4 SW/4, SECTION 36 T01N R65W 6TH PM
WELD COUNTY, COLORADO