

CROSS SECTION A-A'

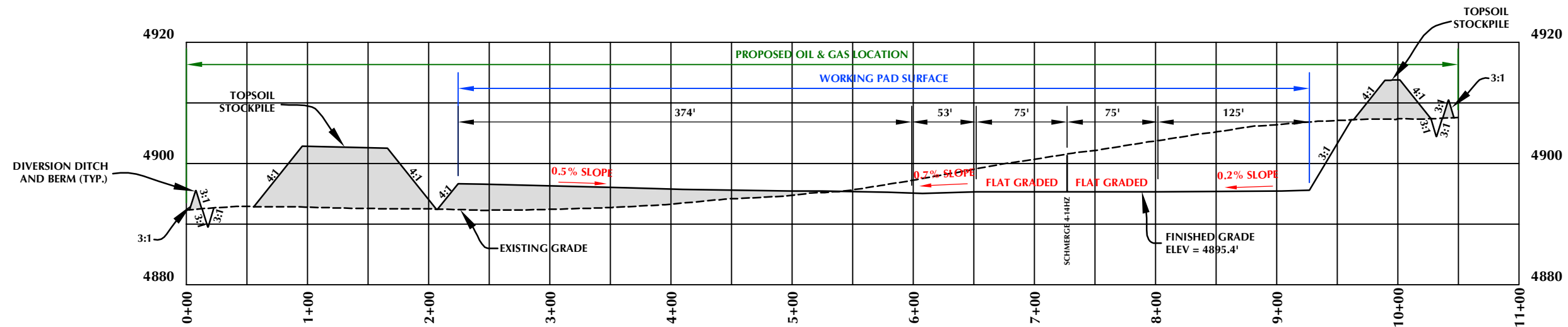

CROSS SECTION B-B'

SCHMERGE 9-4HZ

SCHMERGE 4-1HZ, SCHMERGE 4-2HZ,
SCHMERGE 4-3HZ, SCHMERGE 4-4HZ, SCHMERGE 4-5HZ,
SCHMERGE 4-6HZ, SCHMERGE 4-7HZ, SCHMERGE 4-8HZ,
SCHMERGE 4-9HZ, SCHMERGE 4-10HZ, SCHMERGE 4-11HZ,
SCHMERGE 4-12HZ, SCHMERGE 4-13HZ & SCHMERGE 4-14HZ
LOCATED IN SECTION 4, T5N, R67W, 6TH P.M.
WELD COUNTY, COLORADO

CONSTRUCTION LAYOUT DRAWING - CROSS SECTIONS

Kerr-McGee Oil &
Gas Onshore LP
1099 18th Street
Denver, Colorado 80202



LOVELAND OFFICE
6706 North Franklin Avenue
Loveland, Colorado 80538
Phone 970-776-4331
SHERIDAN OFFICE
1095 Saberton Avenue
Sheridan, Wyoming 82801
Phone 307-674-0609

HORIZONTAL 0 50' 100' 1" = 100'
VERTICAL 0 10' 20' 1" = 20'

SCALE: 1"=100' DATE: 11/18/22 SHEET NO:
REVISED: HJL 1/18/23 1 1 OF 1

PRELIMINARY RIG LAYOUT DRAWING

SCHMERGE 9-4HZ

NE1/4 SE1/4 SECTION 4, TOWNSHIP 5 NORTH, RANGE 67 WEST, 6TH P.M., WELD COUNTY, COLORADO

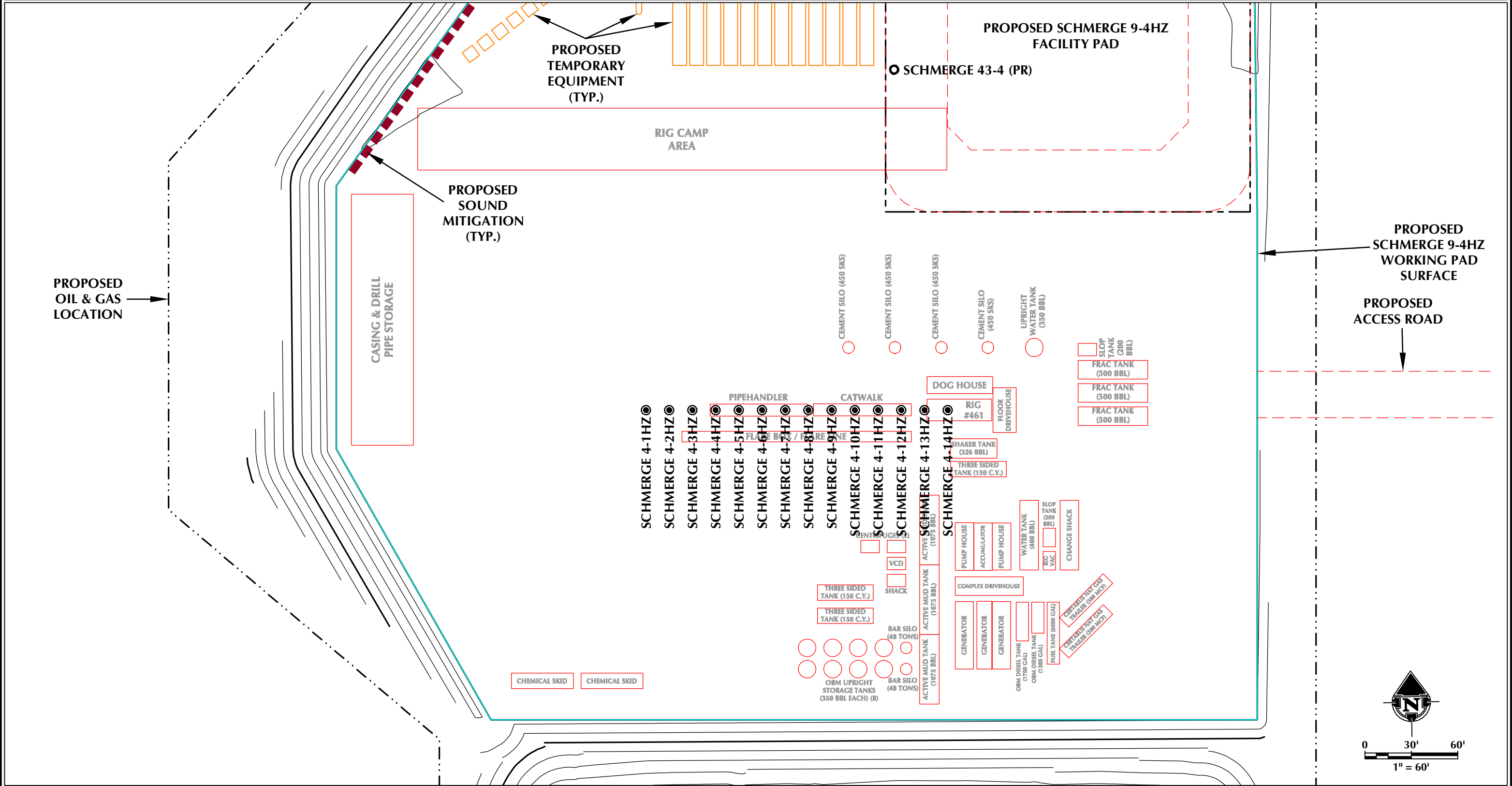

- LEGEND**
- PROPOSED WELL
 - EXISTING WELL
 - PROPOSED OIL & GAS LOCATION
 - PROPOSED WORKING PAD SURFACE
 - PROPOSED 2' CONTOUR



LOVELAND OFFICE
6706 North Franklin Avenue
Loveland, Colorado 80538
Phone 970-776-4331

SHERIDAN OFFICE
1095 Saberton Avenue
Sheridan, Wyoming 82801
Phone 307-674-0609

**Kerr-McGee Oil &
Gas Onshore LP**

1099 18th Street
Denver, Colorado 80202

DATE SURVEYED: 11/3/22
DATE: 11/18/22
DRAFTER: SJM
REVISED: 1/18/23



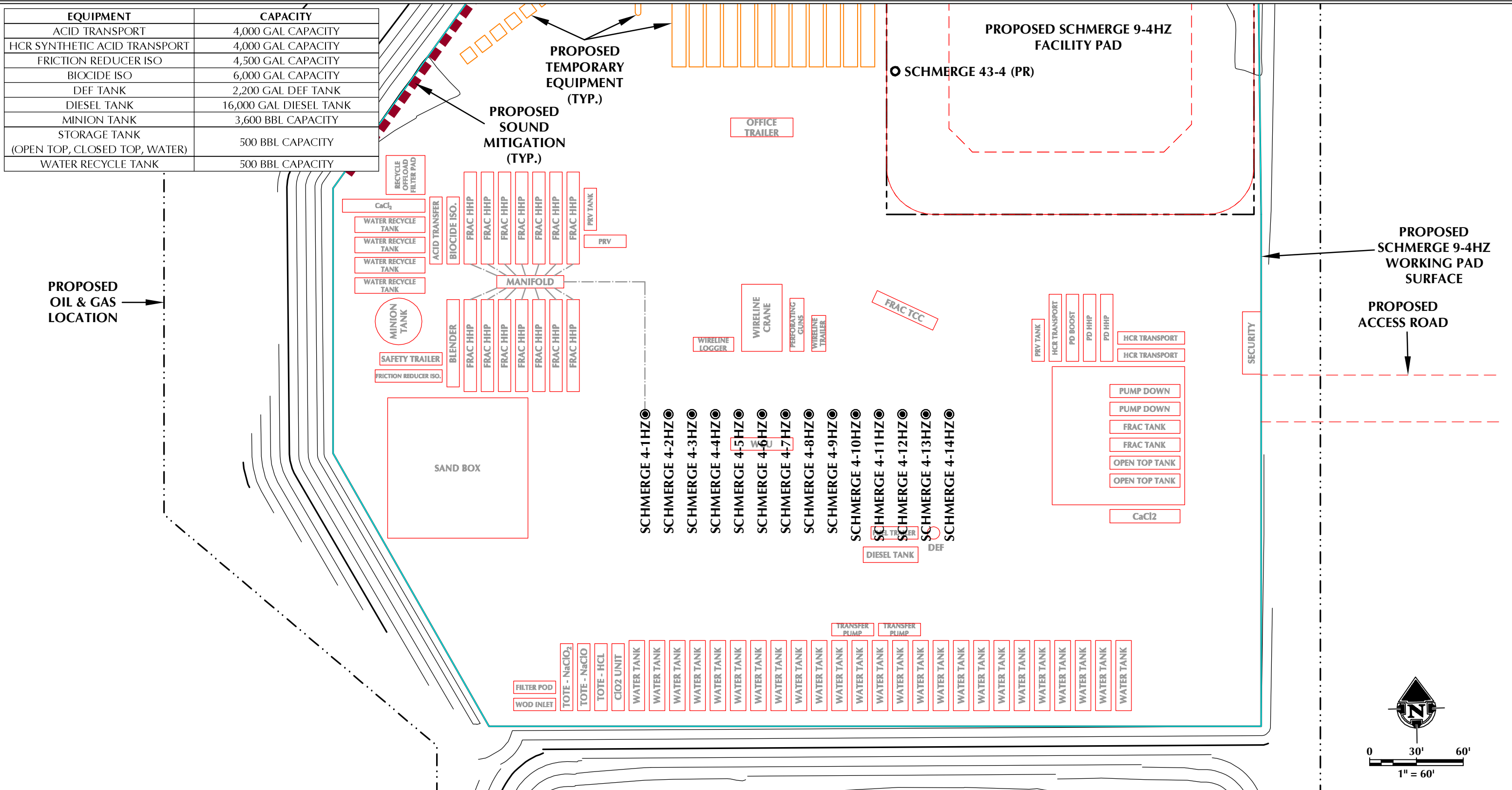

NOTE:
1. RIG PROFILE IS APPROXIMATE AND SUBJECT TO MODIFICATION DUE TO SPECIFIC CIRCUMSTANCES.

SCHMERGE 9-4HZ

EQUIPMENT	CAPACITY
ACID TRANSPORT	4,000 GAL CAPACITY
HCR SYNTHETIC ACID TRANSPORT	4,000 GAL CAPACITY
FRICTION REDUCER ISO	4,500 GAL CAPACITY
BIOCIDE ISO	6,000 GAL CAPACITY
DEF TANK	2,200 GAL DEF TANK
DIESEL TANK	16,000 GAL DIESEL TANK
MINION TANK	3,600 BBL CAPACITY
STORAGE TANK (OPEN TOP, CLOSED TOP, WATER)	500 BBL CAPACITY
WATER RECYCLE TANK	500 BBL CAPACITY



LEGEND

-  PROPOSED WELL
-  EXISTING WELL
-  PROPOSED OIL & GAS LOCATION
-  PROPOSED WORKING PAD SURFACE
-  PROPOSED 2' CONTOUR



LOVELAND OFFICE
6706 North Franklin Avenue
Loveland, Colorado 80538
Phone 970-776-4331

SHERIDAN OFFICE
1095 Saberton Avenue
Sheridan, Wyoming 82801
Phone 307-674-0609

**Kerr-McGee Oil &
Gas Onshore LP**
1099 18th Street
Denver, Colorado 80202

DATE SURVEYED: 11/3/22
DATE: 11/18/22
DRAFTER: SJM
REVISED: 1/18/23

NOTE:

1. COMPLETION AND STIMULATION LAYOUT IS APPROXIMATE AND SUBJECT TO MODIFICATION DUE TO SPECIFIC CIRCUMSTANCES.

PRELIMINARY FLOWBACK EQUIPMENT LAYOUT DRAWING

SCHMERGE 9-4HZ

NE1/4 SE1/4 SECTION 4, TOWNSHIP 5 NORTH, RANGE 67 WEST, 6TH P.M., WELD COUNTY, COLORADO

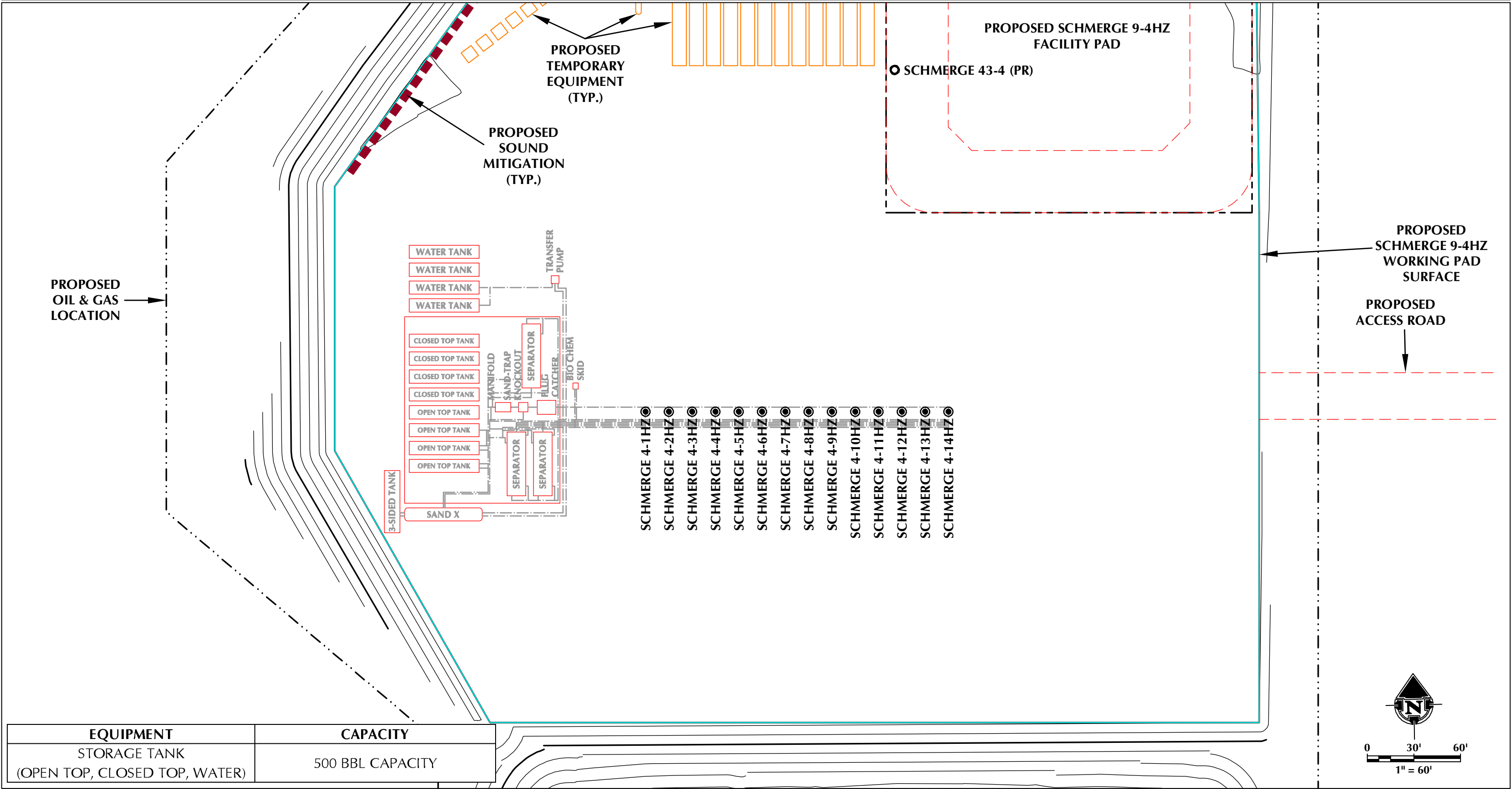

EQUIPMENT	CAPACITY
STORAGE TANK (OPEN TOP, CLOSED TOP, WATER)	500 BBL CAPACITY

- LEGEND
- PROPOSED WELL
 - EXISTING WELL
 - PROPOSED OIL & GAS LOCATION
 - PROPOSED PIPELINE
 - PROPOSED WORKING PAD SURFACE
 - PROPOSED 2' CONTOUR



LOVELAND OFFICE
6706 North Franklin Avenue
Loveland, Colorado 80538
Phone 970-776-4331

SHERIDAN OFFICE
1095 Saberton Avenue
Sheridan, Wyoming 82801
Phone 307-674-0609

**Kerr-McGee Oil &
Gas Onshore LP**

1099 18th Street
Denver, Colorado 80202

DATE SURVEYED: 11/3/22
DATE: 11/18/22
DRAFTER: SJM
REVISED: 1/18/23

NOTES:
-WELLHEADS WILL REMAIN PERMANENTLY AFTER FLOWBACK IS COMPLETE.
ALL OTHER EQUIPMENT DISPLAYED IS TEMPORARY AND WILL BE REMOVED
FOLLOWING FLOWBACK OPERATIONS.

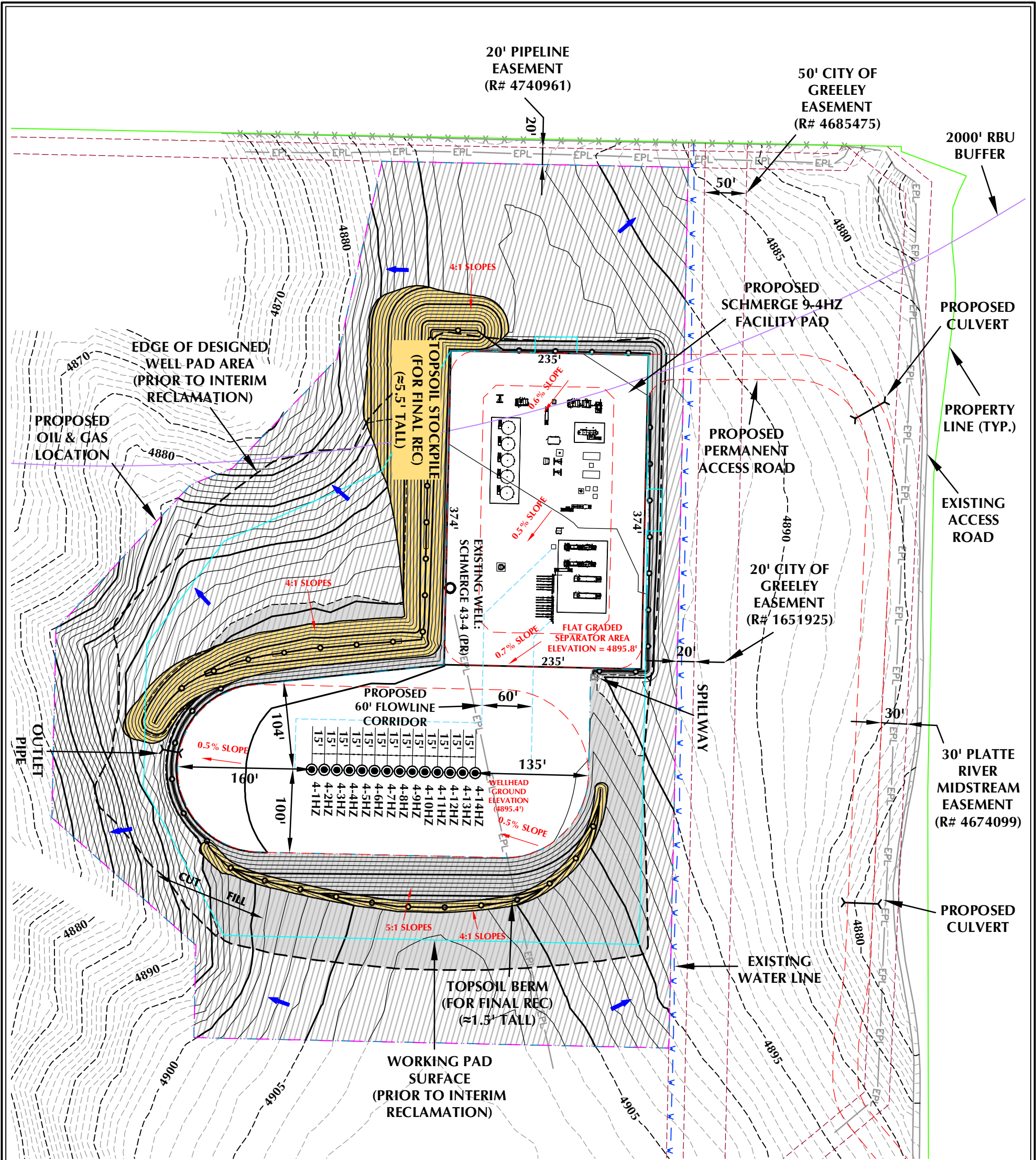

- NOTES:**
- PIPELINE AND UTILITY CORRIDORS ARE PLANNED AND DETERMINED BY THIRD PARTY COMPANIES. SPECIFIC PIPELINE AND UTILITY CORRIDOR LOCATIONS WILL BE DECIDED BY THOSE THIRD PARTY COMPANIES CLOSER TO THE START DATE OF OPERATIONS BASED ON CONTRACT AND RIGHT-OF-WAY NEGOTIATIONS.
 - EXISTING UTILITIES DISPLAYED ON THE GRADING PLAN ARE FOR REFERENCE PURPOSES ONLY. PRIOR TO CONSTRUCTION OR EARTHWORK, CONTRACTOR WILL BE RESPONSIBLE TO CALL FOR LOCATES: (800) 922-1987
 - THE 5.5' TALL TOPSOIL STOCKPILE IS TO BE CONSTRUCTED UTILIZING ±2,004 C.Y. OF BASE MATERIAL AT APPROXIMATELY 2.5' FEET OF HEIGHT AND COVERED WITH ±7,120 C.Y. OF TOPSOIL TO REACH THE EFFECTIVE 5.5' TALL TOPSOIL STOCKPILE HEIGHT.
 - RECLAIMED AREA WILL BE RE-SEEDING AND RE-VEGETATED DURING INTERIM RECLAMATION.

SCHMERGE 9-4HZ FACILITY LAYOUT DRAWING

QUANTITIES AND DESIGN PARAMETERS

SHRINKAGE FACTOR = 1.00
SWELL FACTOR = 1.00
PROPOSED OIL & GAS LOCATION = 13.99 ACRES
AREA RECLAIMED DURING INTERIM RECLAMATION = 9.62 ACRES
TOTAL WELL PAD AREA AFTER INTERIM RECLAMATION = 2.32 ACRES
TOTAL FACILITY PAD AREA AFTER INTERIM RECLAMATION = 2.05 ACRES

PAD QUANTITIES

TOTAL CUT = 16,483 C.Y.
TOTAL FILL = 16,483 C.Y.
TOTAL TOPSOIL @ 12" DEPTH FROM CONSTRUCTION PHASE = 14,937 C.Y.
TOPSOIL USED FOR INTERIM REC = 7,817 C.Y.
TOPSOIL STORED FOR FINAL REC = 7,120 C.Y.

LAND USE: DRYLAND CROP
FACILITY REVISION: SCHMERGE-PP-2020 Rev F

Kerr-McGee Oil & Gas Onshore LP
1099 18th Street
Denver, Colorado 80202



LOVELAND OFFICE
6706 North Franklin Avenue
Loveland, Colorado 80538
Phone 970-776-4331

SHERIDAN OFFICE
1095 Saberton Avenue
Sheridan, Wyoming 82801
Phone 307-674-0609

CONSULTING, LLC

LEGEND

- EXISTING WELL LOCATION
- PROPOSED WELL LOCATION
- EXISTING CONTOURS (1' INTERVAL)
- PROPOSED CONTOURS (1' INTERVAL)
- EPL EXISTING PIPELINE
- PROPOSED FLOWLINE
- EXISTING FENCE
- RECLAMATION AREA
- PLANNED FLOW DIRECTION
- WORKING PAD SURFACE (WPS)
- BERM



HORIZONTAL 0 60' 120' 1" = 120'

1' CONTOURS

SCALE: 1"=120'	DATE: 11/18/22	SHEET NO:
REVISED:	HJL 1/18/23	1 OF 2

BUILDING	±1547' S
RESIDENTIAL BUILDING UNIT (RBU)	±1907' N
HIGH OCCUPANCY BUILDING UNIT (HOBV)	±3848' NW
DESIGNATED OUTSIDE ACTIVITY AREA	5280'+ S
PUBLIC ROAD	±1645' S
ABOVE GROUND UTILITY	±1651' S
RAILROAD	±1815' NW
PROPERTY LINE	±235' N
SCHOOL FACILITY	5280'+ N
CHILD CARE CENTER	5280'+ N
DISPROPORTIONATELY IMPACTED (DI) COMMUNITY	5280'+ W
RBU, HOBV, OR SCHOOL FACILITY WITHIN A DI COMMUNITY	5280'+ W

TEMPORARY WATER TANK	±223' N
PERMANENT WATER TANK	±328' N
PERMANENT MAINTENANCE TANK	±406' N
SEPARATOR	±239' NE
TEMPORARY PURGE FLARE	±358' NE
TEMPORARY ECD	±252' NW
VOC COMBUSTOR	±242' N
WORKING PAD SURFACE	±186' SW

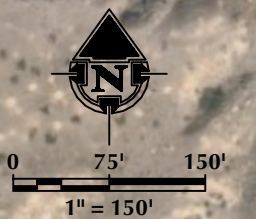

FACILITY COORDINATES:
LAT: 40.427189° LONG: -104.889716° (NAD83)

FACILITY LAYOUT DRAWING
SCHMERGE 9-4HZ
LOCATED IN SECTION 4, T5N, R67W, 6TH P.M.
WELD COUNTY, COLORADO