

RECEIVED

WELL LOCATION
1990.0 FT. SNL-690.0 FT. W.E.L.
SECTION 22, T5N R9OW 6TH.PM.

AUG 14 1974

COLO. OIL & GAS CONS. COMM.



00213193

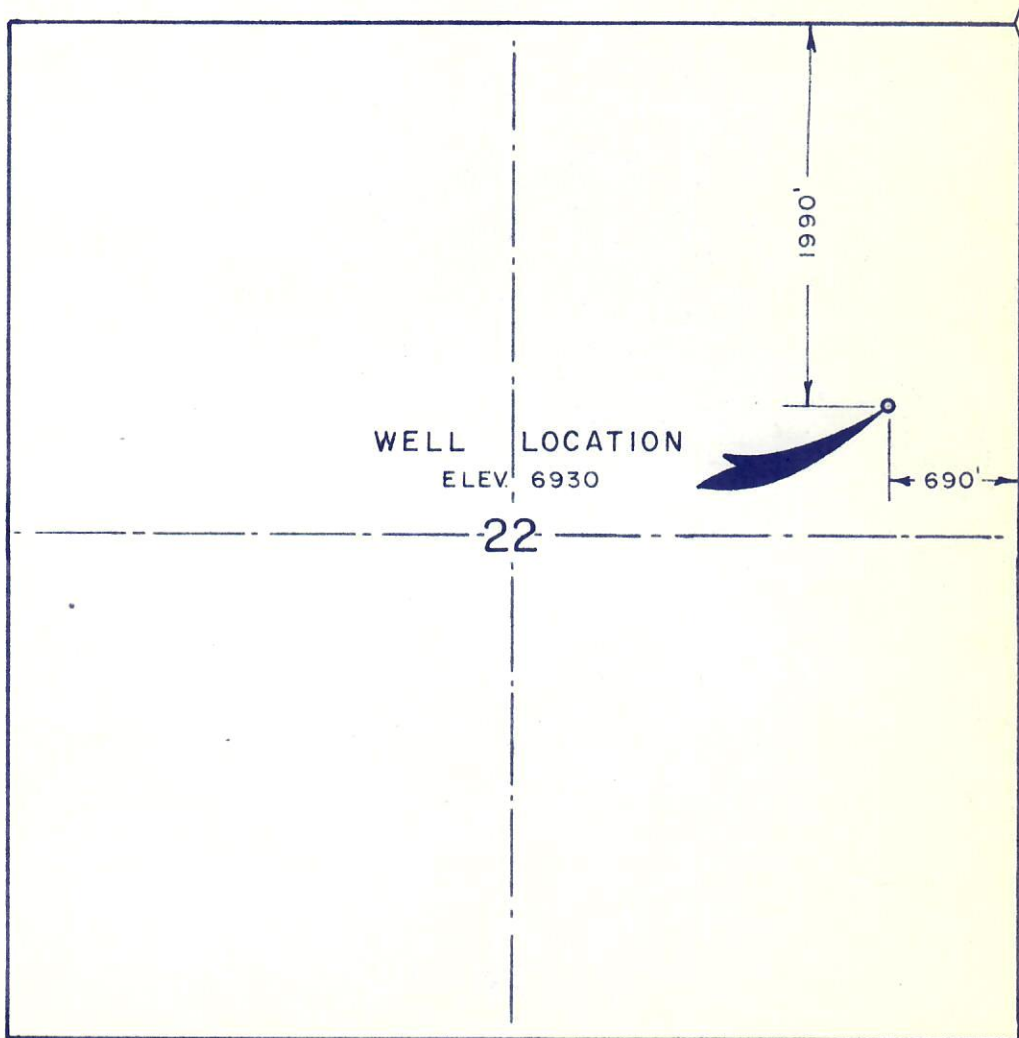

Scale 1" = 1000'

74 653

I, David L. Bear do hereby certify that this plat was plotted from notes of a field survey made under my direct responsibility, supervision and checking on July 25, 1974.

David L. Bear
Registered Land Surveyor

WESTERN ENGINEERS, INC.
WELL LOCATION
ATLANTIC RICHFIELD
U.S.A. No 1-22
MOFFAT COUNTY, COLORADO

SURVEYED D.L.B. DRAWN G.L.A.
GRAND JUNCTION, COLO. 7/29/74