

SCALE: 1" = 1000'

0' 500' 1000'

# WELL LOCATION MAP

SHL NW/4 SE/4, SECTION 35, TOWNSHIP 29-S, RANGE 55-W  
LAS ANIMAS COUNTY, COLORADO



**DESERT EAGLE**  
OPERATING

CALCULATED  
CORNER  
23  
26



27 26  
34 35  
FENCE  
CORNER

N 89°35'09" E 2499.41'

N 89°35'09" E 2499.41'

26 25  
35 36  
FENCE  
CORNER

N 01°41'56" W 2582.11'

S 05°30'27" E 2501.68'

34 35  
CALCULATED  
CORNER

35

SURFACE LOCATION  
GROUND ELEV = 5563.1'  
TPZ MD = 1082'  
1667' FSL  
1478' FEL

35 36  
FOUND  
SANDSTONE

N 01°41'56" W 2582.11'

S 02°53'49" E 2729.97'

1478'

1667'

34 36  
02 01  
CALCULATED BY  
WELL PLAT API  
05-071-09919

N 89°08'33" W 2615.00'

N 89°08'33" W 2615.00'

T29S R55W  
T30S R55W

02  
CALCULATED  
CORNER

35 36  
02 01  
FOUND  
SANDSTONE  
AND 60D NAIL

## LEGEND

- Found Survey Monument
- Calculated Corner Location
- Vertical Well Location
- Section Line
- Quarter Section Line
- Sixteenth Section Line

POINT	NAD 83	NAD 27
SURFACE HOLE LOCATION	N: 1299166.69	N: 299157.18
	E: 3568900.92	E: 2569060.12
	LAT: N37.4718890	LAT: N37.4718729
	LONG: W103.5395334	LONG: W103.5390334

## NOTES

- Horizontal (NAD 83) and vertical (NAVD 88) datum is based on the Trimble VRS Network or OPUS Solution.
- All directions, distances, and dimensions shown hereon are based on coordinates from the "Colorado coordinate system of 1983 central zone" (article 52 of title 38, C.R.S.).
- All section line dimensions shown hereon are based on field measurements of existing monuments and/or physical evidence found in the field unless otherwise indicated.
- See Form 2A, if applicable for visible improvements within 500' of wellhead.
- Distances to nearest section lines are measured perpendicularly.
- This is not a land survey nor land survey plat.

PDOP Reading: 1.1 Instrument Operator: **Kevin Royer**

Date Surveyed: **07/09/2022**

## SURVEYOR'S STATEMENT

The undersigned hereby states that the well location shown hereon was staked on the ground based on existing monumentation and/or physical evidence found in the field and is correct to the best of my knowledge, information and belief.

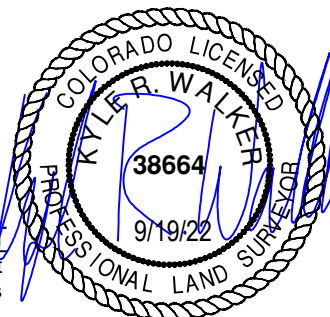

**TOPOGRAPHIC**  
LOYALTY INNOVATION LEGACY  
520 Stacy Court Ste B, Lafayette, CO 80026  
303.666.0379 www.topographic.com

DESERT EAGLE OPERATING RED ROCKS #35-8	SW	09/15/2022	REVISION:
	SHEET :	1 OF 1	
	FILE:LO_RED_ROCKS_35_8		