



00400742

R. 56W

RECEIVED

FEB 6 1980

COLO. OIL & GAS CONS. COMM.

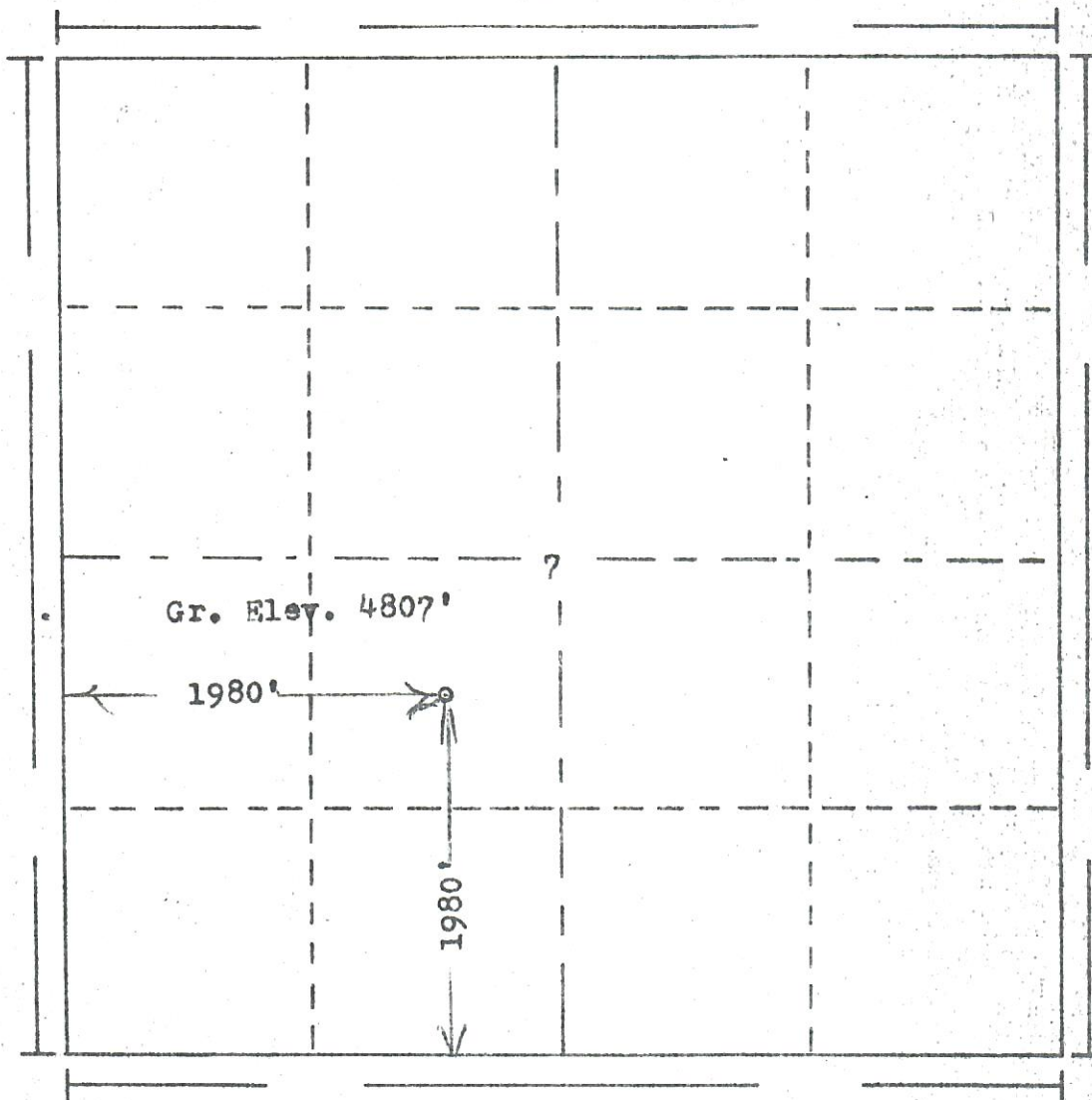

Scale... 1" = 1000'

Powers Elevation of Denver, Colorado
has in accordance with a request from Mr. Brown
for Kimbark Operating Co.
determined the location of No.1 Nothdruff
to be CNE SW Section 7 Township 3S
Range 56W of the 6th Principal Meridian
Washington County, Colorado

I hereby certify that this plat is an
accurate representation of a correct
survey showing the location of

Date: 1-21-80

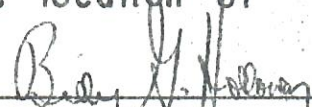
Licensed Land Surveyor No. 2853
State of Colorado