



Form PS-



00400480

R. 55 W

RECEIVED

SEP 30 1985

COLORADO OIL &amp; GAS COM. COMM.

N

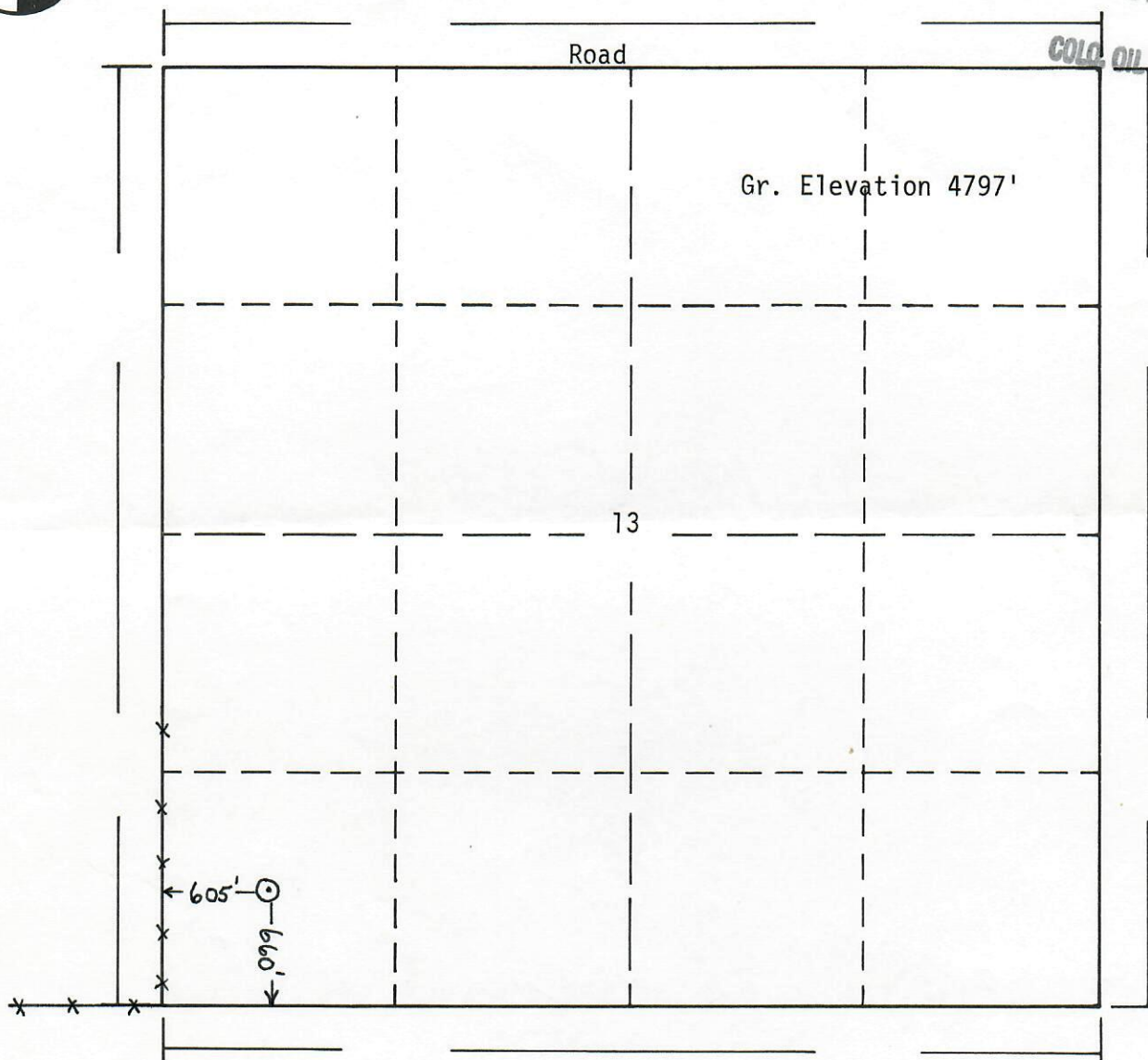
T.  
3  
S

Scale: 1"=1000'

Powers Elevation of Denver, Colorado has in accordance with a request  
from Mr. Nylund for J.W. Nylund Oil Producer  
determined the location of #1 Gade  
to be 660fs1, 605fw1 Section 13 , Township 3 S  
Range 55 W of the 6th Principal Meridian,  
Washington County, Colorado

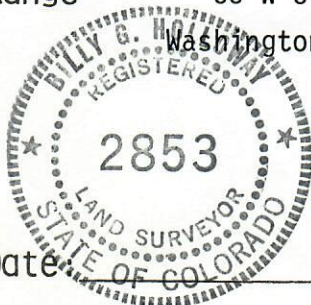

Date 9-25-85

I hereby certify that this plat is an  
accurate representation of a correct  
survey showing the location of

Licensed Land Surveyor No. 2853  
State of Colorado