



00416147

DEPARTMENT OF NATURAL RESOURCES  
OIL AND GAS CONSERVATION COMMISSION  
OF THE STATE OF COLORADO

83 836

RECEIVED

AUG 02 1983

APPLICATION FOR PERMIT TO DRILL, DEEPEN, OR REENTER AND OPERATE			5. LEASE DESIGNATION AND SERIAL NO. COLD. OIL & GAS CONS. COMM	
1a. TYPE OF WORK DRILL <input checked="" type="checkbox"/> DEEPEN <input type="checkbox"/> REENTER <input type="checkbox"/>			6. IF INDIAN, ALLOTTEE OR TRIBE NAME	
b. TYPE OF WELL OIL WELL <input checked="" type="checkbox"/> GAS WELL <input type="checkbox"/> OTHER <input type="checkbox"/> SINGLE ZONE <input checked="" type="checkbox"/> MULTIPLE ZONE <input type="checkbox"/>			7. UNIT AGREEMENT NAME	
2. NAME OF OPERATOR J. W. Nylund			8. FARM OR LEASE NAME Peterson	
3. ADDRESS OF OPERATOR 5680 So. Syracuse Circle, #502, Englewood, CO 80111			9. WELL NO. 1	
4. LOCATION OF WELL (Report location clearly and in accordance with any State requirements.) At surface 1980' FNL; 1980' FEL C SW NE 34-T3S-R55W At proposed prod. zone same			10. FIELD AND POOL, OR WILDCAT Wildcat	
14. DISTANCE IN MILES AND DIRECTION FROM NEAREST TOWN OR POST OFFICE 3-1/2 miles east and 1/2 mile north of Last Chance			11. SEC., T., R., M., OR BLK. AND SURVEY OR AREA C SW NE 34-T3S-R55W	
15. DISTANCE FROM PROPOSED LOCATION TO NEAREST PROPERTY OR LEASE LINE, FT. (Also to nearest drlg. line, if any) 660'			12. COUNTY Washington	
16. NO. OF ACRES IN LEASE* 397.93			13. STATE Colorado	
17. NO. OF ACRES AND/OR DRILLING UNIT ASSIGNED TO THIS WELL 40				
18. DISTANCE FROM PROPOSED LOCATION TO NEAREST WELL, DRILLING, COMPLETED, OR APPLIED FOR, ON THIS LEASE, FT. none			20. ROTARY OR CABLE TOOLS rotary	
19. PROPOSED DEPTH 5025'			22. APPROX. DATE WORK WILL START 8/11/83	
21. ELEVATIONS (Show whether DF, RT, GR, etc.) 4884' GL      Plat attached				

## PROPOSED CASING AND CEMENTING PROGRAM

SIZE OF HOLE	SIZE OF CASING	WEIGHT PER FOOT	SETTING DEPTH	QUANTITY OF CEMENT
12-1/4"	8-5/8"	24#	120' ✓	100 sx

\*DESCRIBE LEASE

Township 3 South - Range 55 West  
Section 34: N/2, E/2 SE/4

We propose to drill well to total depth, run logs and test all significant shows of oil and gas.

IN ABOVE SPACE DESCRIBE PROPOSED PROGRAM: If proposal is to deepen or reenter and operate, give data on present productive zone and proposed new productive zone. If proposal is to drill or deepen directionally, give pertinent data on subsurface locations and measured and true vertical depths. Give blowout preventer program, if any.

In accepting this permit the applicant agrees to fully abide by the requirements and rules of this Commission governing this permitted operation including his responsibility to prevent pollution of state waters during drilling, treating, testing, and producing operations and by the casing, cementing and plugging requirements particularly designed for the protection of state waters and the prevention of intermingling of the contents of all the various zones encountered in this permitted operation.

24. SIGNED [Signature] TITLE Geologist-Producer DATE 7/29/83

(This space for Federal or State Office use)

PERMIT NO. \_\_\_\_\_ APPROVAL DATE AUG 4 1983 expires DEC 2 1983  
 APPROVED BY William Smith TITLE O & G Cons. Comm. DATE AUG 4 1983  
 CONDITIONS OF APPROVAL, IF ANY:

See Instructions On Reverse Side

A.P.I. NUMBER

05 121 9946





RECEIVED

AUG 02 1983

COLO. OIL &amp; GAS CONS. COM.

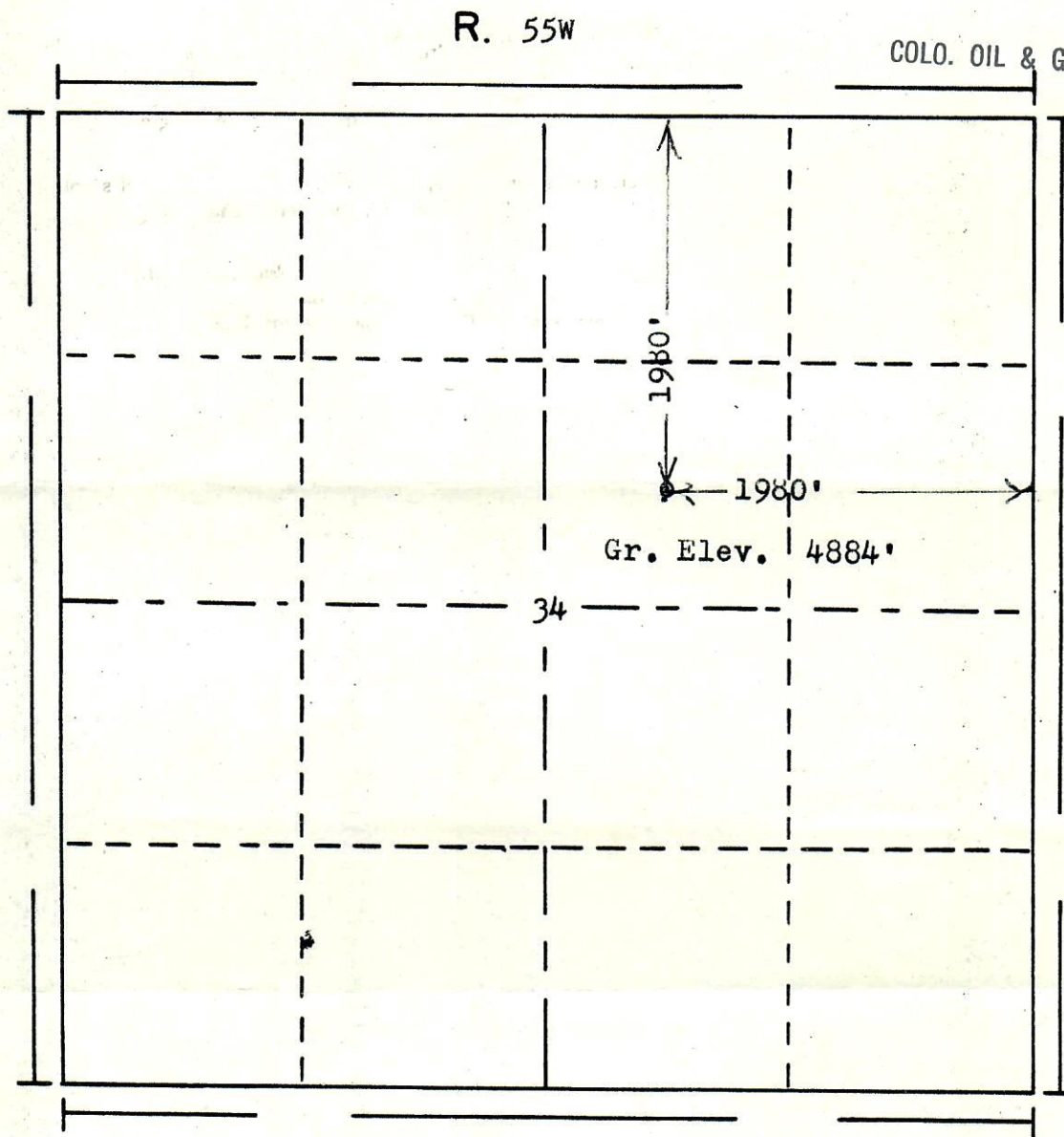

Scale... 1" = 1000'

**Powers Elevation of Denver, Colorado**  
has in accordance with a request from Mr. Nylund  
for J.W. Nylund Oil Producer  
determined the location of No.1 Peterson  
to be CSW NE Section 34 Township 3S  
Range 55W of the 6th Principal Meridian  
Washington County, Colorado

I hereby certify that this plat is an  
accurate representation of a correct  
survey showing the location of

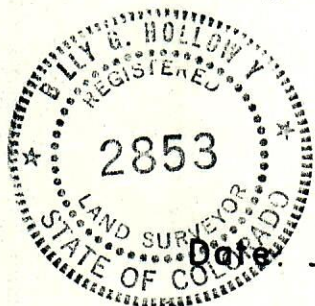

Date

7-19-83

*Billy G. Holloway*  
Licensed Land Surveyor No. 2853  
State of Colorado