

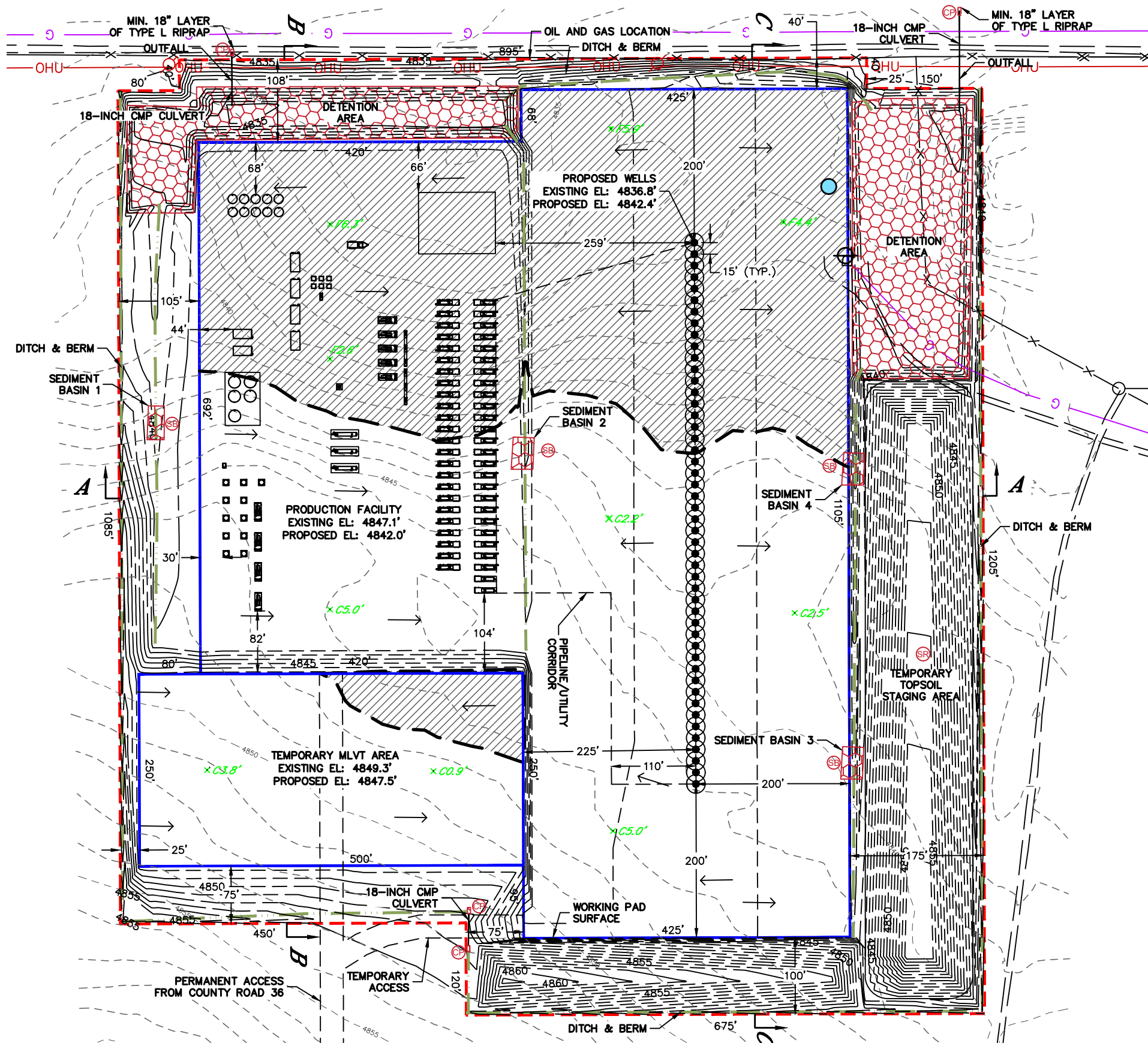

Lat40°, Inc. 6250 W. 10th Street, Unit 2, Greeley, CO 970-515-5294
CONSTRUCTION LAYOUT DRAWINGS - PLAN VIEW
TRIPPETT 3N66W03 1-48 PAD
PDC ENERGY

Q: E2SW4, W2SE4
SECTION: 3
TOWNSHIP: 3N
RANGE: 66W
6TH. P.M.
WELD COUNTY, CO



CUT VOLUME: 54,370 CY
FILL VOLUME: 54,300 CY
EXPORT VOLUME: 70 CY
TOPSOIL (10") VOLUME: 41,290 CY
GRAVEL (6") IMPORT: 16,400 CY

SEE PROPOSED GRADING PLAN FOR ADDITIONAL INFORMATION AS PREPARED BY OTHERS

OIL AND GAS LOCATION: ±30.7 ACRES
WORKING PAD SURFACE: ±20.3 ACRES
PERMANENT ACCESS ROAD: ±1.9 ACRES
TEMPORARY ACCESS ROAD: ±0.2 ACRES
PIPELINE/UTILITY CORRIDOR: ±3.1 ACRES

LEGEND

- WORKING PAD SURFACE
- OIL AND GAS LOCATION
- FILL
- INSTALL SEDIMENT BASIN
- DITCH & BERM
- EXISTING CONTOUR - 1' INTERVAL
- PROPOSED CONTOUR - 1' INTERVAL
- CUT/FILL LINE
- SURFACE ROUGHENING
- INSTALL CULVERT PROTECTION
- INSTALL CULVERT
- FLOW ARROW
- INSTALL EROSION CONTROL BLANKET
- PROPOSED CUT/FILL DEPTH

- NOTE:
1. Ground elevations are based on an observed GPS elevation (NAVD 1988 DATUM).
 2. No offsite flowlines proposed.
 3. Third party custody transfer occurs at LACT for oil.
 4. Third Party custody transfer occurs at meter for gas.

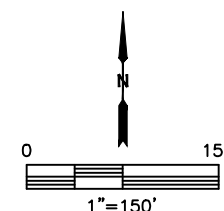



Lat40°, Inc. 6250 W. 10th Street, Unit 2, Greeley, CO 970-515-5294
CONSTRUCTION LAYOUT DRAWING - CROSS-SECTION
TRIPPETT 3N66W03 1-48 PAD
PDC ENERGY

Q: E2SW4, W2SE4
SECTION: 3
TOWNSHIP: 3N
RANGE: 66W
6TH. P.M.
WELD COUNTY, CO

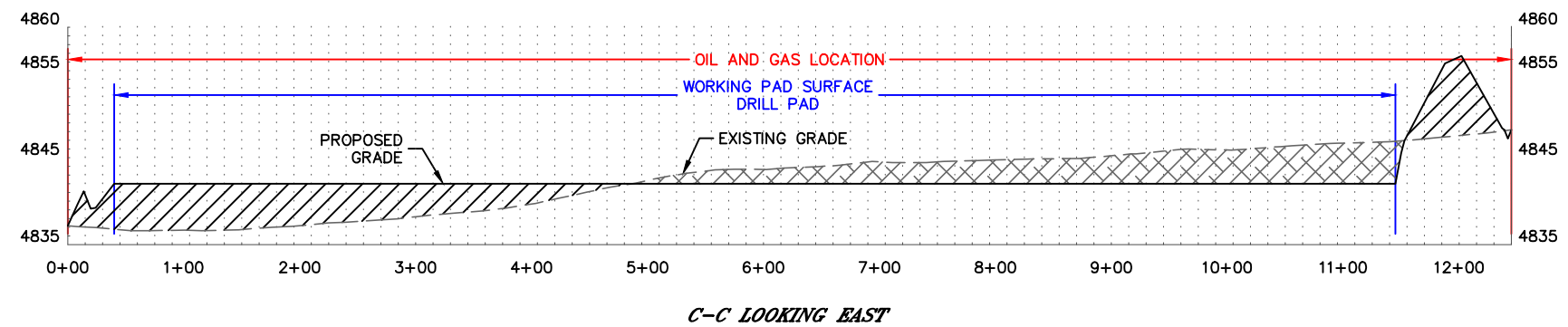
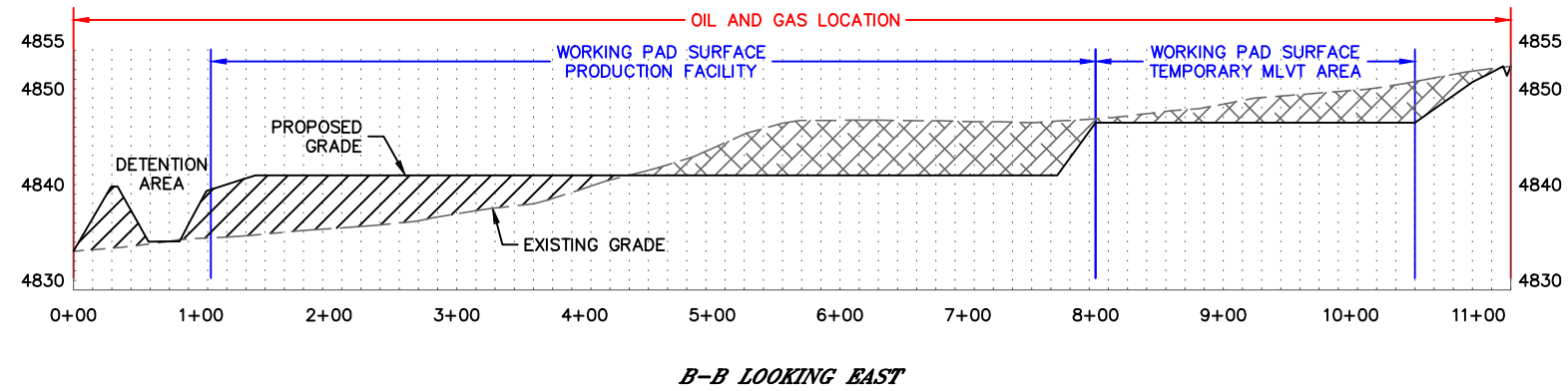
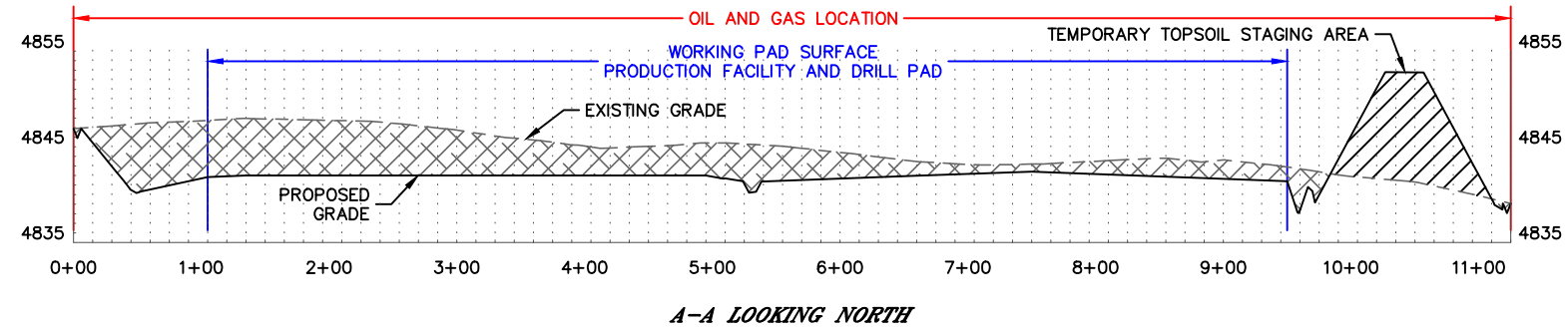

LEGEND

- FILL
- CUT
- WORKING PAD SURFACE
- OIL AND GAS LOCATION

HORIZONTAL SCALE: 1"=150', VERTICAL SCALE: 1"=20'

SHEET 2 OF 6 DATE: 8/17/2022
PROJECT#: 2021414



Lat40°, Inc. 6250 W. 10th Street, Unit 2, Greeley, CO 970-515-5294
PRELIMINARY RIG LAYOUT DRAWING
TRIPPETT 3N66W03 1-48 PAD
PDC ENERGY

Q: E2SW4, W2SE4
SECTION: 3
TOWNSHIP: 3N
RANGE: 66W
6TH. P.M.
WELD COUNTY, CO

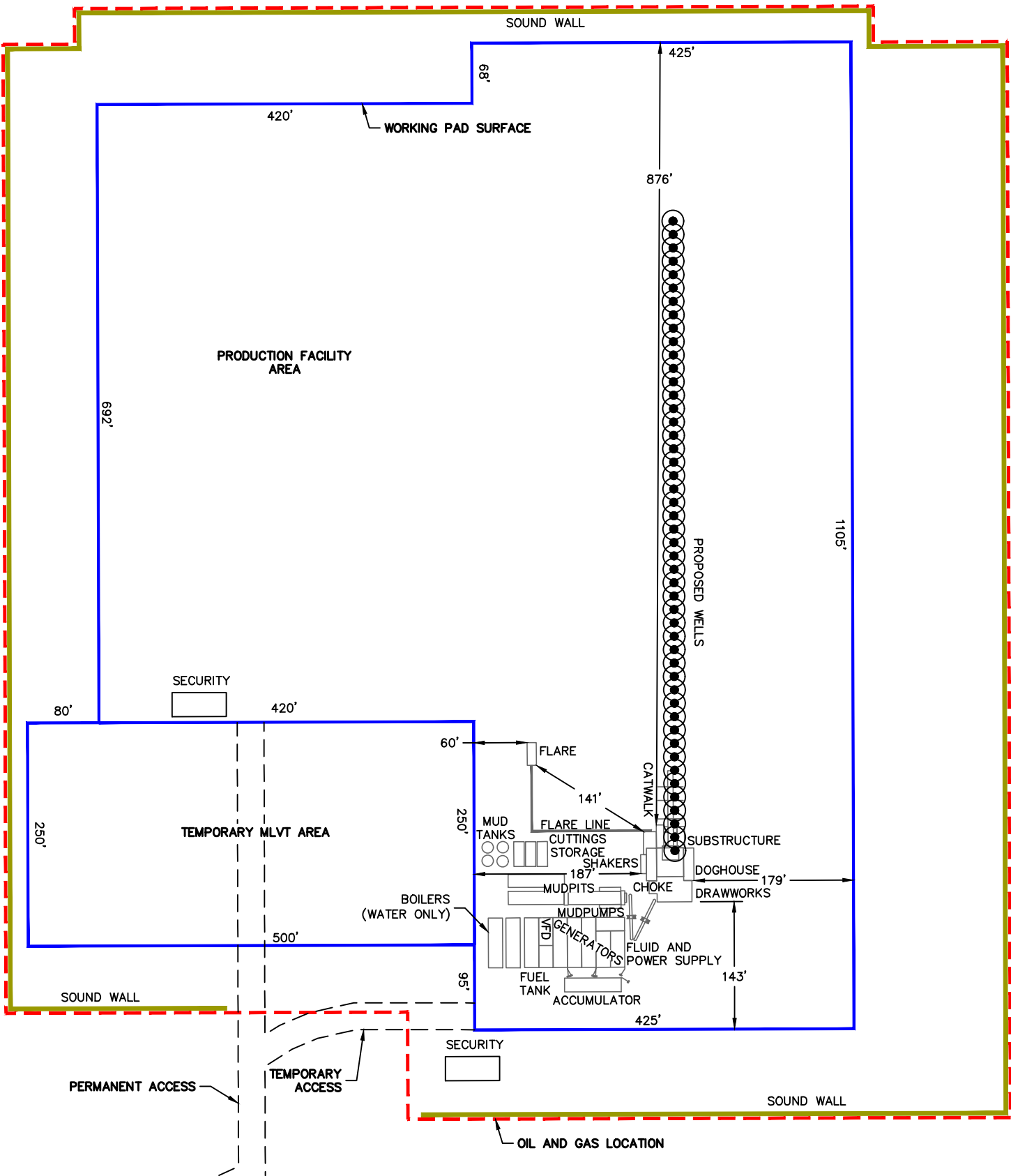

NOTES:
LAYOUTS SHOWN HEREON ARE SUBJECT TO CHANGES DUE TO
EQUIPMENT AVAILABILITY AND TECHNOLOGY CHANGES.

LEGEND
WORKING PAD SURFACE
OIL AND GAS LOCATION

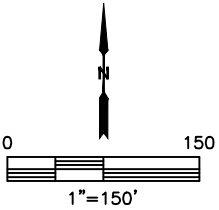



Lat40°, Inc. 6250 W. 10th Street, Unit 2, Greeley, CO 970-515-5294

PRELIMINARY WELL COMPLETION AND STIMULATION LAYOUT DRAWING

TRIPPETT 3N66W03 1-48 PAD
PDC ENERGY

Q: E2SW4, W2SE4
SECTION: 3
TOWNSHIP: 3N
RANGE: 66W
6TH. P.M.
WELD COUNTY, CO

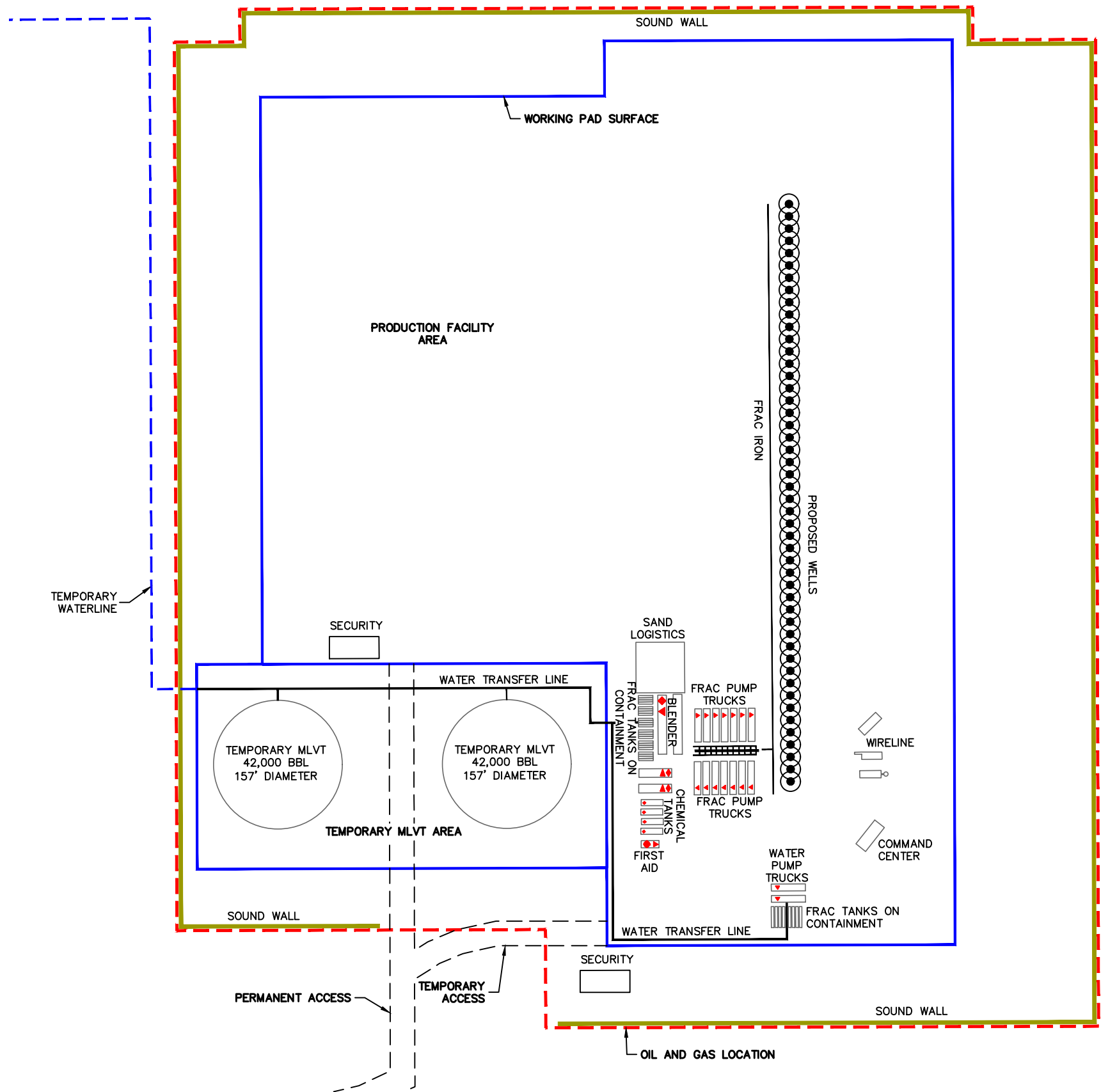

NOTES:
LAYOUTS SHOWN HEREON ARE SUBJECT TO CHANGES DUE TO
EQUIPMENT AVAILABILITY AND TECHNOLOGY CHANGES.

LEGEND
WORKING PAD SURFACE
OIL AND GAS LOCATION

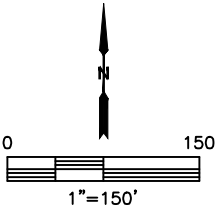



Lat40°, Inc. 6250 W. 10th Street, Unit 2, Greeley, CO 970-515-5294
PRELIMINARY FLOWBACK EQUIPMENT LAYOUT DRAWING
TRIPPETT 3N66W03 1-48 PAD
PDC ENERGY

Q: E2SW4, W2SE4
SECTION: 3
TOWNSHIP: 3N
RANGE: 66W
6TH. P.M.
WELD COUNTY, CO

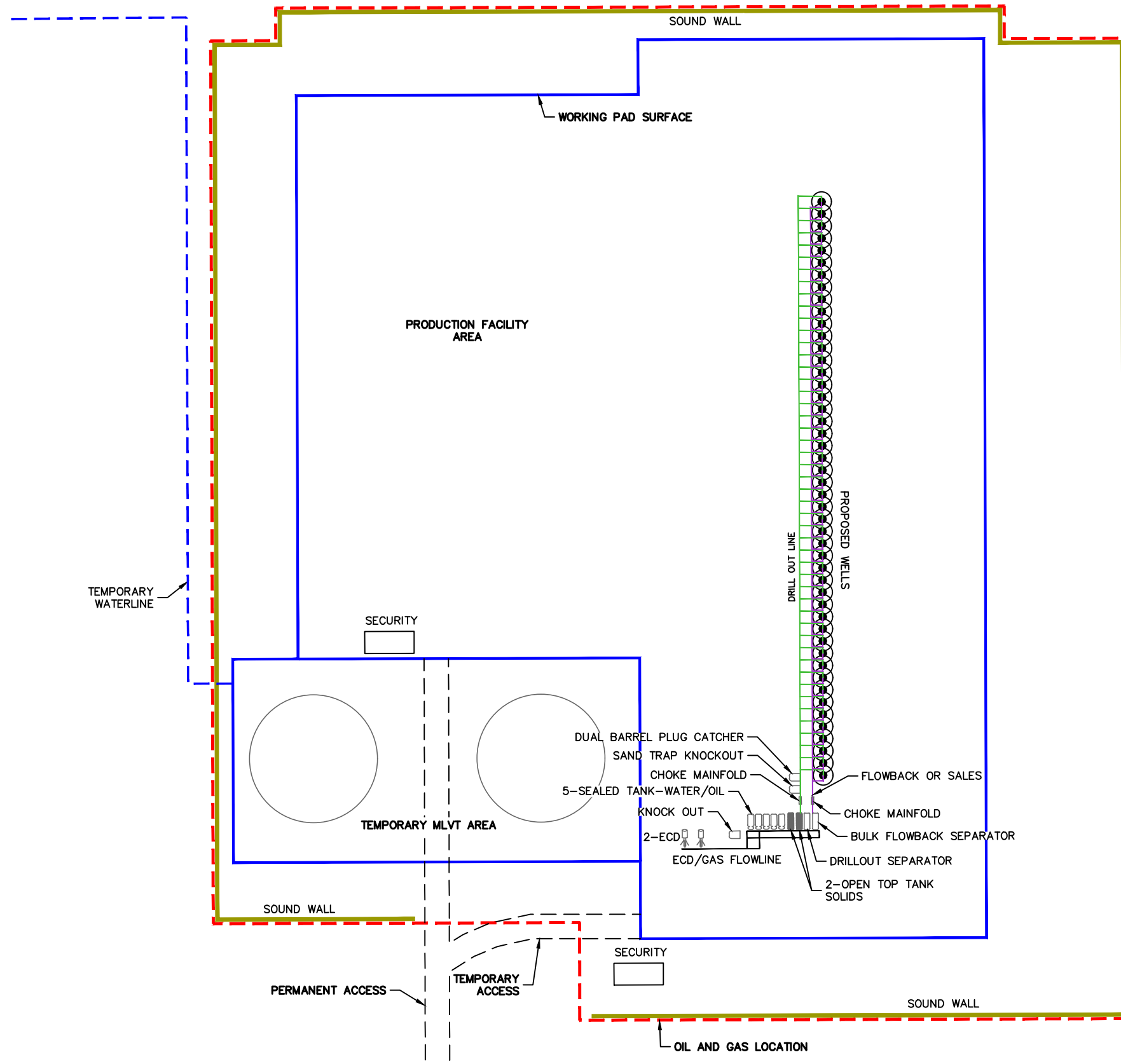

NOTES:
LAYOUTS SHOWN HEREON ARE SUBJECT TO CHANGES DUE TO EQUIPMENT AVAILABILITY AND TECHNOLOGY CHANGES.

LEGEND
[Blue Solid Line] WORKING PAD SURFACE
[Red Dashed Line] OIL AND GAS LOCATION

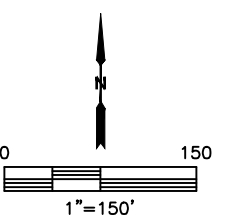

OIL AND GAS FACILITIES LAYOUT DRAWING

TRIPPETT 3N66W03 1-48 PAD
PDC ENERGY

Q: E2SW4, W2SE4
SECTION: 3
TOWNSHIP: 3N
RANGE: 66W
6TH. P.M.
WELD COUNTY, CO

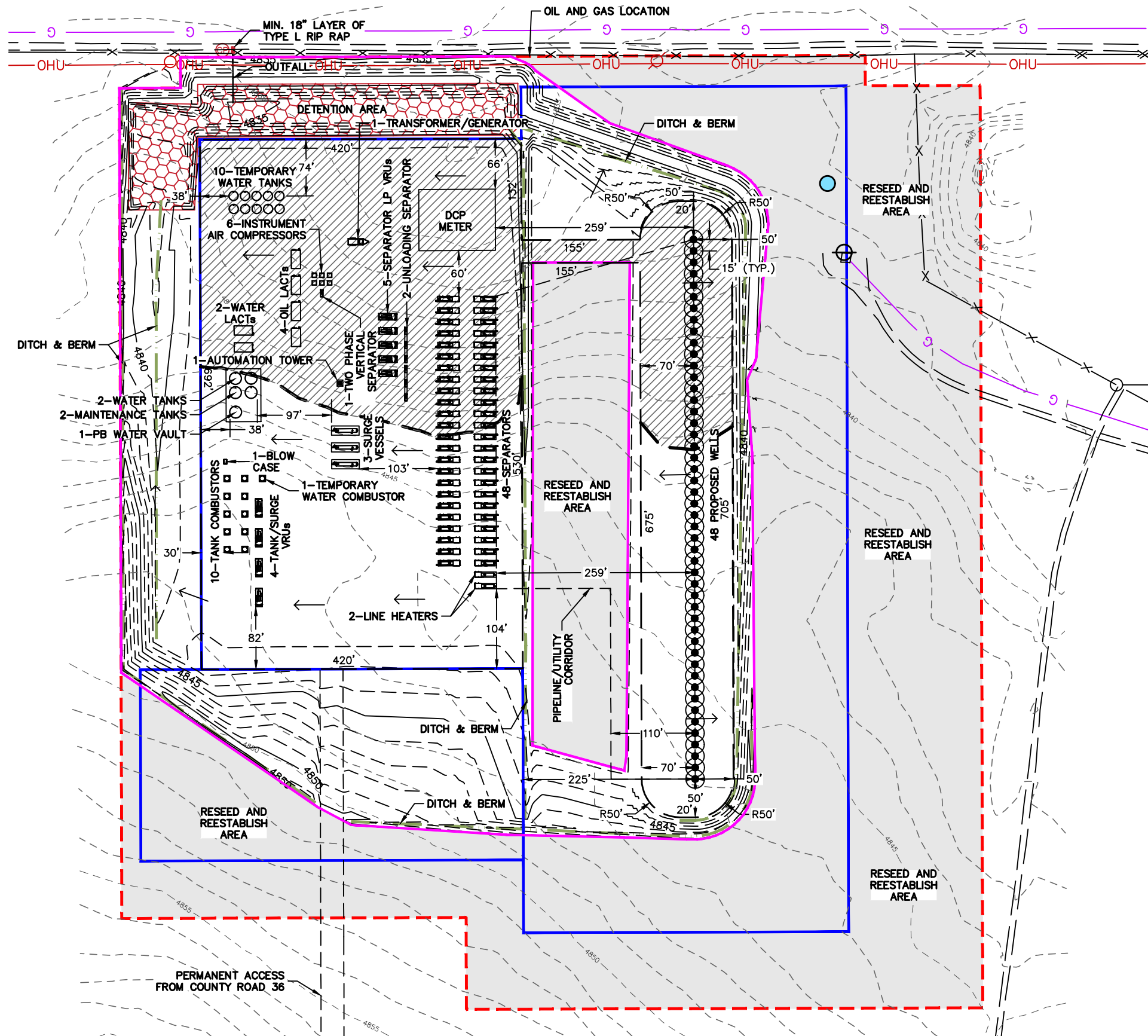

SEE PROPOSED GRADING PLAN FOR ADDITIONAL INFORMATION AS PREPARED BY OTHERS

OIL AND GAS LOCATION: ±30.7 ACRES
RECLAIMED AREA: ±14.7 ACRES
UNRECLAIMED AREA: ±16.0 ACRES

- LEGEND
- UNRECLAIMED AREA
 - WORKING PAD SURFACE
 - OIL AND GAS LOCATION
 - FILL
 - RECLAIMED AREA - RESEED & REESTABLISH
 - EXISTING CONTOUR - 1' INTERVAL
 - PROPOSED CONTOUR - 1' INTERVAL
 - DITCH & BERM
 - CUT/FILL LINE
 - PROPOSED EDGE OF GRAVEL
 - CULVERT PROTECTION
 - CULVERT
 - FLOW ARROW

NOTE:
1. Ground elevations are based on an observed GPS elevation (NAVD 1988 DATUM).
2. All equipment is PROPOSED unless otherwise noted.

