



RECEIVED

AUG 18 1969

COLO. OIL & GAS CONS. COMM.

R. 55W

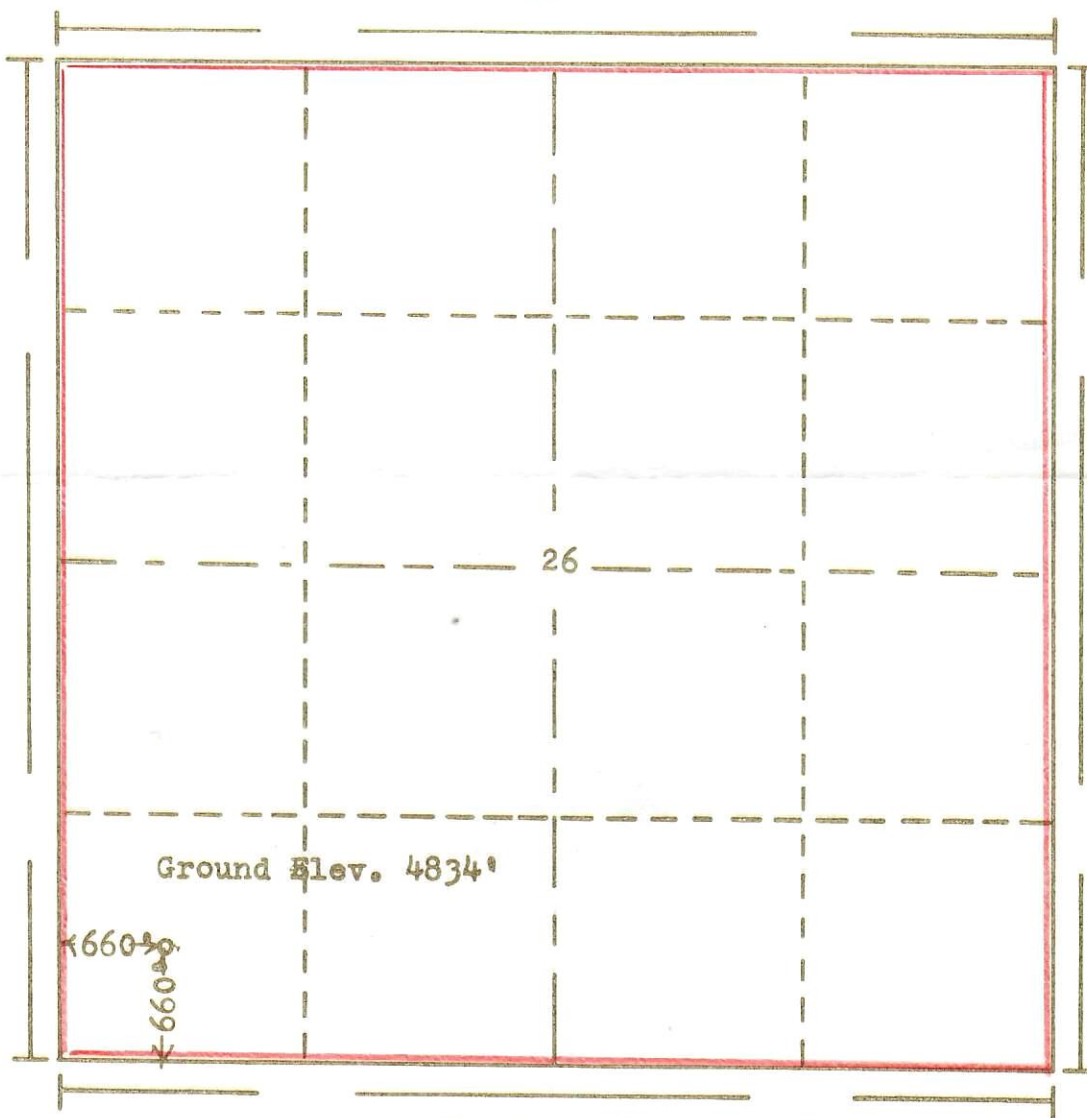

Scale... 1" = 1000'

Powers Elevation Company, Inc. of Denver, Colorado
has in accordance with a request from Mr. Brooks
for Enbrook Oil & Gas Co.
determined the location of No.1 Lewis Ross
to be CSW SW Section 26 Township 3S
Range 55W of the 6th Principal Meridian
Washington County, Colorado

I hereby certify that this plat is an
accurate representation of a correct
survey showing the location of

Date 8-8-69

David J. Hollman
Licensed Land Surveyor No. 2853
State of Colorado

69-479