



FORM F-106

79-103



02357727

R. 55W

RECEIVED

FEB 23 1979

COLO. OIL & GAS CONS. COMM.

State

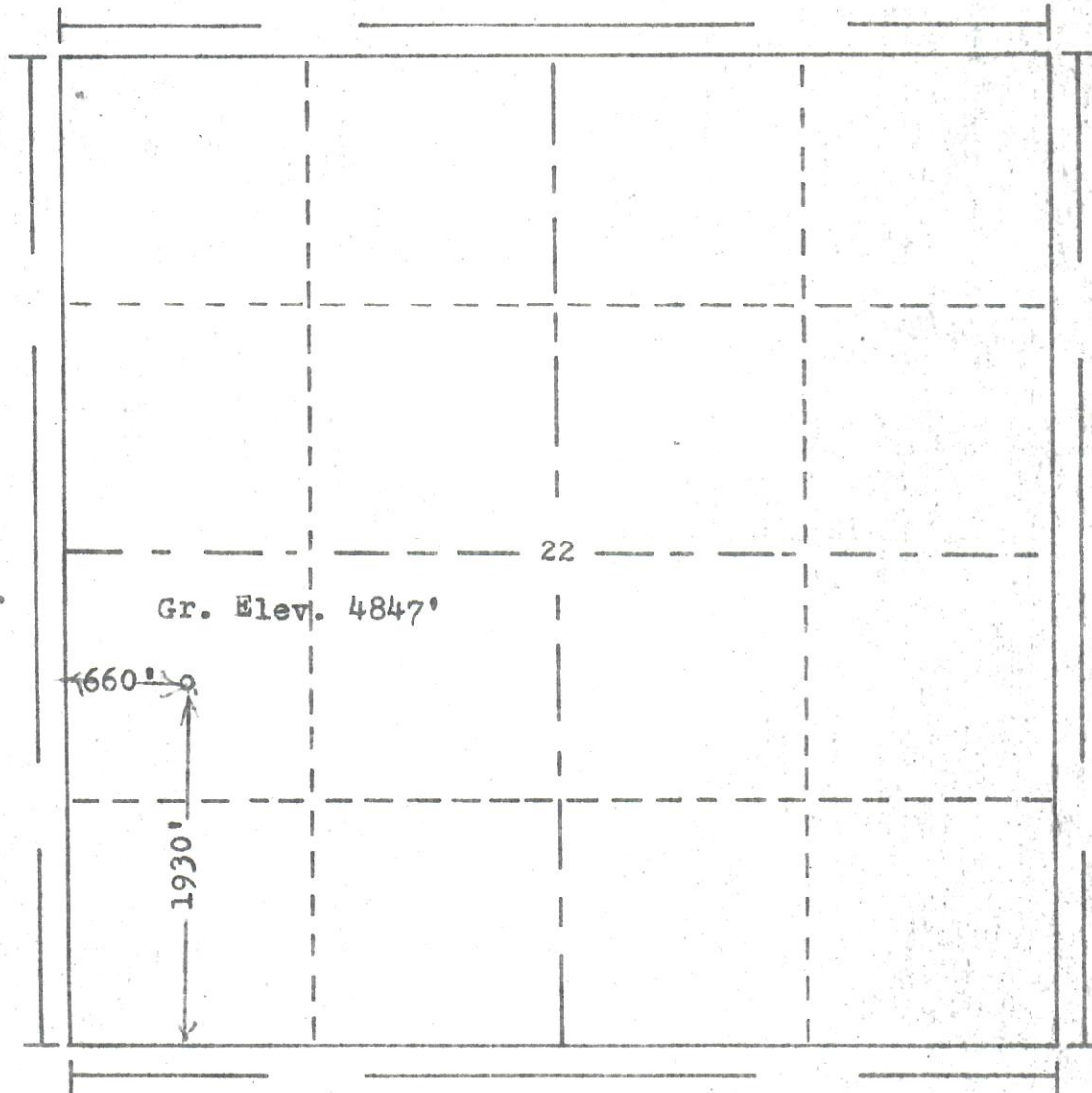
T.
3
S

Scale... 1" = 1000'

Powers Elevation Company, Inc. of Denver, Colorado
has in accordance with a request from Shirley
for C.W. Hughes

determined the location of No.1 Layne-Marable
to be 1930'FS & 660'FW Section 22 Township 3S
Range 55W of the 6th Principal Meridian
Washington County, Colorado

I hereby certify that this plat is an
accurate representation of a correct
survey showing the location of

Date: 2-15-79

Brian J. H...
Licensed Land Surveyor No. 2853
State of Colorado