



RECEIVED

MAY - 8 1969

R.46 W

COLO. OIL & GAS CONS. COMM.

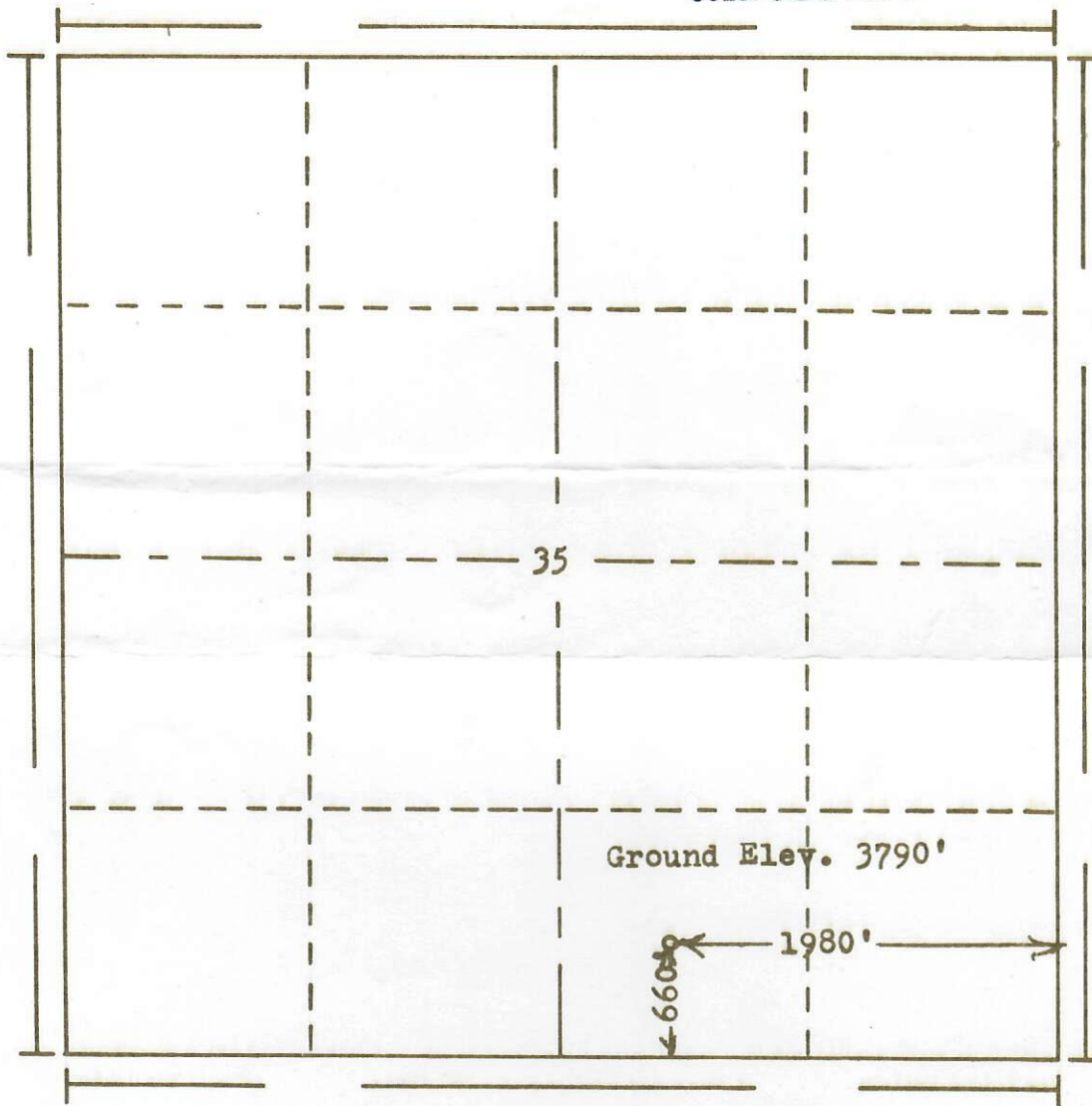

T.
19
S

Scale... 1" = 1000'

Powers Elevation Company, Inc. of Denver, Colorado
has in accordance with a request from Robert E. Johnson
for Plains Exploration Co.
determined the location of No.1 Test Well
to be C SW SE Section 35 Township 19 South
Range 46 West of the 6th Principal Meridian South
Kiowa County, Colorado

I hereby certify that this plat is an
accurate representation of a correct
survey showing the location of

Date: 5-5-69

Billy D. Holloway
Licensed Land Surveyor No. 2853
State of Colorado

69-204