

TO: CHEVRON OIL COMPANY, DENVER, COLORADO
LEASE LOCATION SEC. 4, T.19S, R.45W, 6th P.M.
WELL NAME CHIVINGTON GRASS ASS. * 2 LOCATION CEN NE 1/4 NE 1/4
COUNTY KIOWA STATE COLORADO

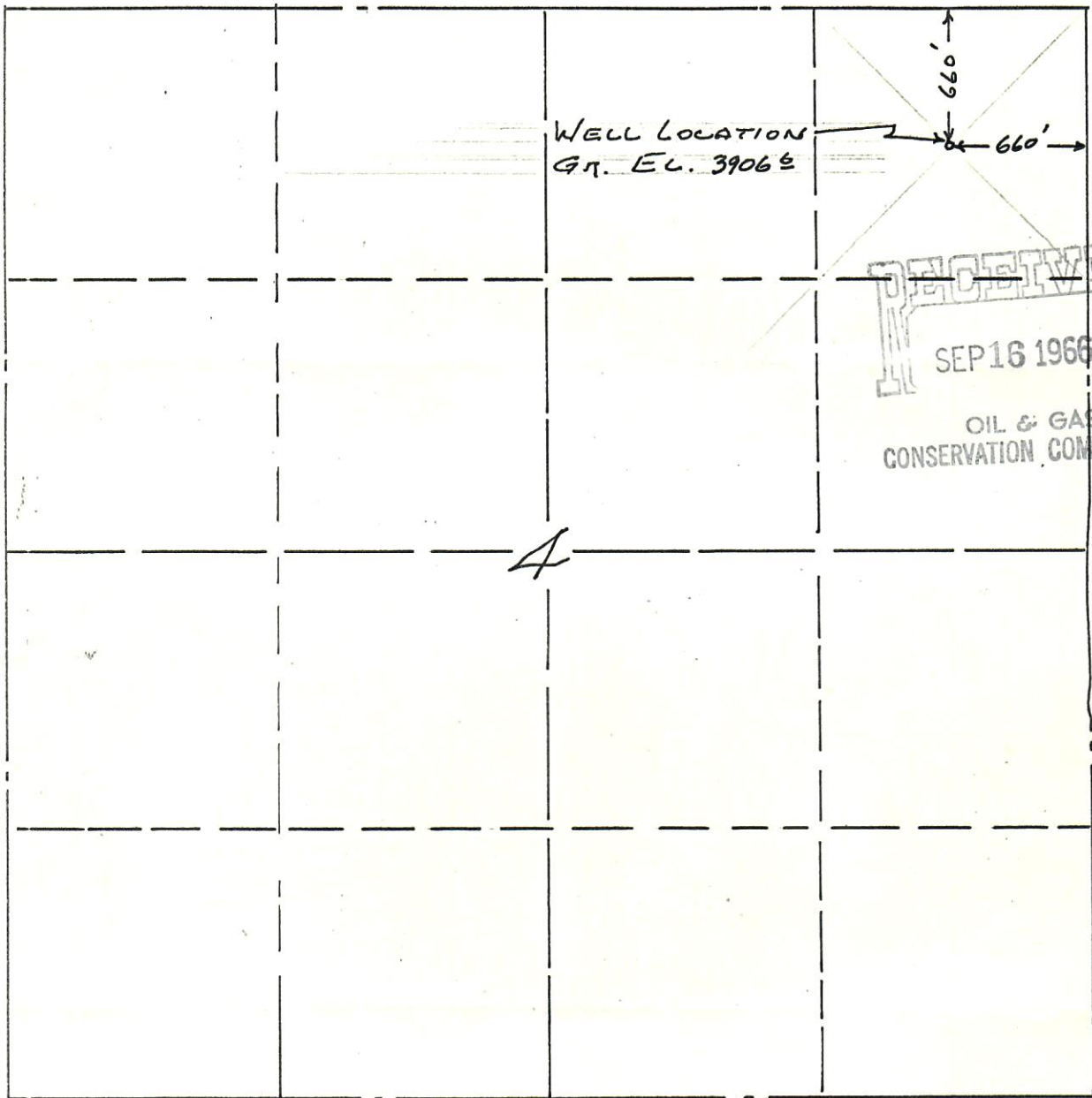

I, HEREBY CERTIFY THAT THE WELL LOCATION
SHOWN ON THE ABOVE PLAT WAS STAKED AND
MEASURED AS SHOWN ON THIS PLAT.

ORDER NO CW 20209

DATE 12 SEPT 1966



Shale P. Hillman
REGISTERED ENGINEER
LAMAR, COLO.