

Location:	COLORADO	Slot:	SLOT#01 G & D HANKS M-27-28HN (1348'FSL & 1573'FEL, SEC.27)
Field:	WELD COUNTY (NAD83/TRUE NORTH)	Well:	G & D HANKS M-27-28HN
Facility:	SEC.27-T07N-R66W	Wellbore:	G & D HANKS M-27-28HN PWB
Plot reference wellpath is G & D HANKS M-27-28HN (REV-E.O.) PWP		Grid System: NAD83 / Lambert Colorado SP, Northern Zone (501), US feet	
True vertical depths are referenced to TRUE 38 (4876'GL + 25'KB @ 4901'RKB) (RKB)		North Reference: True north	
Reference wellpath measured depths are referenced to TRUE 38 (4876'GL + 25'KB @ 4901'RKB) (RKB)		Scale: True distance	
TRUE 38 (4876'GL + 25'KB @ 4901'RKB) (RKB) to Mean Sea Level: 4901 feet		Coordinates are in feet referenced to Slot	
Mean Sea Level to Ground level (At Slot: SLOT#01 G & D HANKS M-27-28HN (1348'FSL & 1573'FEL, SEC.27)): 0 feet		Depths are in feet	
Offset wellpath MDs are referenced to each path's default MD datum		Created by: bloomington on 2023-01-25, Database: WellArchitectDB	

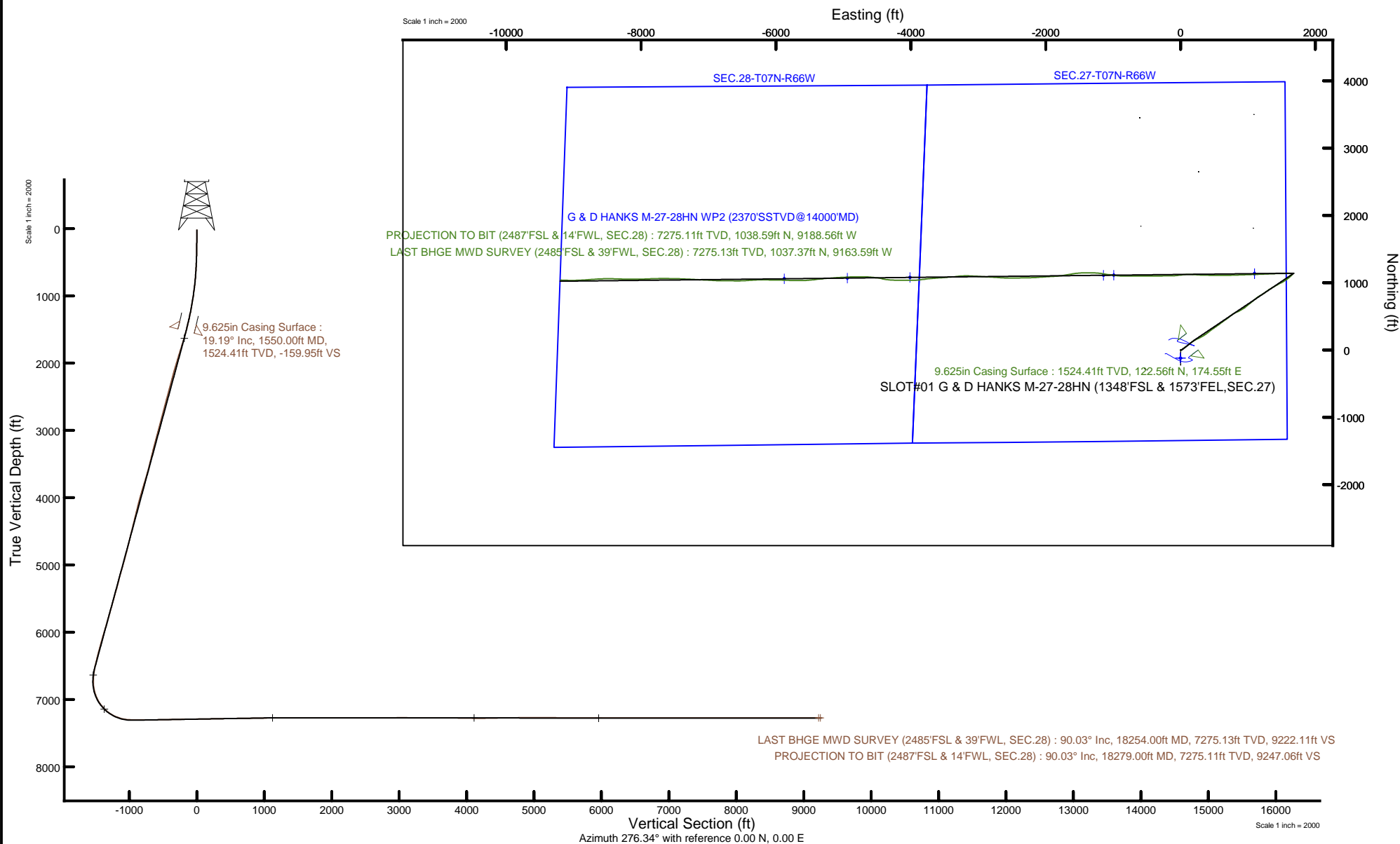

REFERENCE WELLPATH IDENTIFICATION			
Operator	BAYSWATER E&P, LLC	Well	G & D HANKS M-27-28HN
Field	WELD COUNTY (NAD83/TRUE NORTH)	API	05-123-46027
Facility	SEC.27-T07N-R66W	Wellbore	G & D HANKS M-27-28HN AWB
Slot	SLOT#01 G & D HANKS M-27-28HN (1348'FSL & 1573'FEL,SEC.27)		

REPORT SETUP INFORMATION			
Projection System	NAD83 / Lambert Colorado SP, Northern Zone (501), US feet	Software System	WellArchitect® 6.0
North Reference	True	User	Bloojosf
Scale	0.999970	Report Generated	1/25/2023 at 9:03:06 AM
Convergence at slot	0.48° East	Database	WellArchitectDB

WELLPATH LOCATION						
	Local coordinates		Grid coordinates		Geographic coordinates	
	North[ft]	East[ft]	Easting[US ft]	Northing[US ft]	Latitude	Longitude
Slot Location	0.00	0.00	3205703.16	1441302.53	40°32'32.7084"N	104°45'35.4708"W
Facility Reference Pt			3205703.16	1441302.53	40°32'32.7084"N	104°45'35.4708"W
Field Reference Pt			3174587.00	1430859.71	40°30'51.8900"N	104°52'19.4700"W

WELLPATH DATUM			
Calculation method	Minimum curvature	TRUE 38 (4876'GL + 25'KB @ 4901'RKB) (RKB) to Facility Vertical Datum	4901.00ft
Horizontal Reference Pt	Slot	TRUE 38 (4876'GL + 25'KB @ 4901'RKB) (RKB) to Mean Sea Level	4901.00ft
Vertical Reference Pt	TRUE 38 (4876'GL + 25'KB @ 4901'RKB) (RKB)	TRUE 38 (4876'GL + 25'KB @ 4901'RKB) (RKB) to Ground Level at Slot (SLOT#01 G & D HANKS M-27-28HN (1348'FSL & 1573'FEL,SEC.27))	4901.00ft
MD Reference Pt	TRUE 38 (4876'GL + 25'KB @ 4901'RKB) (RKB)	Section Origin	N 0.00, E 0.00 ft
Field Vertical Reference	Mean Sea Level	Section Azimuth	276.34°

### REFERENCE WELLPATH IDENTIFICATION

Operator	BAYSWATER E&P, LLC	Well	G & D HANKS M-27-28HN
Field	WELD COUNTY (NAD83/TRUE NORTH)	API	05-123-46027
Facility	SEC.27-T07N-R66W	Wellbore	G & D HANKS M-27-28HN AWP
Slot	SLOT#01 G & D HANKS M-27-28HN (1348'FSL & 1573'FEL,SEC.27)		

### WELLPATH DATA (196 stations) † = interpolated, ‡ = extrapolated station

MD [ft]	Inclination [°]	Azimuth [°]	TVD [ft]	Vert Sect [ft]	North [ft]	East [ft]	Latitude	Longitude	DLS [°/100ft]	Comments
0.00†	0.000	147.330	0.00	0.00	0.00	0.00	40°32'32.7084"N	104°45'35.4708"W	0.00	
25.00	0.000	147.330	25.00	0.00	0.00	0.00	40°32'32.7084"N	104°45'35.4708"W	0.00	
233.00	1.000	147.330	232.99	-1.14	-1.53	0.98	40°32'32.6933"N	104°45'35.4581"W	0.48	
326.00	1.120	130.340	325.97	-2.41	-2.80	2.11	40°32'32.6807"N	104°45'35.4435"W	0.36	
419.00	1.680	100.230	418.95	-4.52	-3.63	4.15	40°32'32.6725"N	104°45'35.4171"W	0.97	
513.00	2.400	70.600	512.89	-7.67	-3.22	7.36	40°32'32.6766"N	104°45'35.3755"W	1.33	
608.00	4.360	62.800	607.72	-12.47	-0.91	12.45	40°32'32.6994"N	104°45'35.3096"W	2.11	
702.00	5.850	54.840	701.35	-19.04	3.48	19.54	40°32'32.7428"N	104°45'35.2177"W	1.75	
797.00	7.870	53.680	795.66	-27.45	10.12	28.74	40°32'32.8084"N	104°45'35.0985"W	2.13	
891.00	9.590	53.870	888.57	-37.96	18.55	40.25	40°32'32.8917"N	104°45'34.9494"W	1.83	
985.00	11.290	52.490	981.01	-50.37	28.77	53.87	40°32'32.9927"N	104°45'34.7730"W	1.83	
1080.00	12.750	52.060	1073.92	-64.58	40.88	69.52	40°32'33.1124"N	104°45'34.5703"W	1.54	
1174.00	14.420	51.590	1165.29	-80.32	54.53	86.87	40°32'33.2472"N	104°45'34.3456"W	1.78	
1269.00	15.990	52.220	1256.96	-98.12	69.90	106.48	40°32'33.3991"N	104°45'34.0915"W	1.66	
1363.00	17.210	51.940	1347.04	-117.35	86.40	127.67	40°32'33.5622"N	104°45'33.8171"W	1.30	
1458.00	18.500	52.070	1437.46	-138.18	104.33	150.62	40°32'33.7394"N	104°45'33.5198"W	1.36	
1508.00	19.350	52.150	1484.76	-149.80	114.29	163.42	40°32'33.8378"N	104°45'33.3540"W	1.70	
1594.00	19.060	57.310	1565.98	-170.93	130.62	186.49	40°32'33.9991"N	104°45'33.0552"W	2.00	
1688.00	20.270	63.450	1654.51	-196.53	146.19	213.98	40°32'34.1529"N	104°45'32.6992"W	2.55	
1783.00	20.340	63.160	1743.60	-224.17	161.00	243.43	40°32'34.2993"N	104°45'32.3177"W	0.13	
1878.00	20.260	62.130	1832.70	-251.59	176.14	272.70	40°32'34.4489"N	104°45'31.9385"W	0.39	
1973.00	20.230	62.310	1921.83	-278.80	191.46	301.79	40°32'34.6003"N	104°45'31.5618"W	0.07	
2067.00	20.280	59.830	2010.02	-305.37	207.20	330.26	40°32'34.7558"N	104°45'31.1930"W	0.91	
2161.00	20.220	57.070	2098.21	-331.04	224.22	357.98	40°32'34.9240"N	104°45'30.8339"W	1.02	
2256.00	20.260	53.090	2187.35	-355.73	243.03	384.91	40°32'35.1098"N	104°45'30.4851"W	1.45	
2351.00	20.210	52.070	2276.49	-379.46	262.99	411.01	40°32'35.3071"N	104°45'30.1471"W	0.38	
2445.00	20.260	52.060	2364.69	-402.74	282.98	436.65	40°32'35.5046"N	104°45'29.8149"W	0.05	
2540.00	20.210	54.120	2453.83	-426.67	302.71	462.92	40°32'35.6995"N	104°45'29.4747"W	0.75	
2634.00	19.490	54.500	2542.24	-450.37	321.33	488.84	40°32'35.8836"N	104°45'29.1389"W	0.78	
2729.00	19.660	55.010	2631.75	-474.18	339.70	514.84	40°32'36.0650"N	104°45'28.8022"W	0.25	
2824.00	19.770	54.590	2721.18	-498.17	358.17	541.02	40°32'36.2476"N	104°45'28.4630"W	0.19	
2918.00	19.540	53.720	2809.71	-521.60	376.69	566.65	40°32'36.4305"N	104°45'28.1310"W	0.40	
3013.00	19.530	53.340	2899.24	-544.90	395.57	592.20	40°32'36.6171"N	104°45'27.8001"W	0.13	
3107.00	19.780	53.230	2987.76	-568.01	414.47	617.54	40°32'36.8039"N	104°45'27.4718"W	0.27	
3202.00	19.620	54.660	3077.20	-591.65	433.32	643.43	40°32'36.9901"N	104°45'27.1365"W	0.53	
3297.00	19.630	55.150	3166.68	-615.57	451.66	669.54	40°32'37.1714"N	104°45'26.7983"W	0.17	
3391.00	19.220	52.840	3255.33	-638.68	470.03	694.82	40°32'37.3529"N	104°45'26.4708"W	0.93	
3486.00	19.030	51.580	3345.09	-661.02	489.10	719.42	40°32'37.5413"N	104°45'26.1522"W	0.48	
3580.00	19.180	51.980	3433.91	-682.94	508.13	743.59	40°32'37.7294"N	104°45'25.8391"W	0.21	
3675.00	18.840	55.330	3523.73	-705.68	526.47	768.50	40°32'37.9106"N	104°45'25.5164"W	1.20	
3770.00	18.930	59.520	3613.62	-729.59	543.02	794.40	40°32'38.0740"N	104°45'25.1810"W	1.43	
3864.00	19.130	65.020	3702.49	-754.95	557.26	821.50	40°32'38.2147"N	104°45'24.8299"W	1.92	
3959.00	19.130	65.040	3792.25	-781.55	570.40	849.73	40°32'38.3446"N	104°45'24.4643"W	0.01	
4053.00	19.220	64.090	3881.03	-807.80	583.66	877.61	40°32'38.4756"N	104°45'24.1031"W	0.35	
4147.00	19.440	60.030	3969.74	-833.49	598.23	905.08	40°32'38.6196"N	104°45'23.7473"W	1.45	

REFERENCE WELLPATH IDENTIFICATION			
Operator	BAYSWATER E&P, LLC	Well	G & D HANKS M-27-28HN
Field	WELD COUNTY (NAD83/TRUE NORTH)	API	05-123-46027
Facility	SEC.27-T07N-R66W	Wellbore	G & D HANKS M-27-28HN AWP
Slot	SLOT#01 G & D HANKS M-27-28HN (1348'FSL & 1573'FEL,SEC.27)		

WELLPATH DATA (196 stations)										
MD [ft]	Inclination [°]	Azimuth [°]	TVD [ft]	Vert Sect [ft]	North [ft]	East [ft]	Latitude	Longitude	DLS [°/100ft]	Comments
4242.00	19.420	55.200	4059.33	-858.13	615.15	931.74	40°32'38.7867"N	104°45'23.4019"W	1.69	
4336.00	19.260	51.600	4148.03	-880.91	633.69	956.72	40°32'38.9700"N	104°45'23.0783"W	1.28	
4431.00	19.150	50.150	4237.74	-902.83	653.41	980.97	40°32'39.1648"N	104°45'22.7643"W	0.52	
4525.00	19.290	51.560	4326.51	-924.52	672.94	1004.96	40°32'39.3578"N	104°45'22.4534"W	0.52	
4620.00	19.070	51.720	4416.23	-946.71	692.31	1029.44	40°32'39.5492"N	104°45'22.1364"W	0.24	
4714.00	19.440	49.940	4504.97	-968.42	711.89	1053.46	40°32'39.7427"N	104°45'21.8252"W	0.74	
4809.00	19.550	50.190	4594.53	-990.34	732.25	1077.77	40°32'39.9438"N	104°45'21.5103"W	0.15	
4904.00	19.510	51.400	4684.06	-1012.58	752.32	1102.38	40°32'40.1421"N	104°45'21.1915"W	0.43	
4998.00	19.470	50.410	4772.68	-1034.59	772.10	1126.72	40°32'40.3375"N	104°45'20.8762"W	0.35	
5093.00	19.320	54.470	4862.29	-1057.30	791.32	1151.71	40°32'40.5275"N	104°45'20.5525"W	1.43	
5188.00	19.320	60.140	4951.95	-1081.69	808.28	1178.13	40°32'40.6950"N	104°45'20.2103"W	1.97	
5283.00	19.360	62.070	5041.59	-1107.38	823.48	1205.67	40°32'40.8452"N	104°45'19.8535"W	0.67	
5377.00	19.560	56.370	5130.23	-1132.32	839.49	1232.54	40°32'41.0034"N	104°45'19.5055"W	2.03	
5472.00	19.770	52.550	5219.69	-1156.11	858.07	1258.54	40°32'41.1870"N	104°45'19.1687"W	1.37	
5567.00	19.160	54.700	5309.26	-1179.36	876.85	1284.02	40°32'41.3725"N	104°45'18.8387"W	0.99	
5661.00	19.470	57.350	5397.97	-1203.06	894.21	1309.80	40°32'41.5441"N	104°45'18.5047"W	0.99	
5756.00	19.370	58.360	5487.57	-1227.79	911.02	1336.54	40°32'41.7102"N	104°45'18.1583"W	0.37	
5850.00	19.060	60.650	5576.33	-1252.54	926.72	1363.19	40°32'41.8653"N	104°45'17.8131"W	0.87	
5945.00	19.580	59.630	5665.98	-1277.90	942.37	1390.45	40°32'42.0199"N	104°45'17.4600"W	0.65	
6040.00	19.920	59.260	5755.39	-1303.57	958.69	1418.09	40°32'42.1812"N	104°45'17.1019"W	0.38	
6134.00	19.450	61.410	5843.90	-1329.18	974.37	1445.60	40°32'42.3361"N	104°45'16.7456"W	0.92	
6229.00	19.640	62.800	5933.43	-1355.46	989.23	1473.69	40°32'42.4830"N	104°45'16.3818"W	0.53	
6324.00	19.330	60.900	6022.99	-1381.57	1004.18	1501.63	40°32'42.6306"N	104°45'16.0199"W	0.74	
6418.00	19.520	59.260	6111.64	-1406.78	1019.77	1528.72	40°32'42.7847"N	104°45'15.6690"W	0.61	
6513.00	19.550	56.050	6201.17	-1431.57	1036.76	1555.54	40°32'42.9525"N	104°45'15.3214"W	1.13	
6608.00	19.890	54.020	6290.60	-1455.64	1055.13	1581.81	40°32'43.1341"N	104°45'14.9812"W	0.80	
6702.00	19.600	51.190	6379.08	-1478.58	1074.41	1607.03	40°32'43.3245"N	104°45'14.6545"W	1.06	
6797.00	19.570	47.560	6468.58	-1500.31	1095.13	1631.19	40°32'43.5293"N	104°45'14.3415"W	1.28	
6891.00	17.490	43.850	6557.71	-1519.28	1115.94	1652.60	40°32'43.7349"N	104°45'14.0642"W	2.54	
6986.00	8.790	37.550	6650.14	-1531.76	1132.03	1666.94	40°32'43.8938"N	104°45'13.8784"W	9.27	
7081.00	0.250	217.600	6744.77	-1535.42	1137.63	1671.25	40°32'43.9492"N	104°45'13.8226"W	9.52	
7175.00	10.730	268.490	6838.22	-1526.62	1137.23	1662.35	40°32'43.9453"N	104°45'13.9379"W	11.25	
7269.00	19.730	272.520	6928.82	-1502.07	1137.70	1637.70	40°32'43.9499"N	104°45'14.2572"W	9.63	
7364.00	28.420	269.860	7015.48	-1463.53	1138.35	1599.00	40°32'43.9564"N	104°45'14.7585"W	9.22	
7459.00	38.950	268.050	7094.42	-1411.38	1137.28	1546.40	40°32'43.9458"N	104°45'15.4398"W	11.13	
7552.00	47.870	269.830	7161.92	-1348.06	1136.18	1482.57	40°32'43.9350"N	104°45'16.2667"W	9.68	
7647.00	58.580	268.210	7218.71	-1272.71	1134.80	1406.60	40°32'43.9215"N	104°45'17.2507"W	11.36	
7740.00	68.420	267.540	7260.15	-1190.49	1131.70	1323.53	40°32'43.8908"N	104°45'18.3267"W	10.60	
7835.00	77.220	267.510	7288.19	-1100.89	1127.79	1232.94	40°32'43.8522"N	104°45'19.5001"W	9.26	
7930.00	86.680	267.990	7301.48	-1007.98	1124.10	1139.06	40°32'43.8158"N	104°45'20.7162"W	9.97	
8025.00	89.970	268.260	7304.25	-914.01	1121.00	1044.16	40°32'43.7852"N	104°45'21.9454"W	3.47	
8119.00	90.000	268.010	7304.28	-820.97	1117.94	950.21	40°32'43.7550"N	104°45'23.1624"W	0.27	
8214.00	89.970	267.920	7304.30	-726.99	1114.56	855.27	40°32'43.7217"N	104°45'24.3922"W	0.10	
8307.00	91.140	268.210	7303.40	-634.96	1111.42	762.33	40°32'43.6907"N	104°45'25.5961"W	1.30	
8402.00	91.170	269.340	7301.49	-540.81	1109.39	667.38	40°32'43.6706"N	104°45'26.8261"W	1.19	

REFERENCE WELLPATH IDENTIFICATION			
Operator	BAYSWATER E&P, LLC	Well	G & D HANKS M-27-28HN
Field	WELD COUNTY (NAD83/TRUE NORTH)	API	05-123-46027
Facility	SEC.27-T07N-R66W	Wellbore	G & D HANKS M-27-28HN AWP
Slot	SLOT#01 G & D HANKS M-27-28HN (1348'FSL & 1573'FEL,SEC.27)		

WELLPATH DATA (196 stations)										
MD [ft]	Inclination [°]	Azimuth [°]	TVD [ft]	Vert Sect [ft]	North [ft]	East [ft]	Latitude	Longitude	DLS [°/100ft]	Comments
8496.00	91.020	270.340	7299.69	-447.43	1109.13	573.39	40°32'43.6681"N	104°45'28.0435"W	1.08	
8590.00	91.020	271.070	7298.02	-353.90	1110.29	479.42	40°32'43.6795"N	104°45'29.2608"W	0.78	
8685.00	91.020	270.970	7296.33	-259.32	1111.98	384.45	40°32'43.6962"N	104°45'30.4910"W	0.11	
8779.00	91.140	272.160	7294.55	-165.67	1114.54	290.50	40°32'43.7216"N	104°45'31.7079"W	1.27	
8874.00	90.680	274.680	7293.04	-70.81	1120.21	195.69	40°32'43.7776"N	104°45'32.9360"W	2.70	
8969.00	90.180	268.680	7292.33	23.83	1122.99	100.78	40°32'43.8051"N	104°45'34.1654"W	6.34	
9063.00	91.080	261.070	7291.30	115.88	1114.60	7.23	40°32'43.7222"N	104°45'35.3772"W	8.15	
9158.00	91.350	266.840	7289.28	208.61	1104.61	-87.18	40°32'43.6234"N	104°45'36.6001"W	6.08	
9253.00	90.860	270.150	7287.45	302.69	1102.11	-182.12	40°32'43.5988"N	104°45'37.8298"W	3.52	
9347.00	91.080	268.650	7285.86	395.99	1101.13	-276.10	40°32'43.5891"N	104°45'39.0472"W	1.61	
9442.00	91.140	268.720	7284.02	490.12	1098.95	-371.05	40°32'43.5675"N	104°45'40.2772"W	0.10	
9536.00	90.710	270.180	7282.50	583.43	1098.05	-465.04	40°32'43.5586"N	104°45'41.4945"W	1.62	
9631.00	90.860	270.800	7281.20	677.92	1098.86	-560.02	40°32'43.5666"N	104°45'42.7249"W	0.67	
9725.00	90.770	271.370	7279.86	771.52	1100.64	-654.00	40°32'43.5841"N	104°45'43.9422"W	0.61	
9820.00	90.860	268.610	7278.51	865.92	1100.62	-748.98	40°32'43.5840"N	104°45'45.1725"W	2.91	
9914.00	90.980	269.550	7277.00	959.15	1099.11	-842.95	40°32'43.5690"N	104°45'46.3898"W	1.01	
10009.00	90.860	275.910	7275.47	1053.90	1103.63	-937.78	40°32'43.6137"N	104°45'47.6182"W	6.70	
10104.00	90.060	278.180	7274.71	1148.88	1115.28	-1032.06	40°32'43.7287"N	104°45'48.8393"W	2.53	
10200.00	90.000	278.910	7274.66	1244.81	1129.55	-1126.99	40°32'43.8697"N	104°45'50.0690"W	0.76	
10294.00	90.030	275.630	7274.63	1338.79	1141.44	-1220.22	40°32'43.9871"N	104°45'51.2767"W	3.49	
10389.00	90.120	270.650	7274.51	1433.61	1146.64	-1315.05	40°32'44.0385"N	104°45'52.5050"W	5.24	
10484.00	90.220	269.740	7274.23	1528.06	1146.97	-1410.05	40°32'44.0416"N	104°45'53.7356"W	0.96	
10578.00	89.880	265.610	7274.15	1620.97	1143.15	-1503.95	40°32'44.0039"N	104°45'54.9519"W	4.41	
10673.00	90.000	260.170	7274.25	1713.33	1131.40	-1598.18	40°32'43.8877"N	104°45'56.1725"W	5.73	
10768.00	90.220	259.880	7274.06	1804.50	1114.95	-1691.75	40°32'43.7250"N	104°45'57.3845"W	0.38	
10862.00	90.000	263.920	7273.88	1895.52	1101.70	-1784.79	40°32'43.5941"N	104°45'58.5897"W	4.30	
10956.00	90.000	267.440	7273.88	1987.88	1094.62	-1878.51	40°32'43.5241"N	104°45'59.8036"W	3.74	
11051.00	90.340	266.470	7273.60	2081.61	1089.58	-1973.37	40°32'43.4742"N	104°46'1.0324"W	1.08	
11146.00	89.780	265.470	7273.50	2175.05	1082.90	-2068.13	40°32'43.4081"N	104°46'2.2599"W	1.21	
11240.00	89.850	267.070	7273.80	2267.60	1076.79	-2161.93	40°32'43.3476"N	104°46'3.4749"W	1.70	
11335.00	89.910	269.760	7274.00	2361.69	1074.16	-2256.89	40°32'43.3216"N	104°46'4.7049"W	2.83	
11429.00	90.400	267.680	7273.75	2454.85	1072.06	-2350.86	40°32'43.3007"N	104°46'5.9221"W	2.27	
11524.00	90.090	268.400	7273.34	2548.85	1068.81	-2445.80	40°32'43.2685"N	104°46'7.1519"W	0.83	
11618.00	90.060	270.920	7273.22	2642.21	1068.25	-2539.79	40°32'43.2629"N	104°46'8.3694"W	2.68	
11713.00	90.120	273.380	7273.07	2736.95	1071.82	-2634.72	40°32'43.2980"N	104°46'9.5990"W	2.59	
11808.00	90.120	274.340	7272.87	2831.86	1078.21	-2729.50	40°32'43.3611"N	104°46'10.8268"W	1.01	
11903.00	90.220	273.040	7272.59	2926.75	1084.32	-2824.30	40°32'43.4214"N	104°46'12.0547"W	1.37	
11997.00	90.030	273.410	7272.38	3020.61	1089.61	-2918.15	40°32'43.4736"N	104°46'13.2704"W	0.44	
12092.00	89.850	272.960	7272.48	3115.47	1094.89	-3013.00	40°32'43.5256"N	104°46'14.4991"W	0.51	
12187.00	89.750	272.990	7272.82	3210.31	1099.82	-3107.88	40°32'43.5742"N	104°46'15.7280"W	0.11	
12281.00	89.480	269.270	7273.45	3303.90	1101.68	-3201.84	40°32'43.5924"N	104°46'16.9451"W	3.97	
12376.00	89.720	262.910	7274.11	3397.33	1095.20	-3296.57	40°32'43.5283"N	104°46'18.1722"W	6.70	
12472.00	89.910	265.580	7274.42	3491.19	1085.57	-3392.07	40°32'43.4331"N	104°46'19.4093"W	2.79	
12566.00	89.850	265.760	7274.62	3583.57	1078.48	-3485.80	40°32'43.3628"N	104°46'20.6234"W	0.20	
12661.00	89.850	266.090	7274.87	3677.00	1071.73	-3580.56	40°32'43.2960"N	104°46'21.8508"W	0.35	

REFERENCE WELLPATH IDENTIFICATION			
Operator	BAYSWATER E&P, LLC	Well	G & D HANKS M-27-28HN
Field	WELD COUNTY (NAD83/TRUE NORTH)	API	05-123-46027
Facility	SEC.27-T07N-R66W	Wellbore	G & D HANKS M-27-28HN AWP
Slot	SLOT#01 G & D HANKS M-27-28HN (1348'FSL & 1573'FEL,SEC.27)		

WELLPATH DATA (196 stations)										
MD [ft]	Inclination [°]	Azimuth [°]	TVD [ft]	Vert Sect [ft]	North [ft]	East [ft]	Latitude	Longitude	DLS [°/100ft]	Comments
12756.00	89.880	265.930	7275.09	3770.46	1065.12	-3675.33	40°32'43.2305"N	104°46'23.0784"W	0.17	
12850.00	89.230	262.630	7275.82	3862.37	1055.75	-3768.85	40°32'43.1378"N	104°46'24.2897"W	3.58	
12944.00	89.050	261.770	7277.23	3953.51	1042.99	-3861.97	40°32'43.0116"N	104°46'25.4959"W	0.93	
13038.00	89.170	269.360	7278.69	4045.78	1035.73	-3955.61	40°32'42.9397"N	104°46'26.7088"W	8.07	
13133.00	89.320	270.120	7279.95	4140.14	1035.30	-4050.60	40°32'42.9353"N	104°46'27.9392"W	0.82	
13228.00	90.860	270.230	7279.80	4234.59	1035.59	-4145.59	40°32'42.9380"N	104°46'29.1697"W	1.63	
13323.00	90.860	271.860	7278.37	4329.17	1037.32	-4240.56	40°32'42.9550"N	104°46'30.3999"W	1.72	
13417.00	91.260	276.540	7276.63	4423.06	1044.20	-4334.27	40°32'43.0228"N	104°46'31.6137"W	5.00	
13511.00	90.620	281.640	7275.09	4516.91	1059.05	-4427.04	40°32'43.1693"N	104°46'32.8155"W	5.47	
13606.00	90.490	277.120	7274.17	4611.75	1074.53	-4520.75	40°32'43.3221"N	104°46'34.0292"W	4.76	
13701.00	90.830	274.330	7273.07	4706.72	1084.00	-4615.26	40°32'43.4156"N	104°46'35.2535"W	2.96	
13795.00	89.940	270.220	7272.44	4800.46	1087.73	-4709.16	40°32'43.4523"N	104°46'36.4698"W	4.47	
13889.00	90.150	269.290	7272.37	4893.84	1087.33	-4803.16	40°32'43.4481"N	104°46'37.6874"W	1.01	
13984.00	90.180	267.510	7272.09	4987.93	1084.68	-4898.12	40°32'43.4217"N	104°46'38.9174"W	1.87	
14078.00	90.340	267.290	7271.67	5080.79	1080.41	-4992.02	40°32'43.3794"N	104°46'40.1338"W	0.29	
14173.00	89.690	266.800	7271.64	5174.54	1075.52	-5086.89	40°32'43.3308"N	104°46'41.3627"W	0.86	
14267.00	89.750	265.490	7272.10	5267.05	1069.20	-5180.67	40°32'43.2682"N	104°46'42.5775"W	1.40	
14361.00	89.660	265.490	7272.59	5359.37	1061.81	-5274.38	40°32'43.1949"N	104°46'43.7913"W	0.10	
14456.00	89.690	263.210	7273.12	5452.29	1052.45	-5368.91	40°32'43.1023"N	104°46'45.0157"W	2.40	
14551.00	89.970	263.470	7273.41	5544.85	1041.44	-5463.27	40°32'42.9932"N	104°46'46.2379"W	0.40	
14646.00	90.060	267.300	7273.38	5638.11	1033.79	-5557.95	40°32'42.9175"N	104°46'47.4643"W	4.03	
14740.00	89.970	270.120	7273.36	5731.27	1031.68	-5651.91	40°32'42.8964"N	104°46'48.6814"W	3.00	
14835.00	89.880	271.600	7273.48	5825.83	1033.10	-5746.90	40°32'42.9103"N	104°46'49.9118"W	1.56	
14929.00	90.060	271.880	7273.53	5919.53	1035.96	-5840.86	40°32'42.9383"N	104°46'51.1289"W	0.35	
15024.00	89.880	270.980	7273.58	6014.18	1038.33	-5935.83	40°32'42.9615"N	104°46'52.3590"W	0.97	
15119.00	90.000	270.860	7273.68	6108.75	1039.85	-6030.81	40°32'42.9763"N	104°46'53.5894"W	0.18	
15213.00	89.820	271.060	7273.83	6202.34	1041.43	-6124.80	40°32'42.9916"N	104°46'54.8069"W	0.29	
15308.00	89.880	270.240	7274.08	6296.87	1042.51	-6219.79	40°32'43.0021"N	104°46'56.0373"W	0.87	
15403.00	89.970	267.070	7274.20	6391.00	1040.28	-6314.75	40°32'42.9798"N	104°46'57.2674"W	3.34	
15497.00	89.880	265.290	7274.32	6483.53	1034.01	-6408.54	40°32'42.9177"N	104°46'58.4822"W	1.90	
15592.00	89.940	268.130	7274.47	6577.18	1028.56	-6503.37	40°32'42.8635"N	104°46'59.7106"W	2.99	
15686.00	90.060	270.680	7274.47	6670.48	1027.59	-6597.36	40°32'42.8537"N	104°47'0.9280"W	2.72	
15781.00	89.910	270.080	7274.50	6764.97	1028.22	-6692.36	40°32'42.8596"N	104°47'2.1586"W	0.65	
15876.00	89.880	270.580	7274.67	6859.45	1028.76	-6787.36	40°32'42.8648"N	104°47'3.3891"W	0.53	
15970.00	90.000	272.310	7274.77	6953.10	1031.13	-6881.32	40°32'42.8879"N	104°47'4.6063"W	1.84	
16065.00	90.060	273.330	7274.72	7047.92	1035.81	-6976.21	40°32'42.9339"N	104°47'5.8354"W	1.08	
16159.00	89.970	272.860	7274.70	7141.77	1040.88	-7070.07	40°32'42.9837"N	104°47'7.0512"W	0.51	
16254.00	90.220	273.280	7274.54	7236.61	1045.97	-7164.93	40°32'43.0338"N	104°47'8.2800"W	0.51	
16349.00	89.910	272.870	7274.43	7331.46	1051.07	-7259.80	40°32'43.0838"N	104°47'9.5088"W	0.54	
16444.00	90.060	272.290	7274.46	7426.25	1055.34	-7354.70	40°32'43.1258"N	104°47'10.7381"W	0.63	
16538.00	89.970	271.670	7274.43	7519.98	1058.59	-7448.64	40°32'43.1576"N	104°47'11.9550"W	0.67	
16633.00	90.000	270.840	7274.46	7614.61	1060.67	-7543.62	40°32'43.1779"N	104°47'13.1853"W	0.87	
16727.00	90.150	270.330	7274.33	7708.13	1061.63	-7637.61	40°32'43.1871"N	104°47'14.4028"W	0.57	
16822.00	89.970	269.350	7274.23	7802.52	1061.37	-7732.61	40°32'43.1842"N	104°47'15.6334"W	1.05	
16916.00	90.090	267.950	7274.18	7895.67	1059.15	-7826.58	40°32'43.1620"N	104°47'16.8506"W	1.49	

REFERENCE WELLPATH IDENTIFICATION			
Operator	BAYSWATER E&P, LLC	Well	G & D HANKS M-27-28HN
Field	WELD COUNTY (NAD83/TRUE NORTH)	API	05-123-46027
Facility	SEC.27-T07N-R66W	Wellbore	G & D HANKS M-27-28HN AWB
Slot	SLOT#01 G & D HANKS M-27-28HN (1348'FSL & 1573'FEL,SEC.27)		

WELLPATH DATA (196 stations) † = interpolated, ‡ = extrapolated station										
MD [ft]	Inclination [°]	Azimuth [°]	TVD [ft]	Vert Sect [ft]	North [ft]	East [ft]	Latitude	Longitude	DLS [°/100ft]	Comments
17010.00	89.880	267.760	7274.21	7988.65	1055.63	-7920.52	40°32'43.1269"N	104°47'18.0673"W	0.30	
17105.00	89.880	269.180	7274.41	8082.75	1053.10	-8015.48	40°32'43.1016"N	104°47'19.2974"W	1.49	
17199.00	89.850	270.020	7274.63	8176.10	1052.44	-8109.48	40°32'43.0948"N	104°47'20.5150"W	0.89	
17294.00	89.780	270.750	7274.94	8270.58	1053.08	-8204.47	40°32'43.1008"N	104°47'21.7455"W	0.77	
17389.00	90.060	271.820	7275.07	8365.21	1055.21	-8299.45	40°32'43.1215"N	104°47'22.9757"W	1.16	
17483.00	89.940	271.260	7275.07	8458.88	1057.74	-8393.41	40°32'43.1462"N	104°47'24.1929"W	0.61	
17578.00	89.940	270.310	7275.17	8553.44	1059.04	-8488.40	40°32'43.1587"N	104°47'25.4233"W	1.00	
17673.00	89.880	267.440	7275.32	8647.62	1057.17	-8583.38	40°32'43.1400"N	104°47'26.6535"W	3.02	
17767.00	90.030	266.690	7275.39	8740.39	1052.36	-8677.25	40°32'43.0921"N	104°47'27.8695"W	0.81	
17862.00	90.030	265.060	7275.34	8833.81	1045.53	-8772.00	40°32'43.0242"N	104°47'29.0968"W	1.72	
17955.00	89.970	266.510	7275.34	8925.23	1038.69	-8864.75	40°32'42.9563"N	104°47'30.2981"W	1.56	
18050.00	90.030	268.610	7275.34	9019.11	1034.65	-8959.66	40°32'42.9160"N	104°47'31.5275"W	2.21	
18145.00	90.060	270.690	7275.27	9113.46	1034.07	-9054.65	40°32'42.9100"N	104°47'32.7579"W	2.19	
18239.00	90.090	272.500	7275.14	9207.14	1036.68	-9148.61	40°32'42.9355"N	104°47'33.9750"W	1.93	
18254.00	90.030	272.780	7275.13	9222.11	1037.37	-9163.59	40°32'42.9423"N	104°47'34.1691"W	1.91	LAST BHGE MWD SURVEY (2485'FSL & 39'FWL, SEC.28)
18279.00‡	90.030	272.780	7275.11	9247.06	1038.59	-9188.56	40°32'42.9541"N	104°47'34.4926"W	0.00	PROJECTION TO BIT (2487'FSL & 14'FWL, SEC.28)

HOLE & CASING SECTIONS - Ref Wellbore: G & D HANKS M-27-28HN AWB Ref Wellpath: G & D HANKS M-27-28HN AWP									
String/Diameter	Start MD [ft]	End MD [ft]	Interval [ft]	Start TVD [ft]	End TVD [ft]	Start N/S [ft]	Start E/W [ft]	End N/S [ft]	End E/W [ft]
9.625in Casing Surface	25.00	1550.00	1525.00	25.00	1524.41	0.00	0.00	122.56	174.55



[illegible]





# Actual Wellpath Report

G & D HANKS M-27-28HN AWP

Page 8 of 9



REFERENCE WELLPATH IDENTIFICATION			
Operator	BAYSWATER E&P, LLC	Well	G & D HANKS M-27-28HN
Field	WELD COUNTY (NAD83/TRUE NORTH)	API	05-123-46027
Facility	SEC.27-T07N-R66W	Wellbore	G & D HANKS M-27-28HN AWB
Slot	SLOT#01 G & D HANKS M-27-28HN (1348'FSL & 1573'FEL,SEC.27)		

WELLPATH COMPOSITION - Ref Wellbore: G & D HANKS M-27-28HN AWB      Ref Wellpath: G & D HANKS M-27-28HN AWP					
Start MD [ft]	End MD [ft]	Positional Uncertainty Model	Log Name/Comment	Wellbore	Survey Date
25.00	1508.00	BHI NaviTrak (Rotating+Axial Corr)	BHI NAVITRAK (ROTATING+AXIAL CORR) <233-1508>	G & D HANKS M-27-28HN AWB	
1508.00	18279.00	BH AutoTrak Curve (Short)	BHI AUTOTRAK CURVE (SHORT) <1594-18254>	G & D HANKS M-27-28HN AWB	



**Actual Wellpath Report**  
**G & D HANKS M-27-28HN AWP**  
Page 9 of 9



REFERENCE WELLPATH IDENTIFICATION			
Operator	BAYSWATER E&P, LLC	Well	G & D HANKS M-27-28HN
Field	WELD COUNTY (NAD83/TRUE NORTH)	API	05-123-46027
Facility	SEC.27-T07N-R66W	Wellbore	G & D HANKS M-27-28HN AWB
Slot	SLOT#01 G & D HANKS M-27-28HN (1348'FSL & 1573'FEL,SEC.27)		

WELLPATH COMMENTS				
MD [ft]	Inclination [°]	Azimuth [°]	TVD [ft]	Comment
18254.00	90.030	272.780	7275.13	LAST BHGE MWD SURVEY (2485'FSL & 39'FWL, SEC.28)
18279.00	90.030	272.780	7275.11	PROJECTION TO BIT (2487'FSL & 14'FWL, SEC.28)