



FORM F-106



00572882

RECEIVED

NOV 24 1971

OIL & GAS CONS. COMM.

R. 45W

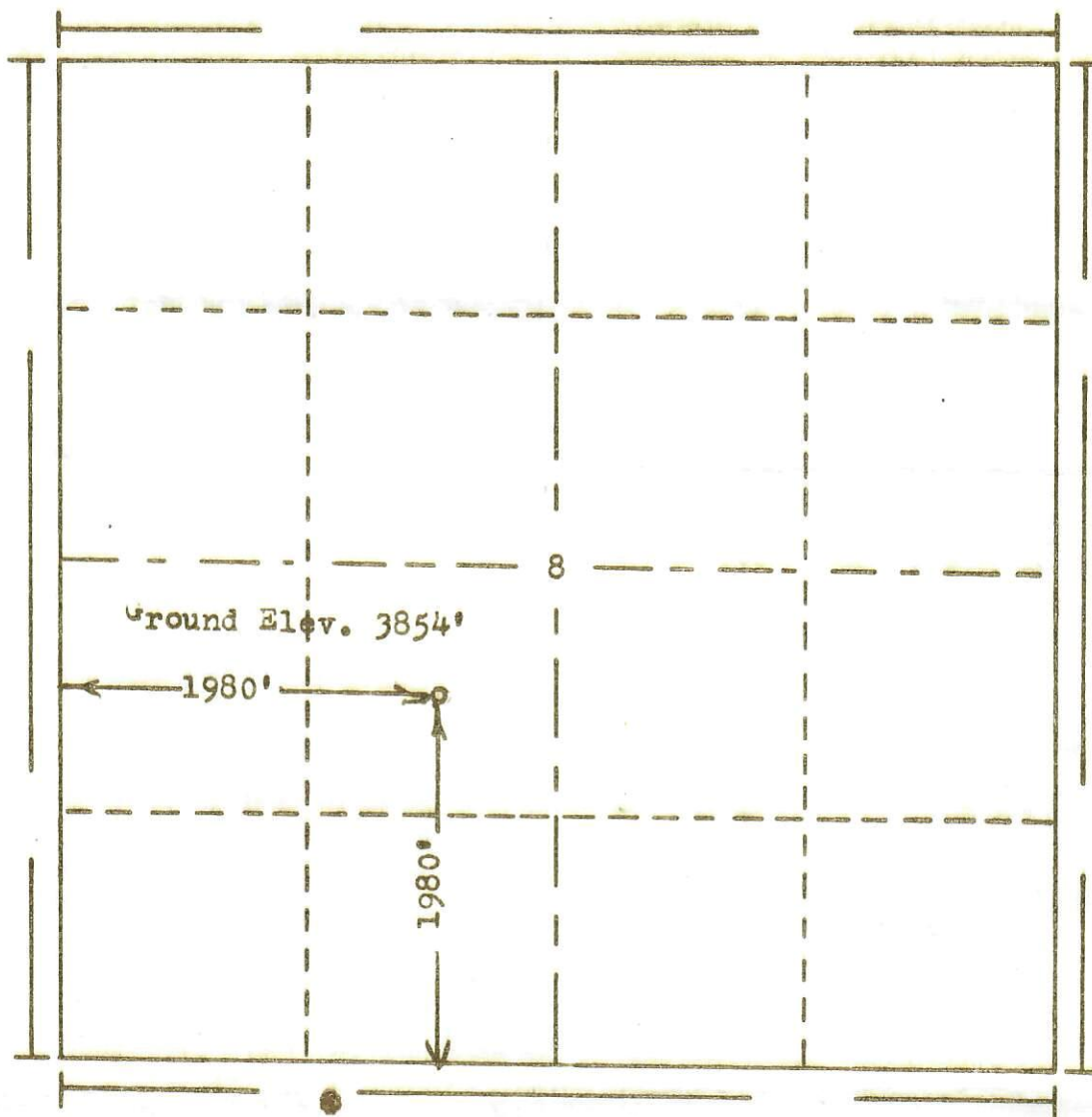

Scale... 1" = 1000'

Powers Elevation Company, Inc. of Denver, Colorado
has in accordance with a request from Mr. Foster
for Inexco Oil Co.

determined the location of No. 2 KCGA
to be CNE SW Section 8 Township 19S
Range 45W of the 6th Principal Meridian
Kiowa County, Colorado.

I hereby certify that this plat is an
accurate representation of a correct
survey showing the location of

Date: 11-2-71

B. G. Hollman
Licensed Land Surveyor No. 2853
State of Colorado