

Date of Survey: 01/10/22

EXISTING WELL DATA:

LOCATION	LATITUDE	LONGITUDE
23C-17-07-95	1592620.7	2287288.4
33D-17-07-95	1592620.8	2287301.0
24A-17-07-95	1592620.7	2287313.3
34A-17-07-95	1592620.4	2287325.8
24C-17-07-95	1592620.2	2287338.2
34C-17-07-95	1592620.4	2287350.8
24WI-17-07-95	1592623.1	2287364.4
32D-17-07-95	1592643.0	2287351.0
32C-17-07-95	1592643.0	2287338.5
32B-17-07-95	1592643.2	2287326.0
33A-17-07-95	1592643.2	2287313.7
23A-17-07-95	1592643.3	2287301.1
33B-17-07-95	1592643.2	2287288.7
33C-17-07-95	1592643.7	2287276.2

*All Well Names preceeded with "Watson Ranch B"

Interim Reclaim Areas

Working Pad Surface Area: ± 2.82 ac.

Oil & Gas Location Area: ± 6.69 ac.

Total Disturbance Area: ± 9.51 ac.

LEGEND

- Existing Well
- Gas Gathering Line
- Well Head Flow Line
- Produced Water Line
- Dump Line
- Vent Line
- Fence Line
- Existing Drainage
- Limit of Oil & Gas Location
- Working Pad Surface
- Oil & Gas Location Area
- Working Pad Surface Area

136 East Third Street
Rifle, Colorado 81650
Ph. (970) 625-1330
Fax (970) 625-2773

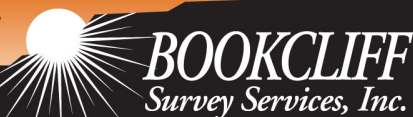

SCALE: 1" = 80'
DATE: 01/11/22
PROJECT: TEP Valley
DFT: cs

Construction Plan Prepared for:



Watson Ranch 'B' Drill Pad

INTERIM RECLAIM AS-CONSTRUCTED EXHIBIT