

# Well Location Plat

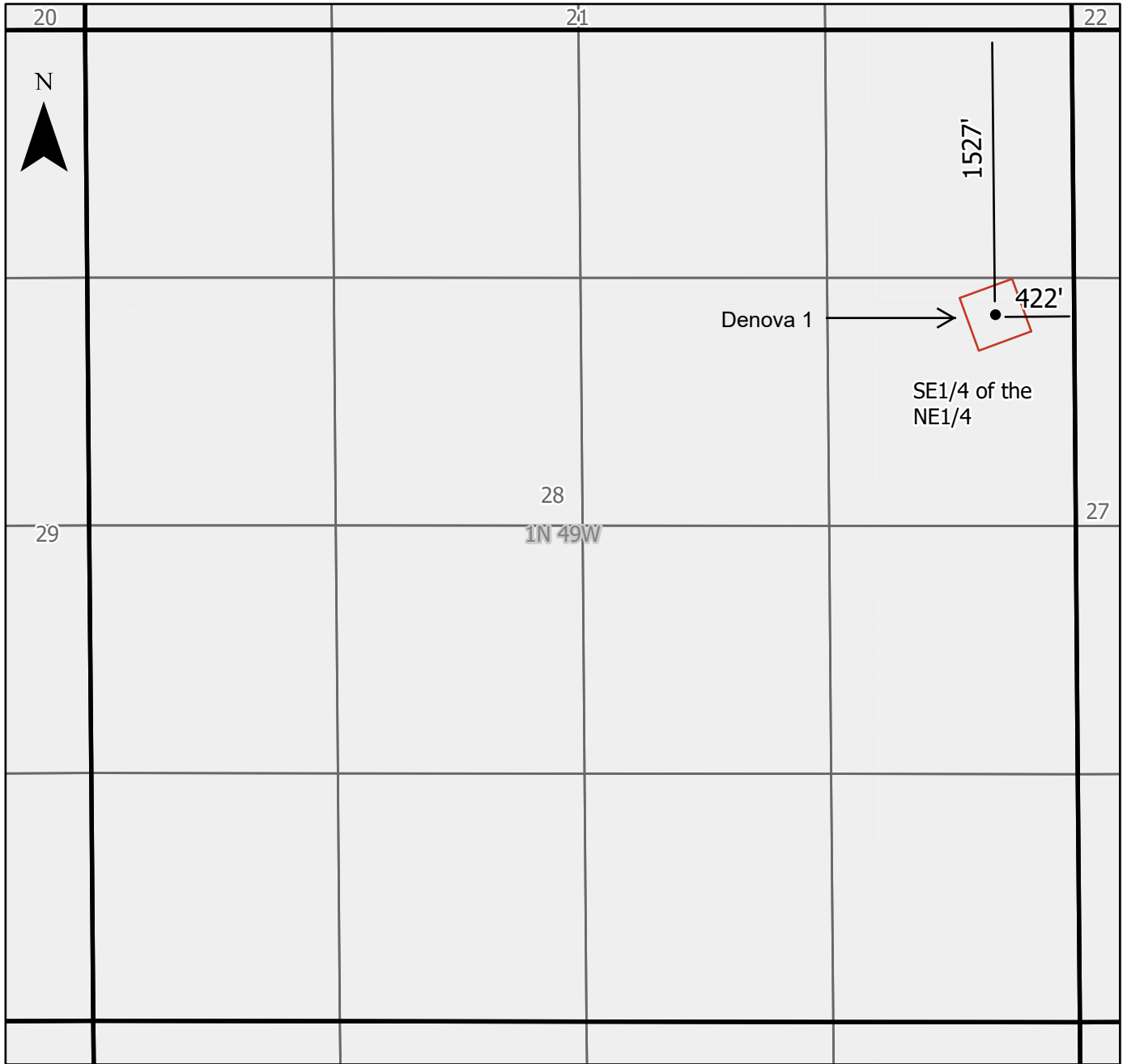

0 500 1,000  
 US Feet

February 7th, 2023

Denova 1  
 Denova Sequestration LLC  
 Lat = 40.027439 NAD 83  
 Long = -102.851636 NAD 83  
 Elev = 4312' GL  
 S28-T01N-R49W-6 PM  
 Washington County, CO

- Strat Well
- Well Pad
- ▭ Sections
- ▭ Quarter Quarter Sections

\*Coordinates, bearings, and elevation based on survey taken 01/06/2022 by Brett Birch of PLS Corporation.