

Legend

- Underground Flowline Location
(Collected via Trimble GPS)
- Excavation Extent
(Collected via Trimble GPS)
- Laboratory Sample Location
(Collected via Trimble GPS)
- Field Screening Sample Location
(Collected via Trimble GPS)

Notes

All locations are approximate unless otherwise noted.

GPS – Global Positioning System

0 ft. 20 ft. 40 ft.

Image Source: Google Earth; June 2021
Projection: WGS 84 UTM Zone 13 North



Legend

Excavation Extent
(Collected via Trimble GPS)

Laboratory Sample Location
(Collected via Trimble GPS)

Notes

All locations are approximate unless otherwise noted.

GPS – Global Positioning System

0 ft.

10 ft.

20 ft.

Image Source: Google Earth; June 2021
Projection: WGS 84 UTM Zone 13 North

DATE: May 11, 2022
DESIGNED BY: C. Hamlin
DRAWN BY: S. Anderson



TASMAN
Tasman, Inc.
6855 W. 119th Ave.
Broomfield, CO 80020

PDC Energy, Inc. – DJ Basin
Former Werning 3,4-2 Tank Battery
NENW, Section 2, Township 4 North, Range 66 West
Weld County, Colorado

INITIAL
EXCIVATION SITE MAP

FIGURE
2

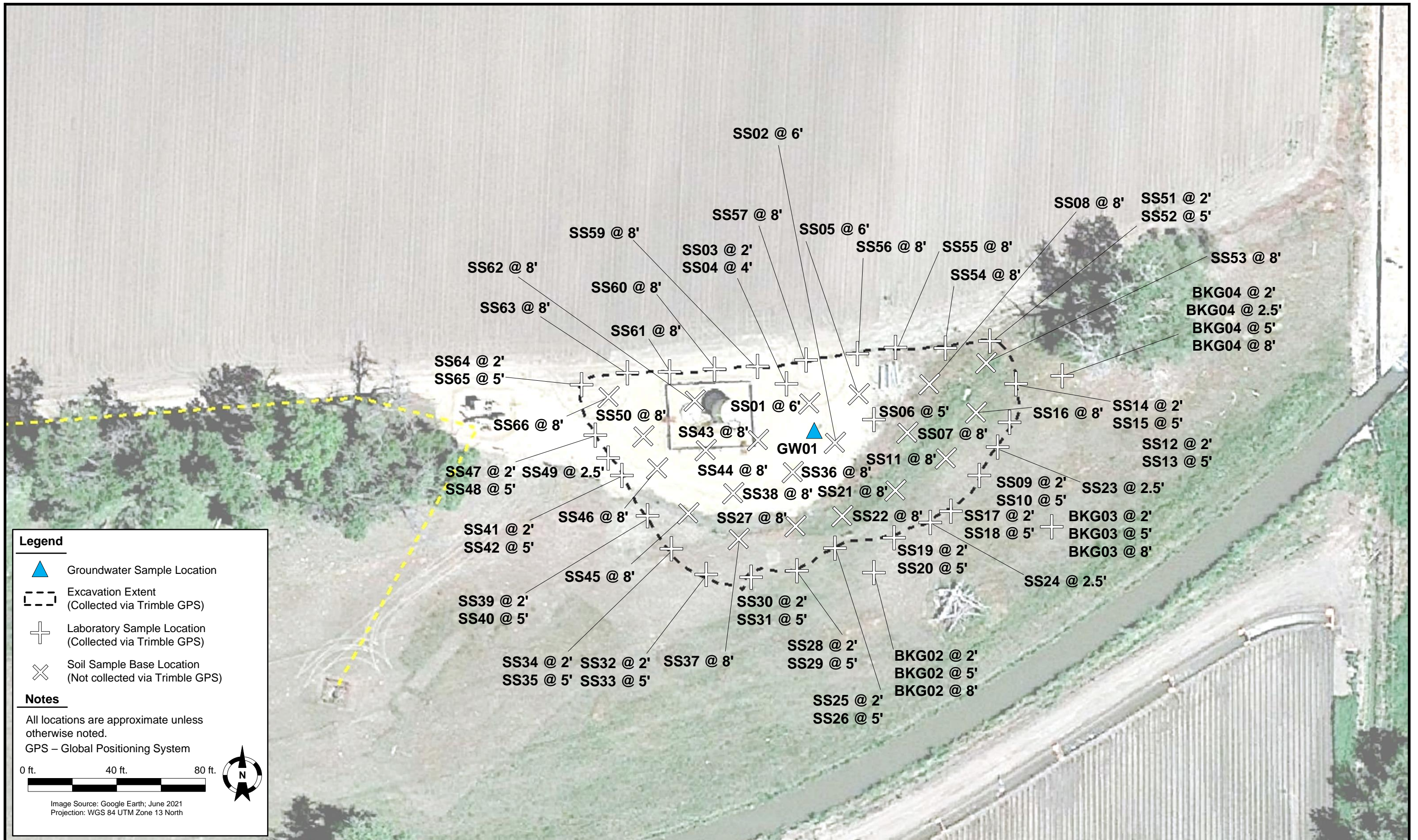

DATE:	May 11, 2022
DESIGNED BY:	C. Hamlin
DRAWN BY:	S. Anderson

TASMAN Tasman, Inc.
6855 W. 119th Ave.
Broomfield, CO 80020

PDC Energy, Inc. – DJ Basin
Former Werning 3,4-2 Tank Battery
NENW, Section 2, Township 4 North, Range 66 West
Weld County, Colorado

EXCAVATION SITE MAP

FIGURE
3