

POINT	NAD 83		NAD 27	
SURFACE HOLE LOCATION	N:	1279507.58	N:	279510.34
	E:	3258821.14	E:	2258972.43
	LAT:	N40.0969335	LAT:	N40.0969508
	LONG:	W104.5748138	LONG:	W104.5742971
LANDING POINT LOCATION	N:	1281930.27	N:	281933.02
	E:	3259861.21	E:	2260012.46
	LAT:	N40.1035540	LAT:	N40.1035714
	LONG:	W104.5710055	LONG:	W104.5704890
BOTTOM OF PRODUCTION ZONE	N:	1286264.21	N:	286266.92
	E:	3259780.93	E:	2259932.15
	LAT:	N40.1154530	LAT:	N40.1154704
	LONG:	W104.5711301	LONG:	W104.5706137
BOTTOM HOLE LOCATION	N:	1286354.19	N:	286356.90
	E:	3259779.27	E:	2259930.48
	LAT:	N40.1157000	LAT:	N40.1157175
	LONG:	W104.5711327	LONG:	W104.5706163

LEGEND

RANGE/TOWNSHIP LINE

SECTION LINE

QUARTER SECTION LINE

SIXTEENTH SECTION LINE

POINT OF INTERSECTION

MONUMENT FOUND

CALCULATED CORNER

TOPOGRAPHIC

LOYALTY INNOVATION LEGACY

520 Stacy Court Ste B, Lafayette, CO 80026

303.666.0379 www.topographic.com

SURVEYOR'S STATEMENT
THE UNDERSIGNED HEREBY STATES THAT THE WELL LOCATION SHOWN HEREON WAS STAKED ON THE GROUND BASED ON EXISTING MONUMENTATION AND/OR PHYSICAL EVIDENCE FOUND IN THE FIELD AND IS CORRECT TO THE BEST OF MY KNOWLEDGE, INFORMATION AND BELIEF.

- NOTES**
- HORIZONTAL (NAD 83) AND VERTICAL (NAVD 88) DATUM IS BASED ON THE TRIMBLE VRS NETWORK. THE LINEAL UNITS OF MEASUREMENT ARE U.S. SURVEY FEET.
 - ALL DIRECTIONS, DISTANCES, AND DIMENSIONS SHOWN HEREON ARE BASED ON COORDINATES FROM THE "COLORADO COORDINATE SYSTEM OF 1983 NORTH ZONE" (TITLE 38, ARTICLE 52 C.R.S.).
 - ALL SECTION LINE DIMENSIONS SHOWN HEREON ARE BASED ON FIELD MEASUREMENTS OF EXISTING MONUMENTS AND/OR PHYSICAL EVIDENCE FOUND IN THE FIELD UNLESS OTHERWISE INDICATED.
 - PHYSICAL FEATURES SHOWN HEREON ARE FOR GRAPHICAL REPRESENTATION ONLY.
 - SEE FORM 2A FOR VISIBLE IMPROVEMENTS WITHIN 500' OF WELLHEAD.
 - DISTANCES TO NEAREST SECTION LINES ARE MEASURED PERPENDICULARLY.
 - THIS IS NOT A LAND SURVEY NOR LAND SURVEY PLAT.
- PDOP READING: 1.4 INSTRUMENT OPERATOR: KEVIN ROYER

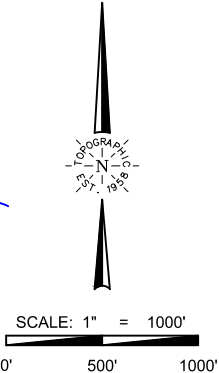
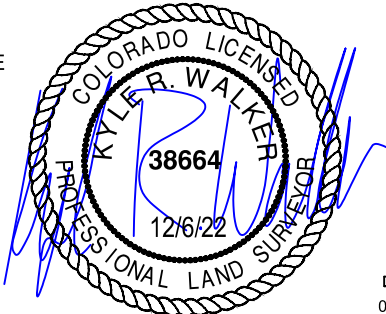

VERDAD RESOURCES			
KIWI 2929 07H			
FIELD	09/14/2021	DRAFT	SW
REV 1	12/06/2022	CHECK	ZAK
SHEET : 1 OF 1		JOB: 138557	

WELL LOCATION MAP
S.H.L. SW/4 NE/4, SECTION 32 T02N R64W 6TH PM
LP SW/4 SE/4, SECTION 29 T02N R64W 6TH PM
BPZ NW/4 NE/4, SECTION 29 T02N R64W 6TH PM
BHL NW/4 NE/4, SECTION 29 T02N R64W 6TH PM
WELD COUNTY, COLORADO