

POINT	NAD 83		NAD 27	
SURFACE HOLE LOCATION	N:	1279507.6	N:	279510.36
	E:	3258805.14	E:	2258956.43
	LAT:	N40.0969340	LAT:	N40.0969514
	LONG:	W104.5748710	LONG:	W104.5743543
LANDING POINT LOCATION	N:	1281926.54	N:	281929.28
	E:	3259323.66	E:	2259474.92
	LAT:	N40.1035592	LAT:	N40.1035766
	LONG:	W104.5729272	LONG:	W104.5724106
BOTTOM OF PRODUCTION ZONE	N:	1286257.51	N:	286260.21
	E:	3259238.69	E:	2259389.92
	LAT:	N40.1154501	LAT:	N40.1154676
	LONG:	W104.5730691	LONG:	W104.5725525
BOTTOM HOLE LOCATION	N:	1286347.49	N:	286350.20
	E:	3259236.93	E:	2259388.15
	LAT:	N40.1156972	LAT:	N40.1157147
	LONG:	W104.5730720	LONG:	W104.5725555

LEGEND

RANGE/TOWNSHIP LINE

SECTION LINE

QUARTER SECTION LINE

SIXTEENTH SECTION LINE

POINT OF INTERSECTION

MONUMENT FOUND

CALCULATED CORNER

TOPOGRAPHIC

LOYALTY INNOVATION LEGACY

520 Stacy Court Ste B, Lafayette, CO 80026

303.666.0379 www.topographic.com

**SURVEYOR'S STATEMENT**  
THE UNDERSIGNED HEREBY STATES THAT THE WELL LOCATION SHOWN HEREON WAS STAKED ON THE GROUND BASED ON EXISTING MONUMENTATION AND/OR PHYSICAL EVIDENCE FOUND IN THE FIELD AND IS CORRECT TO THE BEST OF MY KNOWLEDGE, INFORMATION AND BELIEF.

- NOTES**
- HORIZONTAL (NAD 83) AND VERTICAL (NAVD 88) DATUM IS BASED ON THE TRIMBLE VRS NETWORK. THE LINEAL UNITS OF MEASUREMENT ARE U.S. SURVEY FEET.
  - ALL DIRECTIONS, DISTANCES, AND DIMENSIONS SHOWN HEREON ARE BASED ON COORDINATES FROM THE "COLORADO COORDINATE SYSTEM OF 1983 NORTH ZONE" (TITLE 38, ARTICLE 52 C.R.S.).
  - ALL SECTION LINE DIMENSIONS SHOWN HEREON ARE BASED ON FIELD MEASUREMENTS OF EXISTING MONUMENTS AND/OR PHYSICAL EVIDENCE FOUND IN THE FIELD UNLESS OTHERWISE INDICATED.
  - PHYSICAL FEATURES SHOWN HEREON ARE FOR GRAPHICAL REPRESENTATION ONLY.
  - SEE FORM 2A FOR VISIBLE IMPROVEMENTS WITHIN 500' OF WELLHEAD.
  - DISTANCES TO NEAREST SECTION LINES ARE MEASURED PERPENDICULARLY.
  - THIS IS NOT A LAND SURVEY NOR LAND SURVEY PLAT.
- PDOP READING: 1.4 INSTRUMENT OPERATOR: KEVIN ROYER

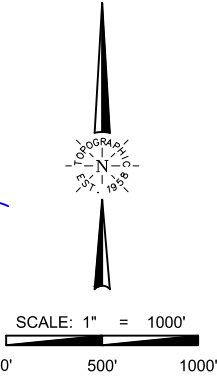
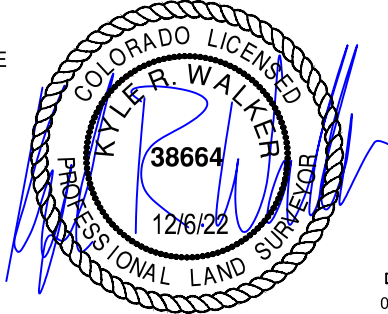

VERDAD RESOURCES			
KIWI 2929 06H			
FIELD	09/14/2021	DRAFT	SW
REV 1	12/06/2022	CHECK	ZAK
SHEET : 1 OF 1		JOB: 138557	

**WELL LOCATION MAP**  
S.H.L. SW/4 NE/4, SECTION 32 T02N R64W 6TH PM  
LP SW/4 SE/4, SECTION 29 T02N R64W 6TH PM  
BPZ NW/4 NE/4, SECTION 29 T02N R64W 6TH PM  
BHL NW/4 NE/4, SECTION 29 T02N R64W 6TH PM  
WELD COUNTY, COLORADO