

Wellhead Closure Checklist

COGCC Rule 911.a.(4) Environmental Site Closure Assessment Field Form

Additional attachments (optional):		Pit Closure		Tank Battery Closure		Flowline Closure		Partially Buried Vault Closure
Site Name & COGCC Facility Number: <i>Cattaraugus State DD #8-11</i>		Date: <i>7-19-22</i>						Remediation Project #: <i>23722</i>
Associated Wells: <i>1</i> <i>05-123-22910</i>		Age of Site: <i>years</i>						Number of Photos Attached: <i>1</i>
Location: (GPS coordinates of wellhead or southeastern most wellhead for multiple)							Estimated Facility Size (acres):	
<i>40.238351 / -104.463754</i>								
General Condition of Site: (General observations regarding housekeeping, corrosion, waste management, etc.)								
<i>Overall good condition</i>								
USCS Soil Type: <i>SM</i>				Estimated Depth to Groundwater: <i>7-20'</i>				
Hydrocarbon Impacted Soils / Spills: (Note estimated size and if impact appears to be surficial or extends to an unknown depth)								
<i>None observed</i>								
Salt Crusted Soils or Impacted Vegetation: (Note estimated size and if impact appears to be surficial or extends to an unknown depth)								
<i>None observed</i>								
Wellhead(s)								
Well API	<i>05-123-22910</i>							
Age	<i>years</i>							
Condition of surface around wellhead	<i>Good - per crew</i>							
PID Readings	<i>N/A - Excavated upon arrival</i>							
Condition of subsurface (leakage present)	<i>Good - no staining, no odor</i>							
PID Readings	<i>4.2</i>	<i>4.0</i>	<i>4.1</i>	<i>4.2</i>	<i>4.3</i>			
Sample taken? Location/Sample ID#	<i>WH-SS-01</i>	<i>WH-SS-02</i>	<i>WH-SS-03</i>	<i>WH-SS-04</i>	<i>WH-FS-01</i>			
Photo Number(s)	<i>See photo log</i>							
Other observations regarding wellheads:								
<i>Well casing cut/capped after assessment</i>								
Summary								
Was impacted soil identified?								
<input checked="" type="radio"/> No			Yes - less than 10 cubic yards			Yes - more than 10 cubic yards		
Total number of samples field screened: <i>5</i>				Total number of samples collected: <i>5</i>				
Highest PID Reading: <i>4.3</i>				Total number of samples submitted to lab for analysis: <i>1</i>				
If more than 10 cubic yards of impacted soil were observed:								
Vertical extent:				Estimated spill volume:				
Lateral extent:				Volume of soil removed:				
<i>N/A</i>								
Is additional investigation required?								
<i>N/A</i>								
Was groundwater encountered during the investigation?								
<input checked="" type="radio"/> No			Yes - not impacted or in contact with impacted soils			Yes - groundwater impacted and/or in contact with impacted soils		
Measured depth to groundwater:				Was remedial groundwater removal conducted? Yes No				
Date Groundwater was encountered:				Commencement date of removal:				
Sheen on groundwater? Yes No				Volume of groundwater removed prior to sampling:				
Free product observed? Yes No				Volume of groundwater removed post sampling:				
Total number of samples collected:				Total Volume of groundwater removed:				
Total number of samples submitted to lab for analysis:								



FIGURES

Figure 1: Topographic Site Location Map

Figure 2: Aerial Site Location Map

Figure 3: Soil Analytical Map

Figure 4: Polycyclic Aromatic Hydrocarbons Map

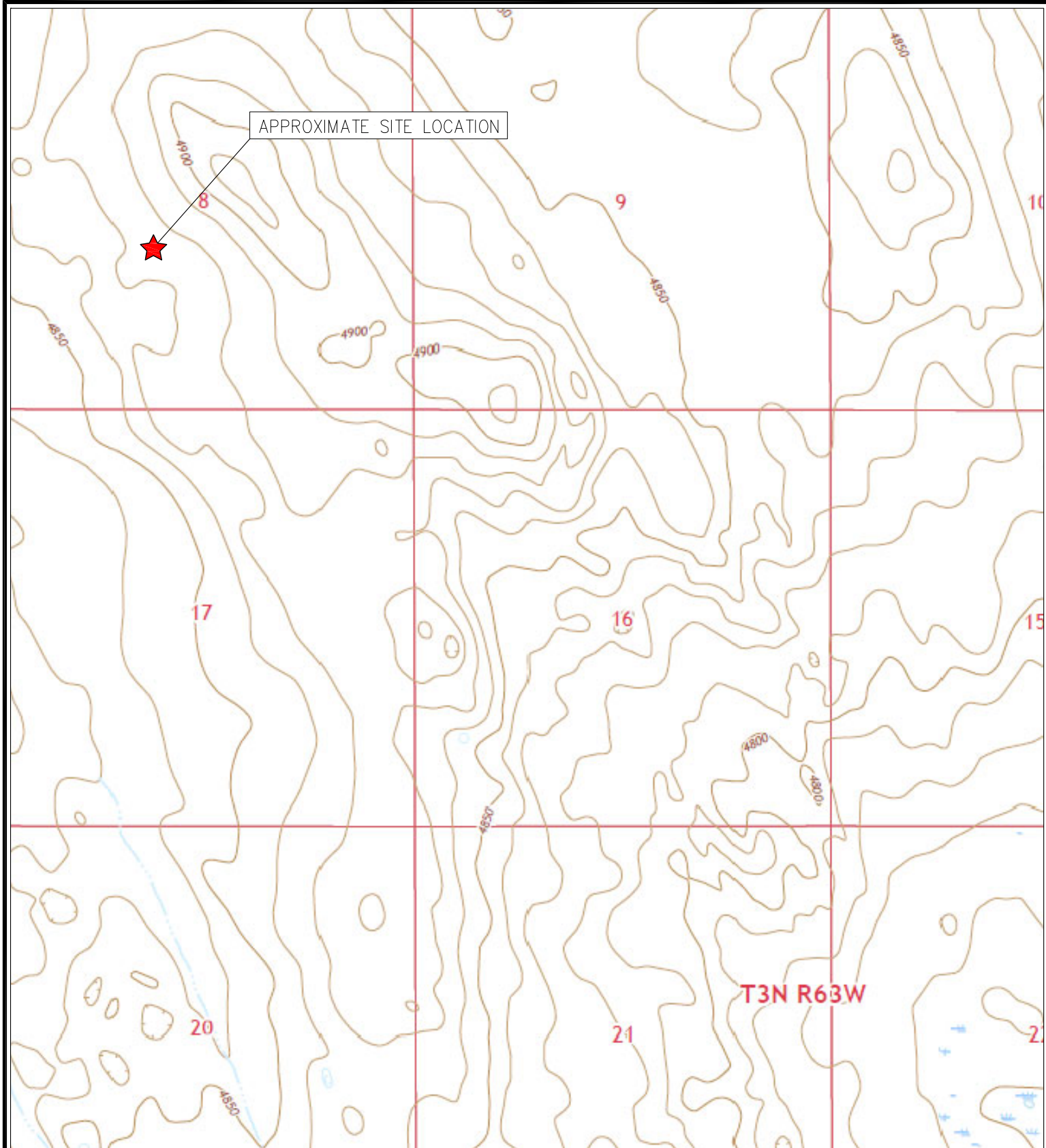

TOPOGRAPHIC SITE LOCATION MAP
 GUTTERSEN STATE DD #8-11
 CLOSURE ASSESSMENT
 40.238351 / -104.463754
 NE¼ SW¼ SEC.8 T3N R63W 6PM
 WELD COUNTY, COLORADO
 API # 05-123-22910
 REMEDIATION # 23722



EAGLE
 ENVIRONMENTAL
 CONSULTING, INC.

8000 W 44th Ave, Wheat Ridge, CO 80033
 Ph: 303-433-0479 • F: 303-325-5449

SOURCE: USGS 7.5 MINUTE TOPOGRAPHIC MAP,
 TAMPA, CO QUADRANGLE 2022

FIGURE 1



LEGEND

- FORMER GUTTERSEN STATE DD #8-11 WELLHEAD (PLUGGED AND ABANDONED)
- ASSOCIATED SEPARATOR
- APPROXIMATE FLOWLINE LOCATION

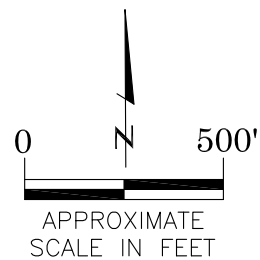

AERIAL SITE LOCATION MAP
GUTTERSEN STATE DD #8-11
CLOSURE ASSESSMENT
40.238351 / -104.463754
NE¼ SW¼ SEC.8 T3N R63W 6PM
WELD COUNTY, COLORADO
API # 05-123-22910
REMEDATION # 23722

DATE:

12/20/22

FIG. NO.

2

DRAWN BY:

GK



EAGLE
ENVIRONMENTAL
CONSULTING, INC.

8000 W 44th Ave, Wheat Ridge, CO 80033
Ph: 303-433-0479 • F: 303-325-5449



WH-FS-01@6'
07/19/22
6'
B = <0.00200
T = <0.00200
E = <0.00200
X = <0.00200
G = <0.200
D = <25.0
R = <100
1,2,4-TMB = <0.00200
1,3,5-TMB = <0.00200
Brn= <0.0990
EC = 0.442
SAR= 0.332
pH = 7.38

LEGEND

- INITIAL ASSESSMENT BOUNDARIES
- SS-02 APPROXIMATE LOCATION OF SOIL SAMPLES FIELD SCREENED, ONLY, WITH PHOTOIONIZATION DETECTOR
- SS-02 APPROXIMATE LOCATION OF SOIL SAMPLES SUBMITTED FOR LABORATORY ANALYSIS

PARAMETERS

SAMPLE LOCATION
DATE
DEPTH (FEET)
B = BENZENE (mg/kg)
T = TOLUENE (mg/kg)
E = ETHYLBENZENE (mg/kg)
X = TOTAL XYLENES (mg/kg)
G = TPH-GRO (mg/kg)
D = TPH-DRO (mg/kg)
R = TPH-RRO (mg/kg)
1,2,4-TMB = 1,2,4 TRIMETHYLBENZENE (mg/kg)
1,3,5-TMB = 1,3,5 TRIMETHYLBENZENE (mg/kg)
Brn= BORON (mg/L)
EC = SPECIFIC CONDUCTANCE (mmhos/cm)
SAR= SODIUM ADSORPTION RATIO
pH = pH (pH UNITS)

mg/kg = MILLIGRAMS PER KILOGRAM
mg/L = MILLIGRAMS PER LITER
mmhos/cm = MILLIHOS PER CENTIMETER

TPH-GRO = TOTAL PETROLEUM HYDROCARBONS - GASOLINE RANGE ORGANICS
TPH-DRO = TOTAL PETROLEUM HYDROCARBONS - DIESEL RANGE ORGANICS
TPH-RRO = TOTAL PETROLEUM HYDROCARBONS - RESIDUAL RANGE ORGANICS

NOTES:
VALUES PRESENTED WITH A LESS THAN SYMBOL (<) DID NOT CONTAIN CONCENTRATIONS AT OR ABOVE LABORATORY DETECTION LIMITS.

VALUES PRESENTED IN **BOLD** EXCEED COGCC TABLE 915-1 REGULATORY LIMITS.

COGCC = COLORADO OIL AND GAS CONSERVATION COMMISSION

SOIL ANALYTICAL MAP
GUTTERSEN STATE DD #8-11
CLOSURE ASSESSMENT
40.238351 / -104.463754
NE¼ SW¼ SEC.8 T3N R63W 6PM
WELD COUNTY, COLORADO
API # 05-123-22910
REMEDIATION # 23722

DATE:
12/20/22
DRAWN BY:
GK
FIG.
NO. 3



EAGLE
ENVIRONMENTAL
CONSULTING, INC.
8000 W 44th Ave, Wheat Ridge, CO 80033
Ph: 303-433-0479 • F: 303-325-5449

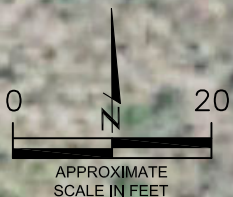



WH-FS-01@6'
07/19/22
6'
ND = <0.00335
1-Methylnaphthalene = ND
2-Methylnaphthalene = ND
Acenaphthene = ND
Anthracene = ND
Benzo(a)anthracene = ND
Benzo(a)pyrene = ND
Benzo(b)fluoranthene = ND
Benzo(k)fluoranthene = ND
Chrysene = ND
Dibenzo(a,h)anthracene = ND
Fluoranthene = ND
Fluorene = ND
Indeno(1,2,3-CD)pyrene = ND
Naphthalene = ND
Pyrene = ND

LEGEND

- INITIAL ASSESSMENT BOUNDARIES
- SS-02 APPROXIMATE LOCATION OF SOIL SAMPLES FIELD SCREENED, ONLY, WITH PHOTOIONIZATION DETECTOR
- SS-02 APPROXIMATE LOCATION OF SOIL SAMPLES SUBMITTED FOR LABORATORY ANALYSIS

PARAMETERS

SAMPLE LOCATION
DATE SAMPLE COLLECTED
APPROXIMATE DEPTH

POLYCYCLIC AROMATIC HYDROCARBONS (PAHs) (mg/kg)

mg/kg = MILLIGRAMS PER KILOGRAM
ND = NON-DETECT

NOTES:
VALUES PRESENTED WITH A LESS THAN SYMBOL (<) DID NOT CONTAIN CONCENTRATIONS AT OR ABOVE LABORATORY DETECTION LIMITS.

VALUES PRESENTED IN **BOLD** EXCEED COGCC TABLE 915-1 REGULATORY LIMITS.

COGCC = COLORADO OIL AND GAS CONSERVATION COMMISSION

POLYCYCLIC AROMATIC HYDROCARBONS MAP
GUTTERSEN STATE DD #8-11
CLOSURE ASSESSMENT
40.238351 / -104.463754
NE¼ SW¼ SEC.8 T3N R63W 6PM
WELD COUNTY, COLORADO
API # 05-123-22910
REMEDIAL # 23722

DATE:
12/20/22
DRAWN BY:
GK
FIG.
NO. 4



EAGLE
ENVIRONMENTAL
CONSULTING, INC.
8000 W 44th Ave, Wheat Ridge, CO 80033
Ph: 303-433-0479 • F: 303-325-5449

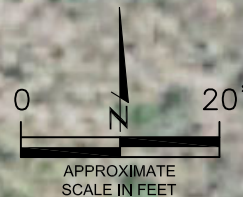



TABLES

Table 1: Photoionization Detector Reading Summary

Table 2: Soil Analytical Results Summary

Table 3: Polycyclic Aromatic Hydrocarbons Analytical Results Summary

TABLE 1
PHOTOIONIZATION DETECTOR READING SUMMARY
GUTTERSEN STATE DD #8-11
CLOSURE ASSESSMENT
40.238351 / -104.463754
NE1/4 SW1/4 SEC.8 T3N R63W 6PM
WELD COUNTY, COLORADO
API # 05-123-22910
REMEDATION # 23722

Sample Location (Latitude/Longitude)	Date	Approximate Depth (feet)	PID Reading (ppm-v)	Lab Submission (Y/N)
WH-SS-01 @ 5' (40.238361 / -104.463766)	07/19/22	5	4.2	N
WH-SS-02 @ 5' (40.238354 / -104.463744)	07/19/22	5	4.0	N
WH-SS-03 @ 5' (40.238335 / -104.463747)	07/19/22	5	4.1	N
WH-SS-04 @ 5' (40.238338 / -104.463774)	07/19/22	5	4.2	N
WH-FS-01 @ 6' (40.238352 / -104.463754)	07/19/22	6	4.3	Y
(Y/N) = Yes or No ppm-v = parts per million by volume PID = Photoionization Detector				

TABLE 2
SOIL ANALYTICAL RESULTS SUMMARY
GUTTERSEN STATE DD #8-11
CLOSURE ASSESSMENT
40.238351 / -104.463754
NE1/4 SW1/4 SEC.8 T3N R63W 6PM
WELD COUNTY, COLORADO
API # 05-123-22910
REMEDIAION # 23722

Sample Location (Latitude/Longitude)	Date	Approximate Depth (feet)	PID Reading (ppm-v)	Benzene (mg/kg)	Toluene (mg/kg)	Ethylbenzene (mg/kg)	Total Xylenes (mg/kg)	TPH-GRO (mg/kg)	TPH-DRO (mg/kg)	TPH-RRO (mg/kg)	1,2,4-TMB (mg/kg)	1,3,5-TMB (mg/kg)	Boron (mg/L)	Specific Conductance (mmhos/cm)	pH (pH units)	SAR
COGCC Table 915-1 Residential Screening Levels (mg/kg)				1.20	490	5.8	58	500			30	27	2	<4	6-8.3	<6
COGCC Table 915-1 Protection of Groundwater Soil Screening Levels				0.0026	0.69	0.78	9.9	--			0.0081	0.0087	--	--	--	--
WH-FS-01 @ 6" (40.238352 / -104.463754)	07/19/22	6	4.3	<0.00200	<0.00200	<0.00200	<0.00200	<0.200	<25.0	<100	<0.00200	<0.00200	<0.0990	0.442	7.38	0.332
COGCC = Colorado Oil and Gas Conservation Commission mg/kg = milligrams per kilogram mmhos/cm = millimhos per centimeter PID = Photoionization Detector ppm-v = parts per million by volume mg/L = milligrams per liter SAR = Sodium Adsorption Ratio Note: Values presented with a less than symbol (<) did not contain concentrations at or above the laboratory reporting limit. Note: Values presented in BOLD contained concentrations exceeding COGCC Table 915-1 Regulatory Limits.																

TABLE 3
POLYCYCLIC AROMATIC HYDROCARBONS ANALYTICAL RESULTS SUMMARY
GUTTERSEN STATE DD #8-11
CLOSURE ASSESSMENT
40.238351 / -104.463754
NE1/4 SW1/4 SEC.8 T3N R63W 6PM
WELD COUNTY, COLORADO
API # 05-123-22910
REMEDIATION # 23722

Sample Location (Latitude/Longitude)	Date	Approximate Depth (feet)	PID Reading (ppm- v)	1-Methyl- naphthalene (mg/kg)	2-Methyl-naphthalene (mg/kg)	Acenaphthene (mg/kg)	Anthracene (mg/kg)	Benzo(a)-anthracene (mg/kg)	Benzo(a)- pyrene (mg/kg)	Benzo(b)- fluoranthene (mg/kg)	Benzo(k)- fluoranthene (mg/kg)	Chrysene (mg/kg)	Dibenzo(a,h)- anthracene (mg/kg)	Fluoranthene (mg/kg)	Fluorene (mg/kg)	Indeno(1,2,3- cd)-pyrene (mg/kg)	Naphthalene (mg/kg)	Pyrene (mg/kg)
COGCC Table 915-1 Residential Screening Levels				18	24	360	1,800	1.1	0.11	1.1	11	110	0.11	240	240	1.1	2	180
COGCC Table 915-1 Protection of Groundwater Soil Screening Levels				0.006	0.019	0.55	5.8	0.011	0.24	0.3	2.9	9	0.096	8.9	0.54	0.98	0.0038	1.3
WH-FS-01 @ 6" (40.238352 / -104.463754)	07/19/22	6	4.3	<0.00335	<0.00335	<0.00335	<0.00335	<0.00335	<0.00335	<0.00335	<0.00335	<0.00335	<0.00335	<0.00335	<0.00335	<0.00335	<0.00335	<0.00335
COGCC = Colorado Oil and Gas Conservation Commission mg/kg = milligrams per kilogram Note: Values presented with a less than symbol (<) did not contain concentrations at or above the laboratory reporting limit. Note: Values presented in BOLD contained concentrations exceeding COGCC Table 915-1 Regulatory Limits				PID = Photoionization Detector ppm-v = parts per million by volume														



ATTACHMENT A

Photo Log

Guttersen State DD #8-11

API # 05-123-22910

Remediation # 23722

Closure Assessment

July 2022



EAGLE
ENVIRONMENTAL
CONSULTING, INC.
8000 W 44th Ave, Wheat Ridge, CO 80033
Ph: 303-433-0479 • F: 303-325-5449



Wellhead Excavation – 07/19/22

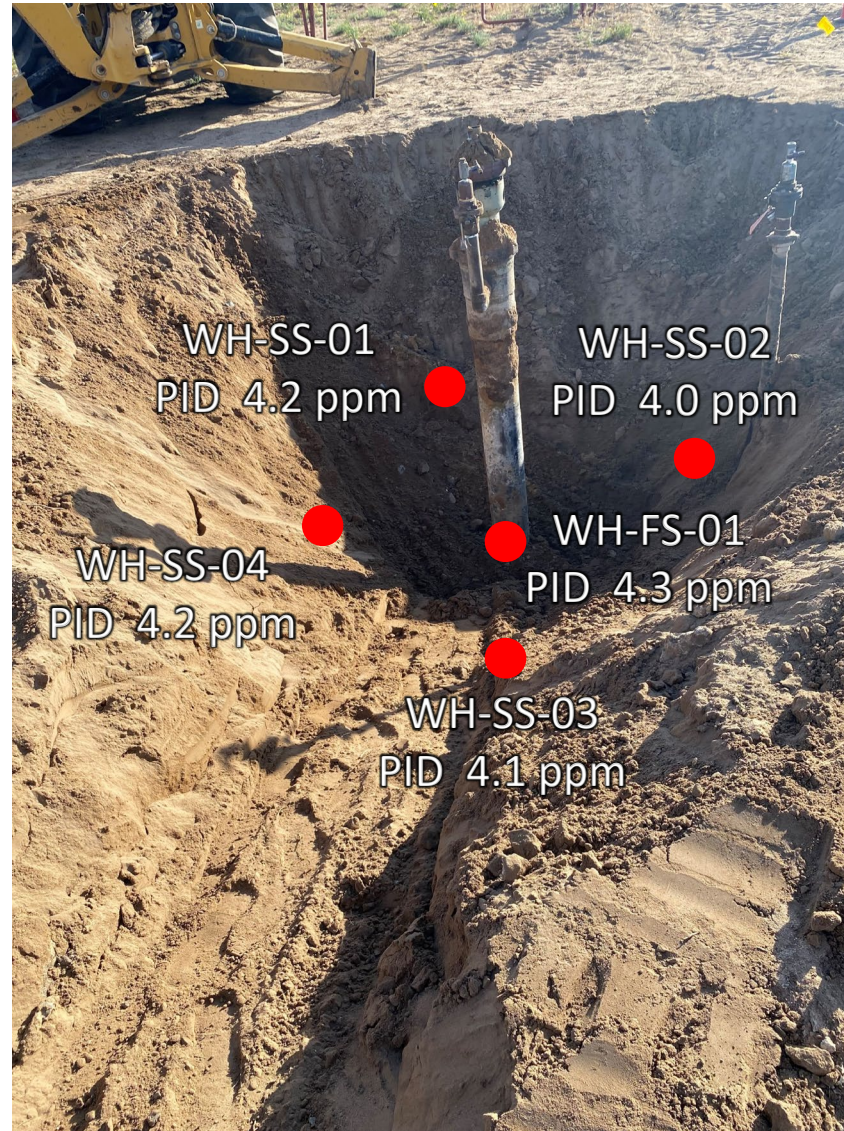

Looking northwest

No petroleum hydrocarbon staining or odor observed



ATTACHMENT B

Laboratory Analytical Report



August 05, 2022

Eagle Environmental Consulting, Inc.

Martin C Eckert III

8000 W 44th Ave

Wheat Ridge CO 80033

Project Name - Noble - Guttersen State DD #8-11 Project Number - [none]

Attached are your analytical results for Noble - Guttersen State DD #8-11 received by Origins Laboratory, Inc. July 19, 2022. This project is associated with Origins project number Y207380-01.

The analytical results in the following report were analyzed under the guidelines of EPA Methods. These methods are identified as follows; "SW" are defined in SW-846, "EPA" are defined in 40CFR part 136 and "SM" are defined in the most current revision of Standard Methods For the Examination of Water and Wastewater.

The analytical results apply specifically to the samples and analyses specified per the attached Chain of Custody. As such, this report shall not be reproduced except in full, without the written approval of Origin's laboratory.

Unless otherwise noted, the analytical results for all soil samples are reported on a wet weight basis. All analytical analyses were performed under NELAP guidelines unless noted by a data qualifier.

Any holding time exceedances, deviations from the method specifications or deviations from Origins Laboratory's Standard Operating Procedures are outlined in the case narrative.

Thank you for selecting Origins for your analytical needs. Please contact us with any questions concerning this report, or if we can help with anything at all.

Origins Laboratory, Inc.
303.433.1322
o-squad@oelabinc.com



1725 Elk Place, Denver, CO 80211 | Phone: 303.433.1322 | Fax: 303.265.9645

Eagle Environmental Consulting, Inc.

8000 W 44th Ave

Wheat Ridge CO 80033

Martin C Eckert III

Project Number: [none]

Project: Noble - Gutttersen State DD #8-11

CROSS REFERENCE REPORT

Sample ID	Laboratory ID	Matrix	Date Sampled	Date Received
WH-FS-01@6'	Y207380-01	Soil	July 19, 2022 7:38	07/19/2022 12:00

Origins Laboratory, Inc.



The results in this report apply to the samples analyzed in accordance with the chain of custody document. This analytical report must be reproduced in its entirety.

Martin C Eckert III
Project Number: [none]
Project: Noble - Guttersen State DD #8-11

ORIGINS

LABORATORY, INC

4207380

www.originslaboratory.com

page 1 of 1

Client: Engle Environmental Consulting

Address: 8000 W 44th Ave

West Kiowa, CO 80033

Telephone Number: 303-433-8479

Email Address: MOSES@engle-environment.com

Project Manager: Martin Eckert III

Project Name: Gettersen Site - SD #P-11

Project Number:

Samples Collected By: len

Sample ID Description	Date Sampled	Time Sampled	# of Containers	Preservative				Matrix			Analysis	Sample Instructions	
				Unpreserved	HCl	HNO ₃	Other	Groundwater	Soil	Air Summa Canister #			Other
W4-FS-01 @ 6"	7/19/22	0738	2	X					X			X	EC, SAR, pH - 1
												X	5 select pore pup2
												X	3
												X	4 MUG method
												X	5
												X	6
												X	7
												X	8
												X	9
												X	10

Relinquished By: Karl Date: 7/19/22 Time: 1200 Received By: DE Date: 7-19-2022 Time: 12:00

Relinquished By: Karl Date: 7/19/22 Time: 1200 Received By: DE Date: 7-19-2022 Time: 12:00

Turnaround Time: Same Day ☐ 24 Hr ☐ 48 Hr ☐ 72 Hr ☒ Standard

1725 Elk Place | Phone: 303.433.1322 | Fax: 303.265.9645 | Denver, CO 80211

Bill to Cole

Temp Received: 59°

Date Results Needed

A N0816

Origins Laboratory, Inc.

Byron

The results in this report apply to the samples analyzed in accordance with the chain of custody document. This analytical report must be reproduced in its entirety.

Eagle Environmental Consulting, Inc.

8000 W 44th Ave

Wheat Ridge CO 80033

Martin C Eckert III

Project Number: [none]

Project: Noble - Gutterson State DD #8-11

Origins Laboratory

Origins Work Order: 4207380

Checklist Completed by: TSM

Date/time completed: 7/19/22

Matrix(s) Received: (Check all that apply): ☒ Soil/Solid ☐ Water ☐ Other: _____

Cooler Number/Temperature: 1 / 59 °C 1 °C 1 °C (Describe) _____ °C

Thermometer ID: T004

F-012207-01-R1
Effective Date: 01/09/12

Client: Eagle Environmental
Client Project ID: Noble - Gutterson DD #8-11
Shipped Via: HD
(UPS, FedEx, Hand Delivered, Pick-up, etc.)
Airbill #: _____

Requirement Description	Yes	No	N/A	Comments (if any)
If samples require cooling, was the temperature between 0°C to ≤ 6°C ⁽¹⁾ ?	<input checked="" type="checkbox"/>			
Is there ice present (document if blue ice is used)	<input checked="" type="checkbox"/>			
Are custody seals present on cooler? (if so, document in comments if they are signed and dated, broken or intact)			<input checked="" type="checkbox"/>	
Are custody seals present on each sample container? (if so, document in comments if they are signed and dated, broken or intact)			<input checked="" type="checkbox"/>	
Were all samples received intact ⁽¹⁾ ?	<input checked="" type="checkbox"/>			
Was adequate sample volume provided ⁽¹⁾ ?	<input checked="" type="checkbox"/>			
Are short holding time analytes or samples with HTs due within 48 hours present ⁽¹⁾ ?			<input checked="" type="checkbox"/>	
Is a chain-of-custody (COC) present and filled out completely ⁽¹⁾ ?	<input checked="" type="checkbox"/>			
Does the COC agree with the number and type of sample bottles received ⁽¹⁾ ?	<input checked="" type="checkbox"/>			
Do the sample IDs on the bottle labels match the COC ⁽¹⁾ ?	<input checked="" type="checkbox"/>			
Is the COC properly relinquished by the client with date and time recorded ⁽¹⁾ ?	<input checked="" type="checkbox"/>			
For volatiles in water — is there headspace (> ¼ inch bubble) present? If yes, contact client and note in narrative.			<input checked="" type="checkbox"/>	
Are samples preserved that require preservation and was it checked ⁽¹⁾ ? (note ID of confirmation instrument used in comments) / (preservation is not confirmed for subcontracted analytes in order to insure sample integrity)/(pH < 2 for samples preserved with HNO ₃ , HCL, H ₂ SO ₄) / (pH > 10 for samples preserved with NaAsO ₂ +NaOH, ZnAc+NaOH)			<input checked="" type="checkbox"/>	
Additional Comments (if any):				

⁽¹⁾ If NO, then contact the client before proceeding with analysis and note date/time and person contacted as well as the corrective action to in the additional comments (above) and the case narrative.

Reviewed by: [Signature] (Project Manager)

Date/Time Reviewed: 7-19-22

Origins Laboratory, Inc.

[Signature]

The results in this report apply to the samples analyzed in accordance with the chain of custody document. This analytical report must be reproduced in its entirety.

Eagle Environmental Consulting, Inc.
8000 W 44th Ave
Wheat Ridge CO 80033

Martin C Eckert III
Project Number: [none]
Project: Noble - Gutttersen State DD #8-11

WH-FS-01@6'

7/19/2022 7:38:00AM

Analyte	Result	Min Detection Limit	Reporting Limit	Units	Dilution	Batch	Prepared	Analyzed	Notes
---------	--------	---------------------	-----------------	-------	----------	-------	----------	----------	-------

Origins Laboratory, Inc.
Y207380-01 (Soil)

Boron (DTPA Sorbitol)

Boron	ND	0.0990	mg/L	1	B2G2008	07/20/2022	07/21/2022	
-------	----	--------	------	---	---------	------------	------------	--

DRO/ORO by EPA 8015D

Diesel (C10-C28)	ND	25.0	mg/kg	1	B2G2012	07/20/2022	07/26/2022	U
Residual Range Organics (C28-C40)	ND	100	"	"	"	"	"	U

Surrogate: o-Terphenyl	116 %	50-150			"	"	"	
------------------------	-------	--------	--	--	---	---	---	--

GBTEX+TMBs by 8260D

1,2,4-Trimethylbenzene	ND	0.00200	mg/kg	1	B2G1927	07/19/2022	07/20/2022	U
1,3,5-Trimethylbenzene	ND	0.00200	"	"	"	"	"	U
Benzene	ND	0.00200	"	"	"	"	"	U
Ethylbenzene	ND	0.00200	"	"	"	"	"	U
Toluene	ND	0.00200	"	"	"	"	"	U
Xylenes, total	ND	0.00200	"	"	"	"	"	U
Gasoline Range Hydrocarbons	ND	0.200	"	"	"	"	"	U

Surrogate: 1,2-Dichloroethane-d4	114 %	70-130			"	"	"	
----------------------------------	-------	--------	--	--	---	---	---	--

Origins Laboratory, Inc.



The results in this report apply to the samples analyzed in accordance with the chain of custody document. This analytical report must be reproduced in its entirety.

Eagle Environmental Consulting, Inc.
8000 W 44th Ave
Wheat Ridge CO 80033

Martin C Eckert III
Project Number: [none]
Project: Noble - Gutterson State DD #8-11

WH-FS-01@6'

7/19/2022 7:38:00AM

Analyte	Result	Min Detection Limit	Reporting Limit	Units	Dilution	Batch	Prepared	Analyzed	Notes
---------	--------	---------------------	-----------------	-------	----------	-------	----------	----------	-------

Origins Laboratory, Inc.
Y207380-01 (Soil)

GBTEX+TMBs by 8260D

Surrogate: Toluene-d8	101 %	70-130	B2G19 27	07/19/2022	07/20/2022
Surrogate: 4-Bromofluorobenzene	96.3 %	70-130	"	"	"

Metals by Saturated Paste by EPA 6010

Calcium	1.64	0.499	meq/L	10	[CALC]	07/20/2022	07/21/2022
Magnesium	ND	0.823	"	"	"	"	"
Sodium	ND	0.435	"	"	"	"	"

PAH by 8270D SIM

1-Methylnaphthalene	ND	0.00182	0.00335	mg/Kg	5	L629607	08/01/2022	08/04/2022
2-Methylnaphthalene	ND	0.00323	0.00335	"	"	"	"	"
Acenaphthene	ND	0.00152	0.00335	"	"	"	"	"
Anthracene	ND	0.00167	0.00335	"	"	"	"	"
Benzo(a)anthracene	ND	0.00247	0.00335	"	"	"	"	"
Benzo(a)pyrene	ND	0.00234	0.00335	"	"	"	"	"
Benzo(b)fluoranthene	ND	0.00293	0.00335	"	"	"	"	"
Benzo(k)fluoranthene	ND	0.00219	0.00335	"	"	"	"	"
Chrysene	ND	0.00312	0.00335	"	"	"	"	"
Dibenz(a,h)anthracene	ND	0.00307	0.00335	"	"	"	"	"
Fluoranthene	ND	0.00197	0.00335	"	"	"	"	"

Origins Laboratory, Inc.



The results in this report apply to the samples analyzed in accordance with the chain of custody document. This analytical report must be reproduced in its entirety.

Eagle Environmental Consulting, Inc.
8000 W 44th Ave
Wheat Ridge CO 80033

Martin C Eckert III
Project Number: [none]
Project: Noble - Guttersen State DD #8-11

WH-FS-01@6'

7/19/2022 7:38:00AM

Analyte	Result	Min Detection Limit	Reporting Limit	Units	Dilution	Batch	Prepared	Analyzed	Notes
---------	--------	---------------------	-----------------	-------	----------	-------	----------	----------	-------

Waypoint Analytical, Inc.
Y207380-01 (Soil)

PAH by 8270D SIM

Fluorene	ND	0.00143	0.00335	mg/Kg	5	L629607	08/01/2022	08/04/2022
Indeno(1,2,3-cd)pyrene	ND	0.00314	0.00335	"	"	"	"	"
Naphthalene	ND	0.00242	0.00335	"	"	"	"	"
Pyrene	ND	0.00322	0.00335	"	"	"	"	"

Surrogate: 2-Fluorobiphenyl	50.6 %		33-115			"	"	"
Surrogate: 4-Terphenyl-d14	59.2 %		33-122			"	"	"
Surrogate: Nitrobenzene-d5	50.6 %		29-110			"	"	"

pH in Soil by 9045D

pH	7.38			pH Units	1	B2G2010	07/20/2022	07/21/2022
----	------	--	--	----------	---	---------	------------	------------

SAR by 20B Saturated Paste

SAR	0.332			SAR	1	B2G2009	07/20/2022	07/21/2022
-----	-------	--	--	-----	---	---------	------------	------------

Specific Conductance Mod. 9050A

Specific Conductance (EC)	0.442		0.00500	mmhos/cm	1	B2G2010	07/20/2022	07/21/2022
---------------------------	-------	--	---------	----------	---	---------	------------	------------

Origins Laboratory, Inc.



The results in this report apply to the samples analyzed in accordance with the chain of custody document. This analytical report must be reproduced in its entirety.

Eagle Environmental Consulting, Inc.
8000 W 44th Ave
Wheat Ridge CO 80033

Martin C Eckert III
Project Number: [none]
Project: Noble - Gutttersen State DD #8-11

Volatile Organic Compounds by GC/MS SW846 8260D - Quality Control
Origins Laboratory, Inc.

Analyte	Result	Reporting Limit	Units	Spike Level	Source Result	%REC	%REC Limits	RPD	RPD Limit	Notes
Batch B2G1927 - EPA 5030 (soil)										
Blank (B2G1927-BLK1)					Prepared: 07/19/2022 Analyzed: 07/20/2022					
1,2,4-Trimethylbenzene	ND	0.00200	mg/kg							U
1,3,5-Trimethylbenzene	ND	0.00200	"							U
Benzene	ND	0.00200	"							U
Ethylbenzene	ND	0.00200	"							U
Naphthalene	ND	0.0100	"							U
Toluene	ND	0.00200	"							U
Xylenes, total	ND	0.00200	"							U
Gasoline Range Hydrocarbons	ND	0.200	"							U
Surrogate: 1,2-Dichloroethane-d4	0.13		"	0.125		107	70-130			
Surrogate: Toluene-d8	0.12		"	0.125		96.7	70-130			
Surrogate: 4-Bromofluorobenzene	0.12		"	0.125		94.1	70-130			

Origins Laboratory, Inc.



The results in this report apply to the samples analyzed in accordance with the chain of custody document. This analytical report must be reproduced in its entirety.

Eagle Environmental Consulting, Inc.
8000 W 44th Ave
Wheat Ridge CO 80033

Martin C Eckert III
Project Number: [none]
Project: Noble - Guttersen State DD #8-11

Volatile Organic Compounds by GC/MS SW846 8260D - Quality Control
Origins Laboratory, Inc.

Analyte	Result	Reporting Limit	Units	Spike Level	Source Result	%REC	%REC Limits	RPD	RPD Limit	Notes
Batch B2G1927 - EPA 5030 (soil)										
LCS (B2G1927-BS1)					Prepared: 07/19/2022 Analyzed: 07/20/2022					
1,2,4-Trimethylbenzene	0.105	0.00200	mg/kg	0.100		105	70-130			
1,3,5-Trimethylbenzene	0.118	0.00200	"	0.100		118	70-130			
Benzene	0.104	0.00200	"	0.100		104	70-130			
Ethylbenzene	0.110	0.00200	"	0.100		110	70-130			
Naphthalene	0.101	0.0100	"	0.100		101	70-130			
Toluene	0.0956	0.00200	"	0.100		95.6	70-130			
o-Xylene	0.109	0.00200	"	0.100		109	70-130			
m,p-Xylene	0.215	0.00400	"	0.200		107	70-130			
Surrogate: 1,2-Dichloroethane-d4	0.13		"	0.125		108	70-130			
Surrogate: Toluene-d8	0.12		"	0.125		96.6	70-130			
Surrogate: 4-Bromofluorobenzene	0.15		"	0.125		119	70-130			

Origins Laboratory, Inc.



The results in this report apply to the samples analyzed in accordance with the chain of custody document. This analytical report must be reproduced in its entirety.

Eagle Environmental Consulting, Inc.
8000 W 44th Ave
Wheat Ridge CO 80033

Martin C Eckert III
Project Number: [none]
Project: Noble - Guttersen State DD #8-11

Volatile Organic Compounds by GC/MS SW846 8260D - Quality Control

Origins Laboratory, Inc.

Analyte	Result	Reporting Limit	Units	Spike Level	Source Result	%REC	%REC Limits	RPD	RPD Limit	Notes
---------	--------	-----------------	-------	-------------	---------------	------	-------------	-----	-----------	-------

Batch B2G1927 - EPA 5030 (soil)

Matrix Spike (B2G1927-MS1)		Source: Y207367-01			Prepared: 07/19/2022 Analyzed: 07/20/2022					
1,2,4-Trimethylbenzene	0.104	0.00200	mg/kg	0.100	ND	104	70-130			
1,3,5-Trimethylbenzene	0.104	0.00200	"	0.100	ND	104	70-130			
Benzene	0.107	0.00200	"	0.100	ND	107	70-130			
Ethylbenzene	0.119	0.00200	"	0.100	ND	119	70-130			
Naphthalene	0.108	0.0100	"	0.100	0.000760	108	70-130			
Toluene	0.0873	0.00200	"	0.100	ND	87.3	70-130			
o-Xylene	0.120	0.00200	"	0.100	ND	120	70-130			
m,p-Xylene	0.239	0.00400	"	0.200	ND	119	70-130			
Surrogate: 1,2-Dichloroethane-d4	0.14		"	0.125		115	70-130			
Surrogate: Toluene-d8	0.11		"	0.125		86.7	70-130			
Surrogate: 4-Bromofluorobenzene	0.13		"	0.125		107	70-130			

Origins Laboratory, Inc.



The results in this report apply to the samples analyzed in accordance with the chain of custody document. This analytical report must be reproduced in its entirety.

Eagle Environmental Consulting, Inc.
8000 W 44th Ave
Wheat Ridge CO 80033

Martin C Eckert III
Project Number: [none]
Project: Noble - Guttersen State DD #8-11

Volatile Organic Compounds by GC/MS SW846 8260D - Quality Control
Origins Laboratory, Inc.

Analyte	Result	Reporting Limit	Units	Spike Level	Source Result	%REC	%REC Limits	RPD	RPD Limit	Notes
Batch B2G1927 - EPA 5030 (soil)										
Matrix Spike Dup (B2G1927-MSD1)		Source: Y207367-01			Prepared: 07/19/2022 Analyzed: 07/20/2022					
1,2,4-Trimethylbenzene	0.107	0.00200	mg/kg	0.100	ND	107	70-130	2.68	20	
1,3,5-Trimethylbenzene	0.107	0.00200	"	0.100	ND	107	70-130	3.25	20	
Benzene	0.111	0.00200	"	0.100	ND	111	70-130	3.35	20	
Ethylbenzene	0.110	0.00200	"	0.100	ND	110	70-130	7.65	20	
Naphthalene	0.108	0.0100	"	0.100	0.000760	108	70-130	0.0553	20	
Toluene	0.100	0.00200	"	0.100	ND	100	70-130	14.0	20	
o-Xylene	0.110	0.00200	"	0.100	ND	110	70-130	8.38	20	
m,p-Xylene	0.215	0.00400	"	0.200	ND	107	70-130	10.6	20	
Surrogate: 1,2-Dichloroethane-d4	0.14		"	0.125		112	70-130			
Surrogate: Toluene-d8	0.12		"	0.125		95.9	70-130			
Surrogate: 4-Bromofluorobenzene	0.13		"	0.125		105	70-130			

Origins Laboratory, Inc.



The results in this report apply to the samples analyzed in accordance with the chain of custody document. This analytical report must be reproduced in its entirety.

Eagle Environmental Consulting, Inc.
8000 W 44th Ave
Wheat Ridge CO 80033

Martin C Eckert III
Project Number: [none]
Project: Noble - Guttarsen State DD #8-11

Volatile Organic Compounds by GC/MS SW846 8260D - Quality Control
Origins Laboratory, Inc.

Analyte	Result	Reporting Limit	Units	Spike Level	Source Result	%REC	%REC Limits	RPD	RPD Limit	Notes
Batch B2G2012 - EPA 3580										
Blank (B2G2012-BLK1)					Prepared: 07/20/2022 Analyzed: 07/25/2022					
Diesel (C10-C28)	ND	25.0	mg/kg							U
Residual Range Organics (C28-C40)	ND	100	"							U
Surrogate: o-Terphenyl	28		"	24.9		112	50-150			

Origins Laboratory, Inc.



The results in this report apply to the samples analyzed in accordance with the chain of custody document. This analytical report must be reproduced in its entirety.

Eagle Environmental Consulting, Inc.
8000 W 44th Ave
Wheat Ridge CO 80033

Martin C Eckert III
Project Number: [none]
Project: Noble - Guttersen State DD #8-11

Extractable Petroleum Hydrocarbons by 8015D - Quality Control
Origins Laboratory, Inc.

Analyte	Result	Reporting Limit	Units	Spike Level	Source Result	%REC	%REC Limits	RPD	RPD Limit	Notes
---------	--------	-----------------	-------	-------------	---------------	------	-------------	-----	-----------	-------

Batch B2G2012 - EPA 3580

LCS (B2G2012-BS1)

Prepared: 07/20/2022 Analyzed: 07/25/2022

Diesel (C10-C28)	983	50.0	mg/kg	1000		98.3	70-130			
Residual Range Organics (C28-C40)	1130	200	"	1000		113	70-130			
Surrogate: o-Terphenyl	53		"	49.8		106	50-150			

Origins Laboratory, Inc.



The results in this report apply to the samples analyzed in accordance with the chain of custody document. This analytical report must be reproduced in its entirety.

Eagle Environmental Consulting, Inc.
8000 W 44th Ave
Wheat Ridge CO 80033

Martin C Eckert III
Project Number: [none]
Project: Noble - Guttersen State DD #8-11

Extractable Petroleum Hydrocarbons by 8015D - Quality Control
Origins Laboratory, Inc.

Analyte	Result	Reporting Limit	Units	Spike Level	Source Result	%REC	%REC Limits	RPD	RPD Limit	Notes
---------	--------	-----------------	-------	-------------	---------------	------	-------------	-----	-----------	-------

Batch B2G2012 - EPA 3580

Matrix Spike (B2G2012-MS1)		Source: Y207355-01			Prepared: 07/20/2022 Analyzed: 07/25/2022					
Diesel (C10-C28)	974	50.0	mg/kg	1000	ND	97.4	70-130			
Residual Range Organics (C28-C40)	1090	200	"	1000	ND	109	70-130			
Surrogate: o-Terphenyl	50		"	49.8		101	50-150			

Origins Laboratory, Inc.



The results in this report apply to the samples analyzed in accordance with the chain of custody document. This analytical report must be reproduced in its entirety.

Eagle Environmental Consulting, Inc.
8000 W 44th Ave
Wheat Ridge CO 80033

Martin C Eckert III
Project Number: [none]
Project: Noble - Gutterson State DD #8-11

Extractable Petroleum Hydrocarbons by 8015D - Quality Control
Origins Laboratory, Inc.

Analyte	Result	Reporting Limit	Units	Spike Level	Source Result	%REC	%REC Limits	RPD	RPD Limit	Notes
---------	--------	-----------------	-------	-------------	---------------	------	-------------	-----	-----------	-------

Batch B2G2012 - EPA 3580

Matrix Spike Dup (B2G2012-MSD1)		Source: Y207355-01			Prepared: 07/20/2022 Analyzed: 07/25/2022					
Diesel (C10-C28)	1160	50.0	mg/kg	1000	ND	116	70-130	17.7	35	
Residual Range Organics (C28-C40)	1280	200	"	1000	ND	128	70-130	16.6	35	
Surrogate: o-Terphenyl	60		"	49.8		121	50-150			

Origins Laboratory, Inc.



The results in this report apply to the samples analyzed in accordance with the chain of custody document. This analytical report must be reproduced in its entirety.

Eagle Environmental Consulting, Inc.
8000 W 44th Ave
Wheat Ridge CO 80033

Martin C Eckert III
Project Number: [none]
Project: Noble - Guttersen State DD #8-11

Extractable Petroleum Hydrocarbons by 8015D - Quality Control

Origins Laboratory, Inc.

Analyte	Result	Reporting Limit	Units	Spike Level	Source Result	%REC	%REC Limits	RPD	RPD Limit	Notes
---------	--------	-----------------	-------	-------------	---------------	------	-------------	-----	-----------	-------

Saturated Paste - Quality Control

Origins Laboratory, Inc.

Analyte	Result	Reporting Limit	Units	Spike Level	Source Result	%REC	%REC Limits	RPD	RPD Limit	Notes
---------	--------	-----------------	-------	-------------	---------------	------	-------------	-----	-----------	-------

Batch B2G2010 - NO PREP

Blank (B2G2010-BLK1)

Prepared: 07/20/2022 Analyzed: 07/21/2022

pH 0.00 pH Units
Specific Conductance (EC) 0.00100 0.00500 mmhos/cm

Duplicate (B2G2010-DUP1)

Source: Y207368-04

Prepared: 07/20/2022 Analyzed: 07/21/2022

Specific Conductance (EC) 0.365 0.00500 mmhos/cm 0.235 43.5 25 QR-DUP
pH 8.19 pH Units 8.28 1.09 25

Origins Laboratory, Inc.



The results in this report apply to the samples analyzed in accordance with the chain of custody document. This analytical report must be reproduced in its entirety.

Eagle Environmental Consulting, Inc.
8000 W 44th Ave
Wheat Ridge CO 80033

Martin C Eckert III
Project Number: [none]
Project: Noble - Guttersen State DD #8-11

PAH by 8270D SIM - Quality Control
Waypoint Analytical, Inc.

Analyte	Result	Reporting Limit	Units	Spike Level	Source Result	%REC	%REC Limits	RPD	RPD Limit	Notes
---------	--------	-----------------	-------	-------------	---------------	------	-------------	-----	-----------	-------

Batch L629607 - 3550B

MSD (L 93176-MSD-L629607)		Source: 93176			Prepared: 08/01/2022 Analyzed: 08/04/2022					
Anthracene	0.0899	0.000334	mg/Kg	0.162	<0.000334	55.4	30-130	13.5	30	
1-Methylnaphthalene	0.0839	0.000364	"	0.162	<0.000364	51.7	30-130	6.7	30	
2-Methylnaphthalene	0.0832	0.000645	"	0.162	<0.000645	51.3	30-130	5.7	30	
Benzo(a)anthracene	0.1	0.000493	"	0.162	<0.000493	61.7	30-130	12.2	30	
Naphthalene	0.0851	0.000484	"	0.162	<0.000484	52.5	30-130	6.5	30	
Acenaphthene	0.0835	0.000304	"	0.162	<0.000304	51.5	30-130	8.2	30	
Indeno(1,2,3-cd)pyrene	0.105	0.000627	"	0.162	<0.000627	64.8	30-130	10.8	30	
Fluorene	0.0895	0.000286	"	0.162	<0.000286	55.2	30-130	9.8	30	
Fluoranthene	0.0984	0.000394	"	0.162	<0.000394	60.7	30-130	12.9	30	
Dibenz(a,h)anthracene	0.0933	0.000614	"	0.162	<0.000614	57.5	30-130	14.6	30	
Chrysene	0.0953	0.000624	"	0.162	<0.000624	58.8	30-130	11.5	30	
Benzo(k)fluoranthene	0.081	0.000437	"	0.162	<0.000437	50	30-130	13.3	30	
Benzo(b)fluoranthene	0.0877	0.000585	"	0.162	<0.000585	54.1	30-130	9.2	30	
Benzo(a)pyrene	0.0996	0.000468	"	0.162	<0.000468	61.4	30-130	16	30	
Pyrene	0.0983	0.000643	"	0.162	<0.000643	60.6	30-130	13.9	30	
Surrogate: 2-Fluorobiphenyl	56.3		"	0.325	187	56.3	33-115			
Surrogate: 4-Terphenyl-d14	67		"	0.325	236	67	33-122			
Surrogate: Nitrobenzene-d5	53.5		"	0.325	177	53.5	29-110			

MS (L 93176-MS-L629607)		Source: 93176			Prepared: 08/01/2022 Analyzed: 08/04/2022					
Benzo(a)anthracene	0.113	0.000493	mg/Kg	0.167	<0.000493	67.6	30-130			
Chrysene	0.107	0.000624	"	0.167	<0.000624	64	30-130			
Pyrene	0.113	0.000643	"	0.167	<0.000643	67.6	30-130			
Naphthalene	0.0909	0.000484	"	0.167	<0.000484	54.4	30-130			
Indeno(1,2,3-cd)pyrene	0.117	0.000627	"	0.167	<0.000627	70	30-130			
Fluorene	0.0988	0.000286	"	0.167	<0.000286	59.1	30-130			
Fluoranthene	0.112	0.000394	"	0.167	<0.000394	67	30-130			

Origins Laboratory, Inc.



The results in this report apply to the samples analyzed in accordance with the chain of custody document. This analytical report must be reproduced in its entirety.

Eagle Environmental Consulting, Inc.
8000 W 44th Ave
Wheat Ridge CO 80033

Martin C Eckert III
Project Number: [none]
Project: Noble - Guttersen State DD #8-11

PAH by 8270D SIM - Quality Control
Waypoint Analytical, Inc.

Analyte	Result	Reporting Limit	Units	Spike Level	Source Result	%REC	%REC Limits	RPD	RPD Limit	Notes
---------	--------	-----------------	-------	-------------	---------------	------	-------------	-----	-----------	-------

Batch L629607 - 3550B

MS (L 93176-MS-L629607)		Source: 93176			Prepared: 08/01/2022 Analyzed: 08/04/2022					
Dibenz(a,h)anthracene	0.108	0.000614	mg/Kg	0.167	<0.000614	64.6	30-130			
Benzo(a)pyrene	0.117	0.000468	"	0.167	<0.000468	70	30-130			
Anthracene	0.103	0.000334	"	0.167	<0.000334	61.6	30-130			
Acenaphthene	0.0907	0.000304	"	0.167	<0.000304	54.3	30-130			
2-Methylnaphthalene	0.0881	0.000645	"	0.167	<0.000645	52.7	30-130			
Benzo(k)fluoranthene	0.0926	0.000437	"	0.167	<0.000437	55.4	30-130			
Benzo(b)fluoranthene	0.0962	0.000585	"	0.167	<0.000585	57.6	30-130			
1-Methylnaphthalene	0.0898	0.000364	"	0.167	<0.000364	53.7	30-130			
Surrogate: Nitrobenzene-d5	57.3		"	0.333	177	57.3	29-110			
Surrogate: 2-Fluorobiphenyl	60.6		"	0.333	187	60.6	33-115			
Surrogate: 4-Terphenyl-d14	78		"	0.333	236	78	33-122			

LCS (LCS-L629607)		Prepared: 08/01/2022 Analyzed: 08/04/2022								
Dibenz(a,h)anthracene	0.103	0.000614	mg/Kg	0.167		61.6	30-130			
Fluoranthene	0.108	0.000394	"	0.167		64.6	30-130			
Fluorene	0.0997	0.000286	"	0.167		59.7	30-130			
Indeno(1,2,3-cd)pyrene	0.116	0.000627	"	0.167		69.4	30-130			
Naphthalene	0.0961	0.000484	"	0.167		57.5	30-130			
Pyrene	0.106	0.000643	"	0.167		63.4	30-130			
2-Methylnaphthalene	0.093	0.000645	"	0.167		55.6	30-130			
Chrysene	0.0983	0.000624	"	0.167		58.8	30-130			
1-Methylnaphthalene	0.0934	0.000364	"	0.167		55.9	30-130			
Benzo(b)fluoranthene	0.102	0.000585	"	0.167		61	30-130			
Benzo(a)pyrene	0.105	0.000468	"	0.167		62.8	30-130			
Benzo(a)anthracene	0.104	0.000493	"	0.167		62.2	30-130			
Anthracene	0.101	0.000334	"	0.167		60.4	30-130			
Acenaphthene	0.0924	0.000304	"	0.167		55.3	30-130			

Origins Laboratory, Inc.



The results in this report apply to the samples analyzed in accordance with the chain of custody document. This analytical report must be reproduced in its entirety.

Eagle Environmental Consulting, Inc.
8000 W 44th Ave
Wheat Ridge CO 80033

Martin C Eckert III
Project Number: [none]
Project: Noble - Guttersen State DD #8-11

PAH by 8270D SIM - Quality Control
Waypoint Analytical, Inc.

Analyte	Result	Reporting Limit	Units	Spike Level	Source Result	%REC	%REC Limits	RPD	RPD Limit	Notes
---------	--------	-----------------	-------	-------------	---------------	------	-------------	-----	-----------	-------

Batch L629607 - 3550B

LCS (LCS-L629607)

Prepared: 08/01/2022 Analyzed: 08/04/2022

Benzo(k)fluoranthene	0.0959	0.000437	mg/Kg	0.167		57.4	30-130			
Surrogate: Nitrobenzene-d5	63		"	0.333		63	29-110			
Surrogate: 4-Terphenyl-d14	75.3		"	0.333		75.3	33-122			
Surrogate: 2-Fluorobiphenyl	65.4		"	0.333		65.4	33-115			

LRB (LRB-L629607)

Prepared: 08/01/2022 Analyzed: 08/04/2022

Chrysene	ND	0.00067	mg/Kg				-			
Dibenz(a,h)anthracene	ND	0.00067	"				-			
Fluoranthene	ND	0.00067	"				-			
Fluorene	ND	0.00067	"				-			
Benzo(k)fluoranthene	ND	0.00067	"				-			
Naphthalene	ND	0.00067	"				-			
Indeno(1,2,3-cd)pyrene	ND	0.00067	"				-			
Benzo(b)fluoranthene	ND	0.00067	"				-			
Benzo(a)pyrene	ND	0.00067	"				-			
Benzo(a)anthracene	ND	0.00067	"				-			
Acenaphthene	ND	0.00067	"				-			
2-Methylnaphthalene	ND	0.00067	"				-			
1-Methylnaphthalene	ND	0.00067	"				-			
Pyrene	ND	0.00067	"				-			
Anthracene	ND	0.00067	"				-			
Surrogate: 4-Terphenyl-d14	54.6		"	0.333		54.6	33-122			
Surrogate: Nitrobenzene-d5	48.3		"	0.333		48.3	29-110			
Surrogate: 2-Fluorobiphenyl	46.8		"	0.333		46.8	33-115			

Origins Laboratory, Inc.



The results in this report apply to the samples analyzed in accordance with the chain of custody document. This analytical report must be reproduced in its entirety.

Eagle Environmental Consulting, Inc.

8000 W 44th Ave

Wheat Ridge CO 80033

Martin C Eckert III

Project Number: [none]

Project: Noble - Gutttersen State DD #8-11

Notes and Definitions

U Sample is Non-Detect.

QR-DUP RPD exceeds QC acceptance criteria, this indicates source sample is not homogenous.

ND Analyte NOT DETECTED at or above the reporting limit

RPD Relative Percent Difference

All soil results are reported on a wet weight basis.

Origins Laboratory, Inc.



The results in this report apply to the samples analyzed in accordance with the chain of custody document. This analytical report must be reproduced in its entirety.