

POINT	NAD 83		NAD 27	
SURFACE HOLE LOCATION	N:	1281682.28	N:	281685.08
	E:	3266033.24	E:	2266184.37
	LAT:	N40.1026936	LAT:	N40.1027110
	LONG:	W104.5489518	LONG:	W104.5484364
TOP OF PRODUCTION ZONE	N:	1283637.20	N:	283639.98
	E:	3265053.62	E:	2265204.75
	LAT:	N40.1080887	LAT:	N40.1081061
	LONG:	W104.5523790	LONG:	W104.5518633
BOTTOM OF PRODUCTION ZONE	N:	1276642.18	N:	276645.01
	E:	3265149.51	E:	2265300.7
	LAT:	N40.0888845	LAT:	N40.0889018
	LONG:	W104.5523034	LONG:	W104.5517878
BOTTOM HOLE LOCATION	N:	1276552.18	N:	276555.02
	E:	3265150.74	E:	2265301.93
	LAT:	N40.0886375	LAT:	N40.0886547
	LONG:	W104.5523025	LONG:	W104.5517868

- LEGEND
- SECTION LINE
 - QUARTER SECTION LINE
 - SIXTEENTH SECTION LINE
 - RANGE/TOWNSHIP LINE
 - PROPOSED LOCATION
 - POINT OF INTERSECTION
 - MONUMENT FOUND
 - CALCULATED CORNER

TOPOGRAPHIC
LOYALTY INNOVATION LEGACY
520 Stacy Court Ste B, Lafayette, CO 80026
303.666.0379 www.topographic.com

SURVEYOR'S STATEMENT
THE UNDERSIGNED HEREBY STATES THAT THE WELL LOCATION SHOWN HEREON WAS STAKED ON THE GROUND BASED ON EXISTING MONUMENTATION AND/OR PHYSICAL EVIDENCE FOUND IN THE FIELD AND IS CORRECT TO THE BEST OF MY KNOWLEDGE, INFORMATION AND BELIEF.

- NOTES**
- HORIZONTAL (NAD 83) AND VERTICAL (NAVD 88) DATUM IS BASED ON THE TRIMBLE VRS NETWORK. THE LINEAL UNITS OF MEASUREMENT ARE U.S. SURVEY FEET.
 - ALL DIRECTIONS, DISTANCES, AND DIMENSIONS SHOWN HEREON ARE BASED ON COORDINATES FROM THE "COLORADO COORDINATE SYSTEM OF 1983 NORTH ZONE" (TITLE 38, ARTICLE 52 C.R.S.).
 - ALL SECTION LINE DIMENSIONS SHOWN HEREON ARE BASED ON FIELD MEASUREMENTS OF EXISTING MONUMENTS AND/OR PHYSICAL EVIDENCE FOUND IN THE FIELD UNLESS OTHERWISE INDICATED.
 - PHYSICAL FEATURES SHOWN HEREON ARE FOR GRAPHICAL REPRESENTATION ONLY.
 - SEE FORM 2A FOR VISIBLE IMPROVEMENTS WITHIN 500' OF WELLHEAD.
 - DISTANCES TO NEAREST SECTION LINES ARE MEASURED PERPENDICULARLY.
 - THIS IS NOT A LAND SURVEY NOR LAND SURVEY PLAT.
 - PDOP READING: 1.6 INSTRUMENT OPERATOR: Brent Garcia

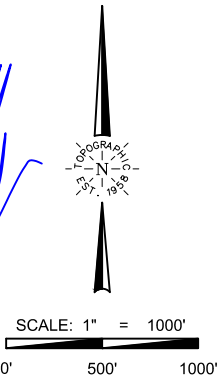
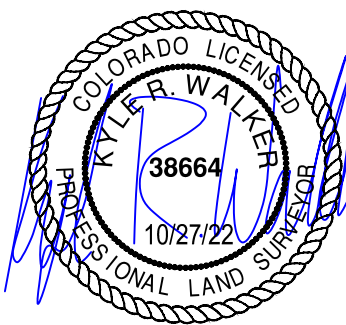

VERDAD RESOURCES
GEORGENE 2833-06H

FIELD	03/31/2022	DRAFT	SW
REV 8	10/27/2022	CHECK	ZAK
SHEET :	1 OF 1	JOB:	128301

WELL LOCATION MAP
S.H.L. SE/4 SE/4, SECTION 28 T2N R64W 6TH PM
TPZ NW/4 SE/4, SECTION 28 T2N R64W 6TH PM
BPZ SW/4 SE/4, SECTION 33 T2N R64W 6TH PM
BHL SW/4 SE/4, SECTION 33 T2N R64W 6TH PM
WELD COUNTY, COLORADO