



FORM F-106



R. 59W

RECEIVED

SEP 16 1974

COLO. OIL & GAS CONS. COMM.

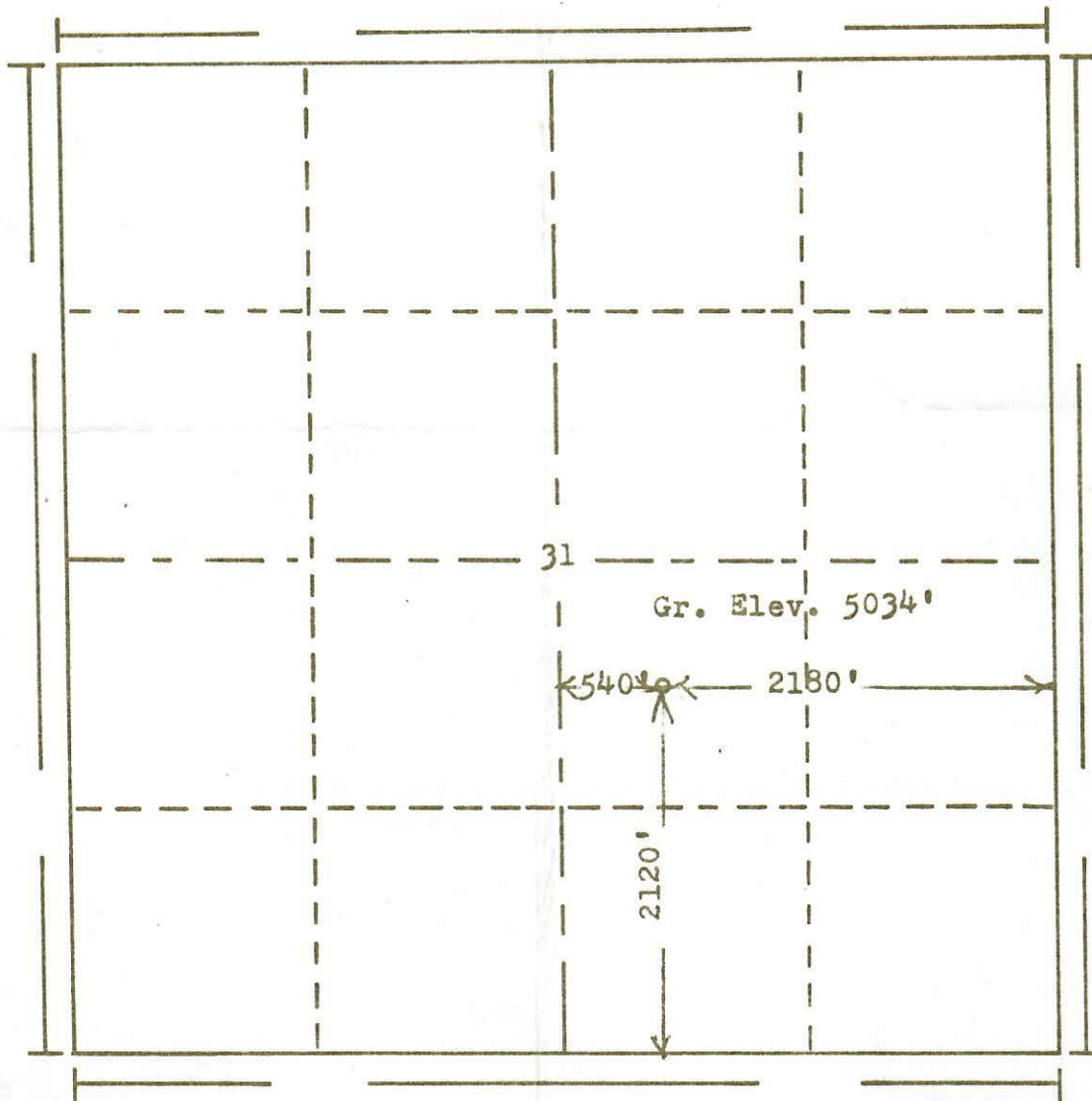

Scale... 1" = 1000'

Powers Elevation Company, Inc. of Denver, Colorado
has in accordance with a request from Mr. Huckabay
for E. Doyle Huckabay, Ltd.

determined the location of No. 2 Minnebur
to be 200'NW of CNW SE Section 31 Township 3S
Range 59W of the 6th Principal Meridian
Adams County, Colorado

I hereby certify that this plat is an
accurate representation of a correct
survey showing the location of

Date 9-3-74

Ray H. Huckabay
Licensed Land Surveyor No. 2853
State of Colorado

74-703