

60

90

120

SE

150

180

S

210

SW

● 40.246754, -104.655059 ±17ft



CRESTONE PEAK
 IN EMERGENCY CONTACT
 911
 303-659-7740
ARISTOCRAT ANGUS 3-10B BATTERY
 NW / NW S10-T3N-R65W 6TH PM
 LAT/LONG:
 40.246518113° N - 104.65087° W
 WELD COUNTY, CO
DANGER
 NO TRESPASSING
 AUTHORIZED PERSONNEL ONLY
REQUIRED:
 PERSONAL PROTECTIVE EQUIPMENT AND THE RETURN OF ALL TOOLS
 PFC
 PLEASE OBEY POSTED SPEED LIMITS

CRESTONE PEAK
 303-659-7740
ARISTOCRAT ANGUS 12-10 WELL
 SE/NW S10-T3N-R65W 6TH PM

CRESTONE PEAK
 303-659-7740
ARISTOCRAT ANGUS 11-10 WELL
 NW/NW S10-T3N-R65W 6TH PM

CRESTONE PEAK
 303-659-7740
ARISTOCRAT ANGUS 1-2-10 WELL
 NW/NW S10-T3N-R65W 6TH PM

CRESTONE PEAK
 303-659-7740
ARISTOCRAT ANGUS 21-10 C WELL
 NE/NW S10-T3N-R65W 6TH PM

CRESTONE PEAK
 303-659-7740
ARISTOCRAT ANGUS 22-10 WELL
 SE/NW S10-T3N-R65W 6TH PM

CRESTONE PEAK
 303-659-7740
ARISTOCRAT ANGUS 2-10 WELL
 NW/NW S10-T3N-R65W 6TH PM

NE

E

SE

S

30

60

90

120

150

180

● 40.246762, -104.655059 ±17ft



AA 3-10A Battery

15 Dec 2022, 01:54 PM

E
90

120

SE

150

S
180

210

SW

240

● 40.24676, -104.655064 ±17ft

310B
COC 57611

SPLLC
162600
91626000

FEDERAL WELL
ALL RUN TICKETS
REQUIRED TO HAVE
LEASE NUMBERS
ON/OFF SEAL
NUMBERS

74203

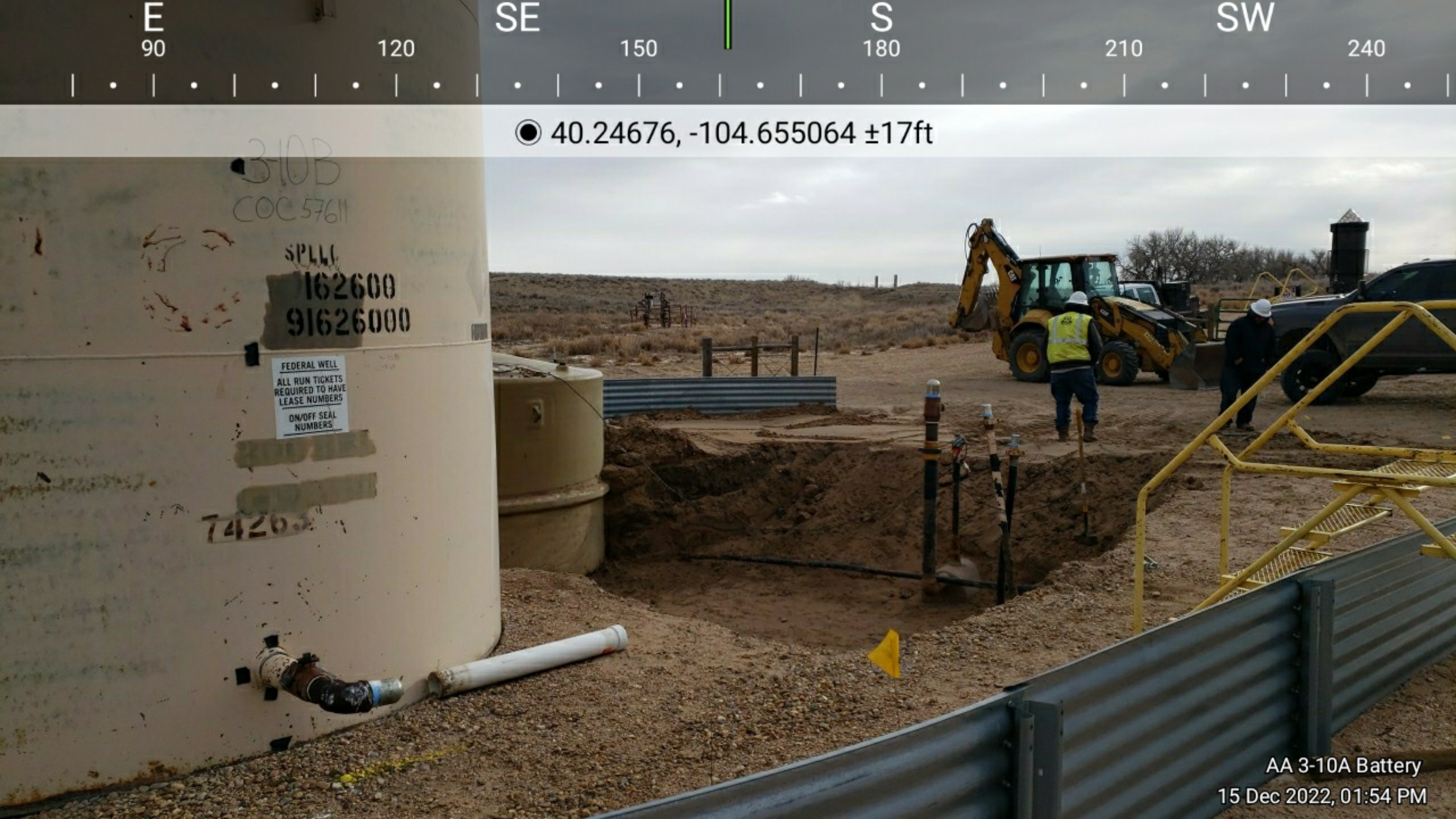

W
270

NW
300

330

N
0

30

NE
60

● 40.246566, -104.655062 ±14ft

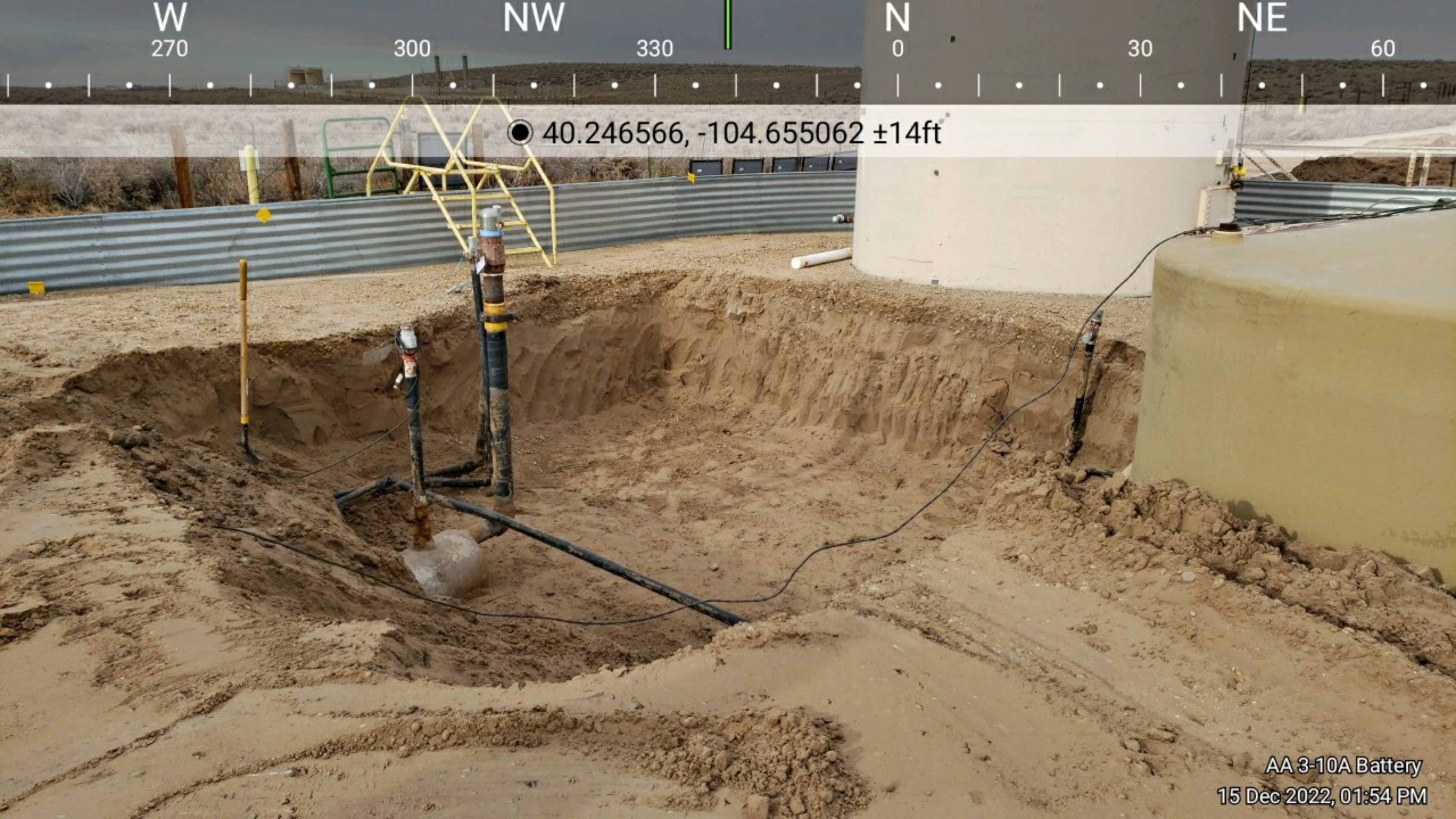

AA 3-10A Battery
15 Dec 2022, 01:54 PM

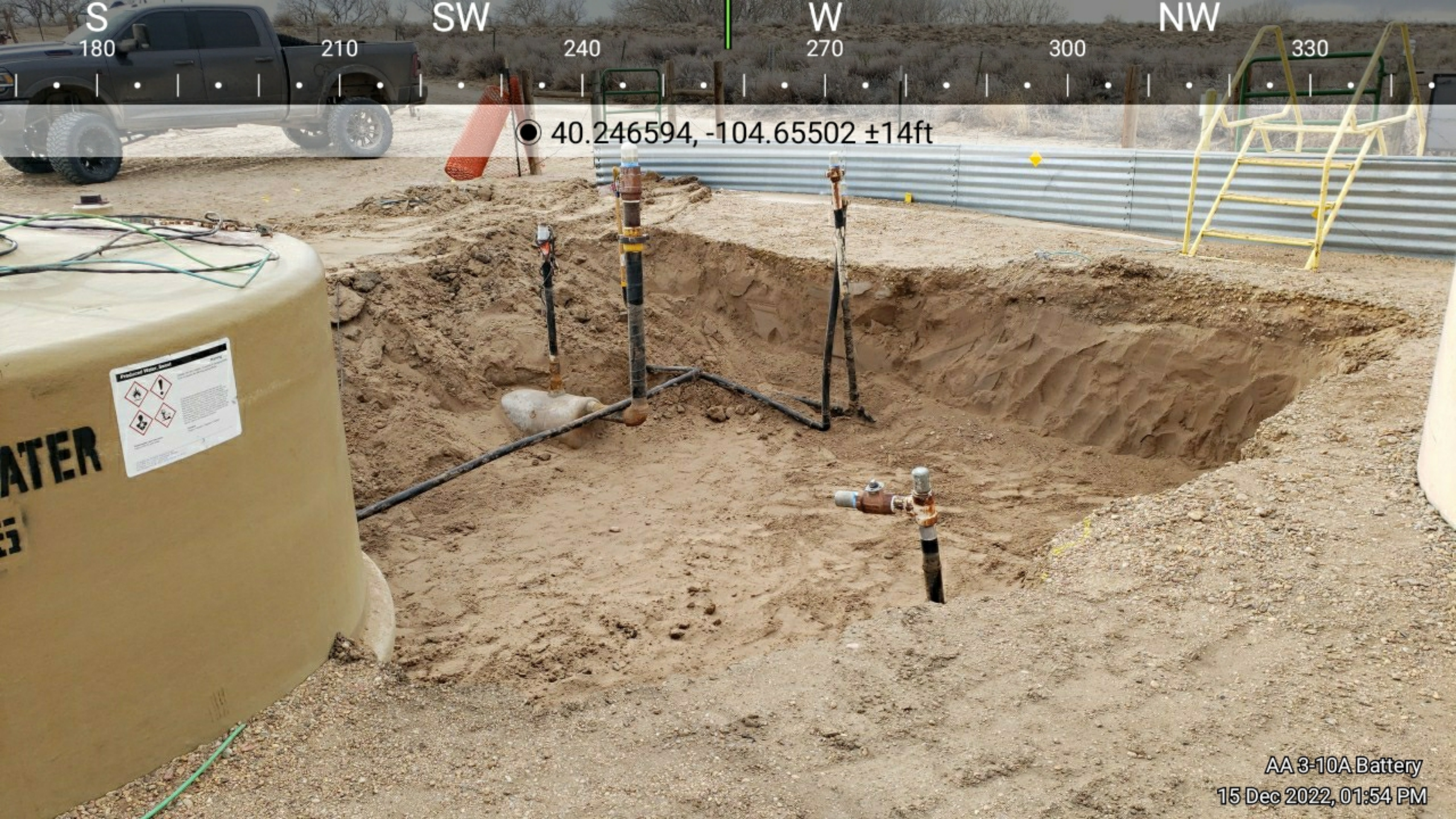

● 40.246594, -104.65502 ±14ft

AA 3-10A Battery
15 Dec 2022, 01:54 PM