

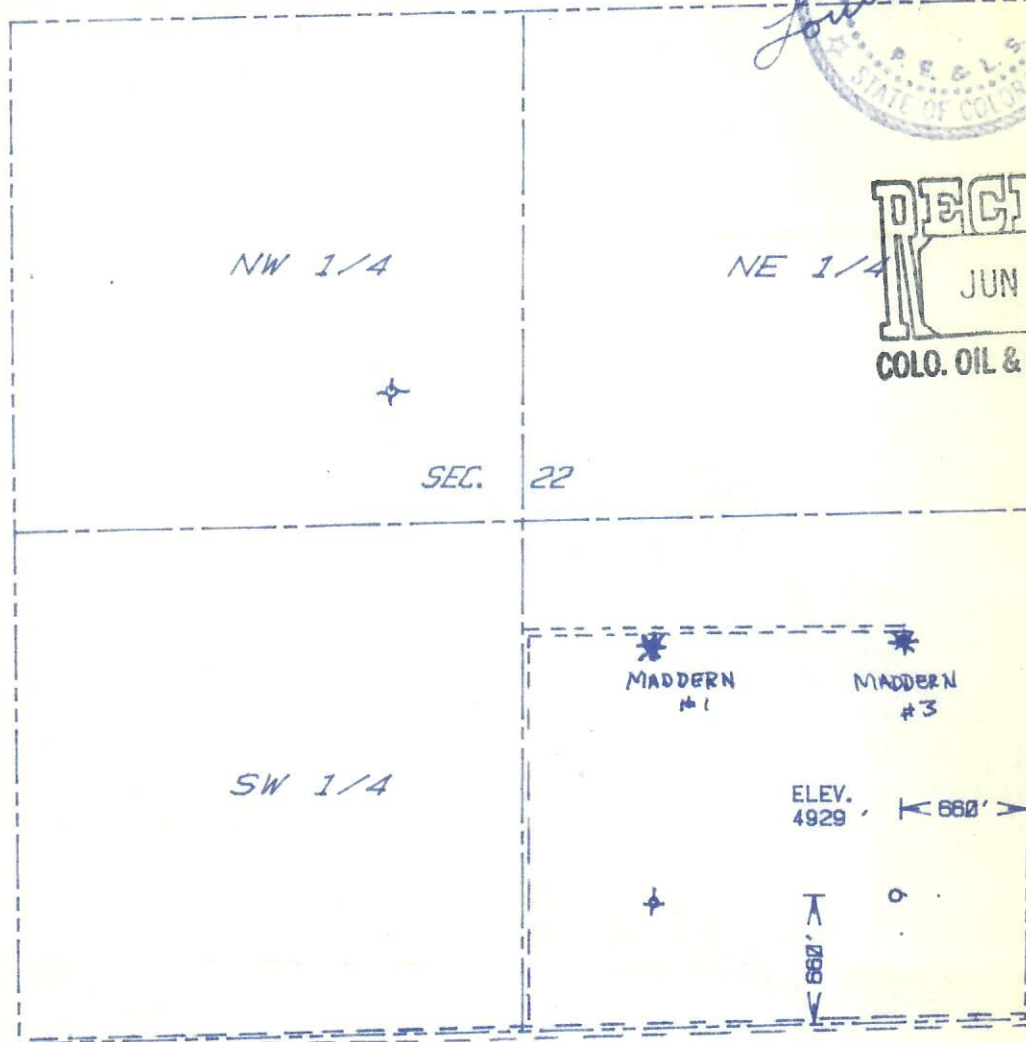

THE ATTACHED PLAT IS AN ACCURATE REPRESENTATION SHOWING THE LOCATION OF A PROPOSED WELL. THIS LOCATION MAY BE DESCRIBED AS A POINT 660 FEET NORTH OF THE SOUTH LINE, AND 660 FEET WEST OF THE EAST LINE OF SECTION 22, TOWNSHIP 3 S RANGE 58 W OF THE 6th P.M., ADAMS COUNTY, COLORADO. THE SURFACE ELEVATION AT THIS POINT IS 4929 FEET m.s.l.

Louis B. Harmon
LOUIS B. HARMON
REGISTERED
P.E. & L.S.
STATE OF COLORADO



RECEIVED
JUN 29 1987
COLO. OIL & GAS CONS. COMM.

2 1/2 miles
South to US 38
East of M.P. 12
SCALE 1"=1000'

- SURVEYED POINT
- ✕ REFERENCE STAKE (200 'S, 200 'E)
- SE 1/4 SEC. 22 , T 3 S , R 58 W

HARMON
ENGINEERING
SERVICES

MADDERN #4

NATIONAL CO-OP REFINERY ASSN.

ADAMS CO., COLORADO 20 JUNE 1987