

# Wellhead Closure Checklist

## COGCC Rule 911.a.(4) Environmental Site Closure Assessment Field Form

Additional attachments (optional):		Pit Closure		Tank Battery Closure		Flowline Closure 4-12-22	Partially Buried Vault Closure
Site Name & COGCC Facility Number: WALKER #4-25		Date: 4-12-22					Remediation Project #: 21727
Associated Wells: 05-123-24666		Age of Site: YEARS					Number of Photos Attached: 1
Location: (GPS coordinates of wellhead or southeastern most wellhead for multiple) 40.345010, -104.672500							Estimated Facility Size (acres):
General Condition of Site: (General observations regarding housekeeping, corrosion, waste management, etc.) GOOD							
USCS Soil Type: SW				Estimated Depth to Groundwater: ~10-12'			
Hydrocarbon Impacted Soils / Spills: (Note estimated size and if impact appears to be surficial or extends to an unknown depth) NONE OBSERVED							
Salt Crusted Soils or Impacted Vegetation: (Note estimated size and if impact appears to be surficial or extends to an unknown depth) NONE OBSERVED							
<b>Wellhead(s)</b>							
Well API	05-123-24666						
Age	YEARS						
Condition of surface around wellhead	GOOD - PER CREW						
PID Readings	NA - EXCAVATED UPON ARRIVAL						
Condition of subsurface (solvents present)	GOOD						
PID Readings	0.4	0.4	0.4	0.3	0.5		
Sample taken? Location/Sample ID#	WH-SS-01	WH-SS-02	WH-SS-03	WH-SS-04	WH-FS-01		
Photo Number(s)	SEE PHOTOLOG						
Other observations regarding wellheads: WELL CASING CUT/CAPPED FOLLOWING ASSESSMENT							
<b>Summary</b>							
Was impacted soil identified? <input checked="" type="radio"/> No      Yes - less than 10 cubic yards      Yes - more than 10 cubic yards							
Total number of samples field screened: 5				Total number of samples collected: 5			
Highest PID Reading: 0.5				Total number of samples submitted to lab for analysis: 1			
If more than 10 cubic yards of impacted soil were observed:							
Vertical extent: N/A				Estimated spill volume:			
Lateral extent:				Volume of soil removed:			
Is additional investigation required?							
Was groundwater encountered during the investigation? <input checked="" type="radio"/> No      Yes - not impacted or in contact with impacted soils      Yes - groundwater impacted and/or in contact with impacted soils							
Measured depth to groundwater:				Was remedial groundwater removal conducted?      Yes      No			
Date Groundwater was encountered:				Commencement date of removal:			
Sheen on groundwater?      Yes      No				Volume of groundwater removed prior to sampling:			
Free product observed?      Yes      No				Volume of groundwater removed post sampling:			
Total number of samples collected:				Total Volume of groundwater removed:			
Total number of samples submitted to lab for analysis:							

<b>Flowline Closure Checklist</b> <b>COGCC Rule 911.a.(4) Environmental Site Closure Assessment Field Form</b>							
Additional Attachments:		Tank Battery Closure		Wellhead Closure	4-12-22	Pit Closure	
Site Name & COGCC Facility Number: <b>WALKER #4-25</b>		Date: <b>4-12-22</b>				Partially Buried Vault Closure	
Associated Wells: <b>05-123-24666</b>		Age of Site: <b>YEARS</b>				Remediation Project #: <b>21727</b>	
						Number of Photos Attached: <b>1</b>	
Starting point: (GPS coordinates and descriptions) <b>40.345008, -104.672498 AT WELL</b>							
End point: (GPS coordinates and descriptions) <b>40.343584, -104.672859 AT SEPARATOR</b>							
USCS Soil Type: <b>SW</b>				Estimated Depth to Groundwater: <b>~ 10-12'</b>			
Hydrocarbon Impacted Soils / Spills: (Note estimated size and if impact appears to be surficial or extends to an unknown depth) <b>NONE OBSERVED</b>							
Salt Crusted Soils or Impacted Vegetation: (Note estimated size and if impact appears to be surficial or extends to an unknown depth) <b>NONE OBSERVED</b>							
Flowlines							
Flowline type	<b>O, S, W</b>						
Depth	<b>~ 4'</b>						
Age	<b>YEARS</b>						
Length	<b>~ 525'</b>						
Construction Material	<b>STEEL</b>						
Were flowlines pulled?	<b>NO - ABANDONED IN PLACE</b>						
Visual Integrity of lines	<b>GOOD - PER INTEGRITY TEST</b>						
Visual impacts if trenched	<b>N/A</b>						
PID Readings if trenched	<b>0.7</b>						
Sample taken? Location/Sample ID#	<b>FL-SS-01</b>						
Photo Number(s)	<b>SEE PHOTO 106</b>						
Other observations regarding on location flowlines: <b>FLOWLINE ABANDONED IN PLACE. PT B. (2 SEP) ASSESSED.</b>							
Summary							
Was impacted soil identified? <div style="display: flex; justify-content: space-between;"> <span><input checked="" type="radio"/> No</span> <span>Yes - less than 10 cubic yards</span> <span>Yes - more than 10 cubic yards</span> </div>							
Total number of samples field screened: <b>1</b>				Total number of samples collected: <b>1</b>			
Highest PID Reading: <b>0.7</b>				Total number of samples submitted to lab for analysis: <b>1</b>			
If more than 10 cubic yards of impacted soil were observed:							
Vertical extent:				Estimated spill volume:			
Lateral extent: <b>N/A</b>				Volume of soil removed:			
Is additional investigation required?							
Was groundwater encountered during the investigation? <div style="display: flex; justify-content: space-between;"> <span><input checked="" type="radio"/> No</span> <span>Yes - not impacted or in contact with impacted soils</span> <span>Yes - groundwater impacted and/or in contact with impacted soils</span> </div>							
Measured depth to groundwater:				Was remedial groundwater removal conducted? Yes    No			
Date Groundwater was encountered:				Commencement date of removal:			
Seen on groundwater? Yes    No				Volume of groundwater removed prior to sampling:			
Free product observed? Yes    No				Volume of groundwater removed post sampling:			
Total number of samples collected:				Total Volume of groundwater removed:			
Total number of samples submitted to lab for analysis:							



## **FIGURES**

**Figure 1: Topographic Site Location Map**

**Figure 2: Aerial Site Location Map**

**Figure 3: Soil Analytical Map**

**Figure 4: Polycyclic Aromatic Hydrocarbons Map**

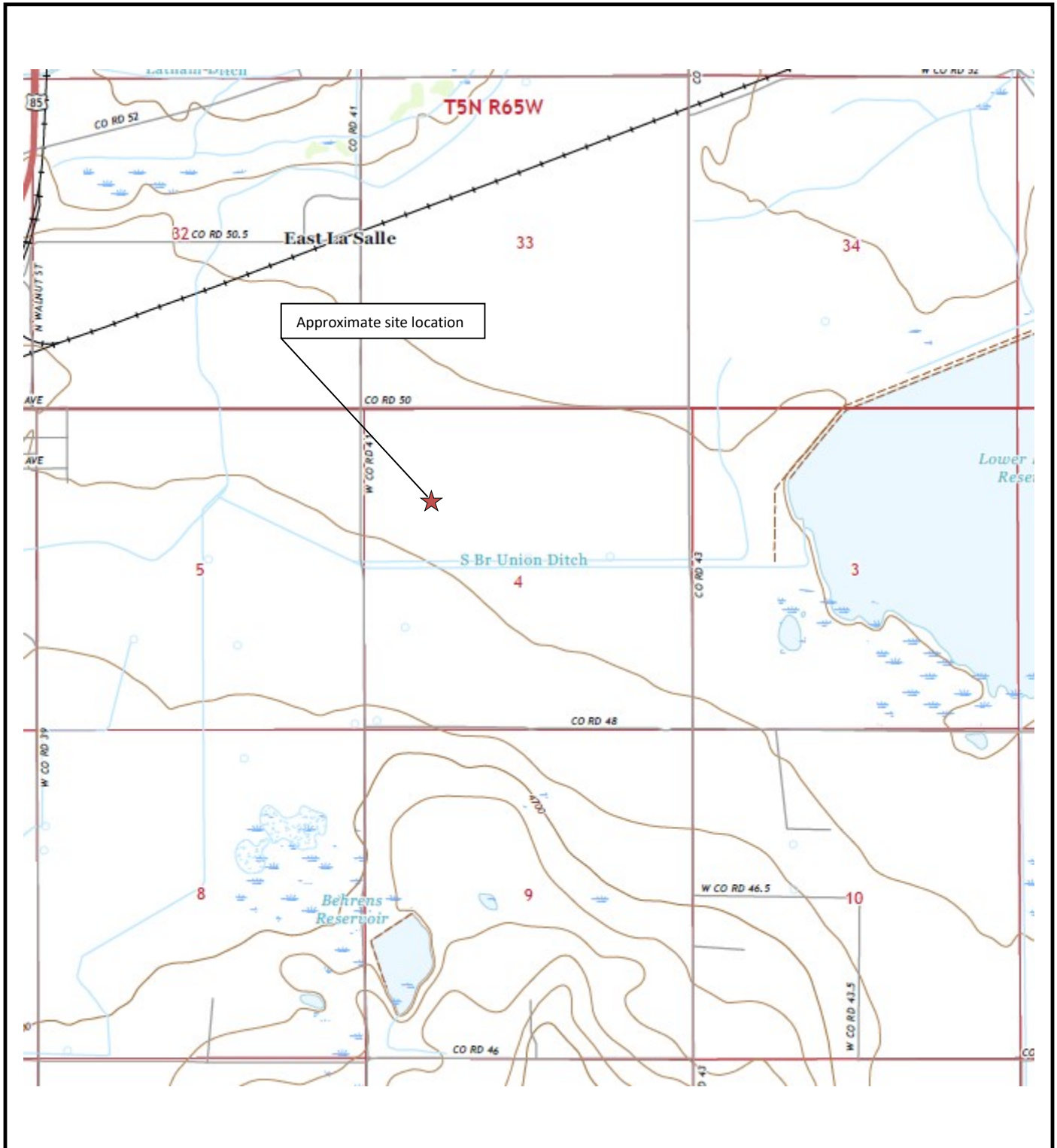

**Topographic Site Location Map**

Walker #4-25  
 Closure Assessment  
 40.345010 / -104.672500  
 SE¼ NW¼ SEC.4 T4N R65W 6PM  
 Weld County, Colorado  
 API # 05-123-24666  
 Remediation # 21727



**EAGLE**  
 ENVIRONMENTAL  
 CONSULTING, INC.

Source: USGS 7.5 Minute Topographic  
 Map, La Salle, CO Quadrangle 2022

**Figure 1**



#### LEGEND

- FORMER WALKER #4-25 WELLHEAD (PLUGGED AND ABANDONED)
- ASSOCIATED SEPARATOR
- APPROXIMATE FLOWLINE LOCATION (ABANDONED IN PLACE)

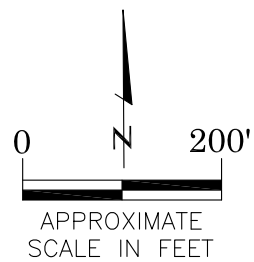

AERIAL SITE LOCATION MAP  
 WALKER #4-25  
 CLOSURE ASSESSMENT  
 40.345010 / -104.672500  
 SE $\frac{1}{4}$  NW $\frac{1}{4}$  SEC.4 T4N R65W 6PM  
 WELD COUNTY, COLORADO  
 API # 05-123-24666  
 REMEDIATION # 21727

DATE: 05/05/22

FIG. NO.  
2

DRAWN BY:  
ER



**EAGLE**  
 ENVIRONMENTAL  
 CONSULTING, INC.  
 8000 W 44th Ave, Wheat Ridge, CO 80033  
 Ph: 303-433-0479 • F: 303-325-5449

# LEGEND

- WELLHEAD ASSESSMENT BOUNDARIES
- APPROXIMATE FLOWLINE LOCATION (ABANDONED IN PLACE)
- SS-02 APPROXIMATE LOCATION OF SOIL SAMPLES FIELD SCREENED, ONLY, WITH PHOTOIONIZATION DETECTOR
- SS-02 APPROXIMATE LOCATION OF SOIL SAMPLES SUBMITTED FOR LABORATORY ANALYSIS

## PARAMETERS

SAMPLE LOCATION  
DATE  
DEPTH (FEET)  
B = BENZENE (mg/kg)  
T = TOLUENE (mg/kg)  
E = ETHYLBENZENE (mg/kg)  
X = TOTAL XYLENES (mg/kg)  
G = TPH-GRO (mg/kg)  
D = TPH-DRO (mg/kg)  
R = TPH-RRO (mg/kg)  
1,2,4-TMB = 1,2,4 TRIMETHYLBENZENE (mg/kg)  
1,3,5-TMB = 1,3,5 TRIMETHYLBENZENE (mg/kg)  
Brn= BORON (mg/L)  
EC = SPECIFIC CONDUCTANCE (mmhos/cm)  
SAR= SODIUM ADSORPTION RATIO  
pH = pH (pH UNITS)

mg/kg = MILLIGRAMS PER KILOGRAM  
mg/L = MILLIGRAMS PER LITER  
mmhos/cm = MILLIMHOS PER CENTIMETER

TPH-GRO = TOTAL PETROLEUM HYDROCARBONS - GASOLINE RANGE ORGANICS  
TPH-DRO = TOTAL PETROLEUM HYDROCARBONS - DIESEL RANGE ORGANICS  
TPH-RRO = TOTAL PETROLEUM HYDROCARBONS - RESIDUAL RANGE ORGANICS

NOTES:  
VALUES PRESENTED WITH A LESS THAN SYMBOL (<) DID NOT CONTAIN CONCENTRATIONS AT OR ABOVE LABORATORY DETECTION LIMITS.

VALUES PRESENTED IN **BOLD** EXCEED COGCC TABLE 915-1 REGULATORY LIMITS.

COGCC = COLORADO OIL AND GAS CONSERVATION COMMISSION

## SOIL ANALYTICAL MAP

WALKER #4-25  
CLOSURE ASSESSMENT  
40.345010 / -104.672500  
SE 1/4 SEC.4 T4N R65W 6PM  
WELD COUNTY, COLORADO  
API # 05-123-24666  
REMEDATION # 21727

DATE:  
05/05/22  
DRAWN BY:  
ER  
FIG.  
NO. 3

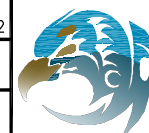

**EAGLE**  
ENVIRONMENTAL  
CONSULTING, INC.  
8000 W 44th Ave, Wheat Ridge, CO 80033  
Ph: 303-433-0479 • F: 303-325-5449

WH-SS-01  
WH-FS-01  
WH-SS-04  
WH-SS-02  
WH-SS-03

WH-FS-01@7'  
04/12/22  
7'  
B = <0.00200  
T = <0.00200  
E = <0.00200  
X = <0.00200  
G = <0.200  
D = <25.0  
R = <100  
1,2,4-TMB = <0.00200  
1,3,5-TMB = <0.00200  
Brn= 0.119  
EC = 0.900  
SAR= 3.04  
pH = 7.99

FL-SS-01@4'  
04/12/22  
4'  
B = <0.00200  
T = <0.00200  
E = <0.00200  
X = <0.00200  
G = <0.200  
D = <25.0  
R = <100  
1,2,4-TMB = <0.00200  
1,3,5-TMB = <0.00200  
Brn= 0.141  
EC = 0.280  
SAR= 0.221  
pH = 7.77

FL-SS-01

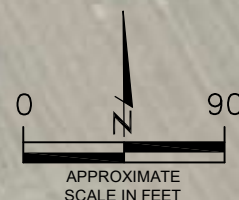

# LEGEND

- WELLHEAD ASSESSMENT BOUNDARIES
- APPROXIMATE FLOWLINE LOCATION (ABANDONED IN PLACE)
- SS-02 APPROXIMATE LOCATION OF SOIL SAMPLES FIELD SCREENED, ONLY, WITH PHOTOIONIZATION DETECTOR
- SS-02 APPROXIMATE LOCATION OF SOIL SAMPLES SUBMITTED FOR LABORATORY ANALYSIS

## PARAMETERS

SAMPLE LOCATION  
DATE SAMPLE COLLECTED  
APPROXIMATE DEPTH

POLYCYCLIC AROMATIC HYDROCARBONS (PAHs) (mg/kg)

mg/kg = MILLIGRAMS PER KILOGRAM

ND = NON-DETECT

## NOTES:

VALUES PRESENTED WITH A LESS THAN SYMBOL (<) DID NOT CONTAIN CONCENTRATIONS AT OR ABOVE LABORATORY DETECTION LIMITS.

VALUES PRESENTED IN **BOLD** EXCEED COGCC TABLE 915-1 REGULATORY LIMITS.

COGCC = COLORADO OIL AND GAS CONSERVATION COMMISSION

## POLYCYCLIC AROMATIC HYDROCARBONS MAP

WALKER #4-25  
CLOSURE ASSESSMENT  
40.345010 / -104.672500  
SE 1/4 NW 1/4 SEC. 4 T4N R65W 6PM  
WELD COUNTY, COLORADO  
API # 05-123-24666  
REMEDIAL # 21727

DATE:  
05/05/22  
DRAWN BY:  
ER

FIG.  
NO. 4



**EAGLE**  
ENVIRONMENTAL  
CONSULTING, INC.  
8000 W 44th Ave, Wheat Ridge, CO 80033  
Ph: 303-433-0479 • F: 303-325-5449

WH-SS-01  
WH-FS-01  
WH-SS-02  
WH-SS-03  
WH-SS-04

WH-FS-01@7'  
04/12/22  
7'  
ND = <0.00067  
1-Methylnaphthalene = ND  
2-Methylnaphthalene = ND  
Acenaphthene = ND  
Anthracene = ND  
Benzo(a)anthracene = ND  
Benzo(a)pyrene = ND  
Benzo(b)fluoranthene = ND  
Benzo(k)fluoranthene = ND  
Chrysene = ND  
Dibenzo(a,h)anthracene = ND  
Fluoranthene = ND  
Fluorene = ND  
Indeno(1,2,3-CD)pyrene = ND  
Naphthalene = ND  
Pyrene = ND

FL-SS-01@4'  
04/12/22  
4'  
ND = <0.00067  
1-Methylnaphthalene = ND  
2-Methylnaphthalene = ND  
Acenaphthene = ND  
Anthracene = ND  
Benzo(a)anthracene = 0.000576  
Benzo(a)pyrene = 0.00133  
Benzo(b)fluoranthene = 0.00096  
Benzo(k)fluoranthene = 0.000609  
Chrysene = 0.00103  
Dibenzo(a,h)anthracene = ND  
Fluoranthene = 0.00131  
Fluorene = ND  
Indeno(1,2,3-CD)pyrene = ND  
Naphthalene = ND  
Pyrene = 0.00161

FL-SS-01

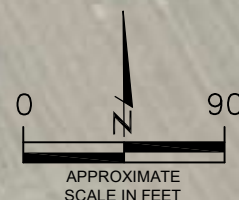

APPROXIMATE  
SCALE IN FEET



## **TABLES**

**Table 1: Photoionization Detector Reading Summary**

**Table 2: Soil Analytical Results Summary**

**TABLE 1**  
**PHOTOIONIZATION DETECTOR READING SUMMARY**  
**WALKER #4-25**  
**CLOSURE ASSESSMENT**  
**40.345010 / -104.672500**  
**SE1/4 NW1/4 SEC.4 T4N R65W 6PM**  
**WELD COUNTY, COLORADO**  
**API # 05-123-24666**  
**REMEDATION # 21727**

Sample Location (Latitude/Longitude)	Date	Approximate Depth (feet)	PID Reading (ppm-v)	Lab Submission (Y/N)
WH-SS-01 @ 6' (40.345022 / -104.672517)	04/12/22	6	0.4	N
WH-SS-02 @ 6' (40.345014 / -104.672498)	04/12/22	6	0.4	N
WH-SS-03 @ 6' (40.345000 / -104.672508)	04/12/22	6	0.4	N
WH-SS-04 @ 6' (40.345012 / -104.672528)	04/12/22	6	0.3	N
WH-FS-01 @ 7' (40.345013 / -104.672513)	04/12/22	7	0.5	Y
FL-SS-01 @ 4' (40.343623 / -104.672872)	04/12/22	4	0.7	Y
(Y/N) = Yes or No ppm-v = parts per million by volume PID = Photoionization Detector				

TABLE 2  
SOIL ANALYTICAL RESULTS SUMMARY  
WALKER #4-25  
CLOSURE ASSESSMENT  
40.345010 / -104.672500  
SE1/4 NW1/4 SEC.4 T4N R65W 6PM  
WELD COUNTY, COLORADO  
API # 05-123-24666  
REMEDATION # 21727

Sample Location		WH-FS-01 @ 7"		FL-SS-01 @ 4'	
(Latitude / Longitude)		(40.345013 / -104.672513)		(40.343623 / -104.672872)	
Sample Date		4/12/2022		4/12/2022	
Sample Depth		7'		4'	
PID Reading (ppm-v)		0.5		0.7	
Regulatory Limits					
Chemical of Concern	Units	COGCC Table 915-1 RSSLs	COGCC Table 915-1 GSSLs		
VOCs					
Benzene	mg/kg	1.2	0.0026	<0.00200	<0.00200
Toluene	mg/kg	490	0.69	<0.00200	<0.00200
Ethylbenzene	mg/kg	5.8	0.78	<0.00200	<0.00200
Total Xylenes	mg/kg	58	9.9	<0.00200	<0.00200
1,2,4-Trimethylbenzene	mg/kg	30	0.0081	<0.00200	<0.00200
1,3,5-Trimethylbenzene	mg/kg	27	0.0087	<0.00200	<0.00200
Total Petroleum Hydrocarbons					
TPH-GRO	mg/kg	500	--	<0.200	<0.200
TPH-DRO	mg/kg	500	--	<25.0	<25.0
TPH-RRO	mg/kg	500	--	<100	<100
Polycyclic Aromatics Hydrocarbons					
1-Methyl-naphthalene	mg/kg	18	0.006	<0.00067	<0.00067
2-Methyl-naphthalene	mg/kg	24	0.019	<0.00067	<0.00067
Acenaphthene	mg/kg	360	0.55	<0.00067	<0.00067
Anthracene	mg/kg	1800	5.8	<0.00067	<0.00067
Benzo(a)-anthracene	mg/kg	1.1	0.011	<0.00067	0.000576
Benzo(a)-pyrene	mg/kg	0.11	0.24	<0.00067	0.00133
Benzo(b)-fluoranthene	mg/kg	1.1	0.3	<0.00067	0.00096
Benzo(k)-fluoranthene	mg/kg	11	2.9	<0.00067	0.000609
Chrysene	mg/kg	110	9	<0.00067	0.00103
Dibenzo(a,h)-anthracene	mg/kg	0.11	0.096	<0.00067	<0.00067
Fluoranthene	mg/kg	240	8.9	<0.00067	0.00131
Fluorene	mg/kg	240	0.54	<0.00067	<0.00067
Indeno(1,2,3-cd)-pyrene	mg/kg	1.1	0.98	<0.00067	<0.00067
Naphthalene	mg/kg	2	0.0038	<0.00067	<0.00067
Pyrene	mg/kg	180	1.3	<0.00067	0.00161
Soil Suitability (Inorganics)					
Boron	mg/L	2	--	0.119	0.141
pH	standard unit	6-8.3	--	7.99	7.77
Sodium Adsorption Ratio (SAR)	--	<6	--	3.04	0.221
Specific Conductance (EC)	mmhos/cm	<4	--	0.900	0.280
COGCC = Colorado Oil and Gas Conservation Commission		VOCs = Volatile Organic Compounds			
mg/kg = milligrams per kilogram		RSSLs = Residential Soil Screening Levels			
mmhos/cm = millimhos per centimeter		GSSLs = Protection of Groundwater Soil Screening Levels			
PID = Photoionization Detector		TPH-GRO = Total Petroleum Hydrocarbons - Gasoline Range Organics			
ppm-v = parts per million by volume		TPH-DRO = Total Petroleum Hydrocarbons - Diesel Range Organics			
mg/L = milligrams per liter		TPH-RRO = Total Petroleum Hydrocarbons - Residual Range Organics			
SAR = Sodium Adsorption Ratio					
Notes:					
Values presented with a less than symbol (<) did not contain concentrations at or above the laboratory reporting limit and/or minimum detection limit					
Values presented in <b>BOLD</b> exceed COGCC Table 915-1 Regulatory Limits.					



## **ATTACHMENT A**

### **Photo Log**

# Walker #4-25

## API # 05-123-24666

## Remediation # 21727

Closure Assessment

April 2022



**EAGLE**  
ENVIRONMENTAL  
CONSULTING, INC.  
8000 W 44th Ave, Wheat Ridge, CO 80033  
Ph: 303-433-0479 • F: 303-325-5449



# Wellhead Excavation – 04/12/22

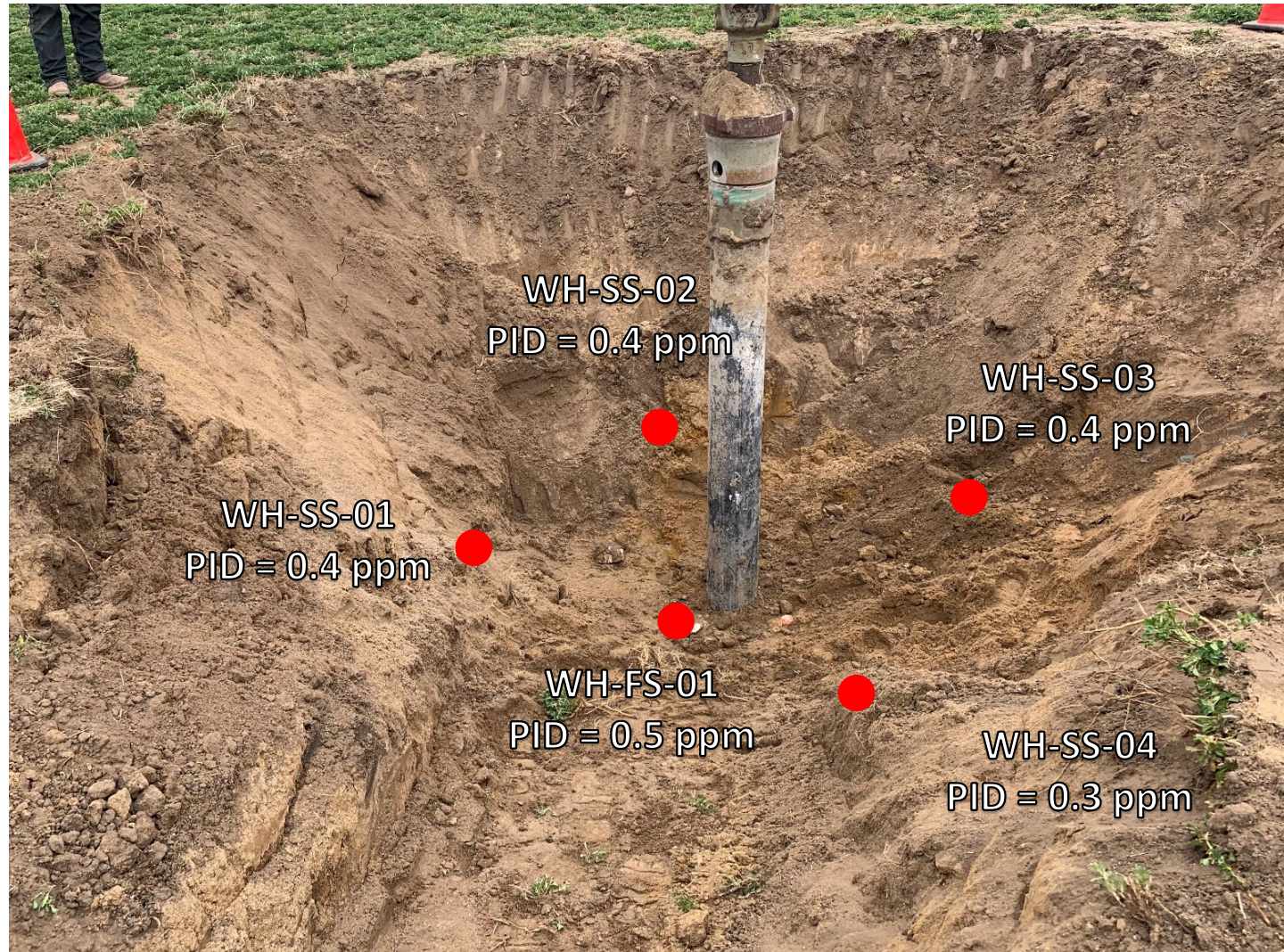

Looking east-southeast

No petroleum hydrocarbon staining or odor observed

# Flowline Assessment – 04/12/22

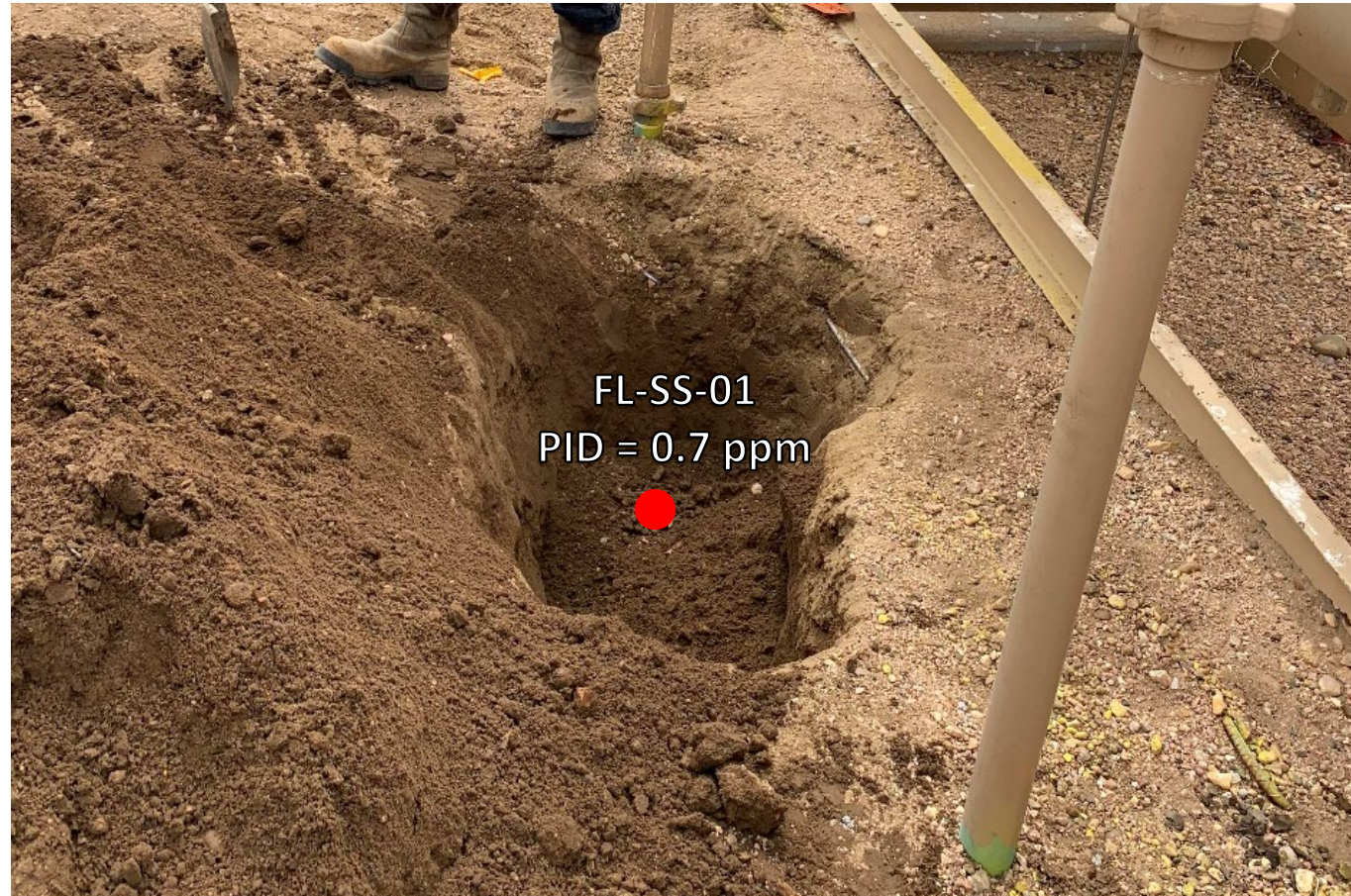

Flowline abandoned in place. Pt. B (at separator) assessed  
No petroleum hydrocarbon staining or odor observed



## **ATTACHMENT B**

### **Laboratory Analytical Report**



April 26, 2022

Eagle Environmental Consulting, Inc.

Martin C Eckert III

8000 W 44th Ave

Wheat Ridge CO 80033

Project Name - Noble - Walker #4-25

Project Number - [none]

Attached are your analytical results for Noble - Walker #4-25 received by Origins Laboratory, Inc. April 12, 2022. This project is associated with Origins project number Y204246-01.

The analytical results in the following report were analyzed under the guidelines of EPA Methods. These methods are identified as follows; "SW" are defined in SW-846, "EPA" are defined in 40CFR part 136 and "SM" are defined in the most current revision of Standard Methods For the Examination of Water and Wastewater.

The analytical results apply specifically to the samples and analyses specified per the attached Chain of Custody. As such, this report shall not be reproduced except in full, without the written approval of Origin's laboratory.

Unless otherwise noted, the analytical results for all soil samples are reported on a wet weight basis. All analytical analyses were performed under NELAP guidelines unless noted by a data qualifier.

Any holding time exceedances, deviations from the method specifications or deviations from Origins Laboratory's Standard Operating Procedures are outlined in the case narrative.

Thank you for selecting Origins for your analytical needs. Please contact us with any questions concerning this report, or if we can help with anything at all.

Origins Laboratory, Inc.  
303.433.1322  
o-squad@oelabinc.com



1725 Elk Place, Denver, CO 80211 | Phone: 303.433.1322 | Fax: 303.265.9645

Eagle Environmental Consulting, Inc.

8000 W 44th Ave

Wheat Ridge CO 80033

Martin C Eckert III

Project Number: [none]

Project: Noble - Walker #4-25

## CROSS REFERENCE REPORT

Sample ID	Laboratory ID	Matrix	Date Sampled	Date Received
WH-FS-01@7'	Y204246-01	Soil	April 12, 2022 13:24	04/12/2022 16:17
FL-SS-01@4'	Y204246-02	Soil	April 12, 2022 13:20	04/12/2022 16:17

Origins Laboratory, Inc.



*The results in this report apply to the samples analyzed in accordance with the chain of custody document. This analytical report must be reproduced in its entirety.*



Eagle Environmental Consulting, Inc.  
8000 W 44th Ave  
Wheat Ridge CO 80033

Martin C Eckert III  
Project Number: [none]  
Project: Noble - Walker #4-25

Origins Laboratory F-012207-01-R1  
Effective Date: 01/09/12

Sample Receipt Checklist

Origins Work Order: 17204246 Client: Eagle  
Client Project ID: Walker 4-25

Checklist Completed by: SG Shipped Via: HD  
Date/time completed: 4/13/22 (UPS, FedEx, Hand Delivered, Pick-up, etc.)  
Airbill #: N/A

Matrix(s) Received: (Check all that apply): ☒ Soil/Solid ☐ Water ☐ Other: \_\_\_\_\_  
Cooler Number/Temperature: 1 3.5 °C 1 °C 1 °C (Describe) \_\_\_\_\_  
Thermometer ID: T004

Requirement Description	Yes	No	N/A	Comments (if any)
If samples require cooling, was the temperature between 0°C to ≤ 6°C <sup>(1)</sup> ?	<input checked="" type="checkbox"/>	<input type="checkbox"/>	<input type="checkbox"/>	
Is there ice present (document if blue ice is used)	<input checked="" type="checkbox"/>	<input type="checkbox"/>	<input type="checkbox"/>	
Are custody seals present on cooler? (if so, document in comments if they are signed and dated, broken or intact)	<input type="checkbox"/>	<input checked="" type="checkbox"/>	<input type="checkbox"/>	
Are custody seals present on each sample container? (if so, document in comments if they are signed and dated, broken or intact)	<input type="checkbox"/>	<input checked="" type="checkbox"/>	<input type="checkbox"/>	
Were all samples received intact <sup>(1)</sup> ?	<input checked="" type="checkbox"/>	<input type="checkbox"/>	<input type="checkbox"/>	
Was adequate sample volume provided <sup>(1)</sup> ?	<input checked="" type="checkbox"/>	<input type="checkbox"/>	<input type="checkbox"/>	
Are short holding time analytes or samples with HTs due within 48 hours present <sup>(1)</sup> ?	<input type="checkbox"/>	<input checked="" type="checkbox"/>	<input type="checkbox"/>	
Is a chain-of-custody (COC) present and filled out completely <sup>(1)</sup> ?	<input checked="" type="checkbox"/>	<input type="checkbox"/>	<input type="checkbox"/>	
Does the COC agree with the number and type of sample bottles received <sup>(1)</sup> ?	<input checked="" type="checkbox"/>	<input type="checkbox"/>	<input type="checkbox"/>	
Do the sample IDs on the bottle labels match the COC <sup>(1)</sup> ?	<input checked="" type="checkbox"/>	<input type="checkbox"/>	<input type="checkbox"/>	
Is the COC properly relinquished by the client with date and time recorded <sup>(1)</sup> ?	<input checked="" type="checkbox"/>	<input type="checkbox"/>	<input type="checkbox"/>	
For volatiles in water – is there headspace (> ¼ inch bubble) present? If yes, contact client and note in narrative.	<input type="checkbox"/>	<input type="checkbox"/>	<input checked="" type="checkbox"/>	
Are samples preserved that require preservation and was it checked <sup>(1)</sup> ? (note ID of confirmation instrument used in comments) / (preservation is not confirmed for subcontracted analyses in order to insure sample integrity)/(pH <2 for samples preserved with HNO <sub>3</sub> , HCL, H <sub>2</sub> SO <sub>4</sub> ) / (pH >10 for samples preserved with NaAsO <sub>2</sub> +NaOH, ZnAc+NaOH)	<input type="checkbox"/>	<input type="checkbox"/>	<input checked="" type="checkbox"/>	
Additional Comments (if any):				

<sup>(1)</sup>If NO, then contact the client before proceeding with analysis and note date/time and person contacted as well as the corrective action to in the additional comments (above) and the case narrative.

Reviewed by (Project Manager) JB

4-14-22  
Date/Time Reviewed

Origins Laboratory, Inc.

*J. Bynon*

The results in this report apply to the samples analyzed in accordance with the chain of custody document. This analytical report must be reproduced in its entirety.

Eagle Environmental Consulting, Inc.  
8000 W 44th Ave  
Wheat Ridge CO 80033

Martin C Eckert III  
Project Number: [none]  
Project: Noble - Walker #4-25

WH-FS-01@7'

4/12/2022 1:24:00PM

Analyte	Result	Min Detection Limit	Reporting Limit	Units	Dilution	Batch	Prepared	Analyzed	Notes
---------	--------	---------------------	-----------------	-------	----------	-------	----------	----------	-------

Origins Laboratory, Inc.  
Y204246-01 (Soil)

## Boron (DTPA Sorbitol)

Boron	0.119	0.0995	mg/L	1	B2D1410	04/14/2022	04/15/2022	
-------	-------	--------	------	---	---------	------------	------------	--

## DRO/ORO by EPA 8015D

Diesel (C10-C28)	ND	25.0	mg/kg	1	B2D1405	04/14/2022	04/23/2022	U
Residual Range Organics (C28-C40)	ND	100	"	"	"	"	"	U

Surrogate: o-Terphenyl	90.1 %	50-150			"	"	"	
------------------------	--------	--------	--	--	---	---	---	--

## GBTEX+TMBs by 8260D

1,2,4-Trimethylbenzene	ND	0.00200	mg/kg	1	B2D1328	04/13/2022	04/17/2022	U
1,3,5-Trimethylbenzene	ND	0.00200	"	"	"	"	"	U
Benzene	ND	0.00200	"	"	"	"	"	U
Ethylbenzene	ND	0.00200	"	"	"	"	"	U
Toluene	ND	0.00200	"	"	"	"	"	U
Xylenes, total	ND	0.00200	"	"	"	"	"	U
Gasoline Range Hydrocarbons	ND	0.200	"	"	"	"	"	U

Surrogate: 1,2-Dichloroethane-d4	108 %	70-130			"	"	"	
----------------------------------	-------	--------	--	--	---	---	---	--

Origins Laboratory, Inc.



The results in this report apply to the samples analyzed in accordance with the chain of custody document. This analytical report must be reproduced in its entirety.

Eagle Environmental Consulting, Inc.  
8000 W 44th Ave  
Wheat Ridge CO 80033

Martin C Eckert III  
Project Number: [none]  
Project: Noble - Walker #4-25

WH-FS-01@7'

4/12/2022 1:24:00PM

Analyte	Result	Min Detection Limit	Reporting Limit	Units	Dilution	Batch	Prepared	Analyzed	Notes
---------	--------	---------------------	-----------------	-------	----------	-------	----------	----------	-------

Origins Laboratory, Inc.  
Y204246-01 (Soil)

## GBTEX+TMBs by 8260D

Surrogate: Toluene-d8	96.4 %	70-130	B2D13 28	04/13/2022	04/17/2022
Surrogate: 4-Bromofluorobenzene	97.2 %	70-130	"	"	"

## Metals by Saturated Paste by EPA 6010

Calcium	2.03	0.499	meq/L	10	[CALC]	04/13/2022	04/14/2022
Magnesium	1.69	0.823	"	"	"	"	"
Sodium	4.15	0.435	"	"	"	"	"

## PAH by 8270D SIM

1-Methylnaphthalene	ND	0.000364	0.00067	mg/Kg	1	L611114	04/15/2022	04/18/2022
2-Methylnaphthalene	ND	0.000645	0.00067	"	"	"	"	"
Acenaphthene	ND	0.000304	0.00067	"	"	"	"	"
Anthracene	ND	0.000334	0.00067	"	"	"	"	"
Benzo(a)anthracene	ND	0.000493	0.00067	"	"	"	"	"
Benzo(a)pyrene	ND	0.000468	0.00067	"	"	"	"	"
Benzo(b)fluoranthene	ND	0.000585	0.00067	"	"	"	"	"
Benzo(k)fluoranthene	ND	0.000437	0.00067	"	"	"	"	"
Chrysene	ND	0.000624	0.00067	"	"	"	"	"
Dibenz(a,h)anthracene	ND	0.000614	0.00067	"	"	"	"	"
Fluoranthene	ND	0.000394	0.00067	"	"	"	"	"

Origins Laboratory, Inc.



The results in this report apply to the samples analyzed in accordance with the chain of custody document. This analytical report must be reproduced in its entirety.

Eagle Environmental Consulting, Inc.  
8000 W 44th Ave  
Wheat Ridge CO 80033

Martin C Eckert III  
Project Number: [none]  
Project: Noble - Walker #4-25

WH-FS-01@7'

4/12/2022 1:24:00PM

Analyte	Result	Min Detection Limit	Reporting Limit	Units	Dilution	Batch	Prepared	Analyzed	Notes
---------	--------	---------------------	-----------------	-------	----------	-------	----------	----------	-------

Waypoint Analytical, Inc.  
Y204246-01 (Soil)

## PAH by 8270D SIM

Fluorene	ND	0.000286	0.00067	mg/Kg	1	L611114	04/15/2022	04/18/2022
Indeno(1,2,3-cd)pyrene	ND	0.000627	0.00067	"	"	"	"	"
Naphthalene	ND	0.000484	0.00067	"	"	"	"	"
Pyrene	ND	0.000643	0.00067	"	"	"	"	"

Surrogate: 2-Fluorobiphenyl	46.8 %	33-115	"	"	"
Surrogate: 4-Terphenyl-d14	67.1 %	33-122	"	"	"
Surrogate: Nitrobenzene-d5	56.9 %	29-110	"	"	"

## pH in Soil by 9045D

pH	7.99	pH Units	1	B2D1327	04/13/2022	04/14/2022
----	------	----------	---	---------	------------	------------

## SAR by 20B Saturated Paste

SAR	3.04	SAR	1	B2D1318	04/13/2022	04/14/2022
-----	------	-----	---	---------	------------	------------

## Specific Conductance Mod. 9050A

Specific Conductance (EC)	0.900	0.00500	mmhos/cm	1	B2D1323	04/13/2022	04/14/2022
---------------------------	-------	---------	----------	---	---------	------------	------------

Origins Laboratory, Inc.



The results in this report apply to the samples analyzed in accordance with the chain of custody document. This analytical report must be reproduced in its entirety.

Eagle Environmental Consulting, Inc.  
8000 W 44th Ave  
Wheat Ridge CO 80033

Martin C Eckert III  
Project Number: [none]  
Project: Noble - Walker #4-25

FL-SS-01@4'  
4/12/2022 1:20:00PM

Analyte	Result	Min Detection Limit	Reporting Limit	Units	Dilution	Batch	Prepared	Analyzed	Notes
---------	--------	---------------------	-----------------	-------	----------	-------	----------	----------	-------

**Origins Laboratory, Inc.**  
**Y204246-02 (Soil)**

**Boron (DTPA Sorbitol)**

Boron	0.141	0.100	mg/L	1	B2D1410	04/14/2022	04/15/2022	
-------	-------	-------	------	---	---------	------------	------------	--

**DRO/ORO by EPA 8015D**

Diesel (C10-C28)	ND	25.0	mg/kg	1	B2D1405	04/14/2022	04/23/2022	U
Residual Range Organics (C28-C40)	ND	100	"	"	"	"	"	U

Surrogate: o-Terphenyl	90.3 %	50-150	"	"	"	"	"
------------------------	--------	--------	---	---	---	---	---

**GBTEX+TMBs by 8260D**

1,2,4-Trimethylbenzene	ND	0.00200	mg/kg	1	B2D1328	04/13/2022	04/17/2022	U
1,3,5-Trimethylbenzene	ND	0.00200	"	"	"	"	"	U
Benzene	ND	0.00200	"	"	"	"	"	U
Ethylbenzene	ND	0.00200	"	"	"	"	"	U
Toluene	ND	0.00200	"	"	"	"	"	U
Xylenes, total	ND	0.00200	"	"	"	"	"	U
Gasoline Range Hydrocarbons	ND	0.200	"	"	"	"	"	U

Surrogate: 1,2-Dichloroethane-d4	111 %	70-130	"	"	"	"	"
----------------------------------	-------	--------	---	---	---	---	---

Origins Laboratory, Inc.



The results in this report apply to the samples analyzed in accordance with the chain of custody document. This analytical report must be reproduced in its entirety.

Eagle Environmental Consulting, Inc.  
8000 W 44th Ave  
Wheat Ridge CO 80033

Martin C Eckert III  
Project Number: [none]  
Project: Noble - Walker #4-25

FL-SS-01@4'

4/12/2022 1:20:00PM

Analyte	Result	Min Detection Limit	Reporting Limit	Units	Dilution	Batch	Prepared	Analyzed	Notes
---------	--------	---------------------	-----------------	-------	----------	-------	----------	----------	-------

Origins Laboratory, Inc.  
Y204246-02 (Soil)

## GBTEX+TMBs by 8260D

Surrogate: Toluene-d8	95.4 %	70-130	B2D13 28	04/13/2022	04/17/2022
Surrogate: 4-Bromofluorobenzene	96.7 %	70-130	"	"	"

## Metals by Saturated Paste by EPA 6010

Calcium	1.49	0.499	meq/L	10	[CALC]	04/13/2022	04/14/2022
Magnesium	ND	0.823	"	"	"	"	"
Sodium	ND	0.435	"	"	"	"	"

## PAH by 8270D SIM

1-Methylnaphthalene	ND	0.000364	0.00067	mg/Kg	1	L611114	04/15/2022	04/18/2022	
2-Methylnaphthalene	ND	0.000645	0.00067	"	"	"	"	"	
Acenaphthene	ND	0.000304	0.00067	"	"	"	"	"	
Anthracene	ND	0.000334	0.00067	"	"	"	"	"	
Benzo(a)anthracene	0.000576	0.000493	0.00067	"	"	"	"	"	J
Benzo(a)pyrene	0.00133	0.000468	0.00067	"	"	"	"	"	
Benzo(b)fluoranthene	0.00096	0.000585	0.00067	"	"	"	"	"	
Benzo(k)fluoranthene	0.000609	0.000437	0.00067	"	"	"	"	"	JB
Chrysene	0.00103	0.000624	0.00067	"	"	"	"	"	
Dibenz(a,h)anthracene	ND	0.000614	0.00067	"	"	"	"	"	
Fluoranthene	0.00131	0.000394	0.00067	"	"	"	"	"	
Fluorene	ND	0.000286	0.00067	"	"	"	"	"	

Origins Laboratory, Inc.



The results in this report apply to the samples analyzed in accordance with the chain of custody document. This analytical report must be reproduced in its entirety.

Eagle Environmental Consulting, Inc.  
8000 W 44th Ave  
Wheat Ridge CO 80033

Martin C Eckert III  
Project Number: [none]  
Project: Noble - Walker #4-25

FL-SS-01@4'

4/12/2022 1:20:00PM

Analyte	Result	Min Detection Limit	Reporting Limit	Units	Dilution	Batch	Prepared	Analyzed	Notes
---------	--------	---------------------	-----------------	-------	----------	-------	----------	----------	-------

Waypoint Analytical, Inc.  
Y204246-02 (Soil)

## PAH by 8270D SIM

Indeno(1,2,3-cd)pyrene	ND	0.000627	0.00067	mg/Kg	1	L611114	04/15/2022	04/18/2022
Naphthalene	ND	0.000484	0.00067	"	"	"	"	"
Pyrene	0.00161	0.000643	0.00067	"	"	"	"	"

Surrogate: 2-Fluorobiphenyl	47.4 %	33-115	"	"	"
Surrogate: 4-Terphenyl-d14	64.9 %	33-122	"	"	"
Surrogate: Nitrobenzene-d5	55 %	29-110	"	"	"

## pH in Soil by 9045D

pH	7.77	pH Units	1	B2D1327	04/13/2022	04/14/2022
----	------	----------	---	---------	------------	------------

## SAR by 20B Saturated Paste

SAR	0.221	SAR	1	B2D1318	04/13/2022	04/14/2022
-----	-------	-----	---	---------	------------	------------

## Specific Conductance Mod. 9050A

Specific Conductance (EC)	0.280	0.00500	mmhos/cm	1	B2D1323	04/13/2022	04/14/2022
---------------------------	-------	---------	----------	---	---------	------------	------------

Origins Laboratory, Inc.



The results in this report apply to the samples analyzed in accordance with the chain of custody document. This analytical report must be reproduced in its entirety.

Eagle Environmental Consulting, Inc.  
8000 W 44th Ave  
Wheat Ridge CO 80033

Martin C Eckert III  
Project Number: [none]  
Project: Noble - Walker #4-25

**Volatile Organic Compounds by GC/MS SW846 8260D - Quality Control**  
**Origins Laboratory, Inc.**

Analyte	Result	Reporting Limit	Units	Spike Level	Source Result	%REC	%REC Limits	RPD	RPD Limit	Notes
<b>Batch B2D1328 - EPA 5030 (soil)</b>										
<b>Blank (B2D1328-BLK1)</b>					Prepared: 04/13/2022 Analyzed: 04/17/2022					
1,2,4-Trimethylbenzene	ND	0.00200	mg/kg							U
1,3,5-Trimethylbenzene	ND	0.00200	"							U
Benzene	ND	0.00200	"							U
Ethylbenzene	ND	0.00200	"							U
Naphthalene	ND	0.0100	"							U
Toluene	ND	0.00200	"							U
Xylenes, total	ND	0.00200	"							U
Gasoline Range Hydrocarbons	ND	0.200	"							U
Surrogate: 1,2-Dichloroethane-d4	0.13		"	0.125	106		70-130			
Surrogate: Toluene-d8	0.12		"	0.125	97.9		70-130			
Surrogate: 4-Bromofluorobenzene	0.12		"	0.125	96.8		70-130			

Origins Laboratory, Inc.



The results in this report apply to the samples analyzed in accordance with the chain of custody document. This analytical report must be reproduced in its entirety.

Eagle Environmental Consulting, Inc.  
8000 W 44th Ave  
Wheat Ridge CO 80033

Martin C Eckert III  
Project Number: [none]  
Project: Noble - Walker #4-25

**Volatile Organic Compounds by GC/MS SW846 8260D - Quality Control**  
**Origins Laboratory, Inc.**

Analyte	Result	Reporting Limit	Units	Spike Level	Source Result	%REC	%REC Limits	RPD	RPD Limit	Notes
<b>Batch B2D1328 - EPA 5030 (soil)</b>										
<b>LCS (B2D1328-BS1)</b>					Prepared: 04/13/2022 Analyzed: 04/17/2022					
1,2,4-Trimethylbenzene	0.115	0.00200	mg/kg	0.100		115	70-130			
1,3,5-Trimethylbenzene	0.120	0.00200	"	0.100		120	70-130			
Benzene	0.0956	0.00200	"	0.100		95.6	70-130			
Ethylbenzene	0.110	0.00200	"	0.100		110	70-130			
Naphthalene	0.0946	0.0100	"	0.100		94.6	70-130			
Toluene	0.104	0.00200	"	0.100		104	70-130			
o-Xylene	0.106	0.00200	"	0.100		106	70-130			
m,p-Xylene	0.221	0.00400	"	0.200		110	70-130			
Surrogate: 1,2-Dichloroethane-d4	0.13		"	0.125		102	70-130			
Surrogate: Toluene-d8	0.12		"	0.125		97.7	70-130			
Surrogate: 4-Bromofluorobenzene	0.13		"	0.125		101	70-130			

Origins Laboratory, Inc.



The results in this report apply to the samples analyzed in accordance with the chain of custody document. This analytical report must be reproduced in its entirety.

Eagle Environmental Consulting, Inc.  
8000 W 44th Ave  
Wheat Ridge CO 80033

Martin C Eckert III  
Project Number: [none]  
Project: Noble - Walker #4-25

**Volatile Organic Compounds by GC/MS SW846 8260D - Quality Control**  
**Origins Laboratory, Inc.**

Analyte	Result	Reporting Limit	Units	Spike Level	Source Result	%REC	%REC Limits	RPD	RPD Limit	Notes
<b>Batch B2D1328 - EPA 5030 (soil)</b>										
<b>Matrix Spike (B2D1328-MS1)</b>		<b>Source: Y204237-01</b>			Prepared: 04/13/2022 Analyzed: 04/17/2022					
1,2,4-Trimethylbenzene	0.0420	0.00200	mg/kg	0.100	ND	42.0	70-130			QM-07
1,3,5-Trimethylbenzene	0.0419	0.00200	"	0.100	ND	41.9	70-130			QM-07
Benzene	0.0839	0.00200	"	0.100	ND	83.9	70-130			
Ethylbenzene	0.0463	0.00200	"	0.100	ND	46.3	70-130			QM-07
Naphthalene	0.0514	0.0100	"	0.100	ND	51.4	70-130			QM-07
Toluene	0.0816	0.00200	"	0.100	ND	81.6	70-130			
o-Xylene	0.0645	0.00200	"	0.100	ND	64.5	70-130			QM-07
m,p-Xylene	0.125	0.00400	"	0.200	ND	62.5	70-130			QM-07
Surrogate: 1,2-Dichloroethane-d4	0.14		"	0.125		109	70-130			
Surrogate: Toluene-d8	0.12		"	0.125		96.0	70-130			
Surrogate: 4-Bromofluorobenzene	0.12		"	0.125		99.6	70-130			

Origins Laboratory, Inc.



The results in this report apply to the samples analyzed in accordance with the chain of custody document. This analytical report must be reproduced in its entirety.

Eagle Environmental Consulting, Inc.  
8000 W 44th Ave  
Wheat Ridge CO 80033

Martin C Eckert III  
Project Number: [none]  
Project: Noble - Walker #4-25

**Volatile Organic Compounds by GC/MS SW846 8260D - Quality Control**  
**Origins Laboratory, Inc.**

Analyte	Result	Reporting Limit	Units	Spike Level	Source Result	%REC	%REC Limits	RPD	RPD Limit	Notes
<b>Batch B2D1328 - EPA 5030 (soil)</b>										
<b>Matrix Spike Dup (B2D1328-MSD1)</b>		<b>Source: Y204237-01</b>			Prepared: 04/13/2022 Analyzed: 04/17/2022					
1,2,4-Trimethylbenzene	0.0673	0.00200	mg/kg	0.100	ND	67.3	70-130	46.4	20	QM-07
1,3,5-Trimethylbenzene	0.0681	0.00200	"	0.100	ND	68.1	70-130	47.6	20	QM-07
Benzene	0.0845	0.00200	"	0.100	ND	84.5	70-130	0.665	20	
Ethylbenzene	0.0765	0.00200	"	0.100	ND	76.5	70-130	49.1	20	QM-07
Naphthalene	0.0593	0.0100	"	0.100	ND	59.3	70-130	14.2	20	QM-07
Toluene	0.0819	0.00200	"	0.100	ND	81.9	70-130	0.392	20	
o-Xylene	0.0744	0.00200	"	0.100	ND	74.4	70-130	14.2	20	
m,p-Xylene	0.152	0.00400	"	0.200	ND	75.8	70-130	19.3	20	
Surrogate: 1,2-Dichloroethane-d4	0.13		"	0.125		104	70-130			
Surrogate: Toluene-d8	0.12		"	0.125		96.6	70-130			
Surrogate: 4-Bromofluorobenzene	0.12		"	0.125		99.4	70-130			

Origins Laboratory, Inc.



The results in this report apply to the samples analyzed in accordance with the chain of custody document. This analytical report must be reproduced in its entirety.

Eagle Environmental Consulting, Inc.  
8000 W 44th Ave  
Wheat Ridge CO 80033

Martin C Eckert III  
Project Number: [none]  
Project: Noble - Walker #4-25

**Volatile Organic Compounds by GC/MS SW846 8260D - Quality Control**  
**Origins Laboratory, Inc.**

Analyte	Result	Reporting Limit	Units	Spike Level	Source Result	%REC	%REC Limits	RPD	RPD Limit	Notes
Batch B2D1405 - EPA 3550B										
Blank (B2D1405-BLK1)					Prepared: 04/14/2022 Analyzed: 04/25/2022					
Diesel (C10-C28)	ND	25.0	mg/kg							U
Residual Range Organics (C28-C40)	ND	100	"							U
Surrogate: o-Terphenyl	24		"	24.9		94.8	50-150			

Origins Laboratory, Inc.



*The results in this report apply to the samples analyzed in accordance with the chain of custody document. This analytical report must be reproduced in its entirety.*

Eagle Environmental Consulting, Inc.  
8000 W 44th Ave  
Wheat Ridge CO 80033

Martin C Eckert III  
Project Number: [none]  
Project: Noble - Walker #4-25

**Extractable Petroleum Hydrocarbons by 8015D - Quality Control**  
**Origins Laboratory, Inc.**

Analyte	Result	Reporting Limit	Units	Spike Level	Source Result	%REC	%REC Limits	RPD	RPD Limit	Notes
Batch B2D1405 - EPA 3550B										
LCS (B2D1405-BS1)					Prepared: 04/14/2022 Analyzed: 04/25/2022					
Diesel (C10-C28)	1220	50.0	mg/kg	1000		122	70-130			
Residual Range Organics (C28-C40)	1130	200	"	1000		113	70-130			
Surrogate: o-Terphenyl	51		"	49.8		102	50-150			

Origins Laboratory, Inc.



*The results in this report apply to the samples analyzed in accordance with the chain of custody document. This analytical report must be reproduced in its entirety.*

Eagle Environmental Consulting, Inc.  
8000 W 44th Ave  
Wheat Ridge CO 80033

Martin C Eckert III  
Project Number: [none]  
Project: Noble - Walker #4-25

**Extractable Petroleum Hydrocarbons by 8015D - Quality Control**  
**Origins Laboratory, Inc.**

Analyte	Result	Reporting Limit	Units	Spike Level	Source Result	%REC	%REC Limits	RPD	RPD Limit	Notes
---------	--------	-----------------	-------	-------------	---------------	------	-------------	-----	-----------	-------

Batch B2D1405 - EPA 3550B

Matrix Spike (B2D1405-MS1)		Source: Y204237-01			Prepared: 04/14/2022 Analyzed: 04/25/2022					
Diesel (C10-C28)	1230	50.0	mg/kg	1000	ND	123	70-130			
Residual Range Organics (C28-C40)	1110	200	"	1000	ND	111	70-130			
Surrogate: o-Terphenyl	48		"	49.8		97.1	50-150			

Origins Laboratory, Inc.



*The results in this report apply to the samples analyzed in accordance with the chain of custody document. This analytical report must be reproduced in its entirety.*

Eagle Environmental Consulting, Inc.  
8000 W 44th Ave  
Wheat Ridge CO 80033

Martin C Eckert III  
Project Number: [none]  
Project: Noble - Walker #4-25

**Extractable Petroleum Hydrocarbons by 8015D - Quality Control**  
**Origins Laboratory, Inc.**

Analyte	Result	Reporting Limit	Units	Spike Level	Source Result	%REC	%REC Limits	RPD	RPD Limit	Notes
Batch B2D1405 - EPA 3550B										
Matrix Spike Dup (B2D1405-MSD1)		Source: Y204237-01			Prepared: 04/14/2022 Analyzed: 04/25/2022					
Diesel (C10-C28)	1230	50.0	mg/kg	1000	ND	123	70-130	0.626	35	
Residual Range Organics (C28-C40)	1150	200	"	1000	ND	115	70-130	3.17	35	
Surrogate: o-Terphenyl	48		"	49.8		97.0	50-150			

Origins Laboratory, Inc.



*The results in this report apply to the samples analyzed in accordance with the chain of custody document. This analytical report must be reproduced in its entirety.*

Eagle Environmental Consulting, Inc.  
8000 W 44th Ave  
Wheat Ridge CO 80033

Martin C Eckert III  
Project Number: [none]  
Project: Noble - Walker #4-25

## Extractable Petroleum Hydrocarbons by 8015D - Quality Control

### Origins Laboratory, Inc.

Analyte	Result	Reporting Limit	Units	Spike Level	Source Result	%REC	%REC Limits	RPD	RPD Limit	Notes
---------	--------	-----------------	-------	-------------	---------------	------	-------------	-----	-----------	-------

## Saturated Paste - Quality Control

### Origins Laboratory, Inc.

Analyte	Result	Reporting Limit	Units	Spike Level	Source Result	%REC	%REC Limits	RPD	RPD Limit	Notes
---------	--------	-----------------	-------	-------------	---------------	------	-------------	-----	-----------	-------

#### Batch B2D1323 - NO PREP

##### Blank (B2D1323-BLK1)

Prepared: 04/13/2022 Analyzed: 04/14/2022

Specific Conductance (EC) 0.000800 0.00500 mmhos/cm

##### Duplicate (B2D1323-DUP1)

Source: Y204235-02

Prepared: 04/13/2022 Analyzed: 04/14/2022

Specific Conductance (EC) 1.44 0.00500 mmhos/cm 1.28 11.7 25

#### Batch B2D1327 - NO PREP

##### Duplicate (B2D1327-DUP1)

Source: Y204235-02

Prepared: 04/13/2022 Analyzed: 04/14/2022

pH 7.73 pH Units 7.65 1.04 25

Origins Laboratory, Inc.



The results in this report apply to the samples analyzed in accordance with the chain of custody document. This analytical report must be reproduced in its entirety.

Eagle Environmental Consulting, Inc.  
8000 W 44th Ave  
Wheat Ridge CO 80033

Martin C Eckert III  
Project Number: [none]  
Project: Noble - Walker #4-25

**PAH by 8270D SIM - Quality Control**  
**Waypoint Analytical, Inc.**

Analyte	Result	Reporting Limit	Units	Spike Level	Source Result	%REC	%REC Limits	RPD	RPD Limit	Notes
---------	--------	-----------------	-------	-------------	---------------	------	-------------	-----	-----------	-------

**Batch L611114 - 3550B**

MS (L 97814-MS-L611114)		Source: 97814			Prepared: 04/15/2022 Analyzed: 04/18/2022					
Dibenz(a,h)anthracene	0.115	0.00307	mg/Kg	0.166	<0.00307	69.2	30-130			
Pyrene	0.106	0.00322	"	0.166	<0.00322	63.8	30-130			
Naphthalene	0.0902	0.00242	"	0.166	<0.00242	54.3	30-130			
Indeno(1,2,3-cd)pyrene	0.0977	0.00314	"	0.166	<0.00314	58.8	30-130			
Fluoranthene	0.106	0.00197	"	0.166	<0.00197	63.8	30-130			
Chrysene	0.11	0.00312	"	0.166	<0.00312	66.2	30-130			
2-Methylnaphthalene	0.0869	0.00323	"	0.166	<0.00323	52.3	30-130			
1-Methylnaphthalene	0.0934	0.00182	"	0.166	<0.00182	56.2	30-130			
Fluorene	0.102	0.00143	"	0.166	<0.00143	61.4	30-130			
Benzo(k)fluoranthene	0.101	0.00219	"	0.166	<0.00219	60.8	30-130			
Acenaphthene	0.0961	0.00152	"	0.166	<0.00152	57.8	30-130			
Anthracene	0.103	0.00167	"	0.166	<0.00167	62	30-130			
Benzo(a)anthracene	0.11	0.00247	"	0.166	<0.00247	66.2	30-130			
Benzo(a)pyrene	0.107	0.00234	"	0.166	<0.00234	64.4	30-130			
Benzo(b)fluoranthene	0.0858	0.00293	"	0.166	<0.00293	51.6	30-130			
Surrogate: Nitrobenzene-d5	50.6		"	0.332	180	50.6	29-110			
Surrogate: 2-Fluorobiphenyl	46.9		"	0.332	165	46.9	33-115			
Surrogate: 4-Terphenyl-d14	59.9		"	0.332	204	59.9	33-122			

**LCS (LCS-L611114)**

Prepared: 04/15/2022 Analyzed: 04/18/2022

Benzo(a)pyrene	0.106	0.000468	mg/Kg	0.167		63.4	30-130
Naphthalene	0.0879	0.000484	"	0.167		52.6	30-130
Indeno(1,2,3-cd)pyrene	0.0993	0.000627	"	0.167		59.4	30-130
Fluorene	0.0977	0.000286	"	0.167		58.5	30-130
Fluoranthene	0.101	0.000394	"	0.167		60.4	30-130
Dibenz(a,h)anthracene	0.112	0.000614	"	0.167		67	30-130
Pyrene	0.104	0.000643	"	0.167		62.2	30-130

Origins Laboratory, Inc.



The results in this report apply to the samples analyzed in accordance with the chain of custody document. This analytical report must be reproduced in its entirety.

Eagle Environmental Consulting, Inc.  
8000 W 44th Ave  
Wheat Ridge CO 80033

Martin C Eckert III  
Project Number: [none]  
Project: Noble - Walker #4-25

**PAH by 8270D SIM - Quality Control**  
**Waypoint Analytical, Inc.**

Analyte	Result	Reporting Limit	Units	Spike Level	Source Result	%REC	%REC Limits	RPD	RPD Limit	Notes
---------	--------	-----------------	-------	-------------	---------------	------	-------------	-----	-----------	-------

**Batch L611114 - 3550B**

**LCS (LCS-L611114)**

Prepared: 04/15/2022 Analyzed: 04/18/2022

1-Methylnaphthalene	0.0859	0.000364	mg/Kg	0.167		51.4	30-130			
Benzo(b)fluoranthene	0.0876	0.000585	"	0.167		52.4	30-130			
Benzo(a)anthracene	0.105	0.000493	"	0.167		62.8	30-130			
Anthracene	0.0973	0.000334	"	0.167		58.2	30-130			
Acenaphthene	0.0914	0.000304	"	0.167		54.7	30-130			
2-Methylnaphthalene	0.0861	0.000645	"	0.167		51.5	30-130			
Benzo(k)fluoranthene	0.0949	0.000437	"	0.167		56.8	30-130			
Chrysene	0.103	0.000624	"	0.167		61.6	30-130			
Surrogate: Nitrobenzene-d5	57.3		"	0.333		57.3	29-110			
Surrogate: 4-Terphenyl-d14	70.2		"	0.333		70.2	33-122			
Surrogate: 2-Fluorobiphenyl	51.9		"	0.333		51.9	33-115			

**LRB (LRB-L611114)**

Prepared: 04/15/2022 Analyzed: 04/18/2022

Fluoranthene	ND	0.00067	mg/Kg				-			
Fluorene	ND	0.00067	"				-			
Indeno(1,2,3-cd)pyrene	ND	0.00067	"				-			
Naphthalene	ND	0.00067	"				-			
Dibenz(a,h)anthracene	0.00104	0.00067	"				-			*
Pyrene	ND	0.00067	"				-			
Anthracene	ND	0.00067	"				-			
Chrysene	ND	0.00067	"				-			
Benzo(k)fluoranthene	0.000665	0.00067	"				-			J
Benzo(b)fluoranthene	ND	0.00067	"				-			
Benzo(a)anthracene	ND	0.00067	"				-			
Acenaphthene	ND	0.00067	"				-			
2-Methylnaphthalene	ND	0.00067	"				-			
1-Methylnaphthalene	ND	0.00067	"				-			

Origins Laboratory, Inc.



The results in this report apply to the samples analyzed in accordance with the chain of custody document. This analytical report must be reproduced in its entirety.

Eagle Environmental Consulting, Inc.  
8000 W 44th Ave  
Wheat Ridge CO 80033

Martin C Eckert III  
Project Number: [none]  
Project: Noble - Walker #4-25

PAH by 8270D SIM - Quality Control  
Waypoint Analytical, Inc.

Analyte	Result	Reporting Limit	Units	Spike Level	Source Result	%REC	%REC Limits	RPD	RPD Limit	Notes
---------	--------	-----------------	-------	-------------	---------------	------	-------------	-----	-----------	-------

Batch L611114 - 3550B

LRB (LRB-L611114)

Prepared: 04/15/2022 Analyzed: 04/18/2022

Benzo(a)pyrene	ND	0.00067	mg/Kg				-			
Surrogate: Nitrobenzene-d5	62.1		"	0.333	62.1		29-110			
Surrogate: 4-Terphenyl-d14	70.2		"	0.333	70.2		33-122			
Surrogate: 2-Fluorobiphenyl	54.9		"	0.333	54.9		33-115			

Origins Laboratory, Inc.



The results in this report apply to the samples analyzed in accordance with the chain of custody document. This analytical report must be reproduced in its entirety.

Eagle Environmental Consulting, Inc.  
8000 W 44th Ave  
Wheat Ridge CO 80033

Martin C Eckert III  
Project Number: [none]  
Project: Noble - Walker #4-25

### Notes and Definitions

U Sample is Non-Detect.

QM-07 The spike recovery was outside acceptance limits for the MS and/or MSD. The batch was accepted based on acceptable LCS recovery.

JB [Undefined]

J Estimated Value. Analyte below reported quantitation limit.

\* QC Failure

ND Analyte NOT DETECTED at or above the reporting limit

RPD Relative Percent Difference

All soil results are reported on a wet weight basis.

Origins Laboratory, Inc.



*The results in this report apply to the samples analyzed in accordance with the chain of custody document. This analytical report must be reproduced in its entirety.*