

MUTUAL S8 EOR Unit

Location Vicinity Water Wells
 Jackson County, Colorado
 North Park Horizontal Niobrara Field

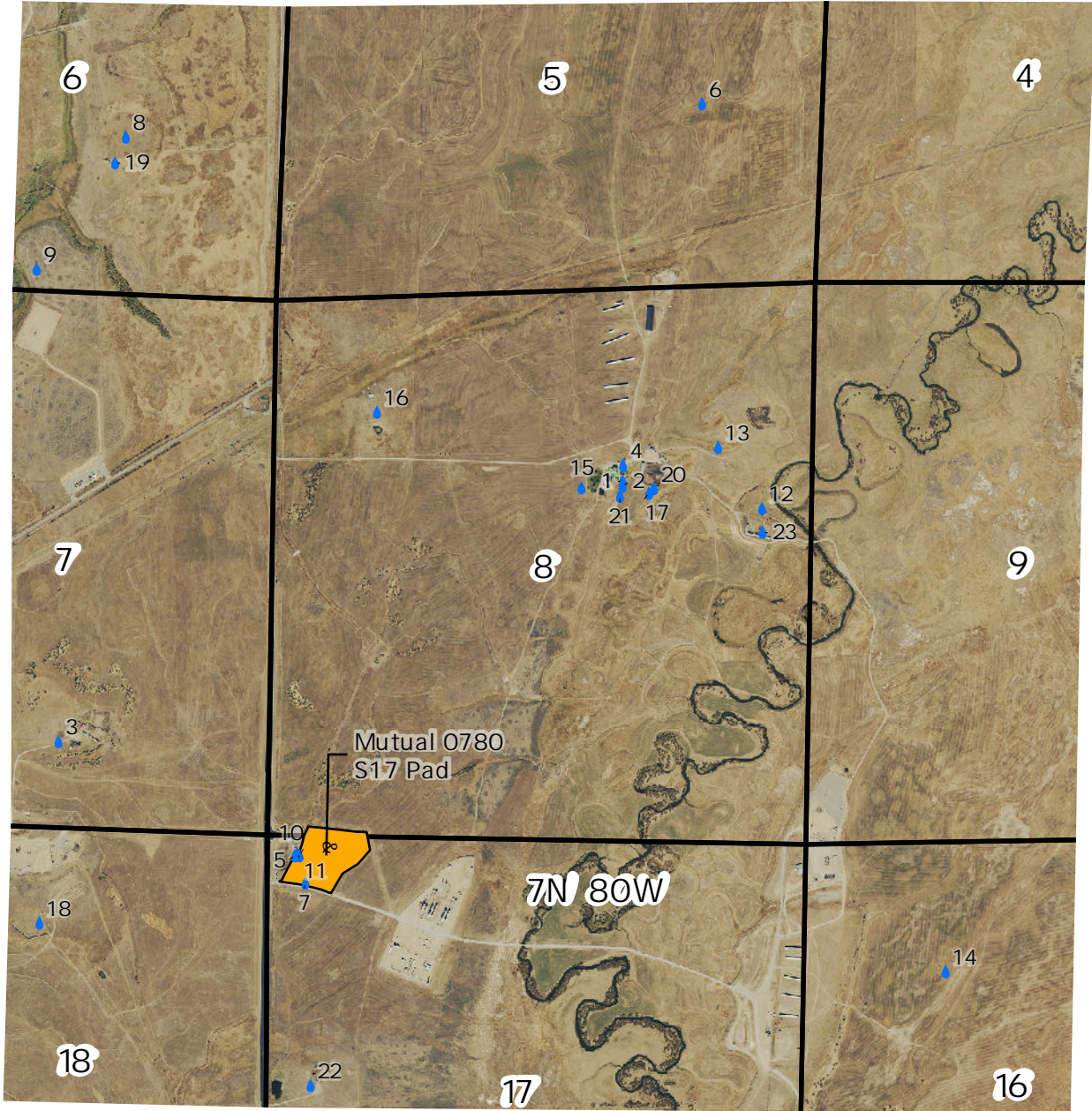

Nearby Crossroads - State Highway 14 & Jackson County Road 24

Well Label	DWR Well Name	Permit	Well Depth	Well Label	DWR Well Name	Permit	Well Depth	Well Label	DWR Well Name	Permit	Well Depth
1	0	73212-	50	9	0	242234-	140	17	0	73634-	12
2	0	73213-	25	10	0	317113-	19	18	0	211370-	101
3	0	200820-	100	11	0	317112-	19	19	0	320080-	140
4	0	73212-A	60	12	0	73211-	40	20	0	73215-	10
5	0	317114-	19	13	0	73216-	12	21	0	73214-	60
6	0	73633-	50	14	0	73209-	60	22	0	297554-	175
7	0	317111-	19	15	0	73214-A	152	23	0	73210-	12
8	0	177594-	75	16	0	72169-	72				

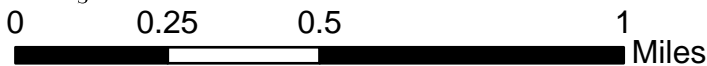
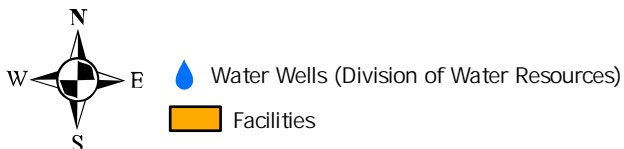

NORTH PARK ENGINEERING & CONSULTING, INC.

P.O. BOX 395
 WALDEN, CO 80480
 (970) 723-3725

DRAWING COMPLETION: 10/12/2022

DRAWN BY: ADL

CHECKED BY: RRM