

Source: Esri, Maxar, Earthstar Geographics, and the GIS User Community

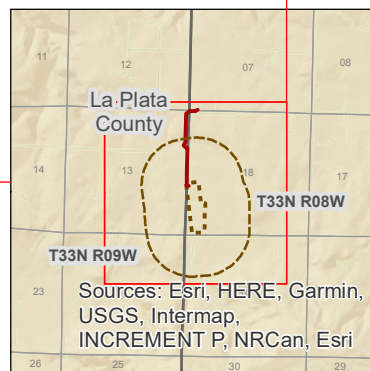
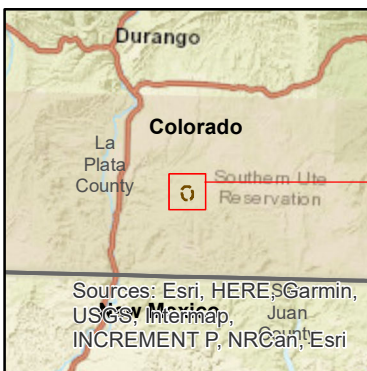

- Area of Disturbance
 - Working Pad Surface (WPS)
 - New Access Road to WPS
 - Existing Access Road to WPS
 - Pipeline
 - Working Pad Surface 2000' Buffer
- Public Land Survey:
- Township Range
 - Section

NAD 1983 State Plane
Colorado South FIPS 0503 Feet

Data Sources:
BLM, EIS, ESRI

0 250 500 Feet

1" = 1,000' 1:12,000

Author: MM, EIS Environmental
& Permitting Solutions

Date: 9/19/2022