



FORM F-106



RECEIVED

OCT 28 1970

COLO OIL & GAS CONS. COMM.

R. 58W

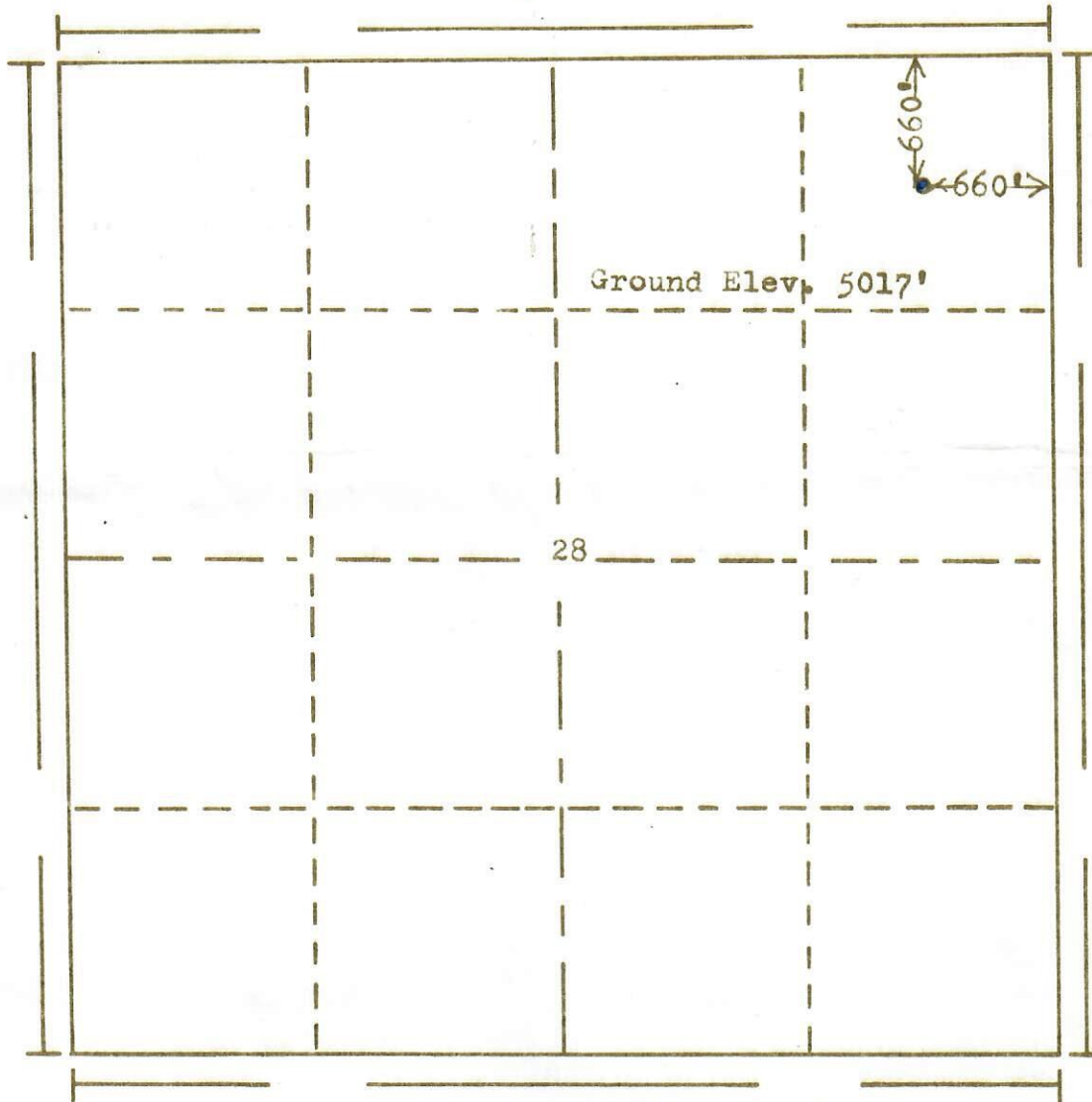

Scale... 1" = 1000'

Powers Elevation Company, Inc. of Denver, Colorado
has in accordance with a request from Mr. Snyder
for Jim Snyder Drlg. Co.

determined the location of No. *Alvina Jackson*
to be CNE NE Section 28 Township 3S

Range 58W of the 6th Principal Meridian
Adams County, Colorado

I hereby certify that this plat is an
accurate representation of a correct
survey showing the location of

Date: 10-5-70

Eric L. Hollaway
Licensed Land Surveyor No. 2853
State of Colorado