



00401382

R 58 W

RECEIVED

JAN 6 1976

COLO. OIL &amp; GAS CONS. COMM.

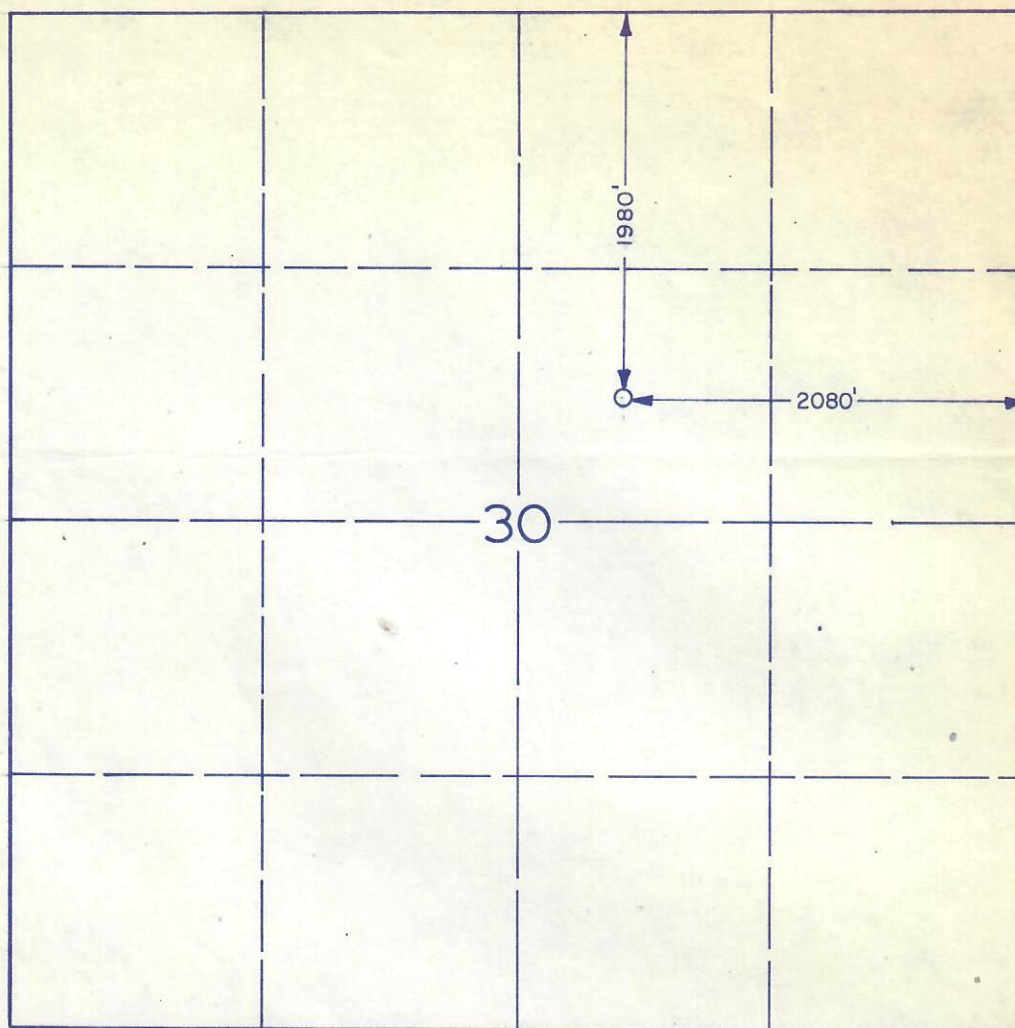

Scale: 1"—1000'

This is to certify that this is a true and correct survey and plat of **FRANK WALSH #30-2 DOWNING** drilling site, located SW NE Section 30, Township 3 SOUTH, Range 58 West, Sixth Principal Meridian, ADAMS County, COLORADO; being more particularly described as follows: beginning at the **NORTHEAST** corner of said Section 30; thence **SOUTH** 1980 feet; thence **WEST** 2080 feet, to said drilling site.

Ground Elevation— **5155 FEET**Requested By: **FRANK WALSH**Date Staked: **JANUARY 4, 1976**By: *Burr D. Leibert*

Burr Leibert

Registered Land Surveyor

Colo. 1791

76 7

