

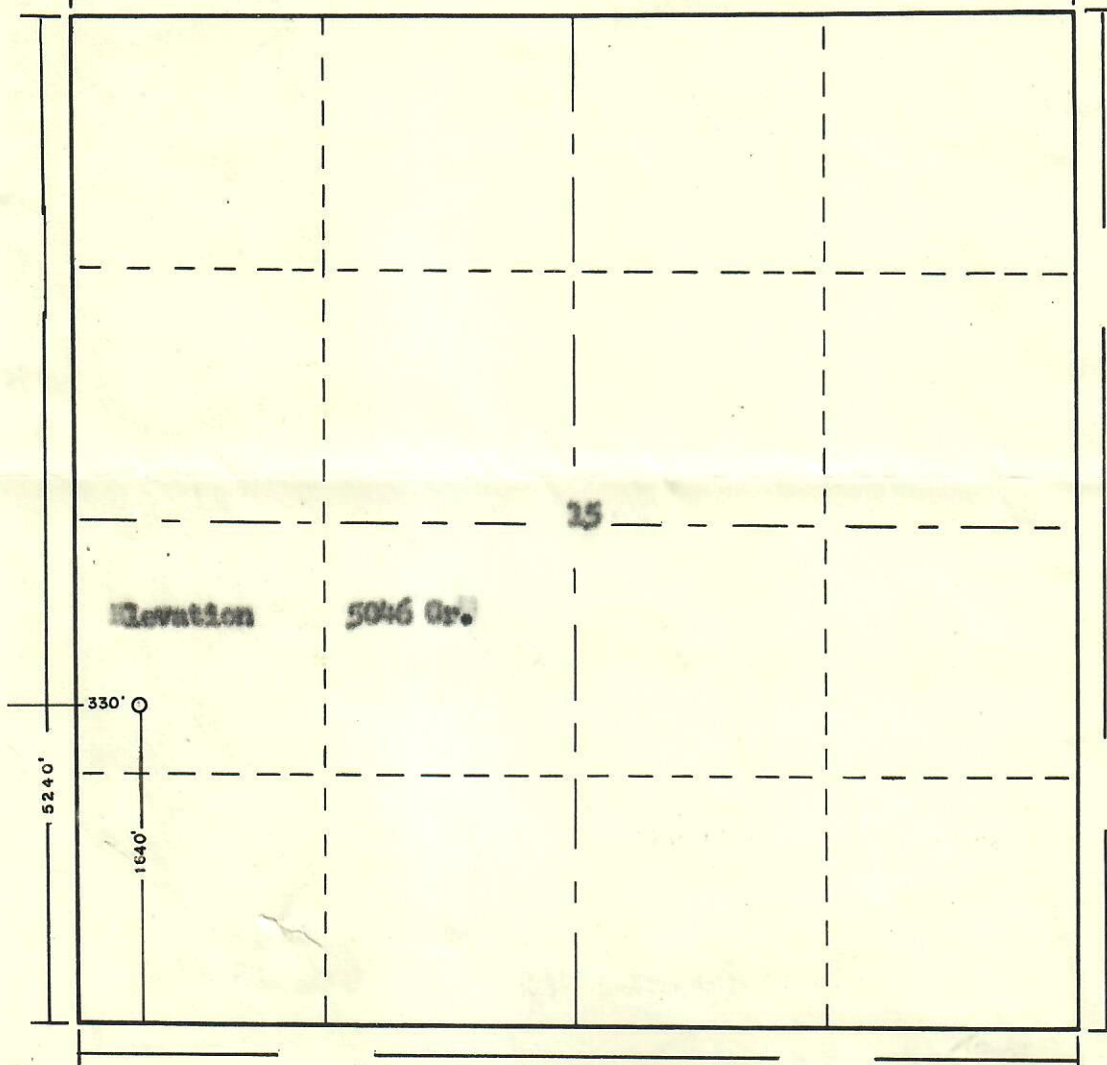

00230397

R. 59 W.

State of
Colorado
15-35-59 W.T.
3
S.

Scale ... 1" = 1000'

Powers Elevation Company of Casper, Wyoming
has in accordance with a request from **Mr. Bill Hanco**
for **Schlo Petroleum Company** determined the
Location of **#1 W-Moore**
to be **SW 1/4 SW 15** Township **3 South**
Range **59 West** **6th Principal** Meridian
Adams County, **Colorado**

The above Plat shows the location of the well site
in said section.

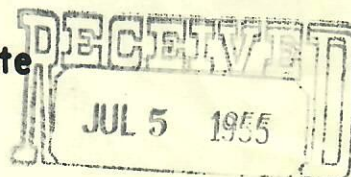

Powers Elevation Company

by:

Registered Land Surveyor

Date: 6-21-55