

**Legend**

- Underground Flowline Location (Collected via Trimble GPS)
- - - Excavation Extent (Collected via Trimble GPS)
- + Laboratory Sample Location (Collected via Trimble GPS)
- + Field Screening Sample Location (Collected via Trimble GPS)

**Notes**

All locations are approximate unless otherwise noted.

GPS – Global Positioning System

0 ft. 20 ft. 40 ft.

Image Source: Google Earth; June 2021  
Projection: WGS 84 UTM Zone 13 North





**Legend**

Excavation Extent  
(Collected via Trimble GPS)

Laboratory Sample Location  
(Collected via Trimble GPS)

**Notes**

All locations are approximate unless otherwise noted.

GPS – Global Positioning System

0 ft.

10 ft.

20 ft.

Image Source: Google Earth; June 2021  
Projection: WGS 84 UTM Zone 13 North

DATE: May 11, 2022	<div><div><b>Tasman, Inc.</b> 6855 W. 119<sup>th</sup> Ave. Broomfield, CO 80020</div></div>	<div><b>PDC Energy, Inc. – DJ Basin</b> <b>Former Werning 3,4-2 Tank Battery</b> NENW, Section 2, Township 4 North, Range 66 West Weld County, Colorado</div>	<div>INITIAL EXCIVATION SITE MAP</div>	<div>FIGURE 2</div>
DESIGNED BY: C. Hamlin				
DRAWN BY: S. Anderson				



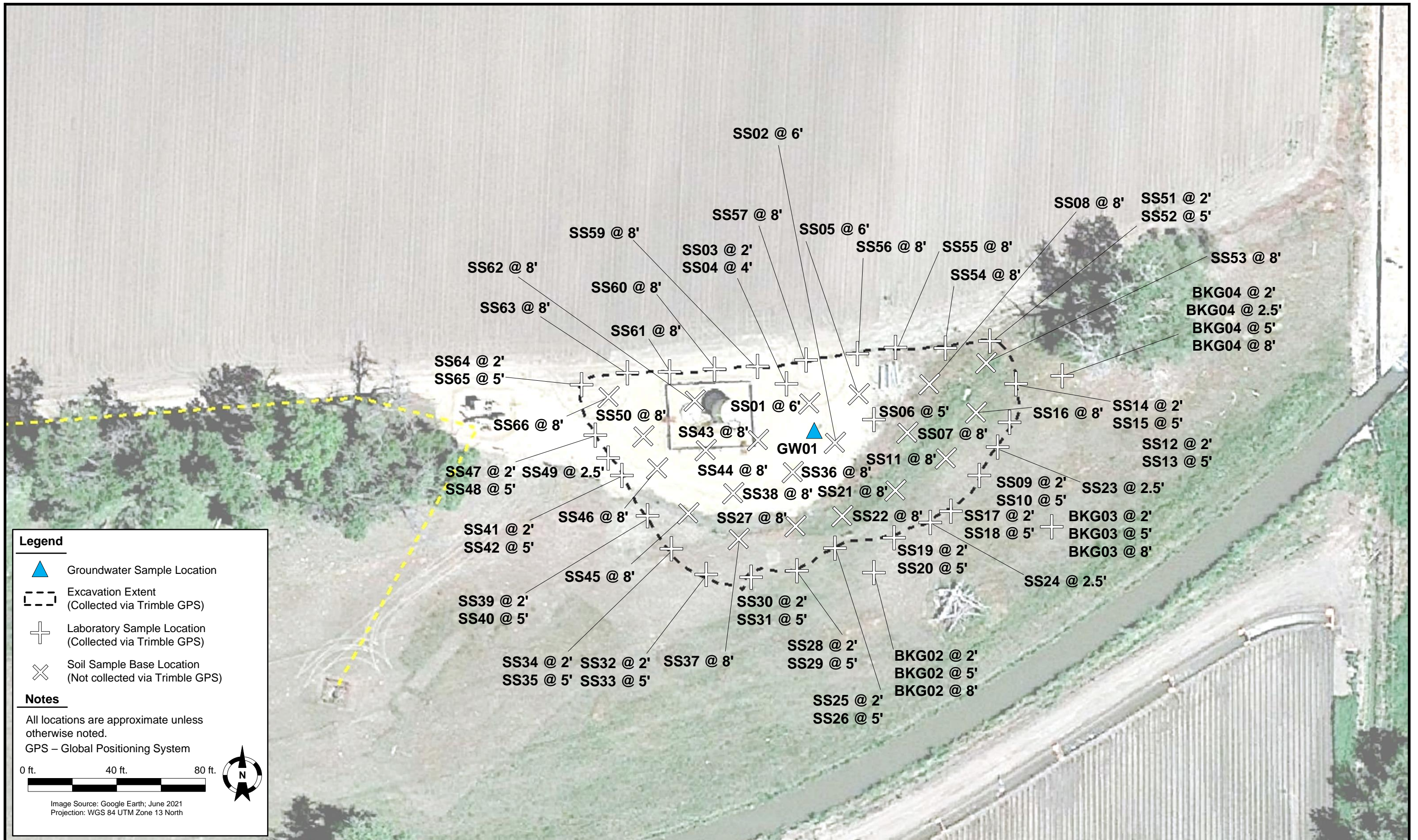

DATE:	May 11, 2022
DESIGNED BY:	C. Hamlin
DRAWN BY:	S. Anderson

**Tasman, Inc.**  
 6855 W. 119<sup>th</sup> Ave.  
 Broomfield, CO 80020

**PDC Energy, Inc. – DJ Basin**  
**Former Werning 3,4-2 Tank Battery**  
 NENW, Section 2, Township 4 North, Range 66 West  
 Weld County, Colorado



EXCAVATION SITE MAP

FIGURE  
3



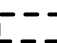

**Legend**

-  Proposed Monitoring Well Location
-  Excavation Extent  
(Collected via Trimble GPS)
-  Underground Flowline Location  
(Collected via Trimble GPS)

**Notes**

All locations are approximate unless otherwise noted.

GPS – Global Positioning System

0 ft. 40 ft. 80 ft.



Image Source: Google Earth; June 2021  
Projection: WGS 84 UTM Zone 13 North



DATE: June 14, 2022

DESIGNED BY: C. Hamlin

DRAWN BY: K. Shepherd



**TASMAN**

**Tasman, Inc.**  
6855 W. 119<sup>th</sup> Ave.  
Broomfield, CO 80020

**PDC Energy, Inc. – DJ Basin**  
**Former Werning 3,4-2 Tank Battery**  
NENW, Section 2, Township 4 North, Range 66 West  
Weld County, Colorado



PROPOSED MONITORING  
WELL LOCATION MAP

FIGURE  
4



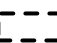

**Legend**

-  Proposed Soil Boring Location
-  Excavation Extent  
(Collected via Trimble GPS)
-  Underground Flowline Location  
(Collected via Trimble GPS)

**Notes**

All locations are approximate unless otherwise noted.

GPS – Global Positioning System

0 ft. 40 ft. 80 ft.



Image Source: Google Earth; June 2021  
Projection: WGS 84 UTM Zone 13 North



DATE: June 14, 2022

DESIGNED BY: C. Hamlin

DRAWN BY: K. Shepherd



**TASMAN**

**Tasman, Inc.**  
6855 W. 119<sup>th</sup> Ave.  
Broomfield, CO 80020

**PDC Energy, Inc. – DJ Basin**  
**Former Werning 3,4-2 Tank Battery**  
NENW, Section 2, Township 4 North, Range 66 West  
Weld County, Colorado

**PROPOSED SOIL  
BORING LOCATION MAP**

**FIGURE  
5**