



00278593

RECEIVED

MAR 24 1971

R. 54W

COLO. OIL & GAS CONS. COMM.

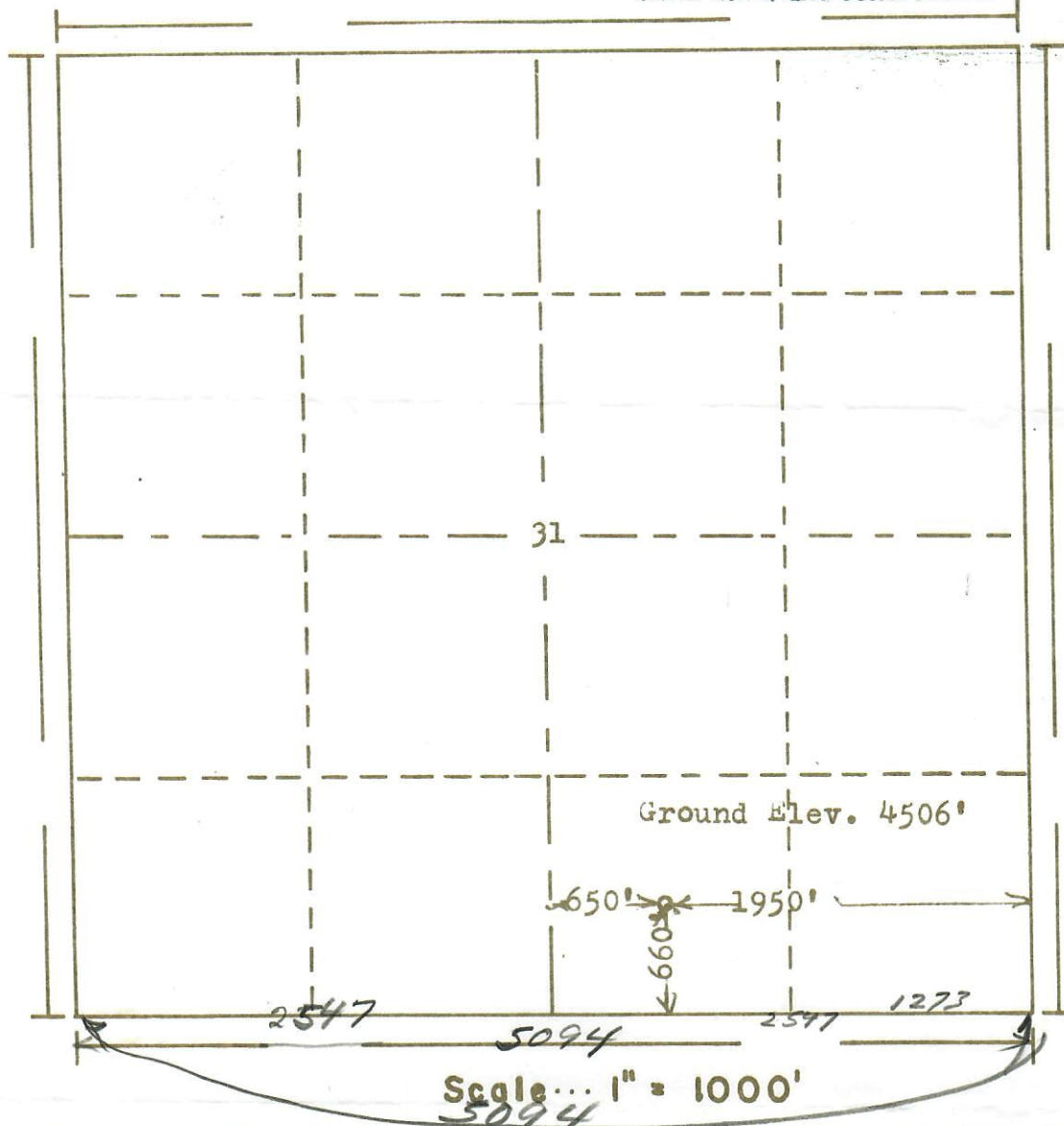

Powers Elevation Company, Inc. of Denver, Colorado
has in accordance with a request from Mr. Gear
for C.W. Hughes et al

determined the location of No. 1 Casement

to be CSW SE

Section 31 Township 12N

Range 54W

of the 6th Principal

Meridian

Logan

County, Colorado

I hereby certify that this plat is an
accurate representation of a correct
survey showing the location of

71 208

Date: 3-19-71

Reed J. Hollman
Licensed Land Surveyor No. 2853
State of Colorado