

OIL AND GAS CONSERVATION COMMISSION
OF THE STATE OF COLORADO

NOV 20 1970



00241616

COLO. OIL & GAS CONS. COMM.

APPLICATION FOR PERMIT TO DRILL, DEEPEN, OR PLUG BACK

1a. TYPE OF WORK

DRILL ☒DEEPEN ☐PLUG BACK ☐

b. TYPE OF WELL

OIL
WELL ☒GAS
WELL ☐

OTHER

SINGLE
ZONE ☐MULTIPLE
ZONE ☐

2. NAME OF OPERATOR

Spelman Prentice & Associates

3. ADDRESS OF OPERATOR

P. O. Box 2514, Casper, Wyoming 82601

4. LOCATION OF WELL (Report location clearly and in accordance with any State requirements.)

At surface

SW $\frac{1}{4}$ NE $\frac{1}{4}$ Sec. 12, T. 9N, R. 55W

At proposed prod. zone 2040' FNL & 2020' FEL of Section 12

14. DISTANCE IN MILES AND DIRECTION FROM NEAREST TOWN OR POST OFFICE

15. DISTANCE FROM PROPOSED
LOCATION TO NEAREST
PROPERTY OR LEASE LINE, FT.

(Also to nearest drlg. line, if any)

600'

16. NO. OF ACRES IN LEASE

320

17. NO. OF ACRES ASSIGNED
TO THIS WELL

40

18. DISTANCE FROM PROPOSED LOCATION

TO NEAREST WELL, DRILLING, COMPLETED,
OR APPLIED FOR, ON THIS LEASE, FT.

P&A

Approximately 2250'

19. PROPOSED DEPTH

5600'

20. ROTARY OR CABLE TOOLS

Rotary - Garvey Drilling Co.

21. ELEVATIONS (Show whether DF, RT, GR, etc.)

4355' Gr., 4365' K.B. (est)

22. APPROX. DATE WORK WILL START

December 1, 1970

23. PROPOSED CASING AND CEMENTING PROGRAM

SIZE OF HOLE	SIZE OF CASING	WEIGHT PER FOOT	SETTING DEPTH	QUANTITY OF CEMENT
12 $\frac{1}{4}$ "	New 8-5/8" H-40	20#	200'	Cemented to surface

We propose to drill a 7-7/8" hole to 5600 feet to evaluate the "D" and "J" sand formations. Drill stem tests will be taken as necessary and Schlumberger IES and porosity logs will be run at total depth. An engineered string of 4 $\frac{1}{2}$ " or 5 $\frac{1}{2}$ " production casing will be run and set if production is indicated. Blowout preventors will be installed and tested every 24 hours.

agent att
5,000 Bond att

DVR	
FJP	
HMM	
JAM	<input checked="" type="checkbox"/>
JJD	Plotter 11/20/70

IN ABOVE SPACE DESCRIBE PROPOSED PROGRAM: If proposal is to deepen or plug back, give data on present productive zone and proposed new productive zone. If proposal is to drill or deepen directionally, give pertinent data on subsurface locations and measured and true vertical depths. Give blowout preventer program, if any.

24. SPELMAN PRENTICE & ASSOCIATES

SIGNED

TITLE

Manager

DATE Nov. 18, 1970

(This space for Federal or State office use)

PERMIT NO.

APPROVAL DATE

DIRECTOR

APPROVED BY

TITLE

DATE

NOV 20 1970

CONDITIONS OF APPROVAL, IF ANY:

A.P.I. NUMBER

05 075 8251

See Instructions On Reverse Side



RECEIVED

NOV 20 1970

R. 55W

COLO. OIL & GAS CONS. COMM.

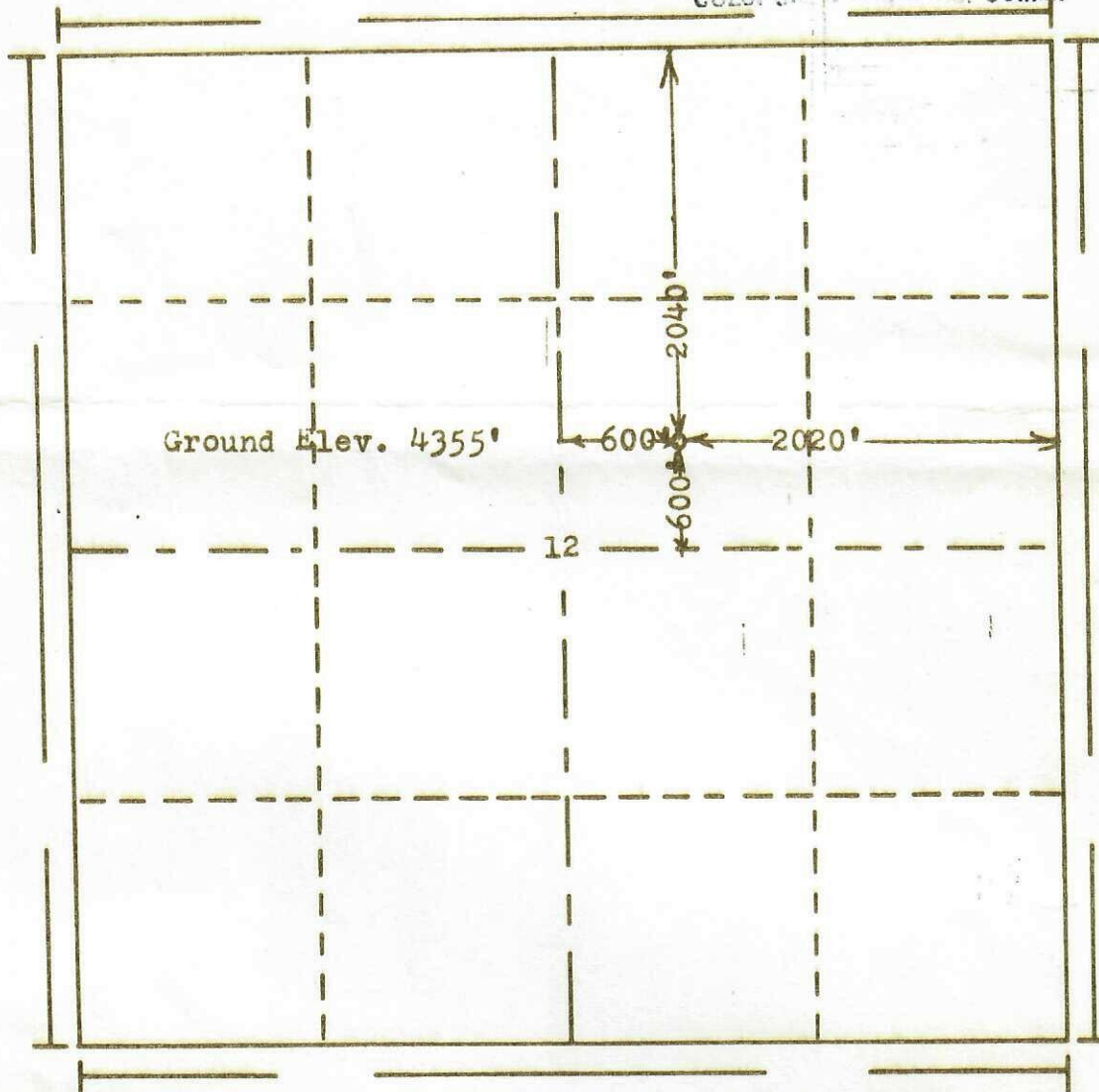

Scale... 1" = 1000'

Powers Elevation Company, Inc. of Denver, Colorado
has in accordance with a request from Mr. Masterson
for Spellman-Prentice & Associates
determined the location of No. 32-12-9-55 C-V
to be 2040'FN & 2020'FE Section 12 Township 9N
Range 55W of the 6th Principal Meridian
Logan County, Colorado

I hereby certify that this plat is an
accurate representation of a correct
survey showing the location of

Date: 11-12-70

B. J. Hall
Licensed Land Surveyor No. 2853
State of Colorado